

SIGN LEGEND

1 TS-9-4860	2 TS-4-4860 (SEE NOTE 2)	3 R3-2-36 (SEE NOTE 1)	4 M4-8(O)-2412 M4-15-2412 M3-4-2412 M1-1-24 M5-1R(O)-2115	5 M4-8(O)-2412 M4-15-2412 M3-4-2412 M1-1-24 M6-1-2115
6 M4-8(O)-2412 M4-15-2412 M3-4-2412 M1-1-24 M5-1L(O)-2115	7 M4-8(O)-2412 M4-15-2412 M3-4-2412 M1-1-24 M6-1-2115	8 NOT USED	9 M4-8(O)-2412 M4-15-2412 M3-4-2412 M1-1-24 M6-1-2115	
10 PHASE I 3-SEC DISPLAY (18" LETTERS) PHASE II 3-SEC DISPLAY (18" LETTERS)	11 W20-2(O)-48	12 M4-8A(O)-2418 M4-15-2412 M3-4-2412 M1-1-24		

NOTES

- SEE MAINTENANCE OF TRAFFIC PLANS FOR SIGN LOCATION DETAIL.
- PLACE TS-4 SIGN ADJACENT TO WESTBOUND RAMP ENTRANCE SIGNAGE FOR NORTHBOUND DIRECTION ONLY. DATES FOR BOTTOM TWO LINES ON TS-4 SIGN SHALL BE DETERMINED BY THE ENGINEER AND PLACED AT LEAST ONE (1) WEEK PRIOR TO RAMP CLOSURES OR AS OTHERWISE DIRECTED BY THE ENGINEER.

MATCH LINE SEE SHEET 6 OF 8

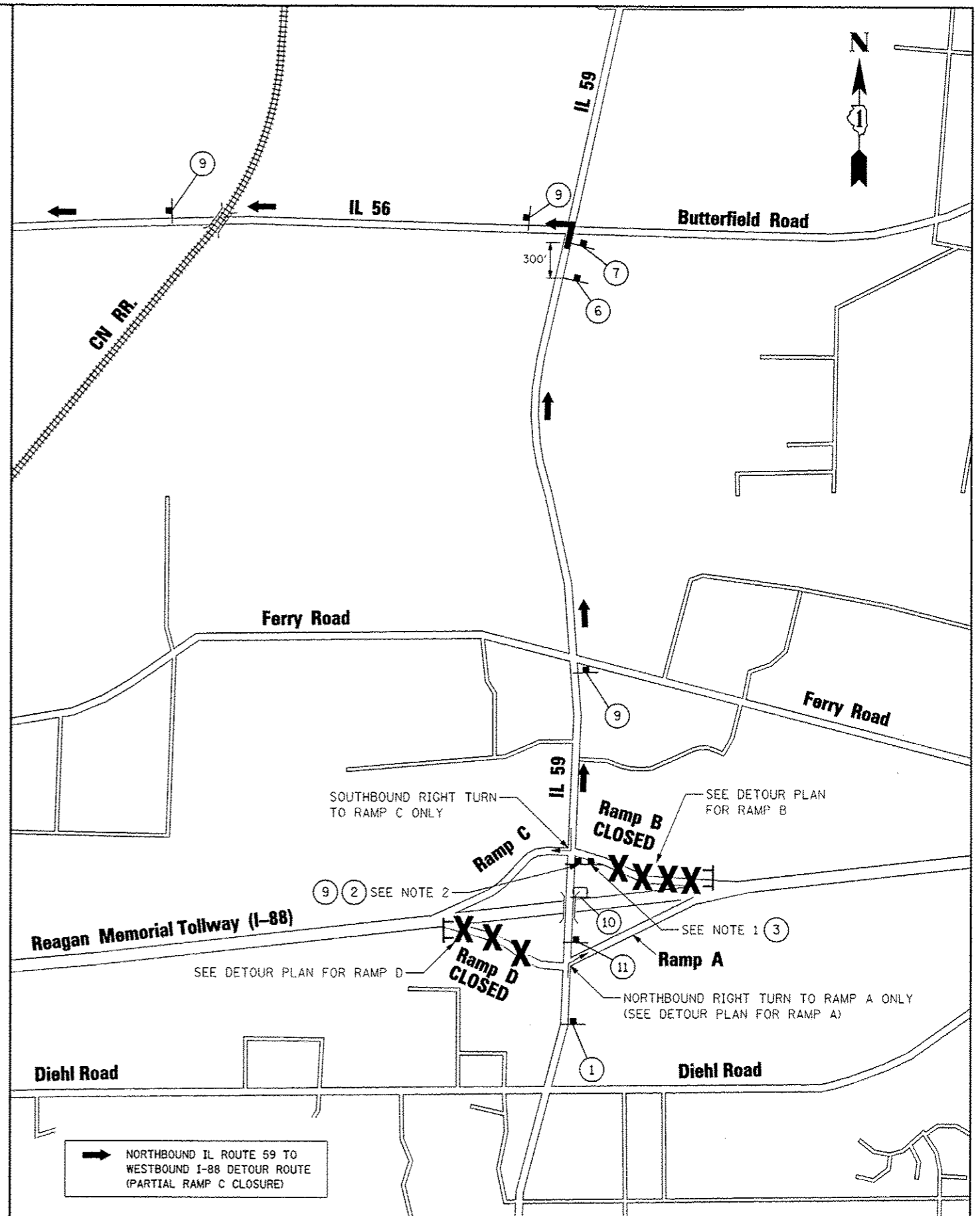

FILE NAME = #PJLE4	USER NAME = #USER#	DESIGNED PJO	REVISED -ADDENDUM A 12/17/2012
		DRAWN KES	REVISED -
		CHECKED JCM	REVISED -
		DATE 10/15/2012	REVISED -

**STATE OF ILLINOIS
DEPARTMENT OF TRANSPORTATION**

**DETOUR PLAN FOR RAMP C (1 OF 2)
NORTHBOUND IL ROUTE 59 TO WESTBOUND I-88**

SCALE: N.T.S. SHEET NO. 5 OF 8 SHEETS STA. TO STA.

F.A.P. RTE.	SECTION	COUNTY	TOTAL SHEETS	SHEET NO.
338	(112 & 113) WRS-5	DUPAGE	963	91
CONTRACT NO. 60131			ILLINOIS FED. AID PROJECT	