

DRUMS WITH STEADY BURNING LIGHTS SPACED AT 50' C-C, TYP.

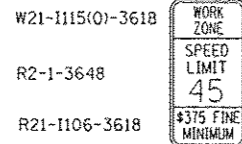

MATCH LINE STA. 6521+00

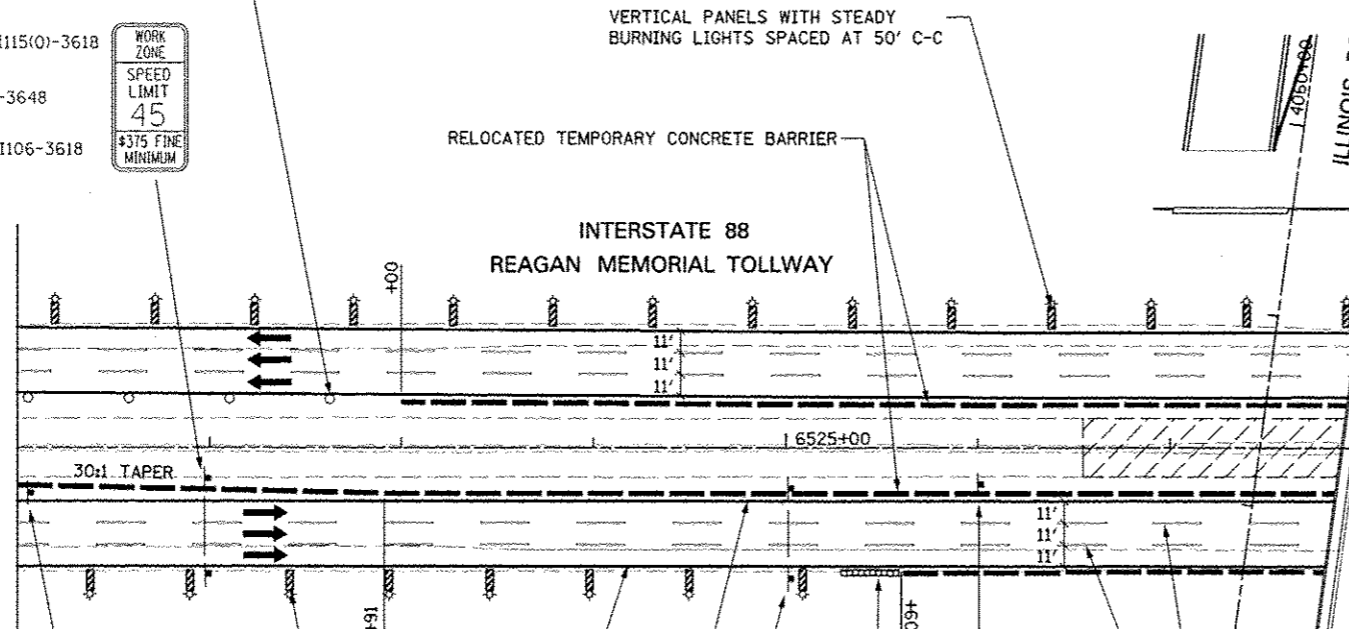

VERTICAL PANELS WITH STEADY BURNING LIGHTS SPACED AT 50' C-C

RELOCATED TEMPORARY CONCRETE BARRIER

INTERSTATE 88 REAGAN MEMORIAL TOLLWAY

ILLINOIS ROUTE 59

SEE SIGN TRAILER MOUNTED SIGN ASSEMBLY AND NOTE BELOW

WET REF TEM TAPE T3 LINE 4 W

WET REF TEM TAPE T3 LINE 4 Y

WET REF TEM TAPE T3 4 W SKIP DASH 25' LINE - 25' SPACE

DRUMS WITH STEADY BURNING LIGHTS SPACED AT 50' C-C, TYP.

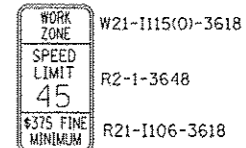

MATCH LINE STA. 6533+00



WET REF TEM TAPE T3 LINE 4 W

WET REF TEM TAPE T3 LINE 4 Y

VERTICAL PANELS WITH STEADY BURNING LIGHTS SPACED AT 50' C-C

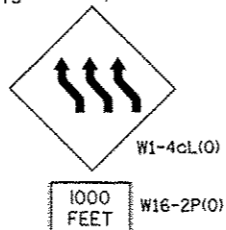

RELOCATED IMPACT ATTENUATORS, TEMPORARY (FULLY REDIRECTIVE, NARROW) TEST LEVEL 3

WET REF TEM TAPE T3 4 W SKIP DASH 25' LINE - 25' SPACE (TYP.)

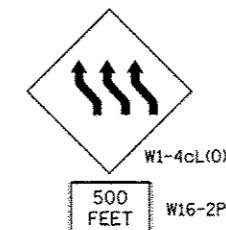

WET REF TEM TAPE T3 LINE 4 W

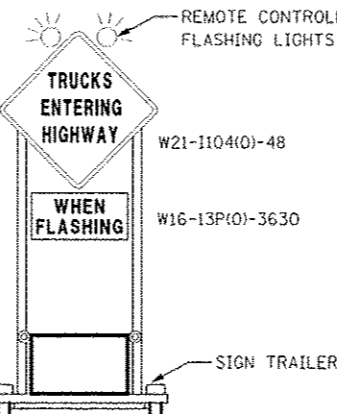

**NOTE:**

FLASHING WARNING LIGHTS SHALL MEET THE REQUIREMENTS OF TOLLWAY SUPPLEMENTAL SPECIFICATIONS AND BE OPERATED BY THE FLAGGER REMOTELY. THE LIGHTS SHALL BE FLASHING ONLY WHEN A VEHICLE IS ENTERING THE TOLLWAY.

**TOLLWAY TRAFFIC CONTROL**

TRAFFIC CONTROL ON INTERSTATE 88 AND AT RAMP TERMINALS SHALL BE IN ACCORDANCE WITH THE FOLLOWING ILLINOIS TOLLWAY STANDARDS:

- E1 CONSTRUCTION SIGNS
- E2 LANE CLOSURE DETAILS
- E3 SHOULDER CLOSURE DETAILS
- E4 MAINTENANCE OF TRAFFIC REVERSE CURVE
- E5 TEMPORARY GORE DETAILS

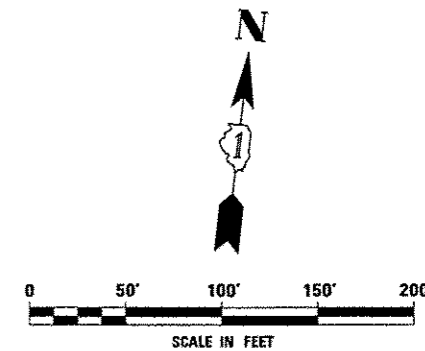

FILE NAME: #FILE#	USER NAME: #USER#	DESIGNED: PJO	REVISED: -	<b>STATE OF ILLINOIS DEPARTMENT OF TRANSPORTATION</b>	<b>MAINTENANCE OF TRAFFIC - STAGE 3A INTERSTATE 88</b>		F.A.P. RTE.:	SECTION:	COUNTY:	TOTAL SHEETS:	SHEET NO.:	
		DRAWN: RES	REVISED: -		SCALE:	SHEET NO. 70 OF 118 SHEETS	STA. 6521+00 TO STA. 6533+00	338	(112 & 113) WRS-5	DUPAGE	963	186
		CHECKED: JCM	REVISED: -		CONTRACT NO. 60131							
		DATE: 10/15/2012	REVISED: -		ILLINOIS FED. AID PROJECT							