



TS-2(0)

STA. 6586+00

1.4 MILES

TRAILER MOUNTED FULL MATRIX PORTABLE CHANGEABLE MESSAGE SIGN SEE NOTES 1 AND 2

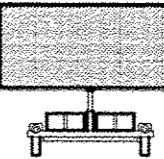

± 500' EAST OF MILL STREET BRIDGE

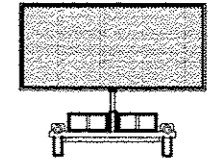

TRAILER MOUNTED FULL MATRIX PORTABLE CHANGEABLE MESSAGE SIGN SEE NOTES 1 AND 2

± 250' EAST OF WASHINGTON ST. BRIDGE

¼ MILE

ADVANCE WARNING SIGN SEQUENCE DETAIL WESTBOUND

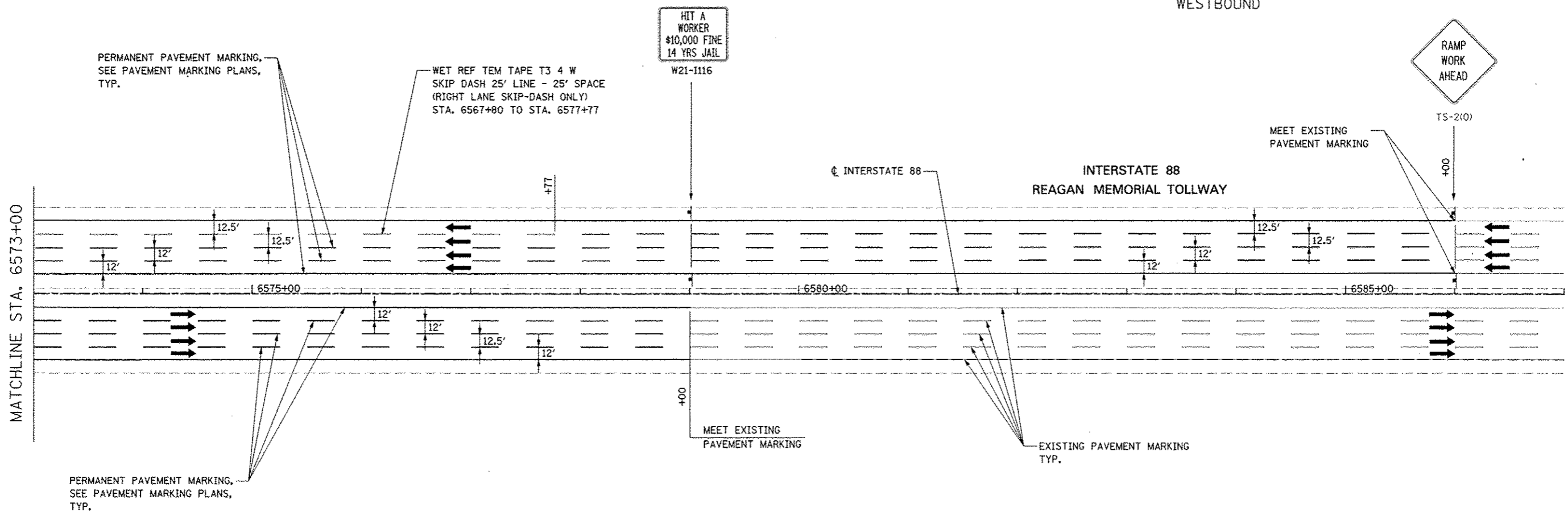

TOLLWAY TRAFFIC CONTROL

TRAFFIC CONTROL ON INTERSTATE 88 AND AT RAMP TERMINALS SHALL BE IN ACCORDANCE WITH THE FOLLOWING ILLINOIS TOLLWAY STANDARDS:

- E1 CONSTRUCTION SIGNS
- E2 LANE CLOSURE DETAILS
- E3 SHOULDER CLOSURE DETAILS
- E4 MAINTENANCE OF TRAFFIC REVERSE CURVE
- E5 TEMPORARY CORE DETAILS

NOTES

- LOCATION OF TRAILER MOUNTED FULL MATRIX PORTABLE CHANGEABLE MESSAGE SIGN SHALL BE COORDINATED WITH THE ENGINEER AND THE ILLINOIS TOLLWAY. MESSAGE TO BE DISPLAYED WILL BE REMOTELY CONTROLLED BY THE ILLINOIS TOLLWAY TRAFFIC MANAGEMENT CENTER.
- THE TRAILER MOUNTED FULL MATRIX PORTABLE CHANGEABLE MESSAGE SIGN SHALL REMAIN IN PLACE FOR THE ENTIRE DURATION OF THE CONTRACT. NO ADDITIONAL COMPENSATION WILL BE ALLOWED FOR DELAYS EXTENDING THE CONTRACT BEYOND COMPLETION DATE AS SHOWN IN THE SPECIAL PROVISIONS.

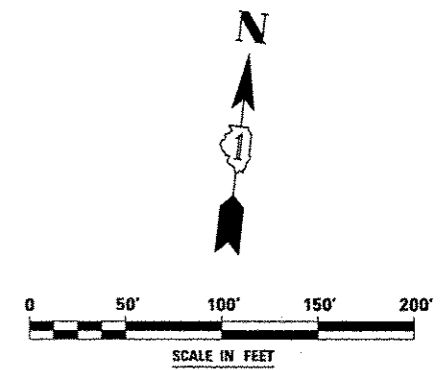

FILE NAME	USER NAME	DESIGNED	REVISED	STATE OF ILLINOIS DEPARTMENT OF TRANSPORTATION	MAINTENANCE OF TRAFFIC - STAGE 3B INTERSTATE 88	F.A.P. RTE.	SECTION	COUNTY	TOTAL SHEETS	SHEET NO.	
FILE #		DRAWN	REVISED			338	(112 & 113) WRS-5	DUPAGE	963	203	
PLOT SCALE		CHECKED	REVISED			CONTRACT NO. 60131					
PLOT DATE		DATE	REVISED			ILLINOIS FED. AID PROJECT					
					SCALE:	SHEET NO. 87 OF 118 SHEETS STA. 6573+00 TO STA. 6587+00					