

SYMBOL LEGEND

- INDICATES SIGN IS MOUNTED TO A TRAFFIC SIGNAL POLE (TYP.)
- 1 REGULATORY SIGN (R SERIES)
- 1 WARNING SIGN (W SERIES)
- 1 GUIDE SIGN (D/M SERIES)
- 1 SPECIAL/OTHER SIGNS

PAVEMENT MARKING LEGEND (SEE NOTE 4)

- A PAVEMENT MARKING - LINE 4", SOLID WHITE
- B PAVEMENT MARKING - LINE 4", WHITE SKIP-DASH (10' LINE - 30' SPACE) WITH RAISED REFLECTIVE PAVEMENT MARKERS, ONE-WAY CRYSTAL (SPACED AT 80' C-C)
- C NOT USED
- D NOT USED
- E PAVEMENT MARKING - LINE 6", SOLID WHITE WITH RAISED REFLECTIVE PAVEMENT MARKERS, ONE-WAY CRYSTAL (SPACED AT 40' C-C)
- F PAVEMENT MARKING - LINE 6", WHITE DOTTED (2' LINE - 6' SPACE, UNLESS OTHERWISE NOTED)
- G PAVEMENT MARKING - LINE 6", SOLID WHITE
- H PAVEMENT MARKING - LINE 6", SOLID WHITE WITH 12" SOLID WHITE DIAGONALS AT 45°, SPACED AT 2'
- I PAVEMENT MARKING - LINE 8", SOLID WHITE
- J PAVEMENT MARKING - LINE 12", SOLID WHITE
- K NOT USED
- L PAVEMENT MARKING - LINE 24", SOLID WHITE
- M PAVEMENT MARKING - LETTERS & SYMBOLS
- N PAVEMENT MARKING - LINE 4", SOLID YELLOW
- O PAVEMENT MARKING - LINE 8", YELLOW DOTTED (2' LINE - 6' SPACE)
- P PAVEMENT MARKING - LINE 8", SOLID YELLOW

NOTES

1. PAVEMENT MARKINGS AND RAISED REFLECTIVE PAVEMENT MARKERS SHALL BE PLACED IN ACCORDANCE WITH IDOT DISTRICT 1 DETAILS TC-11 AND TC-13.
2. SIGN LOCATIONS MAY VARY BASED ON FIELD CONDITIONS.
3. ALL POST-MOUNTED SIGNS SHALL BE MOUNTED ON TELESCOPING POLES IN ACCORDANCE WITH HIGHWAY STANDARD 728001 UNLESS OTHERWISE NOTED.
4. ALL PERMANENT PAVEMENT MARKING ON PCC PAVEMENT SHALL BE POLYUREA PAVEMENT MARKING, TYPE I AND ON HMA PAVEMENT SHALL BE THERMOPLASTIC PAVEMENT MARKING OF THE SPECIFIED TYPE IN THE PAVEMENT MARKING LEGEND.
5. STOP BARS SHALL BE LOCATED 4' BEHIND CROSSWALK MARKING UNLESS OTHERWISE INDICATED.

ALIGNMENT LEGEND

+39.5 INDICATES STATION MEASURED FROM SB BASELINE

+39.5 INDICATES STATION MEASURED FROM NB BASELINE

SIGN LEGEND

- 14 R4-7-3036
- 24 R3-5L-3036 ONLY
- 27 R3-SR-3036 ONLY
- 1 SOUTH ILLINOIS 59 M3-3-2412 M1-I100-24
- 3 JCT TOLL M2-1-2115 M4-15-2412
- 88 INTERSTATE M1-1-36
- 2A SPEED LIMIT 40 R2-1-3036 (40 MPH)

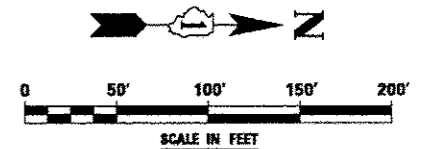
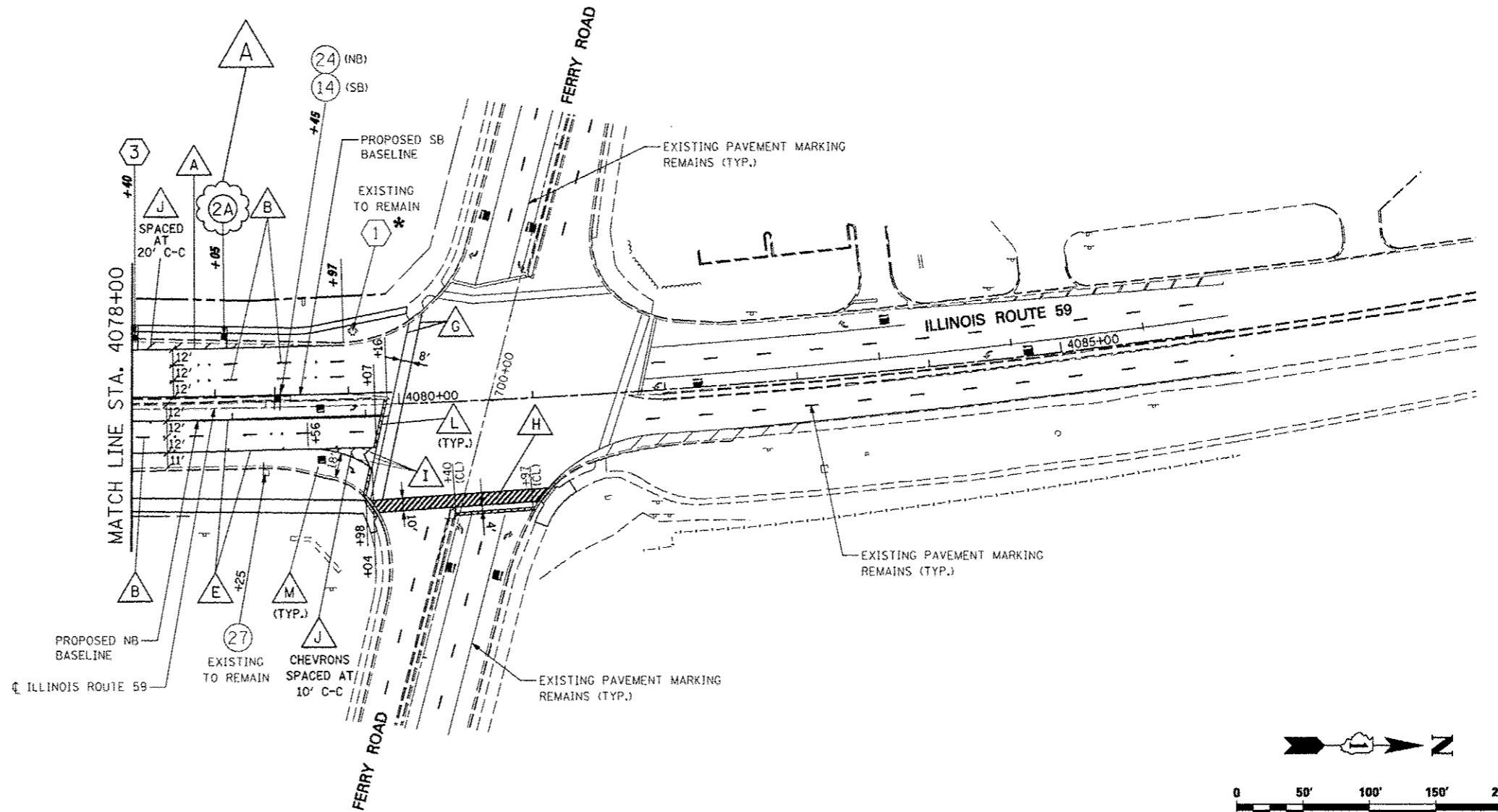

FILE NAME *	USER NAME * #USER*	DESIGNED PJO	REVISED -ADDENDUM A 12/17/2012	STATE OF ILLINOIS DEPARTMENT OF TRANSPORTATION	PAVEMENT MARKING AND SIGNING ILLINOIS ROUTE 59	F.A.P. RTE.	SECTION	COUNTY	TOTAL SHEETS	SHEET NO.	
#FILE#		DRAWN KES	REVISED -			338	(112 & 113) WRS-5	DUPAGE	963	384	
PLT SCALE * #SCALE*		CHECKED JCM	REVISED -			CONTRACT NO. 60131					
PLT DATE * #DATE*		DATE 10/15/2012	REVISED -			ILLINOIS FED. AID PROJECT					
						SCALE:	SHEET NO. 6 OF 18 SHEETS		STA. 4078+00 TO STA. 4086+00		