





STAGE 1A TEMPORARY TRAFFIC SIGNALS
SEE SHEET TS-3 FOR STAGE 1A TEMPORARY CABLE PLAN

RESTORATION OF WORK AREA. RESTORATION OF THE TRAFFIC SIGNAL WORK AREA SHALL BE INCIDENTAL TO THE RELATED PAY ITEM SUCH AS FOUNDATION, CONDUIT, HANDHOLE, TRENCH AND BACKFILL, ETC., AND NO EXTRA COMPENSATION SHALL BE ALLOWED. ALL ROADWAY SURFACES SUCH AS SHOULDERS, MEDIANS, SIDEWALKS, PAVEMENT, ETC. SHALL BE REPLACED IN KIND. ALL DAMAGE TO MOWED LAWNS SHALL BE REPLACED WITH AN APPROVED SOD, AND ALL DAMAGE TO UNMOWED FIELDS SHALL BE SEED IN ACCORDANCE WITH STANDARD SPECIFICATIONS 252 AND 250 RESPECTIVELY.

THE TRAFFIC SIGNAL CONTROLLER EQUIPMENT SHALL BE "ECONOLITE" TO MATCH THE EXISTING ADJACENT SYSTEM.

- LEGEND**
-  CONSTRUCTION WORK ZONE
 -  TEMPORARY PAVEMENT PLACED IN THIS STAGE
 -  DIRECTION OF TRAFFIC
 -  VIDEO DETECTION ZONE

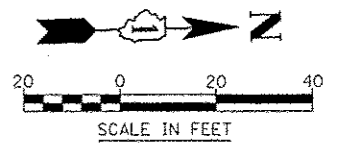
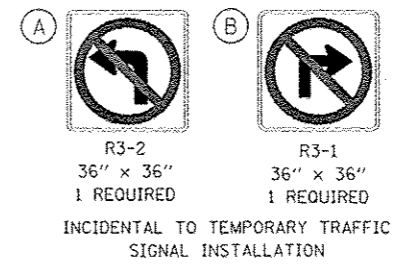

FILE NAME	USER NAME	DESIGNED	REVISED	STATE OF ILLINOIS DEPARTMENT OF TRANSPORTATION	TEMPORARY TRAFFIC SIGNAL INSTALLATION MOT STAGES 1A ILLINOIS ROUTE 59 AND I-88 NORTH RAMPS	F.A.P. RTE.	SECTION	COUNTY	TOTAL SHEETS	SHEET NO.
FILE#		DRAWN	REVISED			338	(112 & 113) WRS-5	DUPAGE	963	420
PILOT SCALE		CHECKED	REVISED			TS-5			CONTRACT NO. 60131	
PILOT DATE		DATE	REVISED			ILLINOIS FED. AID PROJECT				
					SCALE: AS SHOWN	SHEET NO. 5 OF 53 SHEETS	STA.	TO STA.		