

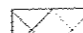

STAGE 1 TEMPORARY TRAFFIC SIGNALS
SEE SHEET TS-17 FOR STAGE 1 TEMPORARY CABLE PLAN

THIS VIDEO DETECTION CAMERA TO BE DEACTIVATED DURING PRESTAGE, STAGES 1, 1A, 1B AND 2; CAMERA LOCATED ON THE SOUTHWEST CORNER SHALL BE USED FOR DETECTION ON SOUTHBOUND IL ROUTE 59. SEE TEMPORARY CABLE PLAN.

RESTORATION OF WORK AREA. RESTORATION OF THE TRAFFIC SIGNAL WORK AREA SHALL BE INCIDENTAL TO THE RELATED PAY ITEM SUCH AS FOUNDATION, CONDUIT, HANDHOLE, TRENCH AND BACKFILL, ETC., AND NO EXTRA COMPENSATION SHALL BE ALLOWED. ALL ROADWAY SURFACES SUCH AS SHOULDERS, MEDIANS, SIDEWALKS, PAVEMENT, ETC. SHALL BE REPLACED IN KIND. ALL DAMAGE TO MOWED LAWNS SHALL BE REPLACED WITH AN APPROVED SOD, AND ALL DAMAGE TO UNMOWED FIELDS SHALL BE SEEDED IN ACCORDANCE WITH STANDARD SPECIFICATIONS 252 AND 250 RESPECTIVELY.

THE TRAFFIC SIGNAL CONTROLLER EQUIPMENT SHALL BE "ECONOLITE" TO MATCH THE EXISTING ADJACENT SYSTEM.

- LEGEND**
-  CONSTRUCTION WORK ZONE
 -  TEMPORARY PAVEMENT PLACED IN THIS STAGE
 -  DIRECTION OF TRAFFIC
 -  VIDEO DETECTION ZONE

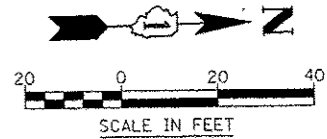
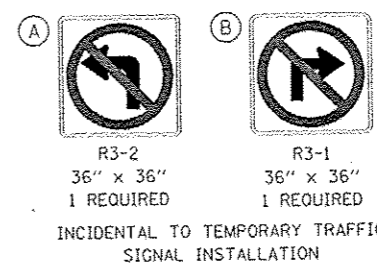

| | | | | | | | | | | | | | |
|-----------|--------------------|------------------------|---------|---|---|---------------------------|------|-------------|---------|-------------------|--------------|-----------|-----|
| FILE NAME | USER NAME = BUSERA | DESIGNED <i>MJM</i> | REVISED | STATE OF ILLINOIS DEPARTMENT OF TRANSPORTATION | TEMPORARY TRAFFIC SIGNAL INSTALLATION MOT STAGE 1 ILLINOIS ROUTE 59 AND I-88 SOUTH RAMPS | | | F.A.P. RTE. | SECTION | COUNTY | TOTAL SHEETS | SHEET NO. | |
| FILE # | | DRAWN <i>KES</i> | REVISED | | SCALE: AS SHOWN | SHEET NO. 18 OF 53 SHEETS | STA. | TO STA. | 338 | (112 & 113) WRS-5 | DUPAGE | 963 | 433 |
| | | CHECKED <i>JCM</i> | REVISED | | TS-18 | | | | | | | | |
| | | DATE <i>10/15/2012</i> | REVISED | | ILLINOIS FED. AID PROJECT CONTRACT NO. 60131 | | | | | | | | |