





**STAGE 1A TEMPORARY TRAFFIC SIGNALS**  
SEE SHEET TS-20 FOR STAGE 1A TEMPORARY CABLE PLAN

RESTORATION OF WORK AREA, RESTORATION OF THE TRAFFIC SIGNAL WORK AREA SHALL BE INCIDENTAL TO THE RELATED PAY ITEM SUCH AS FOUNDATION, CONDUIT, HANDHOLE, TRENCH AND BACKFILL, ETC., AND NO EXTRA COMPENSATION SHALL BE ALLOWED. ALL ROADWAY SURFACES SUCH AS SHOULDERS, MEDIANS, SIDEWALKS, PAVEMENT, ETC. SHALL BE REPLACED IN KIND. ALL DAMAGE TO MOWED LAWNS SHALL BE REPLACED WITH AN APPROVED SOD, AND ALL DAMAGE TO UNMOWED FIELDS SHALL BE SEEDED IN ACCORDANCE WITH STANDARD SPECIFICATIONS 252 AND 250 RESPECTIVELY.

THE TRAFFIC SIGNAL CONTROLLER EQUIPMENT SHALL BE "ECONOLITE" TO MATCH THE EXISTING ADJACENT SYSTEM.

- LEGEND**
-  CONSTRUCTION WORK ZONE
  -  TEMPORARY PAVEMENT PLACED IN THIS STAGE
  -  DIRECTION OF TRAFFIC
  -  VIDEO DETECTION ZONE

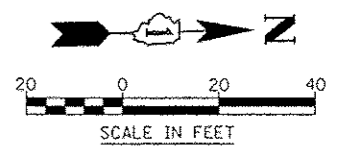
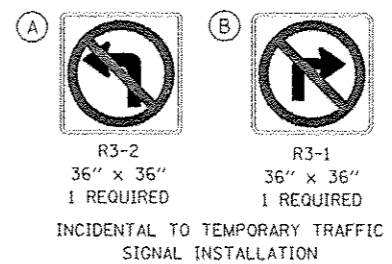

FILE NAME #F11.CLF	USER NAME #USER#	DESIGNED MJM	REVISED	<b>STATE OF ILLINOIS DEPARTMENT OF TRANSPORTATION</b>	<b>TEMPORARY TRAFFIC SIGNAL INSTALLATION MOT STAGE 1A ILLINOIS ROUTE 59 AND I-88 SOUTH RAMPS</b>	F.A.P. RTE.	SECTION	COUNTY	TOTAL SHEETS	SHEET NO.	
		DRAWN KES	REVISED			338	(112 & 113) WRS-5	DUPAGE	963	434	
		CHECKED JCM	REVISED			<b>TS-19</b>			CONTRACT NO. 60131		
		DATE 10/15/2012	REVISED			ILLINOIS FED. AID PROJECT					
					SCALE: AS SHOWN	SHEET NO. 19 OF 53 SHEETS		STA.	TO STA.		