

NOTES:

1. FOR SYMBOL LIST AND GENERAL ELECTRICAL NOTES, SEE SHEET LT-6.
2. EXISTING POLE AND LUMINAIRE SHALL BE REMOVED DURING CONSTRUCTION AND SHALL BE REINSTALLED ON THE SAME FOUNDATION AT THE COMPLETION OF CONSTRUCTION.

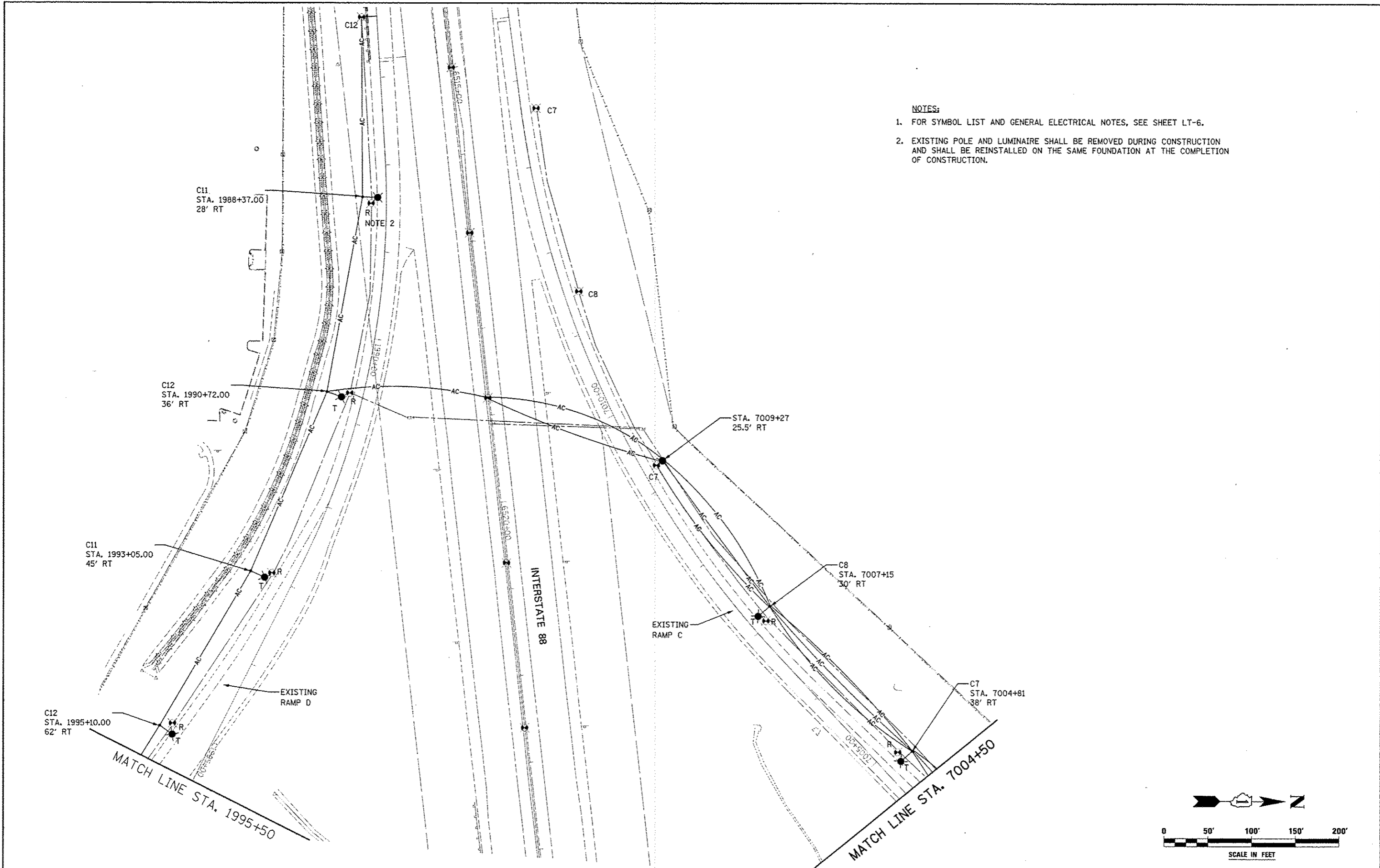

FILE NAME =	USER NAME = USER#	DESIGNED <i>MCP</i>	REVISED -	STATE OF ILLINOIS DEPARTMENT OF TRANSPORTATION	TOLLWAY DEMOLITION AND TEMPORARY LIGHTING PLAN ILLINOIS ROUTE 59 AT INTERSTATE 88 - RAMPS C & D	F.A.P. RTE.	SECTION	COUNTY	TOTAL SHEETS	SHEET NO.	
#FILE#		DRAWN <i>MLB</i>	REVISED -			338	(112 & 113) WRS-5	DUPAGE	963	563	
		CHECKED <i>MCP</i>	REVISED -			LT-08					
		DATE <i>10/15/2012</i>	REVISED -			CONTRACT NO. 60I31					
				ILLINOIS FED. AID PROJECT							