

- LEGEND**
- ① TEMPORARY CONCRETE BARRIER WITH BARRIER WALL MARKERS, TYPE C
  - ② RELOCATE TEMPORARY CONCRETE BARRIER
  - ③ DRUMS AT 50'C-C WITH BIDIRECTIONAL STEADY BURN LIGHTS
  - ④ PAVEMENT MARKING TAPE, TYPE III 4" WHITE
  - ⑤ PAVEMENT MARKING TAPE, TYPE III 4" YELLOW
  - ⑥ PAVEMENT MARKING TAPE, TYPE III 5" WHITE, 10' DASH 30' SKIP
  - ⑦ PAVEMENT MARKING TAPE, TYPE III 8" WHITE
  - ⑧ TEMPORARY PAVEMENT MARKING-LINE 6"
  - ⑨ WORK ZONE PAVEMENT MARKING REMOVAL
  - ⑩ FINAL PAVEMENT MARKINGS, SEE SHEETS
  - ⑪ INSTALLED IN PREVIOUS STAGE
  - ⑫ TEMPORARY PAVEMENT  
TEMP PAVT (INTERSTATE) (HMA BINDER IL-19.0mm), 10"  
HMA SURFACE COURSE, MIX "D", N70 (IL 9.5mm), 2"
- WORKZONE: FULL REHABILITATION  
 WORKZONE: SCARIFICATION AND OVERLAY  
 LANE CLOSED TO TRAFFIC

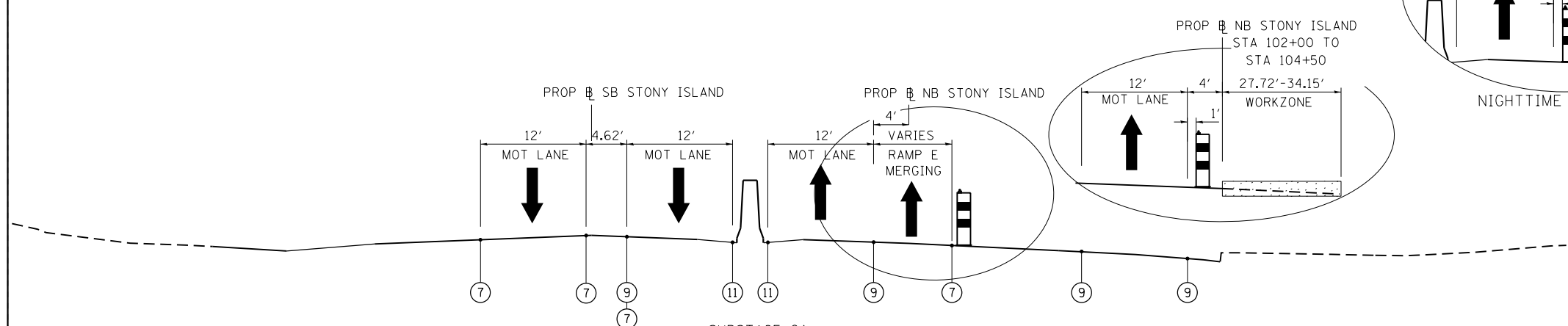
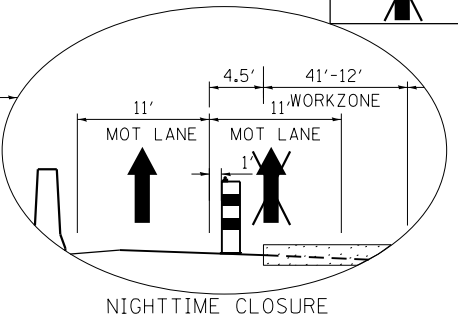
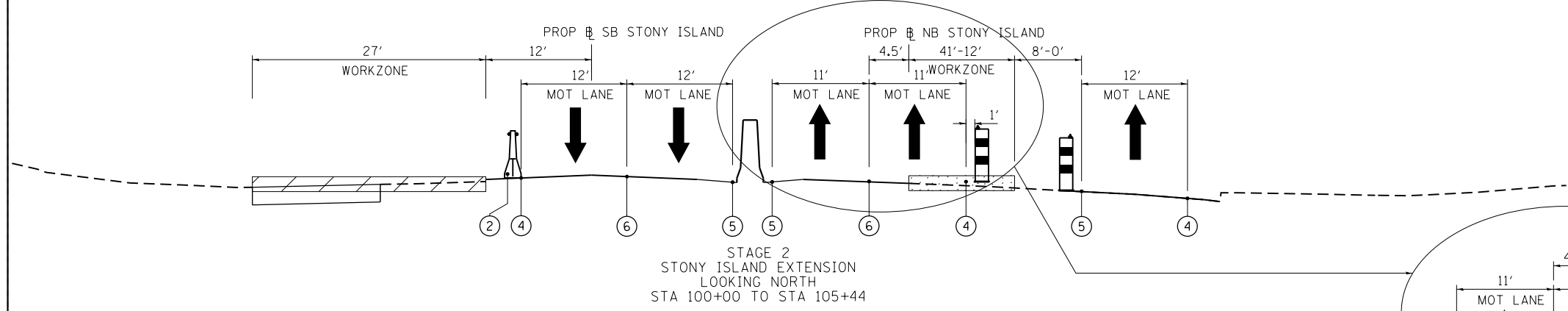
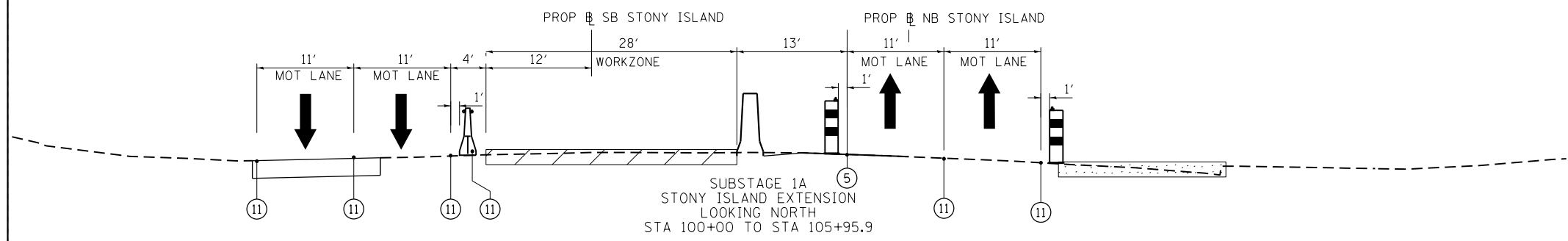

BOWMAN, BARRETT & ASSOCIATES INC.  
CONSULTING ENGINEERS  
Chicago, Illinois  
312.228.0100  
www.bbandainc.com

FILE NAME =	USER NAME = default	DESIGNED - RA	REVISED -
#FILE#		DRAWN - RA	REVISED -
	PLOT SCALE = #SCALE#	CHECKED - RGR	REVISED -
	PLOT DATE = 3/29/2013	DATE - 03/29/2013	REVISED -

**STATE OF ILLINOIS  
DEPARTMENT OF TRANSPORTATION**

**MAINTENANCE OF TRAFFIC - TYPICAL SECTIONS**

SCALE: NA SHEET NO. 6 OF 6 SHEETS STA. NA TO STA. NA

F.A.I. RTE.	SECTION	COUNTY	TOTAL SHEETS	SHEET NO.
94	2012-059-BR	COOK	631	91
ILLINOIS FED. AID PROJECT			CONTRACT NO. 60J12	

S:\1072-05-CADD\0160J12\_Sheets\0160J12-sh1-MOT\_tgn.dgn