

Φ I-94 EB

Φ I-94 WB

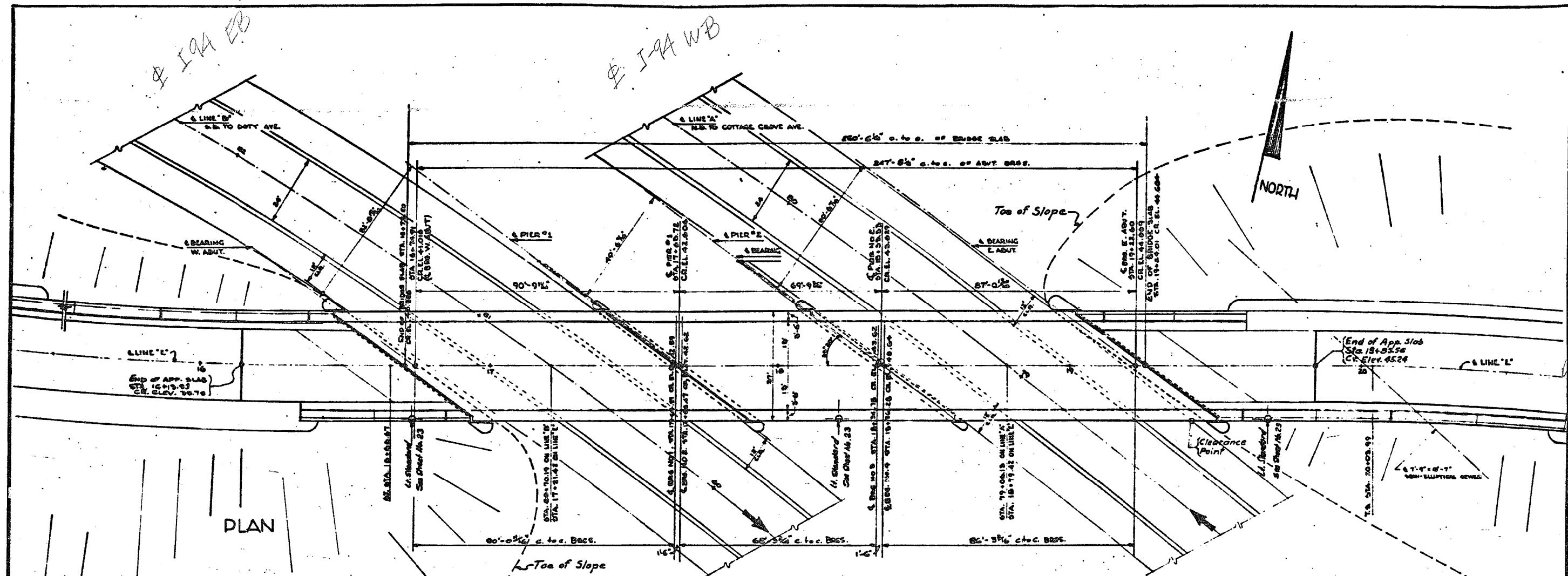

PLAN

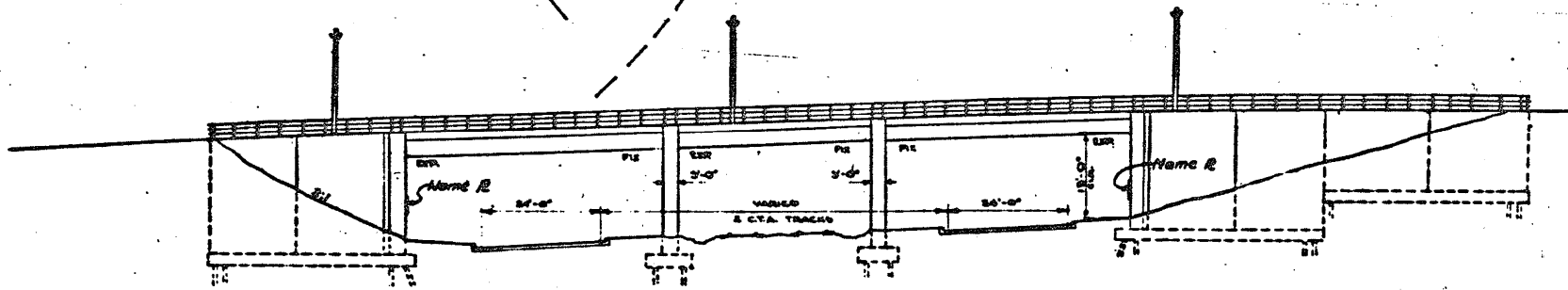

ELEVATION

GENERAL NOTES:

- EXPOSED SURFACES OF CONCRETE ARE TO BE TREATED WITH SILICONES & SEE SPECIAL PROVISIONS.
- ALL PILES IN THE APPROACH SLAB PILE BENT SHALL BE DRIVEN TO ATTAIN A MINIMUM PENETRATION OF 10'-0" INTO A STRATUM OF SOLID MATERIAL, REGARDLESS OF BEARING CAPACITY DEVELOPED.
- FINISHING OF FLOOR SLAB SHALL COMPLY WITH ARTICLE 91.19 OF THE STANDARD SPECIFICATIONS.
- THE COST OF RUBBER WATERSEAL, COPPER NAILS, AND BITUMINOUS PREMOULDED JOINT FILLER SHALL BE INCLUDED IN THE BID PRICE OF CLASS X CONCRETE. THE RUBBER WATERSEAL SPLICES SHALL BE MADE IN ACCORDANCE WITH MANUFACTURERS RECOMMENDATIONS.
- CLASS X CONCRETE SHALL BE USED THROUGHOUT.
- THE CONTRACTOR SHALL ADEQUATELY SUPPORT, BRACE, AND PROTECT THE RUBBER WATERSEAL AND BITUMINOUS PREMOULDED JOINT FILLER DURING CONSTRUCTION, SO THAT THE RUBBER WATERSEAL DOES NOT BECOME BENT, TORN, OR DISTORTED. THE CONTRACTOR'S METHOD OF SUPPORTING, BRACING, AND PROTECTING THE RUBBER WATERSEAL AND BITUMINOUS PREMOULDED JOINT FILLER SHALL BE APPROVED BY THE ENGINEER.
- HOLES FOR PILES IN ABUTMENTS, WINGS AND PIERS & APPROACH SLAB BENT WILL BE PREDRILLED TO ORIGINAL GROUND LINE BEFORE PILES ARE DRIVEN.

DESIGN DATA

DESIGN LOADS	AASHTO MS20-44
DESIGN SPEED	55 MPH
EARTH PRESSURE	20' FLUID
STRUCTURAL STEEL	18,000 psi
REINFORCING BARS	60,000 psi
CONCRETE (COMPRESSIVE STRENGTH)	4,000 psi
CONCRETE (TENSILE STRENGTH)	800 psi
n	10 ; n = 20

DEPARTMENT OF HIGHWAYS
COOK COUNTY, ILLINOIS

DANIEL RYAN
DIRECTOR

WILLIAM J. MORTIMER
SUPERVISOR OF HIGHWAYS

GENERAL PLAN
EAST BOUND STONY ISLAND CONNECTOR
OVER
SOUTH ROUTE EXPRESSWAY

PROJECT 81-05-060-05
SCALE 1/4" = 1'-0"
DATE 10/15/10

CHECKED E.S.C. [Signature]
APPROVED [Signature]

DATE 10/15/10
BY [Signature]
DESCRIPTION [Signature]

F.A.I. 10/15/10
COUNTY 3
SHEET 37
TOTAL SHEETS 52
CONTRACT NO. 4275

REVISIONS		
DATE	BY	DESCRIPTION

2/21/10 PM

3/29/2013

SA1072.05.CADD.Structure.dwg 0162470.CADD Sheets 0162470-60J12-043-FY10.dgn

BOWMAN, BARRETT & ASSOCIATES INC.
CONSULTING ENGINEERS
Chicago, Illinois
312.228.0100
www.bbainc.com

USER NAME =	DESIGNED -	REVISED -
PLOT SCALE =	CHECKED - BAK	REVISED -
PLOT DATE = 03/29/2013	DRAWN -	REVISED -
	CHECKED -	REVISED -

STATE OF ILLINOIS
DEPARTMENT OF TRANSPORTATION

EXISTING PLANS (FOR INFORMATION ONLY)
STRUCTURE NO. 016-2470

SHEET NO. S-43 OF S-53 SHEETS

F.A.I. RTE.	SECTION	COUNTY	TOTAL SHEETS	SHEET NO.
94	2012-059-BR	COOK	631	418
CONTRACT NO. 60J12				

ILLINOIS FED. AID PROJECT