

GENERAL NOTES

Fasteners shall be ASTM A325 Type 1, mechanically galvanized bolts. Bolts 7/8" φ, holes 15/16" φ, unless otherwise noted.

Calculated weight of Structural Steel =

AASHTO M 270 Grade 50 = 481,910 lb.

No field welding is permitted except as specified in the contract documents.

Reinforcement bars designated (E) shall be epoxy coated.

Bearing seat surfaces shall be constructed or adjusted to the designated elevations within a tolerance of 1/8 inch (0.01 ft.). Adjustment shall be made either by grinding the surface or by shimming the bearings.

Concrete Sealer shall be applied to all exposed surfaces of the abutment backwalls, bridge seats, and pile caps, and to all exposed surfaces of the pier.

The existing structural steel coating contains lead. The Contractor shall take appropriate precautions to deal with the presence of lead on this project.

The Organic Zinc Rich Primer / Epoxy / Urethane Paint System shall be used for painting of new structural steel except where otherwise noted. The entire system shall be shop applied, with the exception of the exterior surface and the bottom of the bottom flange of fascia beams, masked off connection surfaces, field installed fasteners and damaged areas, all of which shall be touched up in the field. The color of the final finish coat for all interior steel surfaces shall be Gray, Munsell No. 5B 7/1. The color of the final finish coat for the exterior and bottom flange of the fascia beams shall be Reddish Brown, Munsell No. 2.5YR 3/4.

The concrete for bridge decks finished according to Article 503.16(a) of the Standard Specifications shall be placed and compacted parallel to the skew in uniform increments along centerline of bridge. The machine used for finishing shall be set parallel to the skew for striking off and screeding the concrete.

Slipforming of the parapets is not allowed.

See "Erection of Curved Steel Structures" Special Provision.

INDEX OF SHEETS

S-1	General Plan & Elevation	S-24	Structural Steel Details III
S-2	General Data	S-25	Stage I Deck Pour Temporary Bracing Details
S-3	Construction Staging Details I	S-26	Bearing Details
S-4	Construction Staging Details II	S-27	West Abutment MSE Retaining Wall
S-5	Construction Staging Details III	S-28	East Abutment MSE Retaining Wall
S-6	Temporary Concrete Barrier for Stage Construction	S-29	MSE Retaining Wall Details
S-7	Top of Slab Elevations Layout	S-30	Substructure Removal Details
S-8	Top of Slab Elevations I	S-31	West Abutment Plan and Elevation
S-9	Top of Slab Elevations II	S-32	West Abutment Sections and Details
S-10	Top of Approach Slab Elevations	S-33	West Abutment Bill of Materials
S-11	Superstructure Plan and Cross Section	S-34	East Abutment Plan and Elevation
S-12	Superstructure Details I	S-35	East Abutment Sections and Details
S-13	Superstructure Details II	S-36	East Abutment Bill of Materials
S-14	West Bridge Approach Slab Details I	S-37	Pier Details I
S-15	West Bridge Approach Slab Details II	S-38	Pier Details II
S-16	East Bridge Approach Slab Details I	S-39	Metal Shell Pile Details
S-17	East Bridge Approach Slab Details II	S-40	Bar Splicer Assembly and Mechanical Splicer Details
S-18	Preformed Joint Strip Seal	S-41	Soil Boring Logs I
S-19	Drainage Scupper, DS-33	S-42	Soil Boring Logs II
S-20	Drainage System Details	S-43	Soil Boring Logs III
S-21	Framing Plan	S-44	Soil Boring Logs IV
S-22	Structural Steel Details I	S-45 thru	
S-23	Structural Steel Details II	S-63	Existing Plans (For Information Only)

TOTAL BILL OF MATERIAL

ITEM	UNIT	SUPER	SUB	TOTAL
Removal of Existing Structures No. 2	Each	1	-	1
Protective Shield	Sq Yd	960	-	960
Structure Excavation	Cu Yd	-	2,342	2,342
Removal and Disposal of Unsuitable Material for Structures	Cu Yd	-	515	515
Concrete Structures	Cu Yd	35.5	331.8	367.3
Concrete Superstructure	Cu Yd	413.5	-	413.5
Bridge Deck Grooving	Sq Yd	1,014	-	1,014
Protective Coat	Sq Yd	1,374	-	1,374
Furnishing and Erecting Structural Steel	L Sum	0.45	-	0.45
Stud Shear Connectors	Each	4,677	-	4,677
Reinforcement Bars, Epoxy Coated	Pound	104,330	32,810	137,140
Bar Splicers	Each	948	167	1,115
Furnishing Metal Shell Piles 12" X 0.250"	Foot	-	2,418	2,418
Driving Piles	Foot	-	2,418	2,418
Test Pile Metal Shells	Each	-	3	3
Name Plates	Each	1	-	1
Preformed Joint Strip Seal	Foot	112	-	112
Elastomeric Bearing Assembly, Type I	Each	12	-	12
Anchor Bolts 3/4"	Each	24	-	24
Anchor Bolts 1/2"	Each	12	-	12
Concrete Sealer	Sq Ft	-	2,935	2,935
Drainage Scuppers, DS-33	Each	1	-	1
Drainage System	L Sum	-	0.5	0.5
Mechanically Stabilized Earth Retaining Wall	Sq Ft	-	4,290	4,290
Temporary Soil Retention System	Sq Ft	-	2,420	2,420
Temporary Mechanically Stabilized Earth Retaining Wall	Sq Ft	-	2,680	2,680

STATION 215+62.94
 BUILT 20 BY
 STATE OF ILLINOIS
 F.A.I. RT. 94 SEC. 2012-059-BR
 LOADING HL-93
 STRUCTURE NO. 016-2471

NAME PLATE
 See Std. 515001

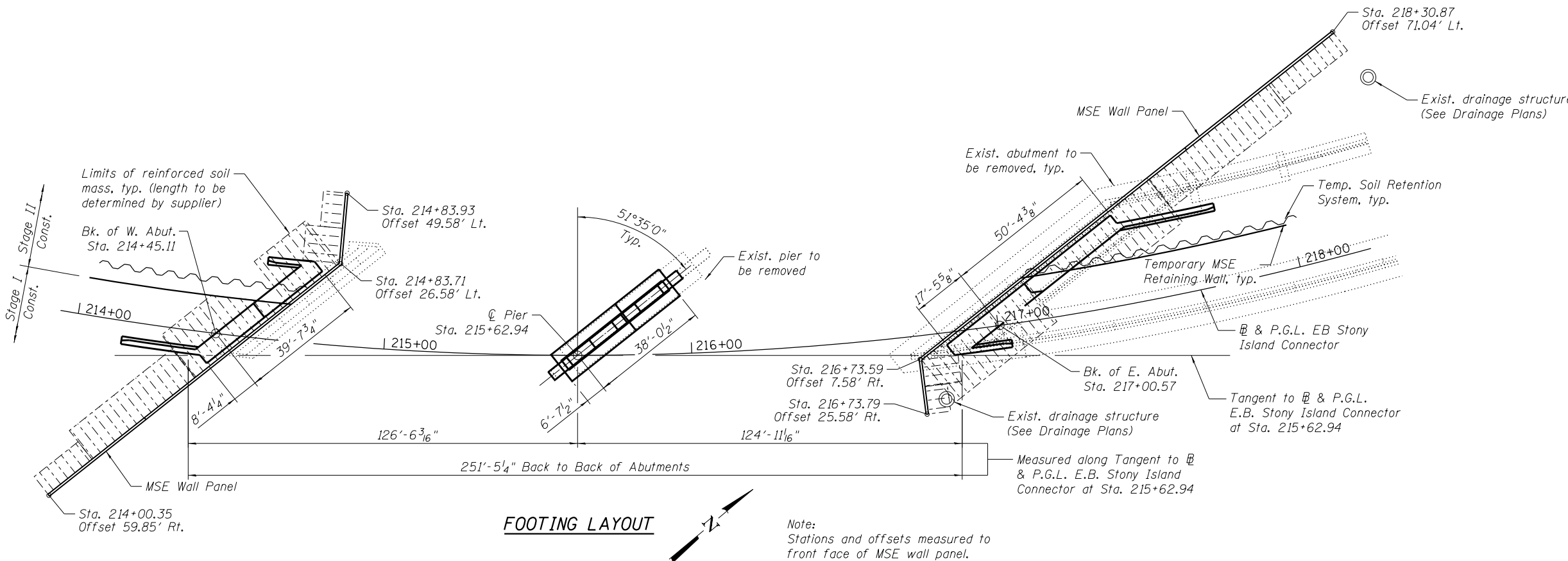

12:29:24 PM

5/2/2013

S:\1072_05_CADD\Structure\1 SN 0162471\CADD Sheets\0162471-60112-002-001.dgn

BOWMAN, BARRETT & ASSOCIATES INC.
 CONSULTING ENGINEERS
 Chicago, Illinois
 312.228.0100
 www.bbainc.com

USER NAME =	DESIGNED - IYL	REVISED -
PLOT SCALE =	CHECKED - BAK	REVISED -
PLOT DATE = 03/29/2013	DRAWN - TL	REVISED -
	CHECKED - BAK	REVISED -

STATE OF ILLINOIS
 DEPARTMENT OF TRANSPORTATION

GENERAL DATA
 STRUCTURE NO. 016-2471

SHEET NO. S-2 OF S-63 SHEETS

F.A.I. RTE.	SECTION	COUNTY	TOTAL SHEETS	SHEET NO.
94	2012-059-BR	COOK	631	495
CONTRACT NO. 60J12				
ILLINOIS FED. AID PROJECT				