

Notes:
 See Sheet S-8 for Sections C-C & D-D.
 a(E) and a₁(E) bar spacings measured along \varnothing Line C or Line D.
 The joint opening shall be determined per Article 520.04 of the
 Std. Specifications. The minimum dimension shall be 1/2" for installation
 purposes.

MINIMUM BAR LAP

#4 bar = 2'-11"
 #5 bar = 3'-3"

Preformed Flexible Foam Expansion Joint
 Filler according to Article 1051.09 of the
 Std. Specifications, full depth of slab,
 approach footing and PCC shoulder, full
 length of parapet, each side.

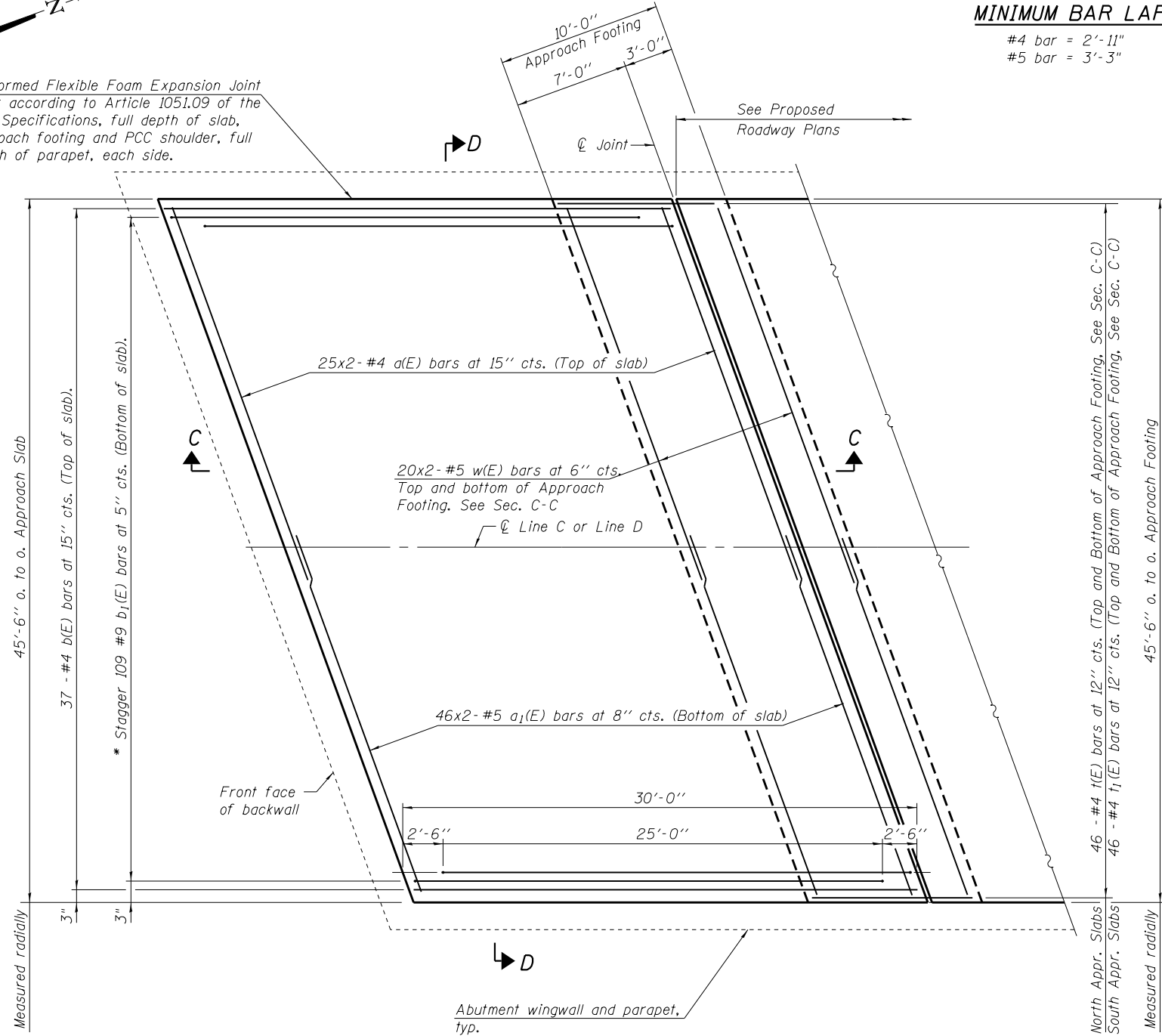

PLAN

(North Appr. Slabs shown, South Appr. Slabs similar)

* Tilt #9 b₁(E) bars as required to maintain clearance.

2:54:57 PM

3/29/2013

S:\1072_05_CADD\Structure\1\SN_0162441_2442\CADD Sheets\0162441-2442-60J12-007-4501.dgn

BOWMAN, BARRETT & ASSOCIATES INC.
 CONSULTING ENGINEERS
 Chicago, Illinois
 312.228.0100
 www.bbainc.com



USER NAME =	DESIGNED - JGC	REVISED -
	CHECKED - BAK	REVISED -
PLOT SCALE =	DRAWN - JGC	REVISED -
PLOT DATE = 03/29/2013	CHECKED - BAK	REVISED -

STATE OF ILLINOIS
 DEPARTMENT OF TRANSPORTATION

BRIDGE APPROACH SLAB DETAILS I
 STRUCTURE NOS. 016-2441 & 016-2442

SHEET NO. S-7 OF S-31 SHEETS

F.A.I. RTE.	SECTION	COUNTY	TOTAL SHEETS	SHEET NO.
94	2012-059-BR	COOK	631	563
CONTRACT NO. 60J12				

ILLINOIS FED. AID PROJECT