

COUNTY PROGRAM		SHEET
ITEM No.	YEAR	No.

ALL DIMENSIONS GIVEN ARE HORIZONTAL ON & OF BEARINGS

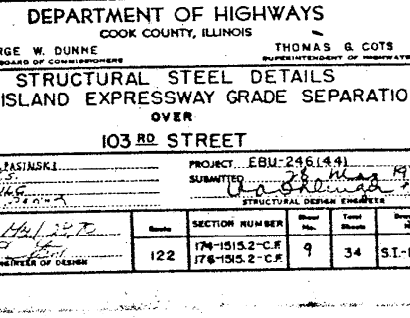
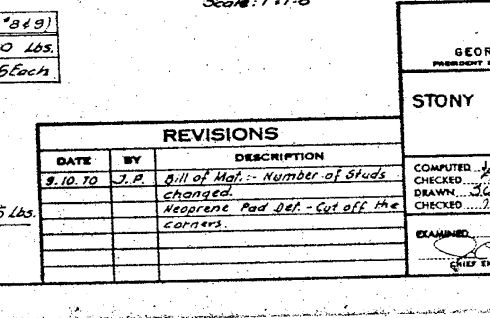
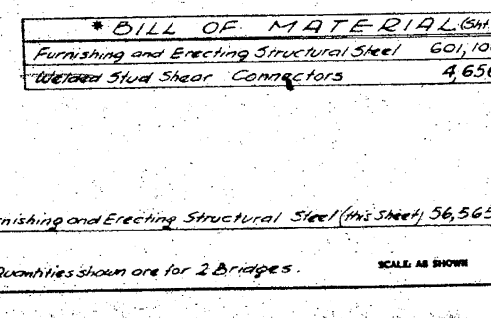
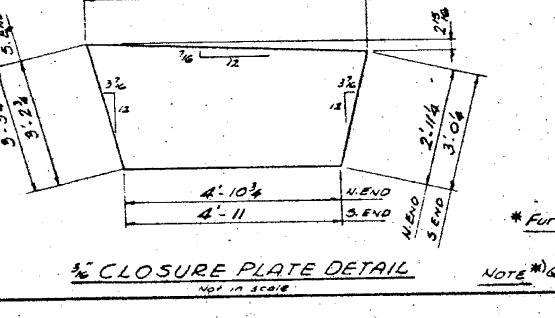
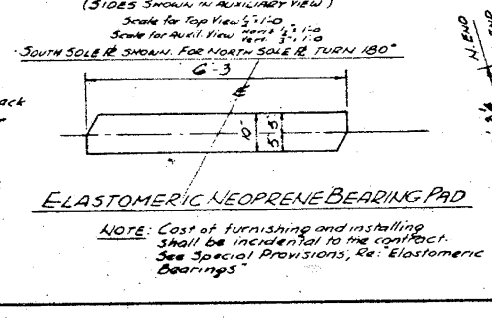
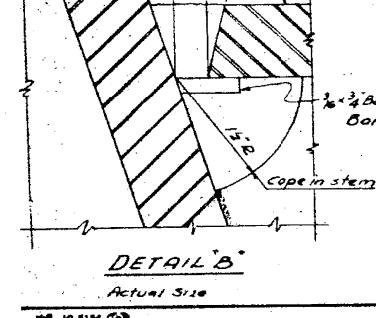
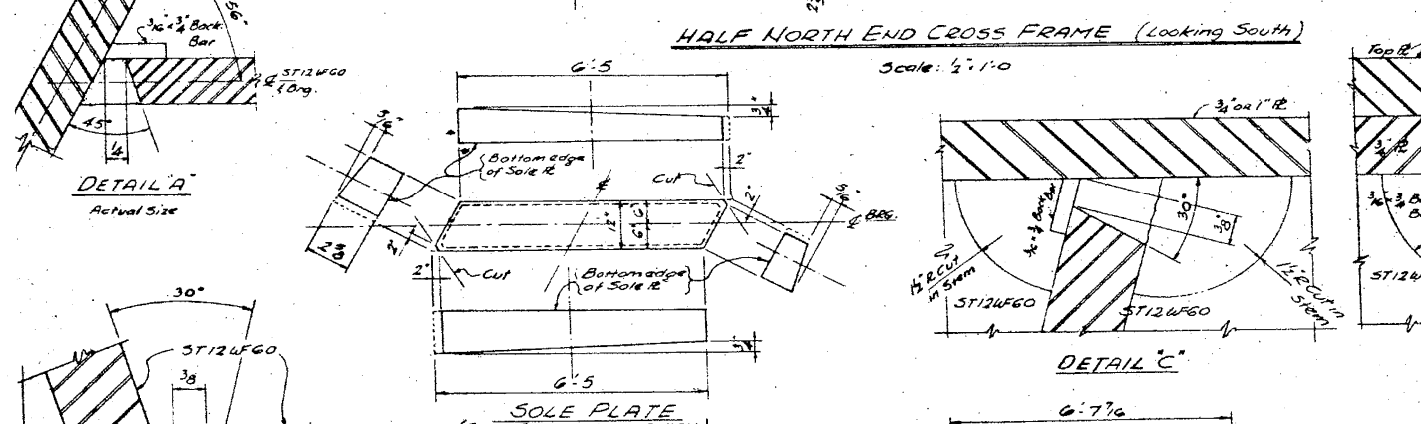
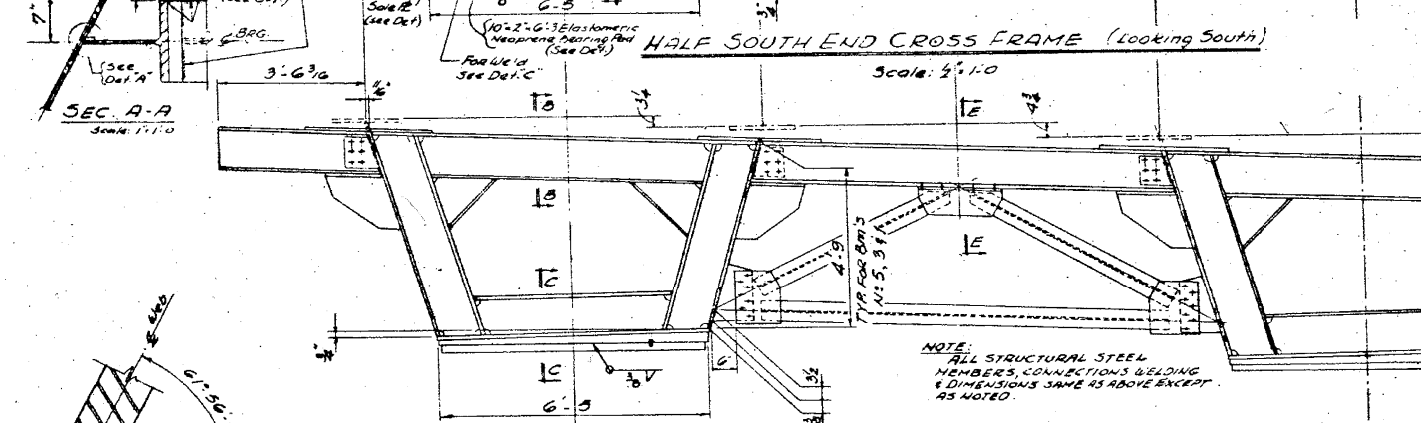
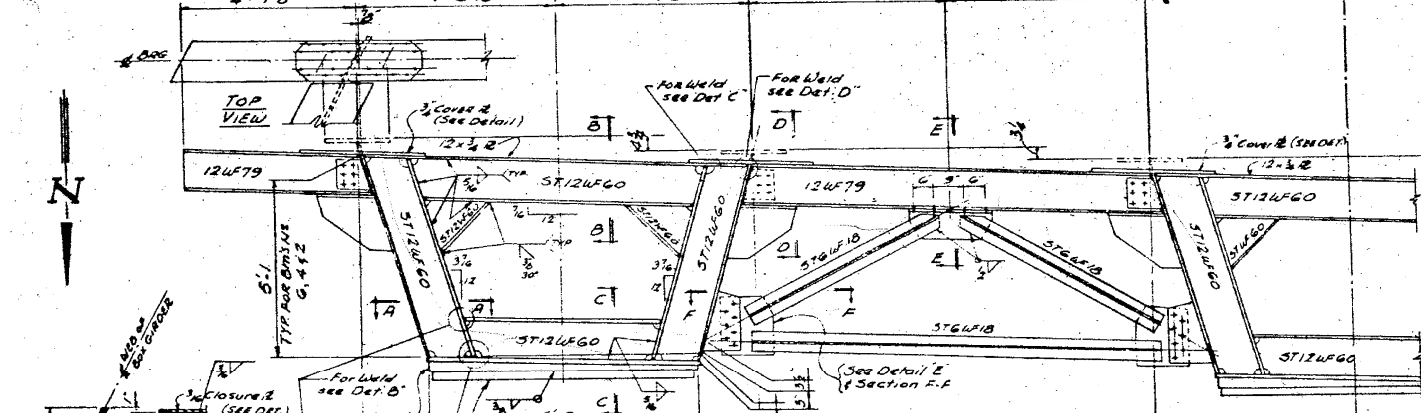

* BILL OF MATERIAL (Sh. # 849)
Furnishing and Erecting Structural Steel 601,100 LBS.
Welded Stud Shear Connectors 4,656 Each

* Furnishing and Erecting Structural Steel (this sheet) 56,565 LBS.

NOTE: Quantities shown are for 2 Bridges.

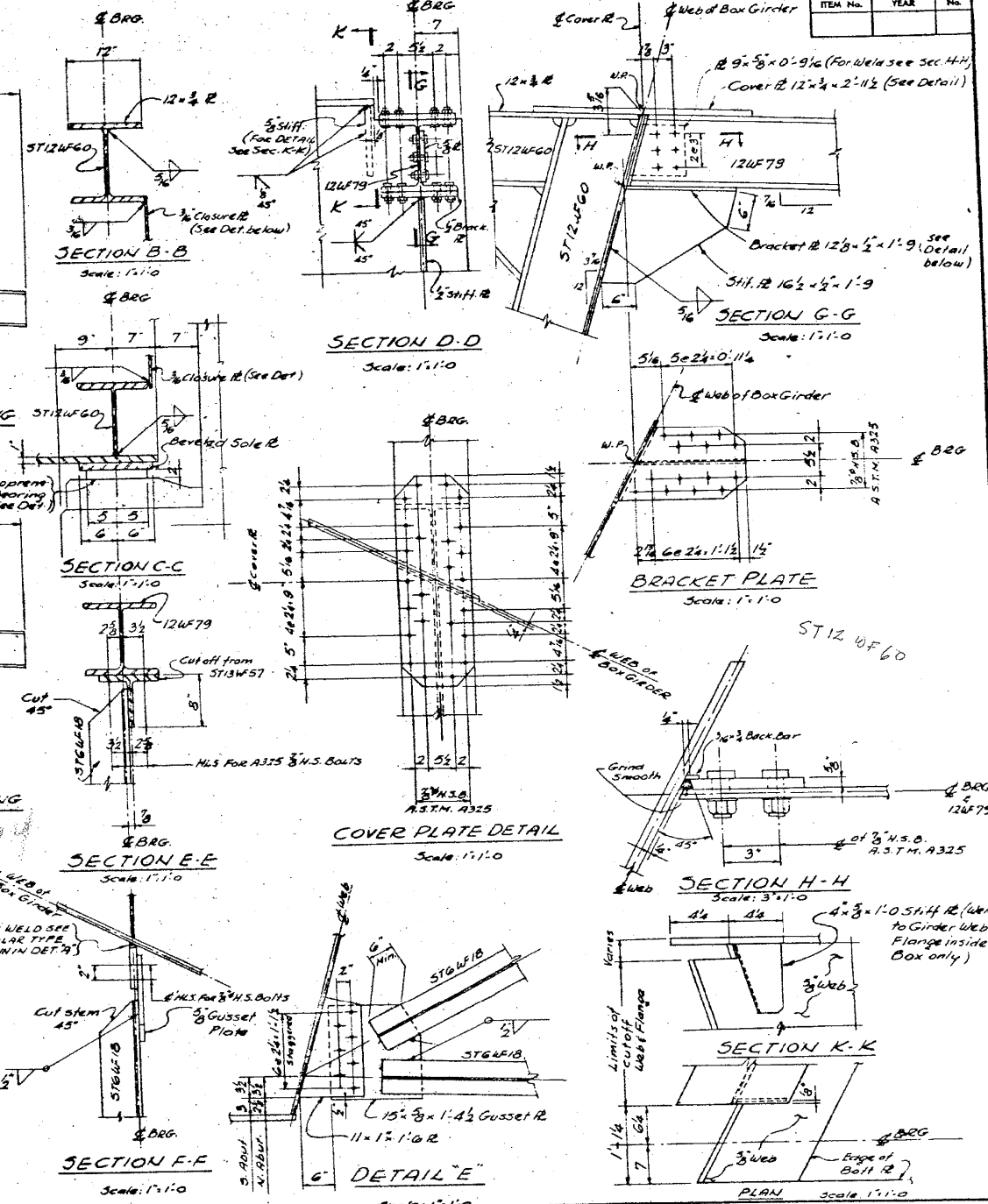

REVISIONS		
DATE	BY	DESCRIPTION
9.10.10	J.P.	Bill of Mat. - Number of Studs changed.
		Neoprene Pad Det. - Cut off the corners.

DEPARTMENT OF HIGHWAYS COOK COUNTY, ILLINOIS		THOMAS & GOTS SUPERINTENDENT OF HIGHWAYS	
STRUCTURAL STEEL DETAILS STONY ISLAND EXPRESSWAY GRADE SEPARATION OVER 103 RD STREET			
COMPUTED BY J. JASINSKI	PROJECT EBU: 246(144)		
CHECKED BY J. P.	SUBMITTED BY J. P.		
DRAWN BY J. P.	DATE 9/28/10		
CHECKED BY J. P.	SCALE 1/2"=1'-0"		
EXAMINED BY H. J. P.	SECTION NUMBER 122	TOTAL SHEETS 34	SHEET NO. 34
CHIEF ENGINEER OF DESIGN	174-1515.2-C.F.	9	34
	176-1515.2-C.F.		SI-14

255529 PM

3/29/2013

SA:1072.05.CADD.S-Structural-SN 0162441.2442.CADD Sheets 062441-2442-66112-021-F104.dgn

BOWMAN, BARRETT & ASSOCIATES INC.
CONSULTING ENGINEERS
Chicago, Illinois
312.228.0100
www.bbainc.com

USER NAME =
DESIGNED -
CHECKED - BAK
DRAWN -
PLOT SCALE =
PLOT DATE = 03/29/2013

DESIGNED -
CHECKED -
DRAWN -
PLOT DATE = 03/29/2013

REVISIONS
REVISOR -
DATE -
REVISIONS
REVISOR -
DATE -

STATE OF ILLINOIS
DEPARTMENT OF TRANSPORTATION

EXISTING PLANS (FOR INFORMATION ONLY)
STRUCTURE NOS. 016-2441 & 016-2442
SHEET NO. S-21 OF S-31 SHEETS

F.A.I. RTE.	SECTION	COUNTY	TOTAL SHEETS	SHEET NO.
94	2012-059-BR	COOK	631	577
CONTRACT NO. 60J12				
ILLINOIS FED. AID PROJECT				