

** CONCRETE MEDIAN AND CURB & GUTTER REMOVAL AND THE CONSTRUCTION OF TEMP. PAVEMENT SHALL BE DONE AS A PRESTAGE USING STANDARD 701606 BEFORE STAGE I CONSTRUCTION. COST INCLUDED IN "TRAFFIC CONTROL AND PROTECTION (SPECIAL)".

COST OF TEMPORARY REMOVAL OR RELOCATION OF EXISTING SIGNS IS INCLUDED IN COST OF "TRAFFIC CONTROL AND PROTECTION (SPECIAL)".

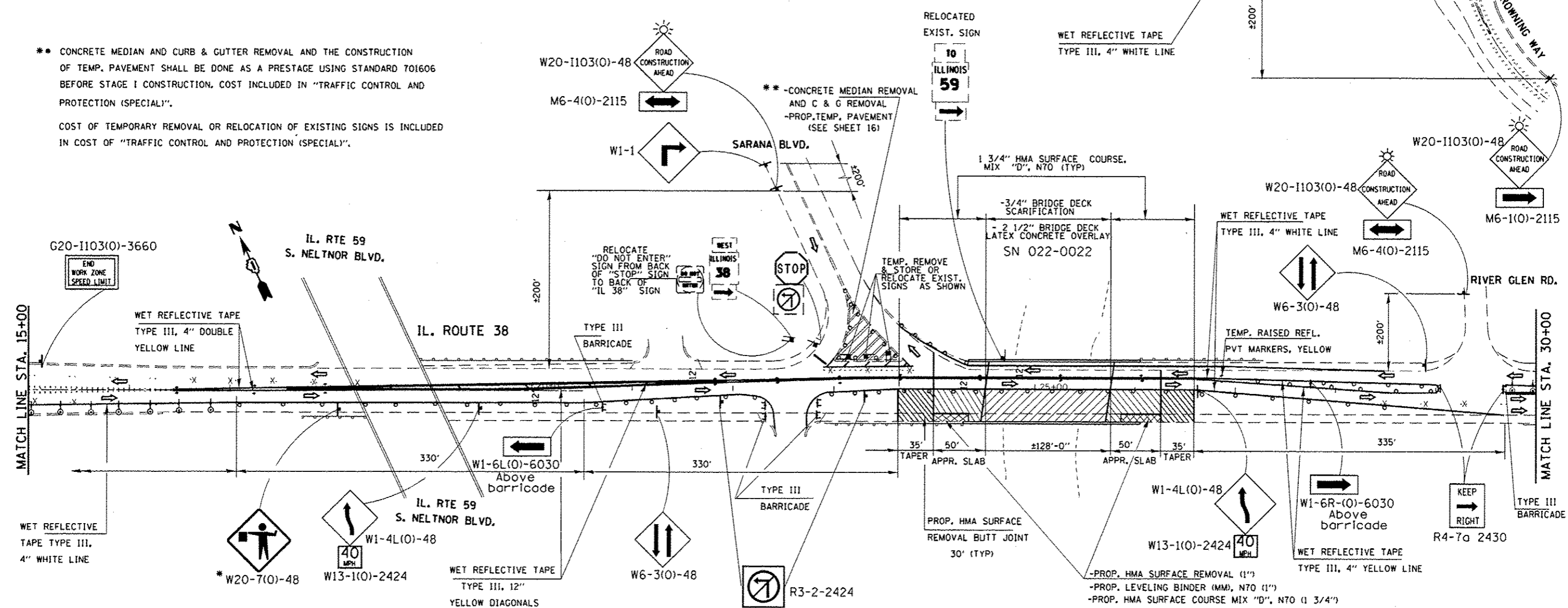

* MUST BE REMOVED WHEN FLAGGER IS NOT PRESENT FOR MORE THAN ONE HOUR

REVISION A.G. 05/22/2013

FILE NAME *	USER NAME * gorenautab	DESIGNED -	REVISED -	STATE OF ILLINOIS DEPARTMENT OF TRANSPORTATION	IL 38 (ROOSEVELT RD) AT WEST BRANCH DUPAGE RIVER TRAFFIC CONTROL PLAN, STAGE I (SN 022-0022)	F.A.P. RTE.	SECTION	COUNTY	TOTAL SHEETS	SHEET NO.	
ei:\p\work\p\widot\gorenautab\d8273151\162311-shrt-plan.dgn	162311-shrt-plan.dgn	DRAWN -	REVISED -			347	2011-067-1	DUPAGE	29	15	
PLOT SCALE * 97.2723 / 1 in.		CHECKED -	REVISED -			CONTRACT NO. 60P86					
PLOT DATE * 5/24/2013		DATE -	REVISED -			ILLINOIS FED. AID PROJECT					