

NOTE:
 ISLAND MEDIAN TO BE CONSTRUCTED USING TRAFFIC STANDARD 701606,
 COST INCLUDED IN "TRAFFIC CONTROL AND PROTECTION (SPECIAL)".

* EXISTING SIGNS TO BE PLACED BACK TO THEIR ORIGINAL LOCATIONS, EXCEPT
 "DO NOT ENTER" SIGN SHALL BE RELOCATED FROM BACK OF "STOP" SIGN
 TO BACK OF "IL 38" SIGN.

POLYUREA PVT MARKING
 TYPE I, 4" SKIP-DASH LINE,
 WHITE, 10' LONG, 30' SPACE

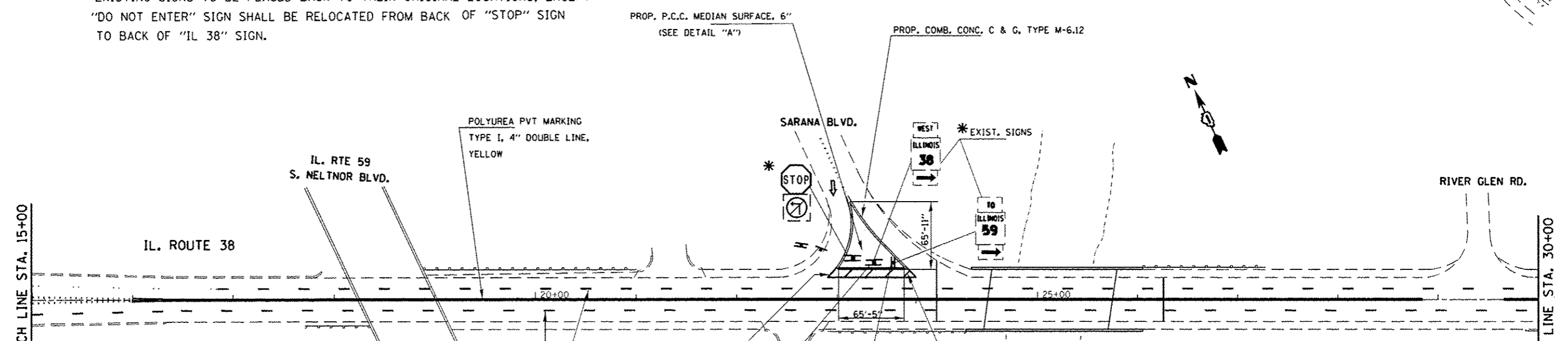

DETAIL "A"

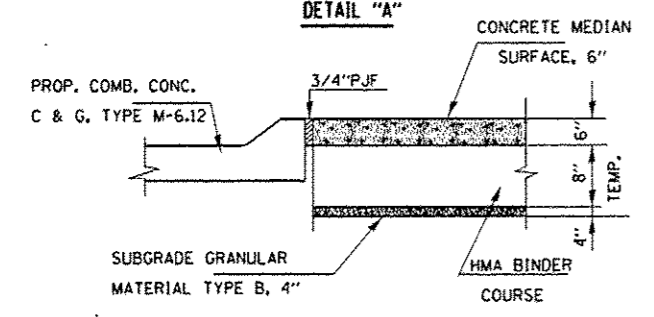

REVISÉ A.G. 05/22/2013

FILE NAME : c:\pwork\pwidot\gorangautab\027315\162311-shi-plan.dgn	USER NAME : gorangautab	DESIGNED - DRAWN -	REVISED - REVISED -	STATE OF ILLINOIS DEPARTMENT OF TRANSPORTATION	IL 38 (ROOSEVELT RD) AT WEST BRANCH DUPAGE RIVER FINAL PAVEMENT MARKING PLAN (SN 022-0022)	F.A.P. RTE. 347	SECTION 2011-067-1	COUNTY DUPAGE	TOTAL SHEETS 29	SHEET NO. 21		
PLOT SCALE * 1/8"=0'00" / 1"=10'	CHECKED - DATE -	REVISED - REVISED -	SCALE:			SHEET NO. OF SHEETS	STA. TO STA.	CONTRACT NO. 60P86 ILLINOIS FED. AID PROJECT				
PLOT DATE * 5/24/2013	DATE -	REVISED -										