

PROPOSED HOT-MIX ASPHALT SURFACE REMOVAL, 2 1/2"
 PROPOSED POLYMERIZED HOT-MIX ASPHALT SURFACE COURSE, MIX "F", N90, 1 3/4"
 PROPOSED POLYMERIZED LEVELING BINDER (MACHINE METHOD), IL-4.75, N50, 3/4"

LEGEND	
① THERMOPLASTIC PAVEMENT MARKING 6" SOLID WHITE LINE	⑧ THERMOPLASTIC PAVEMENT MARKING 4" YELLOW SKIP DASH MEDIAN LINE
② THERMOPLASTIC PAVEMENT MARKING 24" WHITE STOP BAR OR CROSS WALK*	⑨ POLYUREA PAVEMENT MARKING TYPE I 8" WHITE GORE LINE
③ THERMOPLASTIC PAVEMENT MARKING 6" WHITE DOTTED EXTENSION	⑩ POLYUREA PAVEMENT MARKING TYPE I 4" WHITE SKIP DASH LANE LINE
④ THERMOPLASTIC PAVEMENT MARKING 4" SOLID DOUBLE YELLOW	⑪ POLYUREA PAVEMENT MARKING TYPE I 24" WHITE STOP BAR OR CROSS WALK
⑤ THERMOPLASTIC PAVEMENT MARKING 4" WHITE SKIP DASH LANE LINE	⑫ POLYUREA PAVEMENT MARKING TYPE I 12" WHITE CHEVRONS
⑥ THERMOPLASTIC PAVEMENT MARKING 12" SOLID YELLOW DIAGONAL LINE	⑬ POLYUREA PAVEMENT MARKING TYPE I 4" SOLID YELLOW SINGLE LINE
⑦ THERMOPLASTIC PAVEMENT MARKING WHITE LETTERS & SYMBOLS	⑭ POLYUREA PAVEMENT MARKING TYPE I 12" SOLID YELLOW DIAGONALS
	⑮ POLYUREA PAVEMENT MARKING TYPE I 4" SOLID DOUBLE YELLOW

* REFER TO STD. TC-24 CROSSWALK BAR DIMENSION AND SPACING.
 NOTE: CROSSWALK BARS 8' LONG ON MAINLINE AND MAJOR SIDEROADS. CROSSWALK BARS 6' LONG ON MINOR SIDEROADS.

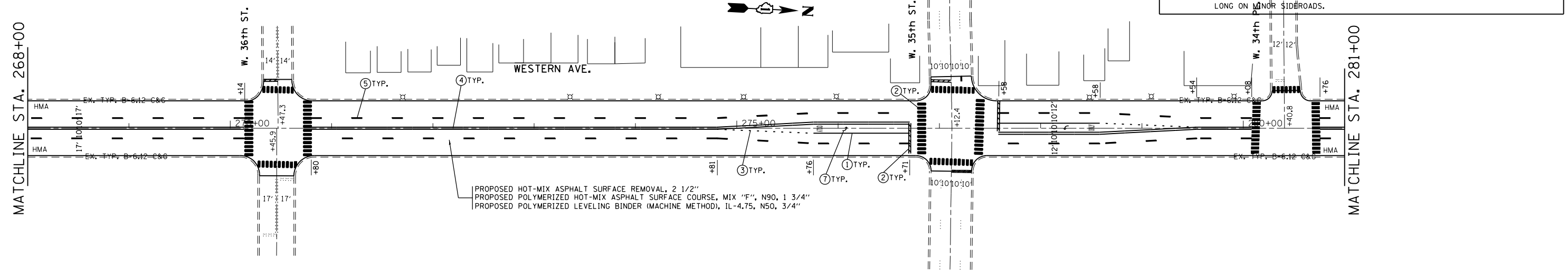

PROPOSED HOT-MIX ASPHALT SURFACE REMOVAL, 2 1/2"
 PROPOSED POLYMERIZED HOT-MIX ASPHALT SURFACE COURSE, MIX "F", N90, 1 3/4"
 PROPOSED POLYMERIZED LEVELING BINDER (MACHINE METHOD), IL-4.75, N50, 3/4"

NOTE:
 CONCRETE BUS PAD SHALL NOT BE RESURFACED.

FILE NAME =	USER NAME = abreueh	DESIGNED -	REVISED -	STATE OF ILLINOIS DEPARTMENT OF TRANSPORTATION	WESTERN AVE. (COLOMBUS DR. TO 34th ST.)				F.A.P. RTE.	SECTION	COUNTY	TOTAL SHEETS	SHEET NO.		
ci:\pw\work\p\idot\obreueh\0282900\0104\212-sh1-plan.dgn		DRAWN -	REVISED -		SCALE: 1"=50'	SHEET	OF	SHEETS	STA. 253+00	TO STA. 281+00	370	2011-089-RS	COOK	30	16
		CHECKED -	REVISED -						CONTRACT NO. 60R16						
		DATE -	REVISED -						ILLINOIS FED. AID PROJECT						