

PROPOSED P.C.C. ISLAND:

TOTAL STANDARD B-6-12 C&G - 77 L.F.  
TOTAL DEPRESSED B-6-12 C&G - 18 L.F.  
TOTAL DETECTABLE WARNINGS - 35 S.F.  
TOTAL P.C.C. SIDEWALK, 5" - 117 S.F.  
TOTAL CORG. MEDIAN SURFACE, 4" - 294 S.F.

CORRUGATED P.C.C. MEDIAN - 92 S.F.

THERMOPLASTIC PAVEMENT MARKING LINE, 4" YELLOW - 29 L.F.

THERMOPLASTIC PAVEMENT MARKING LINE, 24" WHITE - 53 L.F.

PROPOSED P.C.C. SIDEWALK, 5" - 60 S.F.

PROPOSED DETECTABLE WARNINGS - 18 S.F.

PROPOSED P.C.C. SIDEWALK, 5" - 59 S.F.

PROPOSED DETECTABLE WARNINGS - 18 S.F.

PROPOSED STANDARD CONC. CURB AND GUTTER, TYPE B-6-12 - 26 L.F.  
PROPOSED DEPRESSED CONC. CURB AND GUTTER, TYPE B-6-12 - 13 L.F.

CLASS D PATCH, 12" - 4.4 S.Y.

THERMOPLASTIC PAVEMENT MARKING LINE, 4" YELLOW - 38 L.F.

CORRUGATED P.C.C. MEDIAN - 126 S.F.

THERMOPLASTIC PAVEMENT MARKING LINE, 24" WHITE - 66 L.F.

THERMOPLASTIC PAVEMENT MARKING LINE, 24" WHITE - 23 L.F.

THERMOPLASTIC PAVEMENT MARKING LINE, 6" WHITE - 229 L.F.

PROPOSED DEPRESSED CONC. CURB AND GUTTER, TYPE B-6-12 - 5 L.F.

THERMOPLASTIC PAVEMENT MARKING LINE, 12" WHITE - 176 L.F.

CLASS D PATCH, 12" - 11.2 S.Y.

THERMOPLASTIC PAVEMENT MARKING LINE, 12" WHITE - 200 L.F.

THERMOPLASTIC PAVEMENT MARKING LINE, 24" WHITE - 60 L.F.

PROPOSED P.C.C. SIDEWALK, 5" - 92 S.F.

THERMOPLASTIC PAVEMENT MARKING LINE, 24" WHITE - 22 L.F.

THERMOPLASTIC PAVEMENT MARKING LINE, 12" WHITE - 42 L.F.  
(SEE DETAIL "A")  
PROPOSED DETECTABLE WARNINGS - 10 S.F.

PROPOSED STANDARD CONC. CURB AND GUTTER, TYPE B-6-12 - 14 L.F.  
PROPOSED DEPRESSED CONC. CURB AND GUTTER, TYPE B-6-12 - 5 L.F.

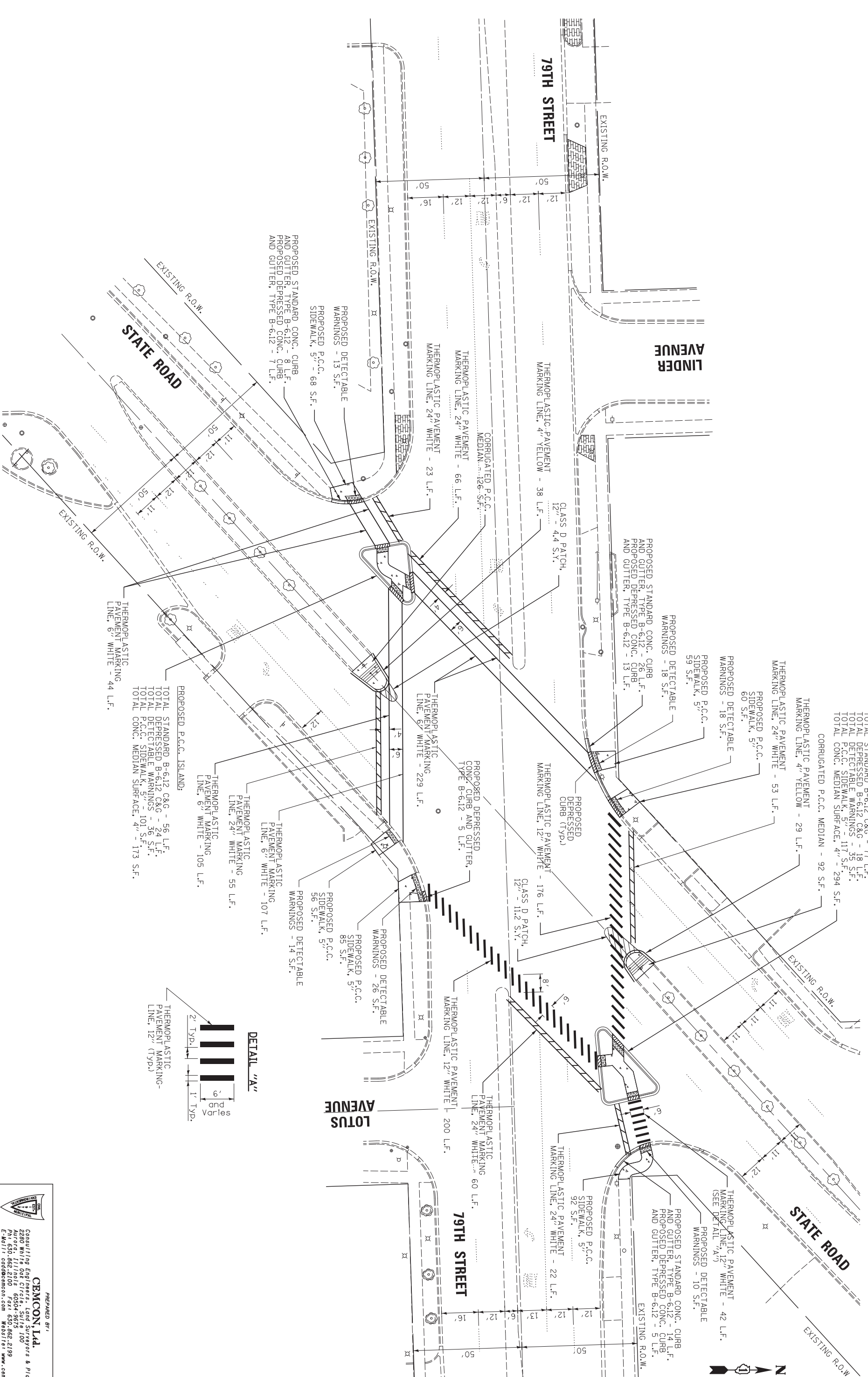

PROPOSED STANDARD CONC. CURB AND GUTTER, TYPE B-6-12 - 8 L.F.  
PROPOSED DEPRESSED CONC. CURB AND GUTTER, TYPE B-6-12 - 7 L.F.

PROPOSED P.C.C. SIDEWALK, 5" - 68 S.F.

PROPOSED DETECTABLE WARNINGS - 13 S.F.

THERMOPLASTIC PAVEMENT MARKING LINE, 6" WHITE - 44 L.F.

TOTAL STANDARD B-6-12 C&G - 56 L.F.  
TOTAL DEPRESSED B-6-12 C&G - 24 L.F.  
TOTAL DETECTABLE WARNINGS - 36 S.F.  
TOTAL P.C.C. SIDEWALK, 5" - 101 S.F.  
TOTAL CONC. MEDIAN SURFACE, 4" - 173 S.F.

PROPOSED P.C.C. ISLAND:

THERMOPLASTIC PAVEMENT MARKING LINE, 6" WHITE - 105 L.F.

THERMOPLASTIC PAVEMENT MARKING LINE, 24" WHITE - 55 L.F.

THERMOPLASTIC PAVEMENT MARKING LINE, 6" WHITE - 107 L.F.

PROPOSED DETECTABLE WARNINGS - 14 S.F.

PROPOSED P.C.C. SIDEWALK, 5" - 85 S.F.

PROPOSED DETECTABLE WARNINGS - 26 S.F.

PROPOSED P.C.C. SIDEWALK, 5" - 56 S.F.

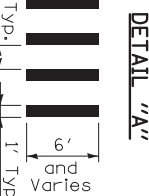

FILE NAME =	USER NAME = JGC
\\MICROST\382104\79TH & STATE GEO.DWG	DESIGNED - KK
	DRAWN - RDS/JGC
	CHECKED - BPT
	DATE - 12-6-12

DESIGNED - KK	REVISID -
DRAWN - RDS/JGC	REVISID -
CHECKED - BPT	REVISID -
DATE - 12-6-12	REVISID -

REVISID -	REVISID -
REVISID -	REVISID -
REVISID -	REVISID -
REVISID -	REVISID -

STATE OF ILLINOIS  
DEPARTMENT OF TRANSPORTATION

SCALE: 1"=20'  
SHEET NO. OF SHEETS STA. TO STA.

F.A.U. RTE. 1548	SECTION (461-Y) TS	COUNTY	TOTAL SHEETS 24	SHEET NO. 14
FED. ROAD DIST. NO. ILLINOIS FED. AID PROJECT		CONTRACT NO. 60T94		

PREPARED BY:

**CEMCON, Ltd.**  
Consulting Engineers, Land Surveyors & Planners  
4601 North Lincoln Street, Suite 100  
Chicago, Illinois 60630-4975  
Ph: 630.862.2100 Fax: 630.862.2199  
E-Mail: cadd@cemcon.com Website: www.cemcon.com