

TEMPORARY VIDEO DETECTION  
DETAIL  
(NOT TO SCALE)

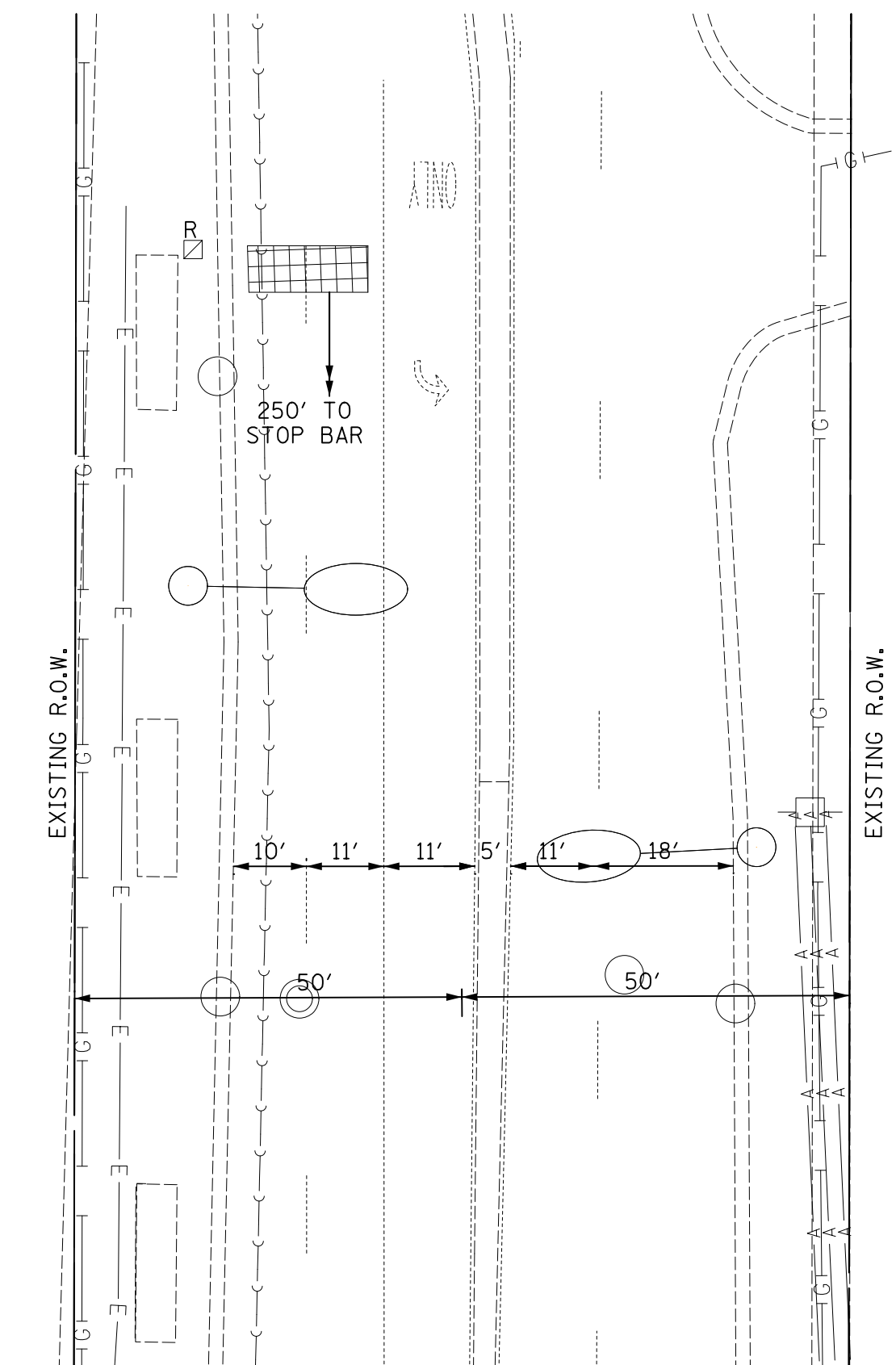

MATCH LINE A

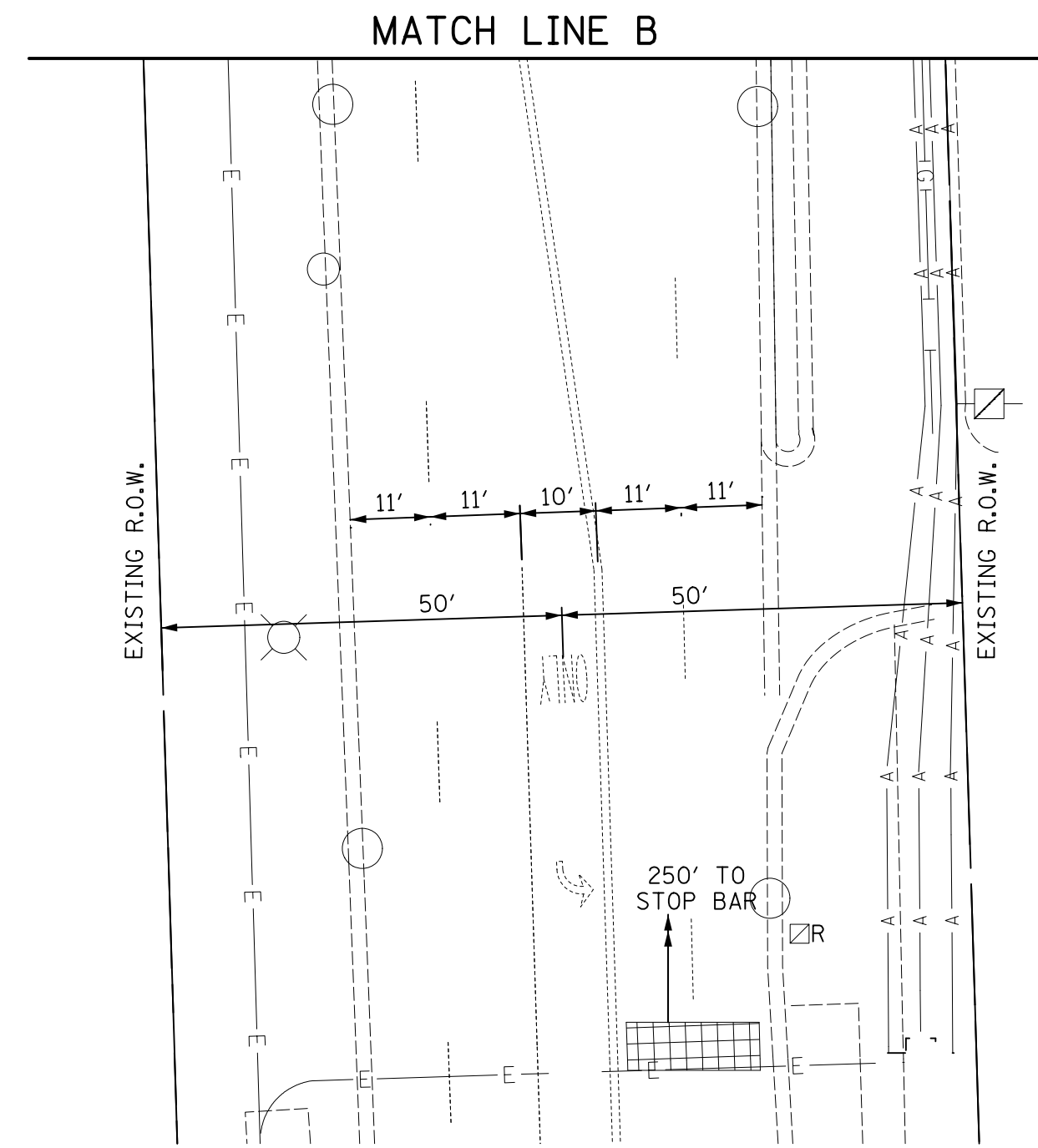

MATCH LINE B

THE FOLLOWING ITEMS SHALL BE REMOVED BY THE CONTRACTOR AND SHALL BE DISPOSED OF BY THEM OUTSIDE THE RIGHT-OF-WAY AT THEIR EXPENSE. THE SALVAGE VALUE OF THE REMOVED EQUIPMENT SHALL BE REFLECTED IN THE CONTRACT BID PRICE.

- 5 EACH SIGNAL POST
- 4 EACH STEEL MAST ARM ASSEMBLY AND POLE
- 4 EACH SIGNAL HEAD, 1-FACE, 3-SECTION
- 4 EACH SIGNAL HEAD, 1-FACE, 5-SECTION
- 4 EACH SIGNAL HEAD, 2-FACE, 3-SECTION, 5-SECTION
- 4 EACH PEDESTRIAN SIGNAL HEAD, 1-FACE
- 2 EACH PEDESTRIAN SIGNAL HEAD, 2-FACE
- 8 EACH TRAFFIC SIGNAL BACKPLATE
- 8 EACH PEDESTRIAN PUSH-BUTTON
- 1 EACH CONTROLLER AND CABINET, COMPLETE
- 1 EACH SERVICE INSTALLATION



USER NAME = mfb	DESIGNED - BRD	REVISED -
PLOT SCALE = 20.0000' / 1"	DRAWN - MFB	REVISED -
PLOT DATE = 3/20/2013	CHECKED - JJE	REVISED -
	DATE - 03/21/2013	REVISED -

STATE OF ILLINOIS  
DEPARTMENT OF TRANSPORTATION

TEMPORARY TRAFFIC SIGNAL INSTALLATION PLAN AND REMOVAL PLAN  
IL ROUTE 43 (HARLEM AV.) AT FOREST PRESERVE DRIVE

SCALE: 1" = 20' SHEET NO. 1 OF 1 SHEETS STA. TO STA.

F.A.P. RTE. 0348	SECTION 2012-041TS	COUNTY COOK	TOTAL SHEETS 34	SHEET NO. 25
				CONTRACT NO. 60T97
ILLINOIS FED. AID PROJECT				