

MATCH LINE A
(SEE SHEET 2 OF 2)

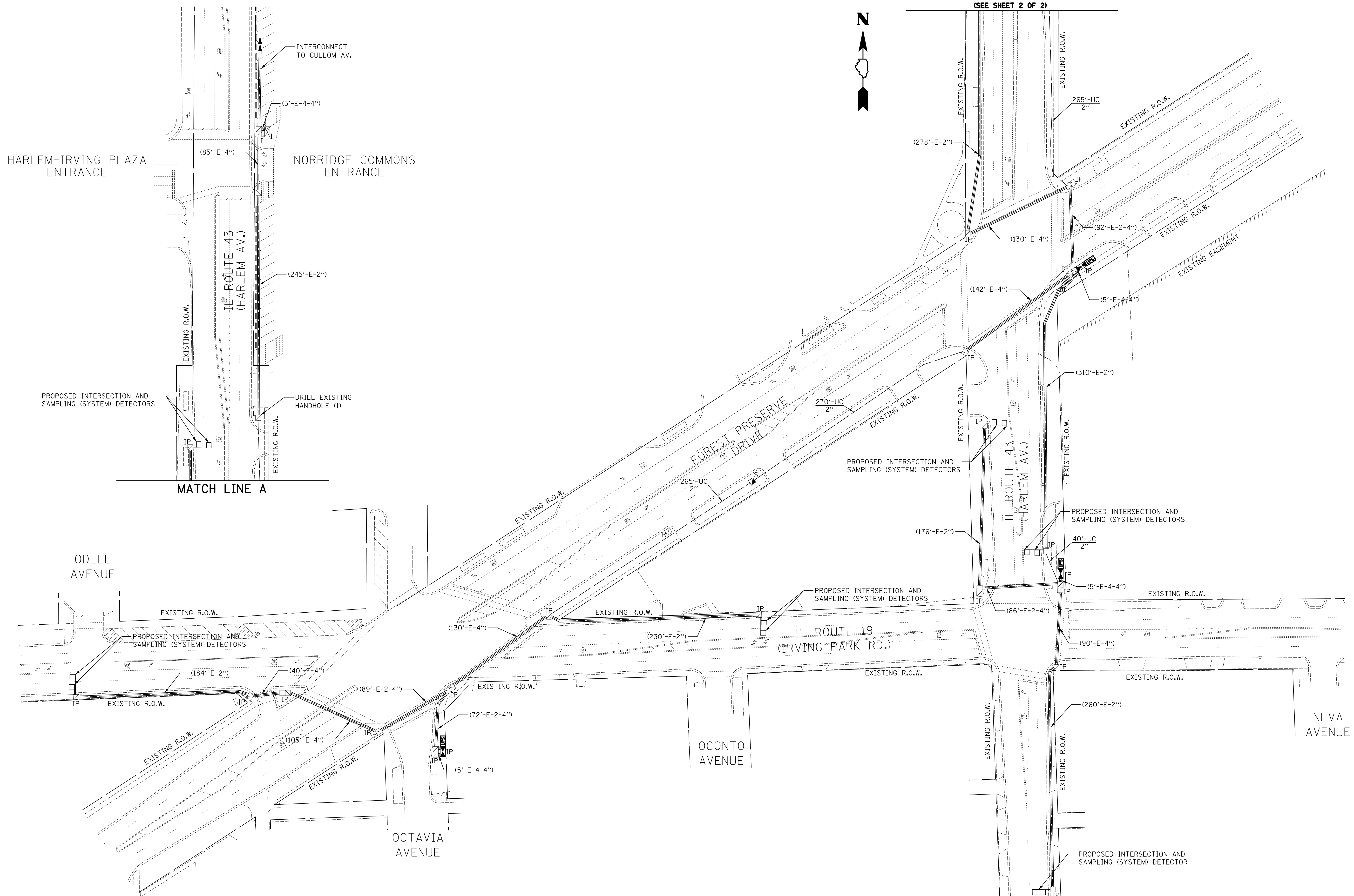

HARLEM-IRVING PLAZA
ENTRANCE

NORRIDGE COMMONS
ENTRANCE

IL ROUTE 43
(HARLEM AV.)

FOREST PRESERVE
DRIVE

IL ROUTE 43
(HARLEM AV.)

IL ROUTE 19
(IRVING PARK RD.)

ODELL
AVENUE

OCONTO
AVENUE

OCTAVIA
AVENUE

NEVA
AVENUE



USER NAME = mfb
PLOT SCALE = 50.0000' / 1" =
PLOT DATE = 3/20/2013

DESIGNED - BRD
DRAWN - MFB
CHECKED - JJE
DATE - 03/21/2013

REVISED -
REVISED -
REVISED -
REVISED -

STATE OF ILLINOIS
DEPARTMENT OF TRANSPORTATION

INTERCONNECT PLAN
IL ROUTE 19 (IRVING PARK RD.), IL ROUTE 43 (HARLEM AV.) AND
FOREST PRESERVE DRIVE
SCALE: 1" = 50' SHEET NO. 1 OF 1 SHEETS STA. TO STA.

F.A.P. RTE.	SECTION	COUNTY	TOTAL SHEETS	SHEET NO.
0348	2012-041TS	COOK	34	32
CONTRACT NO. 60T97				
ILLINOIS FED. AID PROJECT				