

CONSTRUCTION NOTES:

- ① THE CONTRACTOR SHALL LOCATE AND INTERCEPT THE COUPLING OF THE EXISTING 2" CONDUIT AND SPLICE A NEW 2" GALVANIZED STEEL CONDUIT TO RE-ESTABLISH THE FIBRE OPTIC INTERCONNECTOR. THE WORK SHALL BE INCLUDED IN THE COST OF THE CONDUIT.
- ② THE CONTRACTOR SHALL REINSTALL THE COILED FIBER OPTIC AND TRACING CABLES FROM THE TEMPORARY TRAFFIC SIGNAL INSTALLATION.
- ③ THE CONTRACTOR SHALL LOCATE AND INTERCEPT THE COUPLING OF THE EXISTING 2" CONDUIT AND SPLICE A NEW 2" GALVANIZED STEEL CONDUIT TO RE-ESTABLISH THE FAR OUT DETECTION. THE WORK SHALL BE INCLUDED IN THE COST OF THE CONDUIT.

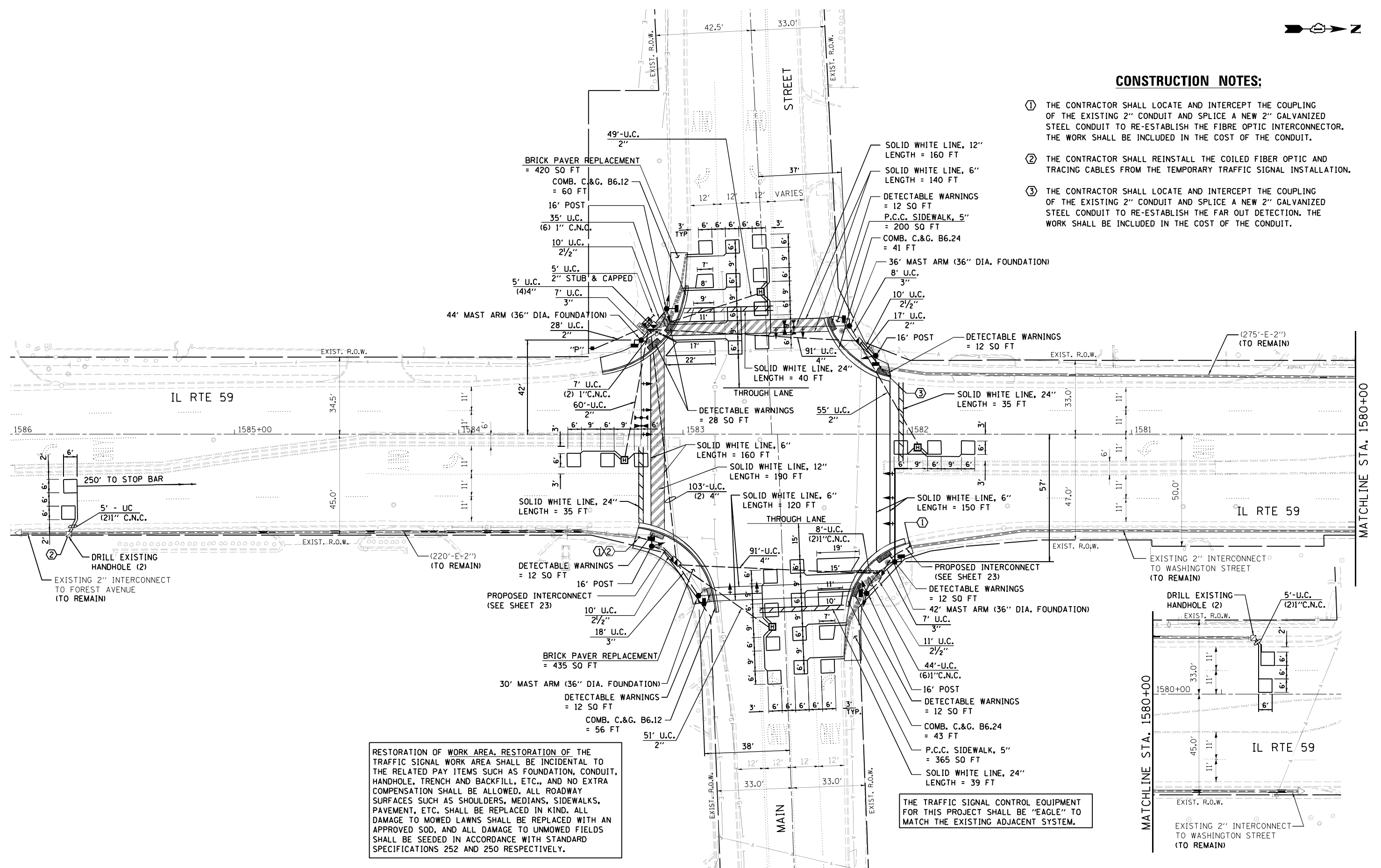

RESTORATION OF WORK AREA, RESTORATION OF THE TRAFFIC SIGNAL WORK AREA SHALL BE INCIDENTAL TO THE RELATED PAY ITEMS SUCH AS FOUNDATION, CONDUIT, HANDHOLE, TRENCH AND BACKFILL, ETC., AND NO EXTRA COMPENSATION SHALL BE ALLOWED. ALL ROADWAY SURFACES SUCH AS SHOULDERS, MEDIANS, SIDEWALKS, PAVEMENT, ETC. SHALL BE REPLACED IN KIND. ALL DAMAGE TO MOWED LAWNS SHALL BE REPLACED WITH AN APPROVED SOD, AND ALL DAMAGE TO UNMOWED FIELDS SHALL BE SEEDED IN ACCORDANCE WITH STANDARD SPECIFICATIONS 252 AND 250 RESPECTIVELY.

THE TRAFFIC SIGNAL CONTROL EQUIPMENT FOR THIS PROJECT SHALL BE "EAGLE" TO MATCH THE EXISTING ADJACENT SYSTEM.

FILE NAME = 60V59-TS17.dgn	USER NAME = jwouife	DESIGNED - JRD	REVISED -	STATE OF ILLINOIS DEPARTMENT OF TRANSPORTATION	TRAFFIC SIGNAL MODERNIZATION PLAN IL 59 AT MAIN STREET				F.A.P. RTE. 338	SECTION 2012-056T5	COUNTY DuPAGE	TOTAL SHEETS 32	SHEET NO. 17
\$MODELNAME\$	PLOT SCALE = 1:200	CHECKED - KLB	REVISED -		SCALE: 1" = 20'	SHEET	OF	SHEETS	STA.	TO	STA.	CONTRACT NO. 60V59	ILLINOIS FED. AID PROJECT
	PLOT DATE = 3/11/2013	DATE -	REVISED -										

GHA #4085.884