

SCHEDULE OF QUANTITIES
US 52 (RAYNOR AV) AT US 52 (McDONOUGH ST)

| NO. | QUANT. | UNIT | DESCRIPTION |
|-----|--------|------|---|
| 1. | 1 | EACH | MAINTENANCE OF EXISTING TRAFFIC SIGNAL INSTALLATION |
| 2. | 1 | EACH | UNINTERRUPTIBLE POWER SUPPLY, GROUND MOUNTED |

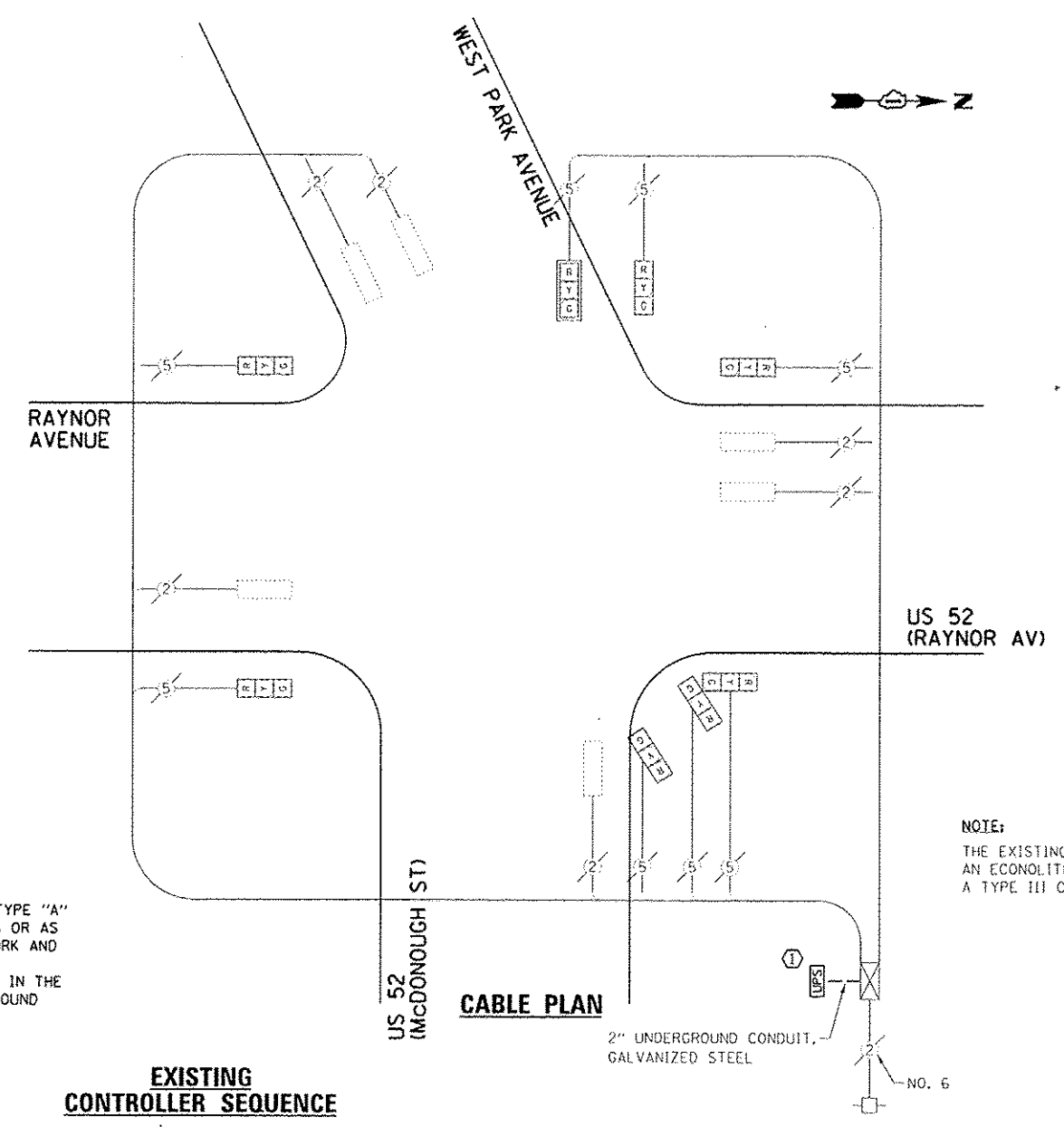

CONSTRUCTION NOTE:

① THE UPS SHALL BE INSTALLED ON A SEPARATE TYPE "A" FOUNDATION DUE TO THE PHYSICAL CONSTRAINTS OR AS DIRECTED BY THE RESIDENT ENGINEER. THIS WORK AND ALL CONDUIT AND ELECTRICAL CABLE NEEDED TO PROPERLY INSTALL THE UPS SHALL BE INCLUDED IN THE PAY ITEM "UNINTERRUPTIBLE POWER SUPPLY, GROUND MOUNTED".

NOTE:
THE EXISTING CONTROLLER IS AN ECONOLITE ASC/2-2100 IN A TYPE III CABINET.

EXISTING CONTROLLER SEQUENCE

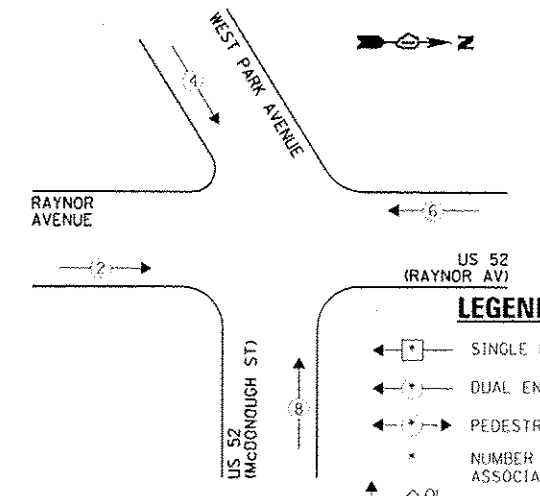

- LEGEND:**
- ◀ [Symbol] ▶ SINGLE ENTRY PHASE
 - ◀ [Symbol] ▶ DUAL ENTRY PHASE
 - ◀ [Symbol] ▶ PEDESTRIAN PHASE
 - * NUMBER REFERS TO ASSOCIATED PHASE
 - ◀ [Symbol] ▶ OVERLAP

EXISTING PHASE DESIGNATION DIAGRAM

| I.D.O.T. TRAFFIC SIGNAL INSTALLATION ELECTRICAL SERVICE REQUIREMENTS | | | | TOTAL WATTAGE | |
|--|-----------|---------|-----------|---------------|-------|
| TYPE | NO. LAMPS | WATTAGE | OPERATION | | |
| | | INCAND. | L.E.D. | | |
| SIGNAL (RED) | 8 | 135 | 17 | 0.50 | 68.0 |
| SIGNAL (YELLOW) | 8 | 135 | 25 | 0.25 | 50.0 |
| SIGNAL (GREEN) | 8 | 135 | 15 | 0.25 | 30.0 |
| ARROW | - | 135 | 12 | 0.10 | - |
| PED. SIGNAL | - | 90 | 25 | 1.00 | - |
| CONTROLLER | 1 | - | 100 | 1.00 | 100.0 |
| LUMINAIRE | - | - | 250 | 0.50 | - |
| L.E.D. ST. NAME SIGN | - | - | 64 | 0.50 | - |
| VIDEO SYSTEM | - | - | 150 | 1.00 | - |
| BATTERY BACKUP | 1 | - | 25 | 1.00 | 25.0 |
| ILLUMINATED SIGN | - | - | 25 | 0.05 | - |
| TOTAL = | | | | | 273.0 |

ENERGY COSTS - BILLED TO: IL DEPT. OF TRANSPORTATION
(ADDRESS) 201 W. CENTER COURT
(ADDRESS) SCHAMBERG, IL 60196-1096
ENERGY SUPPLY - CONTACT: TIM COSLET
PHONE: 815-724-5010
COMPANY: COMED - JOLIET

THE TRAFFIC SIGNAL CONTROL EQUIPMENT FOR THIS PROJECT SHALL BE "ECONOLITE" TO MATCH THE EXISTING ADJACENT SYSTEM.

| | | | |
|--|----------------------|-----------------|--------------------|
| FILE NAME: 0890-Raynor and McDonough.txd | USER NAME: gwhitten | DESIGNED - JRD | REVISED - 05-24-13 |
| Default | PLOT SCALE: 1/32" | DRAWN - CW3 | REVISED - |
| | PLOT DATE: 5/24/2013 | CHECKED - KLB | REVISED - |
| | | DATE - 05/24/13 | REVISED - |

STATE OF ILLINOIS
DEPARTMENT OF TRANSPORTATION

SCHEDULE OF QUANTITIES, CABLE PLAN, PHASE DESIGNATION DIAGRAM, & EMERGENCY VEHICLE PREEMPTION SEQUENCE
US 52 (RAYNOR AV) AT US 52 (McDONOUGH ST)

SCALE: SHEET OF SHEETS STA. TO STA.

| | | | | | |
|---------------|--------------------|-------------|-----------------|---------------|---------------------------|
| F.A. RTE. VAR | SECTION 2013-003-1 | COUNTY WILL | TOTAL SHEETS 89 | SHEET NO. 89D | CONTRACT NO. 60W21 |
| GHA #4085.888 | | | | | ILLINOIS FED. AID PROJECT |