

STATE OF ILLINOIS
DEPARTMENT OF TRANSPORTATION
DIVISION OF HIGHWAYS

PLANS FOR PROPOSED FEDERAL AID HIGHWAY

F. A. I. D. NO.	SECTION	COUNTY	TOTAL SHEETS	SHEET NO.
112	09-00055-00-CH	WILL.	54	1
STA.	TO STA.			
FED. ROAD DIST. NO. 1	ILLINOIS	FED. AID PROJECT	M-9003(829)	

CONTRACT #63753

INDEX OF SHEETS
SEE SHEET 2

STATE STANDARDS
SEE SHEET 2

DESIGN DESIGNATION - IL RTE 53 ADT 37,000 (2030) - PRINCIPAL ARTERIAL
PV=31,820 SU=2,590 MU=2,590

2009 ADT - 29,100
2030 ADT - 37,000

EXISTING SPEED LIMIT - 45 MPH
PROPOSED SPEED LIMIT - 45 MPH

DESIGN PERIOD - 20 YEARS
DESIGN SPEED LIMIT - 50 MPH
STREET CLASSIFICATION - CLASS 1 ROAD

FAP ROUTE 112
IL RTE 53 AT MATERIAL ROAD
INTERSECTION IMPROVEMENT
L.A. SECTION NO.: 09-00055-00-CH
PROJECT NO.: M-9003(829)
VILLAGE of ROMEOVILLE
WILL COUNTY
JOB NO. C-91-572-11

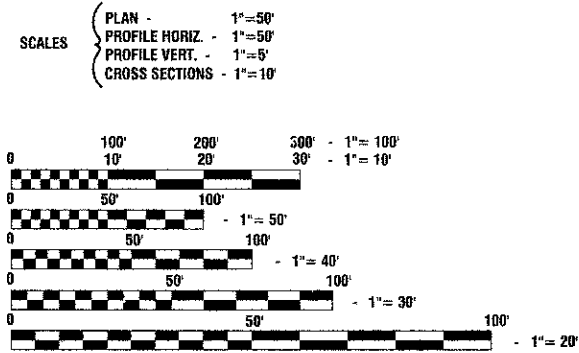
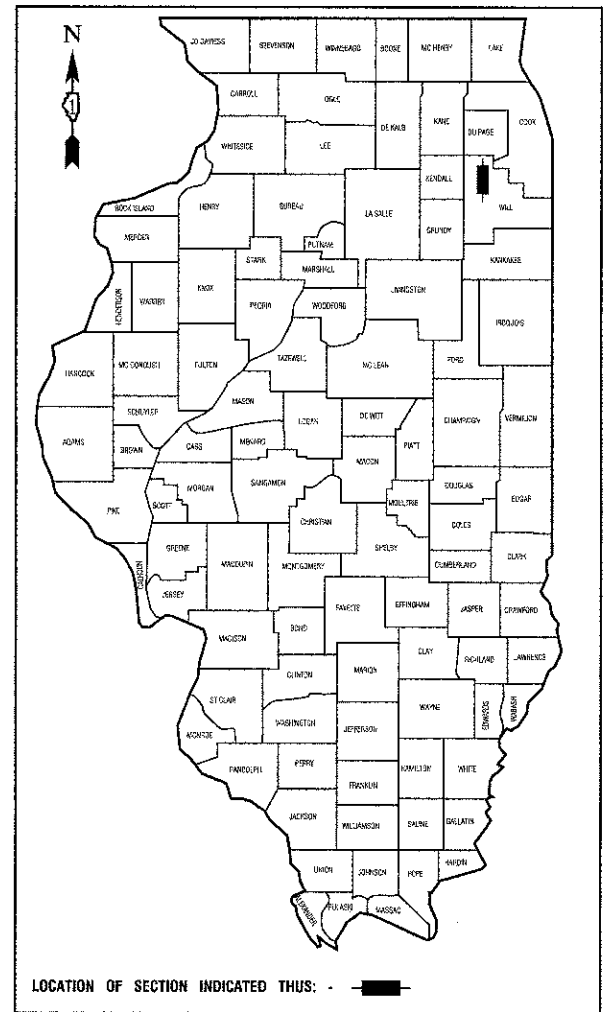

FULL SIZE PLANS HAVE BEEN PREPARED USING STANDARD ENGINEERING SCALES, REDUCED SIZED PLANS WILL NOT CONFORM TO STANDARD SCALES, IN MAKING MEASUREMENTS ON REDUCED PLANS, THE ABOVE SCALES MAY BE USED.

J. U. L. I. E.
JOINT UTILITY LOCATION INFORMATION FOR EXCAVATION
1-800-892-0123 or 811

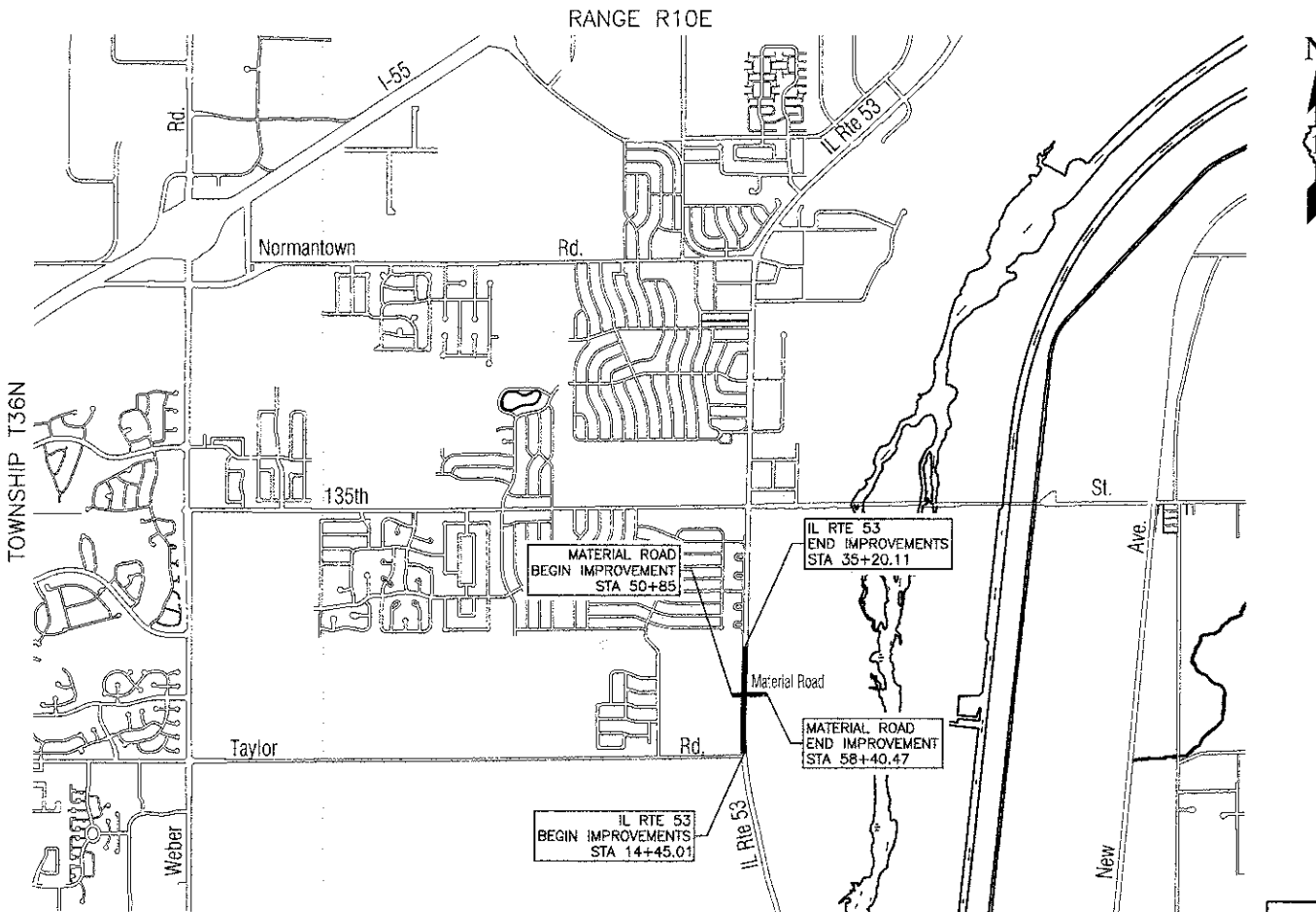

LOCATION MAP

GROSS LENGTH=2,830.57 FEET=0.536 MILES
NET LENGTH=2,830.57 FEET=0.536 MILES

PRINTED BY THE AUTHORITY OF
THE STATE OF ILLINOIS

STATE OF ILLINOIS DEPARTMENT OF TRANSPORTATION
DIVISION OF HIGHWAYS

Approved: 10-19-2012
[Signature]
Director of Public Works, Village of Romeoville

Passed: DECEMBER 20 2012
[Signature]
District Engineer of Local Roads & Streets

Released for Bid Based on Limited Review: December 21 2012
[Signature]
Deputy Director of Highways, Region 1 Engineer

DESCRIPTION OF IMPROVEMENT
THIS IMPROVEMENT CONSISTS OF EARTH EXCAVATION, PAVEMENT REMOVAL, HMA WIDENING AND OVERLAY, HMA FULL DEPTH PAVEMENT, STORM SEWER CONSTRUCTION, TRAFFIC SIGNALS, AND ALL INCIDENTAL WORK AS NECESSARY TO COMPLETE THE IMPROVEMENT SHOWN HEREIN AND AS DESCRIBED IN THE SPECIFICATIONS.

PREPARED BY OR UNDER THE DIRECT SUPERVISION OF:

[Signature]
11-12-2012

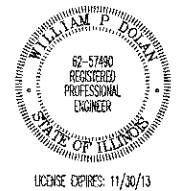

PROGRAM AND OFFICE ENGINEER: CHARLES F. RIDDLE, PE (847)705-4406 SCHAMBURG, IL
CONSULTANTS: ROBINSON ENGINEERING, LTD. 708-331-6700