

SECTION 3, TOWNSHIP 36, RANGE 10

DATE	BY	REVISIONS
		1. REVISION
		2. REVISION
		3. REVISION
		4. REVISION
		5. REVISION
		6. REVISION
		7. REVISION
		8. REVISION
		9. REVISION
		10. REVISION
		11. REVISION
		12. REVISION
		13. REVISION
		14. REVISION
		15. REVISION
		16. REVISION
		17. REVISION
		18. REVISION
		19. REVISION
		20. REVISION
		21. REVISION
		22. REVISION
		23. REVISION
		24. REVISION
		25. REVISION
		26. REVISION
		27. REVISION
		28. REVISION
		29. REVISION
		30. REVISION
		31. REVISION
		32. REVISION
		33. REVISION
		34. REVISION
		35. REVISION
		36. REVISION
		37. REVISION
		38. REVISION
		39. REVISION
		40. REVISION
		41. REVISION
		42. REVISION
		43. REVISION
		44. REVISION
		45. REVISION
		46. REVISION
		47. REVISION
		48. REVISION
		49. REVISION
		50. REVISION

DATE	BY	REVISIONS
		1. REVISION
		2. REVISION
		3. REVISION
		4. REVISION
		5. REVISION
		6. REVISION
		7. REVISION
		8. REVISION
		9. REVISION
		10. REVISION
		11. REVISION
		12. REVISION
		13. REVISION
		14. REVISION
		15. REVISION
		16. REVISION
		17. REVISION
		18. REVISION
		19. REVISION
		20. REVISION
		21. REVISION
		22. REVISION
		23. REVISION
		24. REVISION
		25. REVISION
		26. REVISION
		27. REVISION
		28. REVISION
		29. REVISION
		30. REVISION
		31. REVISION
		32. REVISION
		33. REVISION
		34. REVISION
		35. REVISION
		36. REVISION
		37. REVISION
		38. REVISION
		39. REVISION
		40. REVISION
		41. REVISION
		42. REVISION
		43. REVISION
		44. REVISION
		45. REVISION
		46. REVISION
		47. REVISION
		48. REVISION
		49. REVISION
		50. REVISION

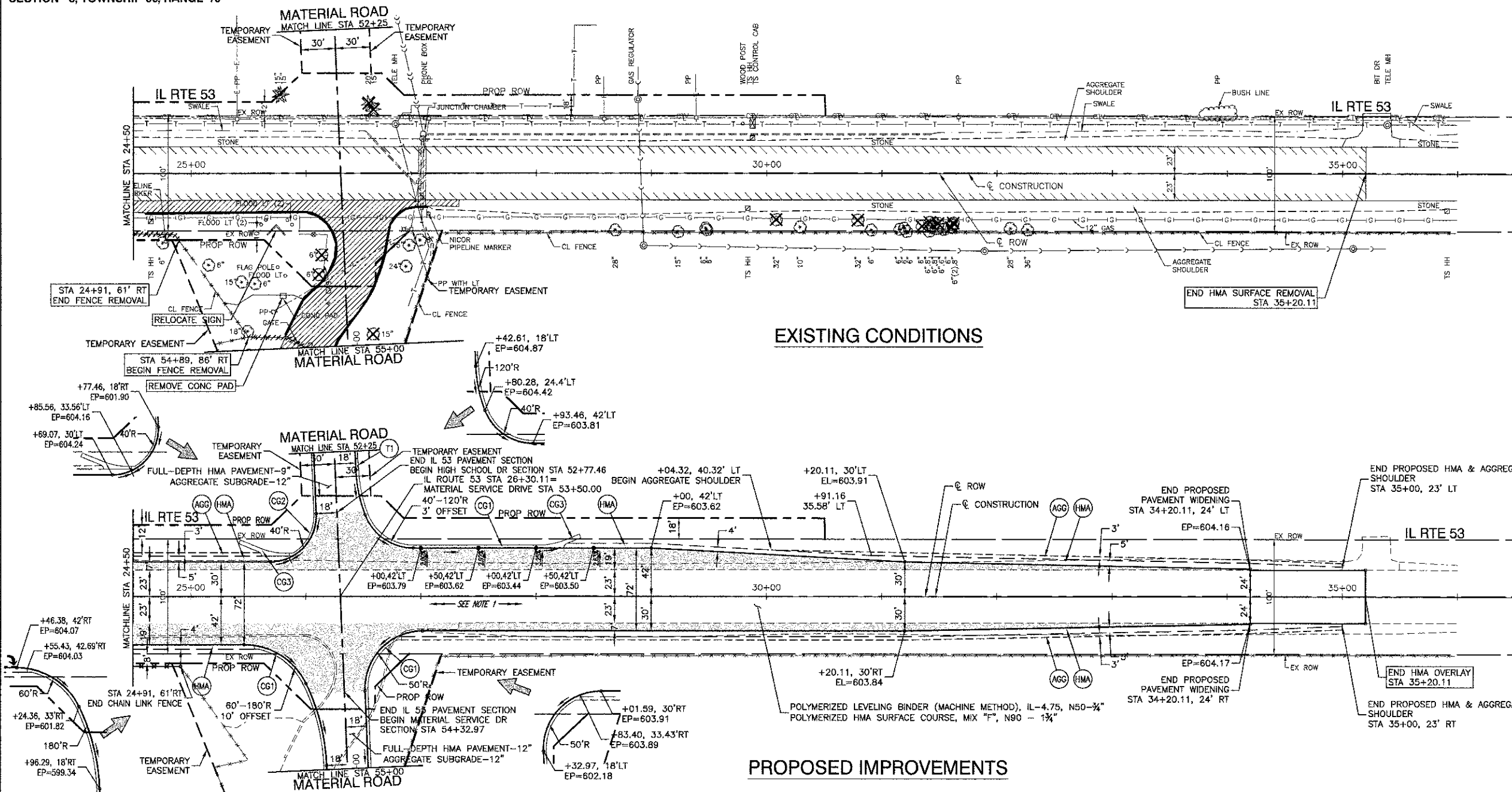

EXISTING CONDITIONS

PROPOSED IMPROVEMENTS

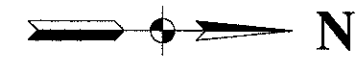

LEGEND

- CURB AND GUTTER REMOVAL
- PAVEMENT REMOVAL
- HMA SURFACE REMOVAL-2 1/2"
- CONCRETE SIDEWALK REMOVAL
- CLASS "D" PATCHES-13"
- TREE REMOVAL
- IL RTE 53 PAVEMENT WIDENING (SEE TYPICAL CROSS SECTIONS)
- HMA SHOULDER (SEE TYPICAL CROSS SECTION)
- AGG SHOULDER, TYPE B-8"
- COMB CONC CURB & GUTTER, TYPE B-6.24
- COMB CONC CURB & GUTTER, TYPE B-6.18
- OUTLET FOR COMB CONC CURB & GUTTER, TYPE B-6.24
- 10' TRANSITION FROM CURB & GUTTER TYPE B-6.24 TO CURB & GUTTER TYPE B-6.18
- 10' TRANSITION FROM CURB & GUTTER TYPE B-6.24 TO EXISTING TYPE CURB & GUTTER
- P.C.C. SIDEWALK-5"

NOTES

1. THE RIGHT-TURN LANE CROSS SLOPE SHALL VARY AS SHOWN TO MAINTAIN PROPER DRAINAGE ALONG THE ADJACENT CURB AND GUTTER.
2. THE CONTRACTOR SHALL MILL FIRST PRIOR TO PATCHING.
3. ADDITIONAL QUANTITIES OF PAVEMENT PATCHING HAVE BEEN ADDED TO THE CONTRACT ON AN AS-NEEDED BASIS FOR IL RTE 53. LOCATIONS TO BE DETERMINED IN THE FIELD BY THE ENGINEER.
4. THE GENERAL CONTRACTOR IS REQUIRED TO HIRE AN ENVIRONMENTAL FIRM WITH AT LEAST FIVE (5) DOCUMENTED LEAKING UNDERGROUND STORAGE TANK CLEANUPS OR THAT IS PRE-QUALIFIED IN HAZARDOUS WASTE BY THE DEPARTMENT TO REMEDIATE THE SOIL CONTAMINATION AND MONITOR FOR WORKER PROTECTION.

BENCH MARK:

2 NAILS IN EAST FACE OF 9TH POWER POLE NORTH OF TAYLOR ROAD, ON WEST SIDE OF ROUTE 53. ELEVATION=605.76

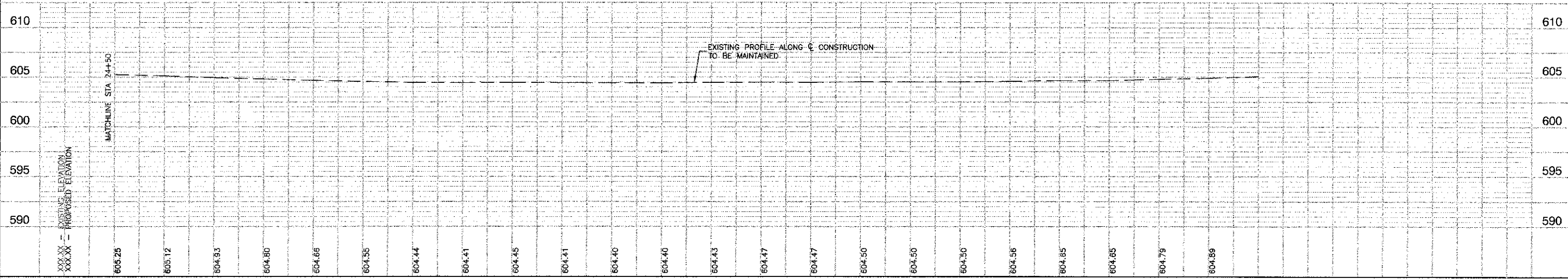

FILE NAME = 09361_02-PLPR-01 - PLPR02

USER NAME =	DESIGNED -- WPD	REVISED -- 01-07-13 - TEMP EASE
PLOT SCALE = 1"=50'	CHECKED -- PB	REVISED --
PLOT DATE = 02-28-13	DRAWN -- AG	REVISED --
	CHECKED -- PS	REVISED --

STATE OF ILLINOIS
DEPARTMENT OF TRANSPORTATION

IL RTE 53 AT MATERIAL ROAD STA 24+50 TO END IMPROVEMENTS PLAN AND PROFILE		F.A.P. RTE	SECTION	COUNTY	TOTAL SHEETS	SHEET NO.
SCALE: H 1"=50' V 1"=5'		112	09-00655-00-CH	WILL	54	11
SHEET NO. 11 OF 54 SHEETS		STATION		TO STA.		

FED. ROAD DIST. NO. 1	ILLINOIS	FED. AID PROJECT M-9003(829)
-----------------------	----------	------------------------------