

DRAINAGE BASINS OF LAKE COUNTY

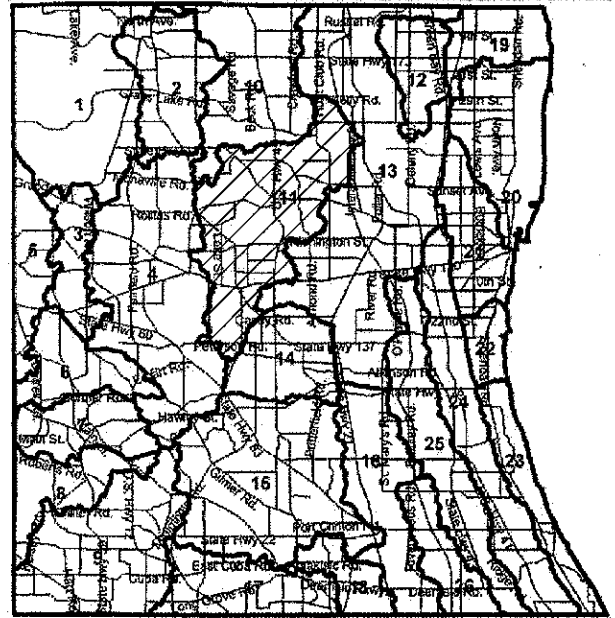

- I. FOX RIVER WATERSHED
  - 1. UPPER FOX RIVER
  - 2. SEQUOIT CREEK
  - 3. FISH LAKE DRAIN
  - 4. SQUAW CREEK
  - 5. LOWER FOX RIVER
  - 6. MUTTON CREEK
  - 7. SLOCUM LAKE DRAIN
  - 8. TOWER LAKE DRAIN
  - 9. FLINT CREEK
- II. DES PLAINES RIVER WATERSHED
  - 10. NORTH MILL CREEK
  - 11. MILL CREEK
  - 12. NEWPORT DRAINAGE DITCH
  - 13. UPPER DES PLAINES RIVER
  - 14. BULL CREEK
  - 15. INDIAN CREEK
  - 16. LOWER DES PLAINES RIVER
  - 17. BUFFALO CREEK
  - 18. APTAKISIC CREEK
- III. LAKE MICHIGAN WATERSHED
  - 19. KELLOGG CREEK
  - 20. DEAD RIVER
  - 21. WAUKEGAN RIVER
  - 22. PETTIBONE CREEK
  - 23. BLUFF/RAVINE
- IV. CHICAGO RIVER WATERSHED
  - 24. SKOKIE RIVER
  - 25. MIDDLE FORK
  - 26. WEST FORK

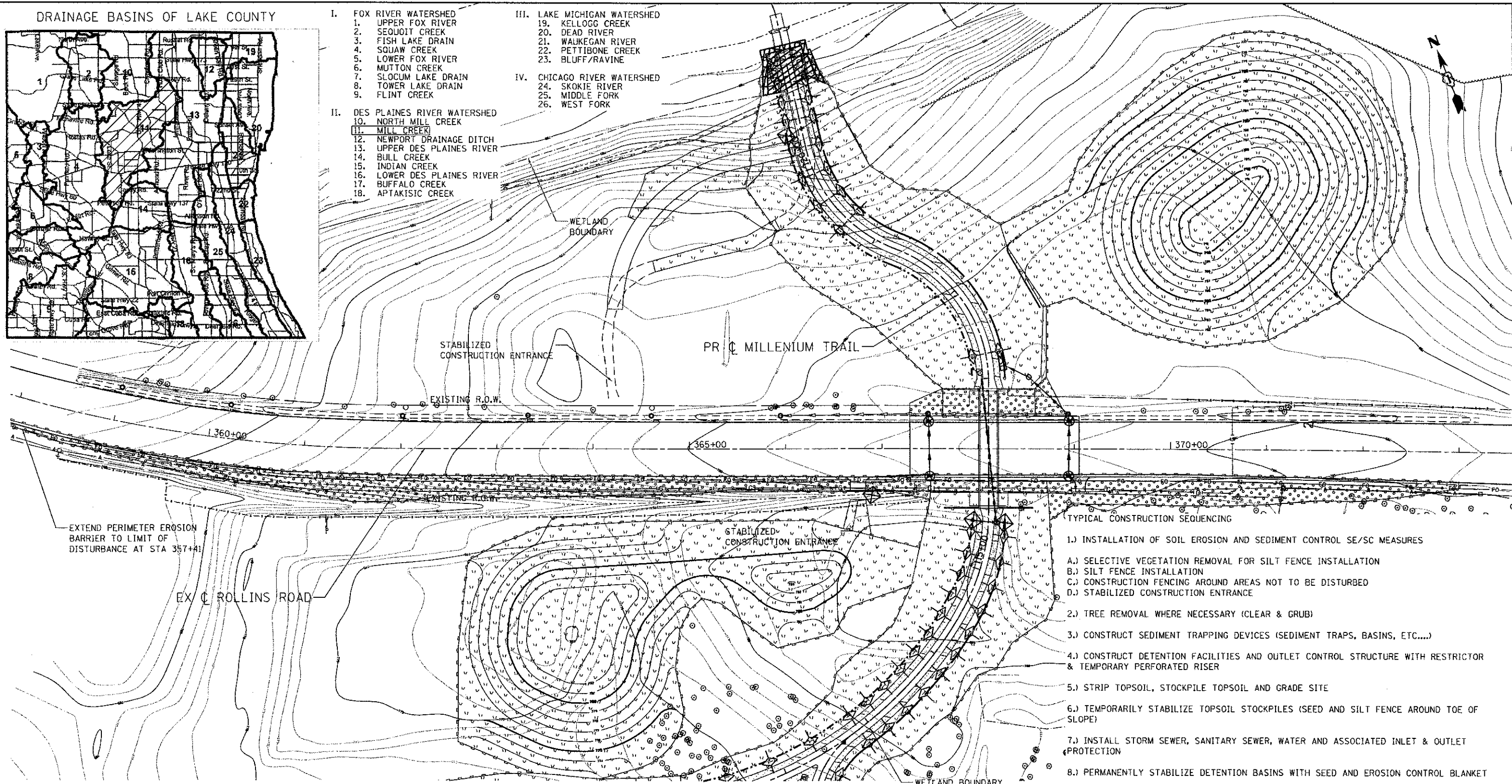

- TYPICAL CONSTRUCTION SEQUENCING
- 1.) INSTALLATION OF SOIL EROSION AND SEDIMENT CONTROL SE/SC MEASURES
    - A.) SELECTIVE VEGETATION REMOVAL FOR SILT FENCE INSTALLATION
    - B.) SILT FENCE INSTALLATION
    - C.) CONSTRUCTION FENCING AROUND AREAS NOT TO BE DISTURBED
    - D.) STABILIZED CONSTRUCTION ENTRANCE
  - 2.) TREE REMOVAL WHERE NECESSARY (CLEAR & GRUB)
  - 3.) CONSTRUCT SEDIMENT TRAPPING DEVICES (SEDIMENT TRAPS, BASINS, ETC....)
  - 4.) CONSTRUCT DETENTION FACILITIES AND OUTLET CONTROL STRUCTURE WITH RESTRICTOR & TEMPORARY PERFORATED RISER
  - 5.) STRIP TOPSOIL, STOCKPILE TOPSOIL AND GRADE SITE
  - 6.) TEMPORARILY STABILIZE TOPSOIL STOCKPILES (SEED AND SILT FENCE AROUND TOE OF SLOPE)
  - 7.) INSTALL STORM SEWER, SANITARY SEWER, WATER AND ASSOCIATED INLET & OUTLET PROTECTION
  - 8.) PERMANENTLY STABILIZE DETENTION BASINS WITH SEED AND EROSION CONTROL BLANKET
  - 9.) TEMPORARILY STABILIZE ALL AREAS INCLUDING LOTS THAT HAVE REACHED TEMPORARY GRADE
  - 10.) INSTALL ROADWAYS
  - 11.) PERMANENTLY STABILIZE ALL OUTLOT AREAS
  - 12.) INSTALL STRUCTURES AND GRADE INDIVIDUAL LOTS
  - 13.) PERMANENTLY STABILIZE LOTS AND INSTALL PERMEABLE PLASTIC BERMS
  - 14.) REMOVE ALL TEMPORARY SE/SC MEASURES AFTER THE SITE IS STABILIZED WITH VEGETATION
- SOIL EROSION AND SEDIMENT CONTROL MAINTENANCE MUST OCCUR EVERY TWO WEEKS AND AFTER EVERY 1/2" OR GREATER RAINFALL EVENT

LEGEND:

	SEEDING CLASS 3 (SPECIAL) EROSION CONTROL BLANKET
	SEEDING CLASS 2 (SPECIAL) EROSION CONTROL BLANKET
	SEEDING CLASS 2A, EROSION CONTROL BLANKET
	PERIMETER EROSION BARRIER (SEE DETAIL)
	TEMPORARY DITCH CHECK/PERMEABLE PLASTIC BERM
	INLET AND PIPE PROTECTION
	INLET FILTER

- GENERAL NOTES:
- 1.) SILT FENCE SHALL MEET THE APPLICABLE STANDARDS OF AASHTO 288-00 (ARTICLE IV, SECTION B.1.J.1.F.1, AS AMENDED), OR EQUIVALENT.
  - 2.) INLET FILTERS SHALL BE USED ALONG ROLLINS ROAD. INLET AND PIPE PROTECTION SHALL BE USED FOR FLARED END SECTIONS ALONG THE PROPOSED MILLENNIUM TRAIL.



**Ciorba Group, Inc.**  
 CONSULTING ENGINEERS  
 5597 North Cumberland Avenue, Suite 402  
 Chicago, Illinois 60656  
 Tel. 773.775.4009 Fax 773.775.4014

USER NAME = jk.jellman	DESIGNED -	REVISED -
PLOT SCALE = 1/200,0000' / ft.	DRAWN -	REVISED -
PLOT DATE = 4/8/2013	CHECKED -	REVISED -
	DATE -	REVISED -

**MILLENNIUM TRAIL  
 LAKE COUNTY FOREST PRESERVES**

<b>EROSION CONTROL AND LANDSCAPING - ROLLINS ROAD</b>			
<b>ROLLINS ROAD UNDERPASS</b>			
SCALE:	SHEET NO.	OF SHEETS	STA. TO STA.

F.A.U. RTE.	SECTION	COUNTY	TOTAL SHEETS	SHEET NO.
181	12-F3000-01-BT	LAKE	118	36
CONTRACT NO. 63807				
FED. ROAD DIST. NO. - [ILLINOIS] FED. AID PROJECT				

FILE NAME = N:\PROJ\0820087\01\Rollins\Design\Exec\Ln\dep\0820087.dwg; user: jk.jellman