

06-14-13 LETTING ITEM 040

STATE OF ILLINOIS  
DEPARTMENT OF TRANSPORTATION  
DIVISION OF HIGHWAYS

F.A. RTE.	SECTION	COUNTY	TOTAL SHEETS	SHEET NO.
	12-U001-00-SW	WILL	7	1
STATION TO BE SHOWN ON GREEN GARDEN PLACE		ILLINOIS	CONTRACT NO. 63820	

INDEX TO SHEETS:  
SHEET NO. DESCRIPTION

1. COVER SHEET
2. SUMMARY OF QUANTITIES
3. GENERAL NOTES AND TYPICAL SECTION
- 4.-5. PLAN AND PROFILE SHEETS
6. CROSS SECTIONS GREEN GARDEN PLACE
7. DISTRICT ONE TYPICAL PAVEMENT MARKINGS (TC-13)

HIGHWAY STANDARDS

- 000001-06 STANDARD SYMBOLS, ABBREVIATIONS AND PATTERNS
- 424001-07 PERPENDICULAR CURB RAMPS FOR SIDEWALKS
- 701011-03 OFF-ROAD MOVING OPERATIONS, 2L, 2W, DAY ONLY
- 701301-04 LANE CLOSURE, 2L, 2W, SHORT TIME OPERATIONS
- 701801-05 SIDEWALK, CORNER, OR CROSSWALK CLOSURE
- 701901-02 TRAFFIC CONTROL DEVICES

PROPOSED  
HIGHWAY PLANS

GREEN GARDEN PLACE  
NOBES AVENUE TO JAK AVENUE  
SIDEWALK CONSTRUCTION  
SECTION NO. 12-U001-00-SW  
PROJECT NO. SRTS 4009(227)  
TOWNSHIP OF LOCKPORT  
WILL COUNTY  
JOB NO. C-91-074-13

R 10 E 3RD P.M.

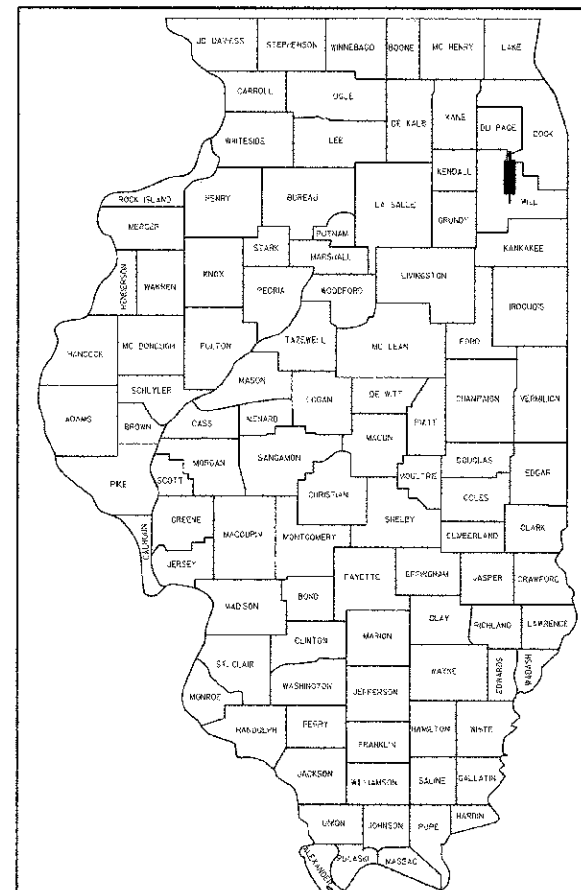

LOCATION OF SECTION INDICATED THUS: -

STATE OF ILLINOIS  
DEPARTMENT OF TRANSPORTATION  
DIVISION OF HIGHWAYS

APPROVED March 5 2013  
Thomas Carroll  
THOMAS CARROLL P.E., WILL COUNTY ENGINEER

PASSED April 5 2013  
C. J. Hart  
DISTRICT 1 ENGINEER OF LOCAL ROADS AND STREETS

RELEASING FOR BID BASED ON LIMITED REVIEW April 10 2013  
John Fortson  
DEPUTY DIRECTOR OF HIGHWAYS, REGION ONE ENGINEER

PROGRAM AND OFFICE ENGINEER: CHARLES R. RIDGILL, P.E., SCHUMBERG, IL (847) 705-4406



FULL SIZE PLANS HAVE BEEN PREPARED USING STANDARD ENGINEERING SCALES. REDUCED SIZED PLANS WILL NOT CONFORM TO STANDARD SCALES. IN MAKING MEASUREMENTS ON REDUCED PLANS, THE ABOVE SCALES MAY BE USED.

J.U.L.I.E.  
JOINT UTILITY LOCATION INFORMATION  
FOR EXCAVATION  
1-800-892-0123 OR 811



LOCKPORT TWP

LOCATION MAP  
SCALE: NTS

GROSS LENGTH = 952 FT. = 0.18 MILE  
NET LENGTH = 905 FT. = 0.17 MILE

CONTRACT NO. 63820

DATE: \_\_\_\_\_  
EXP: \_\_\_\_\_

PRINTED BY THE AUTHORITY  
OF THE STATE OF ILLINOIS

SUMMARY OF QUANTITIES

ITEM NO.	ITEM	UNIT	TOTAL QUANTITY	CONST. TYPE CODE (002)
2010400	NITROGEN FERTILIZER NUTRIENT	LBS	3.6	
2010500	PHOSPHORUS FERTILIZER NUTRIENT	LBS	3.6	
2010600	POTASSIUM FERTILIZER NUTRIENT	LBS	3.6	
20200100	EARTH EXCAVATION	CU YD	79.90	
20201200	REMOVAL AND DISPOSAL OF UNSUITABLE MATERIAL	CU YD	35.15	
2101601	TOPSOIL FURNISH AND PLACE, 1 INCH	SQ YD	201.0	
25000100	SEEDING, CLASS-1	ACRE	0.04	
25100105	MULCH, METHOD 1	ACRE	0.04	
3102100	SUBBASE GRANULAR MATERIAL (CA-6), TYPE C, 4 INCH	SQ YD	502.0	
42400200	PORTLAND CEMENT CONCRETE SIDEWALK 5 INCH	SQ FT	4518.0	
42400800	DETECTABLE WARNINGS	SQ FT	60.0	
44000200	DRIVEWAY PAVEMENT REMOVAL	SQ YD	21.5	
44000600	SIDEWALK REMOVAL	SQ FT	54.0	
67100100	MOBILIZATION	L SUM	1.0	
Δ 7800150	PAINT PAVEMENT MARKING 12 INCH	FOOT	144.0	
XX008200	STABILIZED DRIVEWAY PAVEMENT	SQ YD	8.0	

Δ SPECIALTY ITEMS

FILE NAME	USER NAME	DESIGNED - RAS	REVISED - MAS 1/14/13	STATE OF ILLINOIS DEPARTMENT OF TRANSPORTATION	SUMMARY OF QUANTITIES	F.A. RTE.	SECTION	COUNTY	TOTAL SHEETS	SHEET NO.
		DRAWN - RAS	REVISED - MAS 2/28/13			12-LU001-00-SW	WILL	7	2	
		CHECKED - TC	REVISED -			STA. 0+10 TO STA. 9+50 GREEN GARDEN PLACE	CONTRACT NO. 63820			
		DATE - 12/27/12	REVISED -			ILLINOIS FED. AID PROJECT				
					SCALE: _____	SHEET NO. 2 OF 7 SHEETS		STA. _____ TO STA. _____		

**CLEARING**

ALL AREAS DESIGNATED IN PLANS AS TO BE CLEARED SHALL INVOLVE REMOVAL OF OBSTRUCTIONS AS DEFINED IN ARTICLE 201.01(a) OF THE STANDARD SPECIFICATIONS. ALL CLEARING SHALL NOT BE PAID FOR SEPARATELY, BUT INCLUDED IN THE COST OF THE CONTRACT.

**UTILITIES**

THE CONTRACTOR SHALL BE RESPONSIBLE FOR CONTACTING THE OWNER OF ALL EXISTING FACILITIES SO THAT UTILITIES AND THEIR APPURTENANCES MAY BE LOCATED AND ADJUSTED OR MOVED, IF NECESSARY, PRIOR TO THE START OF CONSTRUCTION OPERATIONS. THE CONTRACTORS SHALL COOPERATE WITH ALL UTILITY OWNERS AS PROVIDED FOR IN THE STANDARD SPECIFICATIONS.

THE LOCATIONS OF EXISTING DRAINAGE STRUCTURES, STORM AND SANITARY SEWERS, WATER SERVICE LINES AND OTHER UTILITY LINES ARE APPROXIMATE, AND THE TOWNSHIP DOES NOT GUARANTEE THEIR ACCURACY. THEIR EXACT HORIZONTAL AND VERTICAL LOCATIONS ARE TO BE DETERMINED IN THE FIELD BY THE CONTRACTOR AT HIS OWN EXPENSE.

THE CONTRACTOR SHALL BE RESPONSIBLE FOR THE PROTECTION OF ALL UNDERGROUND OR SURFACE UTILITIES EVEN THOUGH THEY MAY NOT BE SHOWN ON THE PLANS. ANY UTILITY THAT IS DAMAGED DURING CONSTRUCTION SHALL BE REPAIRED OR REPLACED TO THE SATISFACTION OF THE ENGINEER OR THE TOWNSHIP. THIS WORK SHALL BE AT THE CONTRACTORS EXPENSE.

COORDINATION OF ALL UTILITY WORK INVOLVED IN THE CONSTRUCTION AREA WILL BE DISCUSSED AT THE PRECONSTRUCTION CONFERENCE.

BEFORE STARTING ANY EXCAVATION, THE CONTRACTOR SHALL CALL "JULIE" AT 800-892-0123 FOR FIELD LOCATIONS OF BURIED ELECTRIC, TELEPHONE, GAS AND CABLE TELEVISION FACILITIES. 148 HOURS NOTIFICATION IS REQUIRED.

**STORM SEWER**

ANY EXISTING STORM SEWER DAMAGED BY THE CONTRACTOR DURING CONSTRUCTION SHALL BE REPLACED BY THE CONTRACTOR AT HIS OR HER OWN EXPENSE.

**RESURFACING**

CONTRACTOR IS TO RESTORE ALL UNPAVED AREAS DAMAGED DURING CONSTRUCTION OPERATIONS TO THEIR ORIGINAL CONDITION INCLUDING THE FINE GRADING AND SODDING OR SEEDING OF AREAS WITHIN EASEMENTS AND RIGHTS-OF-WAY.

**MISCELLANEOUS**

ACCESS: THE CONTRACTOR SHALL PROVIDE ACCESS TO ADJUTING PROPERTY AT ALL TIMES DURING CONSTRUCTION, EXCEPT DURING THE INSTALLATION OF SIDEWALK SPANNING DRIVEWAYS, WHICH INCLUDES THE LENGTH OF TIME NECESSARY FOR EXCAVATION, FRAMING, POURING, AND CURING.

DIMENSIONS: IT SHALL BE THE CONTRACTORS RESPONSIBILITY TO VERIFY ALL DIMENSIONS AND CONDITIONS EXISTING IN THE FIELD PRIOR TO ORDERING MATERIALS AND BEGINNING CONSTRUCTION.

ALL SAWCUTTING SHALL BE INCLUDED IN THE UNIT COST OF REMOVAL ITEMS AND SHALL BE PERFORMED PRIOR TO BEGINNING REMOVAL. ANY ITEMS OF WORK REMOVED PRIOR TO SAWCUTTING WILL NOT BE MEASURED FOR PAYMENT.

ANY EXISTING PAVEMENT OUTSIDE THE AREAS DESIGNATED FOR REMOVAL IN THE PLANS DAMAGED BY THE CONTRACTOR DURING CONSTRUCTION SHALL BE REPLACED/REPAIRED BY THE CONTRACTOR AT HIS/HER OWN EXPENSE TO THE SATISFACTION OF THE ENGINEER WITH NO ADDITIONAL COMPENSATION TO THE CONTRACTOR.

**STAKING**

THE CONTRACTOR SHALL TAKE CARE TO PROTECT AND PRESERVE ALL STAKING AND MARKING DURING CONSTRUCTION. CONTINUOUS DESTRUCTION OF STAKES AS A RESULT OF CARELESSNESS MAY RESULT IN THE CONTRACTOR BEING BILLED FOR THE COST OF REPLACEMENT.

THE ENGINEER SHALL BE NOTIFIED AT LEAST TWO (2) DAYS PRIOR TO THE COMMENCEMENT OF WORK. THEY SHALL BE NOTIFIED AT LEAST 72 HOURS IN ADVANCE IF CONSTRUCTION STAKING IS REQUIRED.

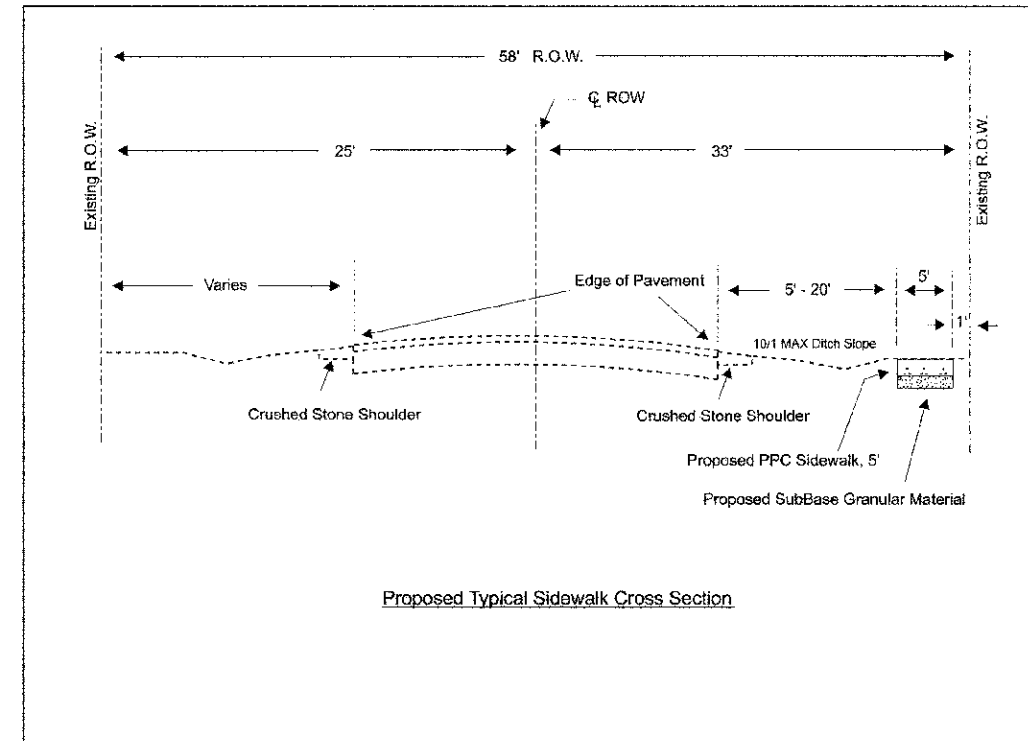

Proposed Typical Sidewalk Cross Section

FILE NAME =	USER NAME =	DESIGNED - RAS	REVISED - MAS 1/14/13
		DRAWN - RAS	REVISED - MAS 2/28/13
	PLOT SCALE = 1"=20'	CHECKED - TC	REVISED -
	PLOT DATE =	DATE - 12/27/12	REVISED -

STATE OF ILLINOIS  
DEPARTMENT OF TRANSPORTATION

GENERAL NOTES AND TYPICAL SECTIONS

SCALE: \_\_\_\_\_ SHEET NO. 30F 7 SHEETS STA. \_\_\_\_\_ TO STA. \_\_\_\_\_

F.A. RTE.	SECTION	COUNTY	TOTAL SHEETS	SHEET NO.
	12-LU001-00-SW	WILL	7	3
STA. 0+0 TO STA. 8+50 GREEN GARDEN PLACE		CONTRACT NO. 63820		
ILLINOIS FED. AID PROJECT				

PLAN  
 DESIGNED BY: \_\_\_\_\_ DATE: \_\_\_\_\_  
 DRAWN BY: \_\_\_\_\_  
 CHECKED BY: \_\_\_\_\_  
 DATE: \_\_\_\_\_

PROFILE  
 SURVEYED BY: \_\_\_\_\_ DATE: \_\_\_\_\_  
 PLOTTED BY: \_\_\_\_\_  
 CHECKED BY: \_\_\_\_\_  
 DATE: \_\_\_\_\_

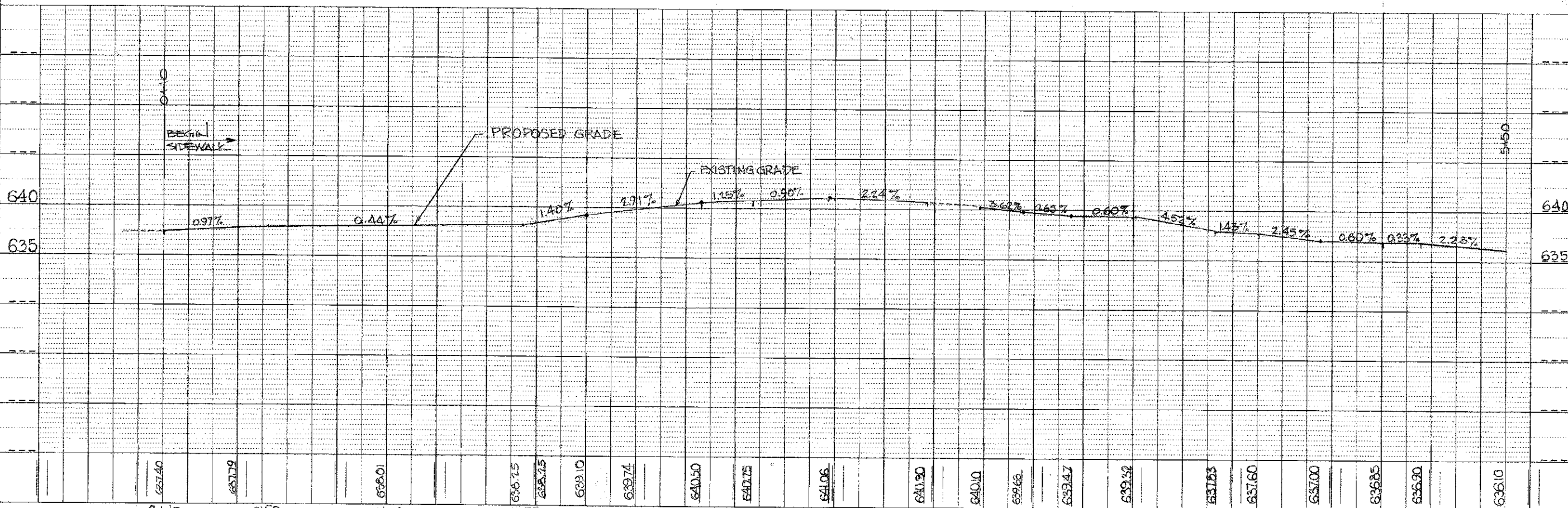
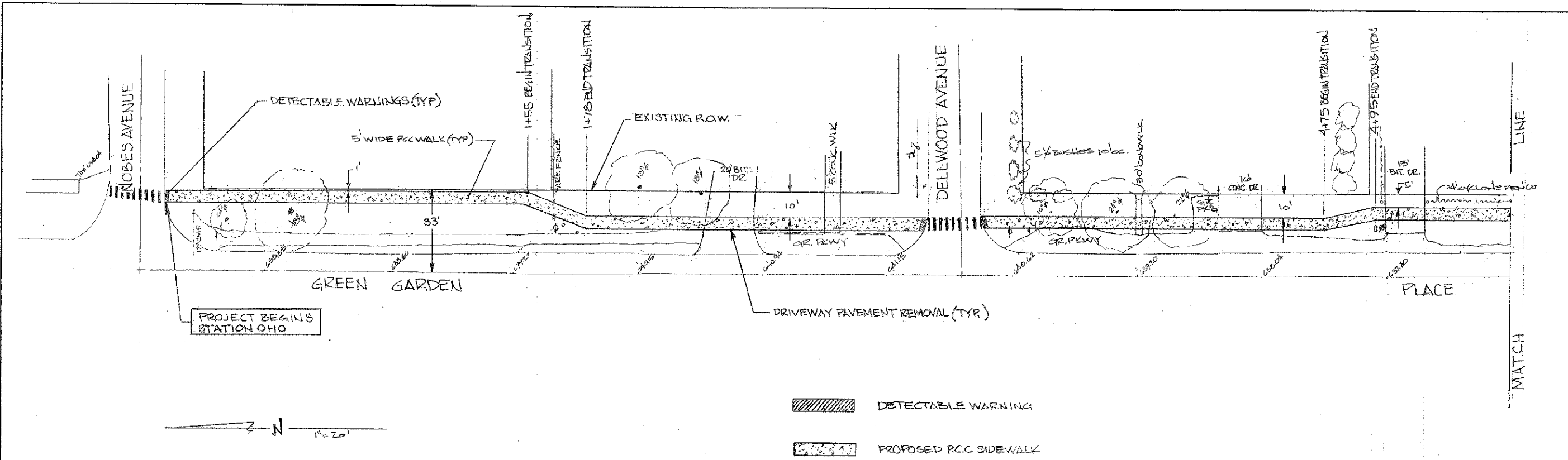

FILE NAME =	USER NAME =	DESIGNED - <b>RMB</b>	REVISED	STATE OF ILLINOIS DEPARTMENT OF TRANSPORTATION	GREEN GARDEN PLACE PLAN SHEET		F.A. RTE. =	SECTION	COUNTY	TOTAL SHEET SHEETS
		DRAWN - <b>RMB</b>	REVISED		SCALE: 1" = 20'	SHEET 4 OF 7 SHEETS	STA. 0+10 TO STA. 5+50	12-LU001-00-SW	WILL	7 4
		CHECKED - <b>TG</b>	REVISED							
		DATE - 12-27-12	REVISED							

DATE: \_\_\_\_\_ BY: \_\_\_\_\_  
 PLAN: \_\_\_\_\_  
 1077 BOOK NO. \_\_\_\_\_  
 1077 SHEET NO. \_\_\_\_\_

DATE: \_\_\_\_\_ BY: \_\_\_\_\_  
 PROFILE SHEET: \_\_\_\_\_  
 1077 BOOK NO. \_\_\_\_\_  
 1077 SHEET NO. \_\_\_\_\_

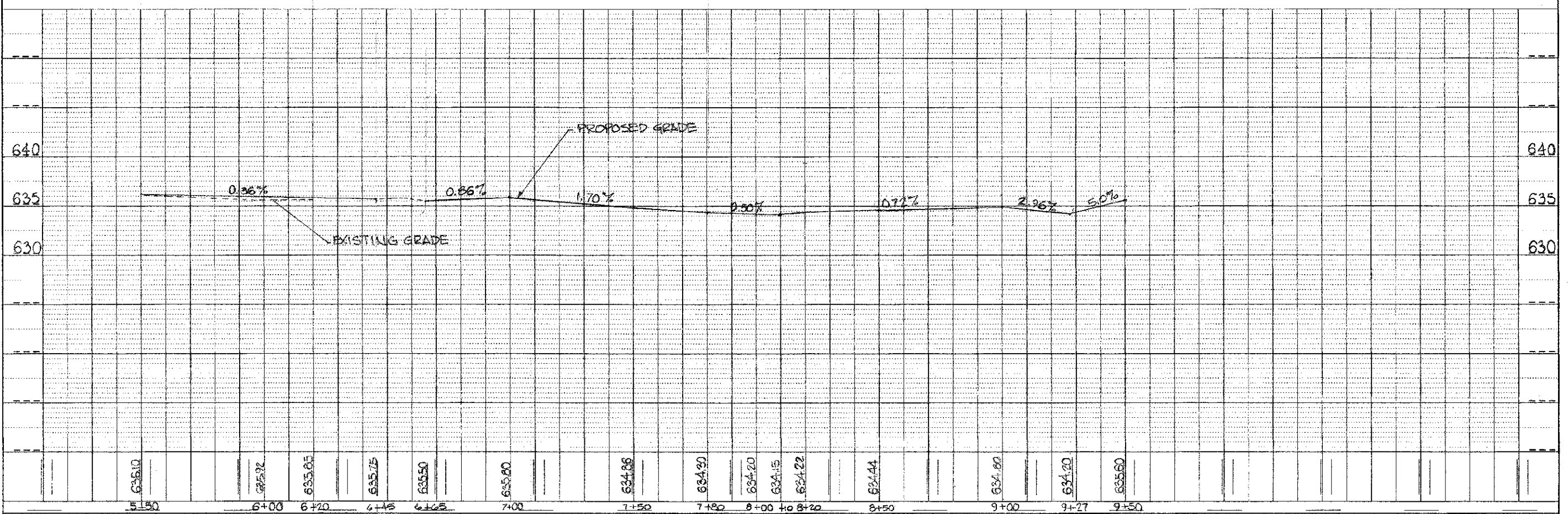
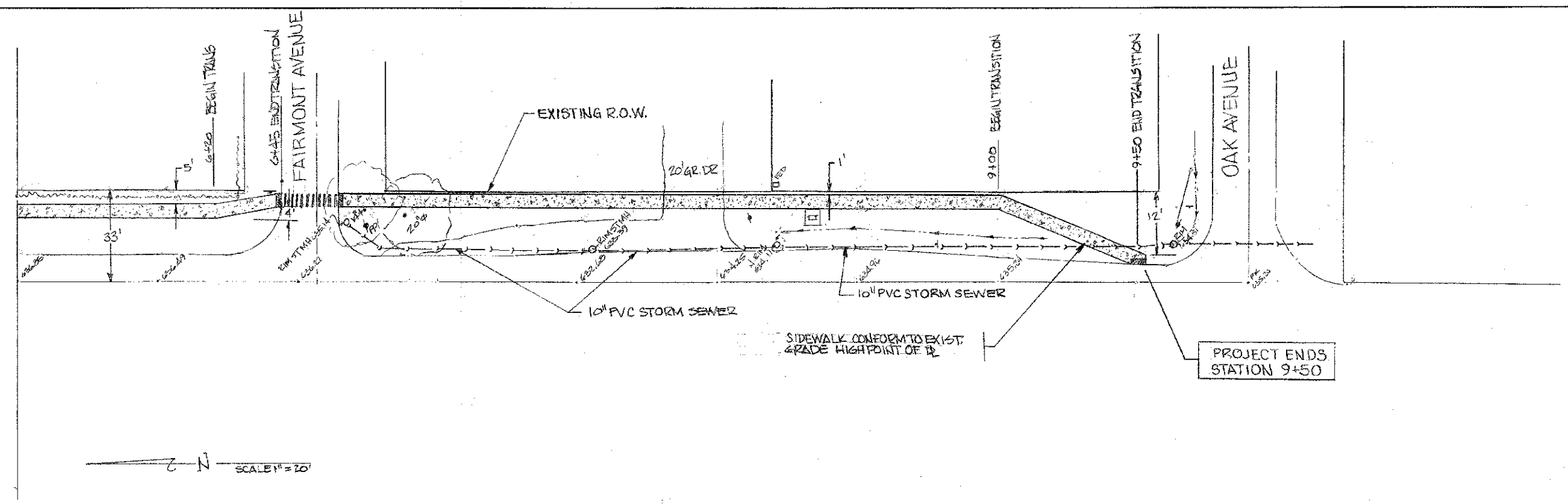

FILE NAME =	USER NAME =	DESIGNED - <u>RS</u>	REVISIONS	STATE OF ILLINOIS DEPARTMENT OF TRANSPORTATION	GREEN GARDEN PLACE PLAN SHEET	F.A. RT.:	SECTION	COUNTY	TOTAL SHEETS	SHEET NO.	
		DRAWN - <u>RS</u>	REVISIONS			Route	12-LU001-00-SW	WILL	7	5	
		CHECKED - <u>TE</u>	REVISIONS			CONTRACT NO. 63820		ILLINOIS FED. AID PROJECT			
		DATE - 12-27-12	REVISIONS			SCALE: SHEET 5 OF 7 SHEETS STA. 5+50 TO STA. 9+50					

DATE	
3	
DESIGNED	
PLANNED	
PLATTED	
ROUTE BOOK	
AREAS	
NO.	

DATE	
5	
DESIGNED	
PLANNED	
PLATTED	
ROUTE BOOK	
AREAS	
NO.	

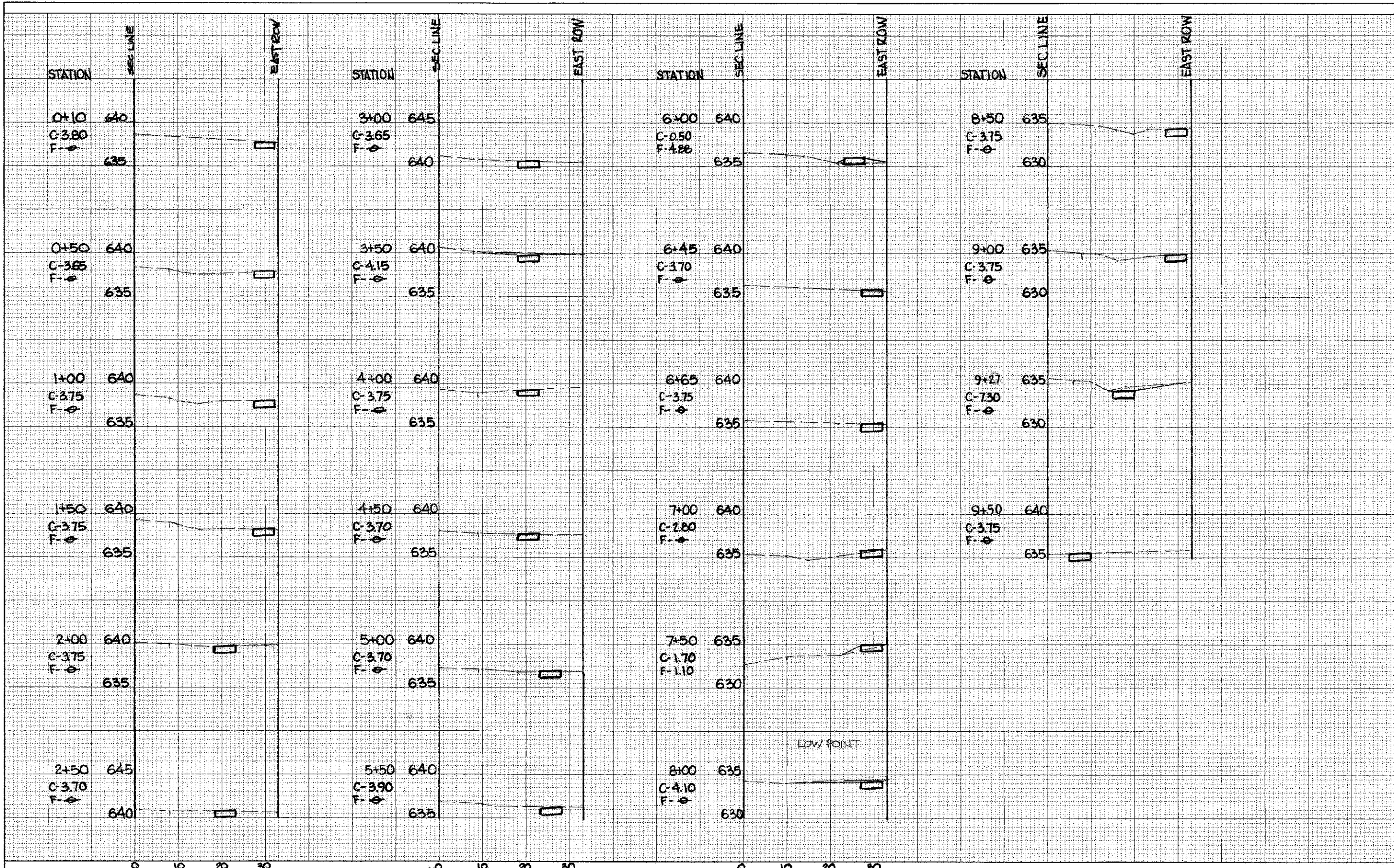

LOW POINT

FILE NAME	USFR NAME	DESIGNED	REVISIONS	F.A.E.A. SECTION	COUNTY	TOTAL SHEETS	SHEET NO.
		ZAS		12-LU001-00-SW	Will	7	6
PLLOT SCALE = 1" = 10' H / 1" = 5' V	CHECKED	DATE	REVISIONS	CONTRACT NO. 63820			
	TZ	12-27-02		ILLINOIS FED. AID PROJECT			
SCALE: _____ SHEET 6 OF 7 SHEETS STA. 0+10 TO STA. 9+50				GREEN GARDEN PLACE CROSS SECTIONS			

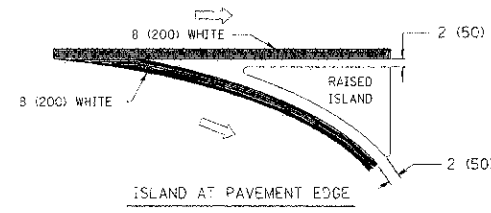
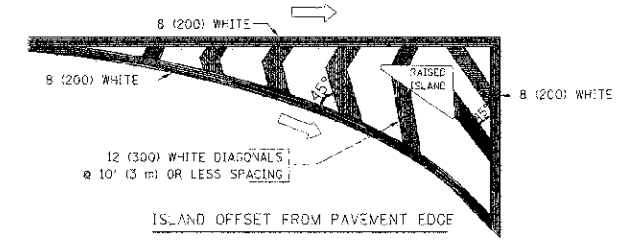
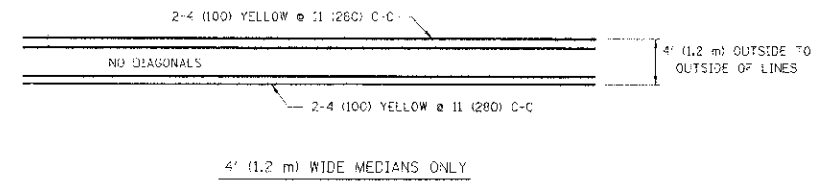
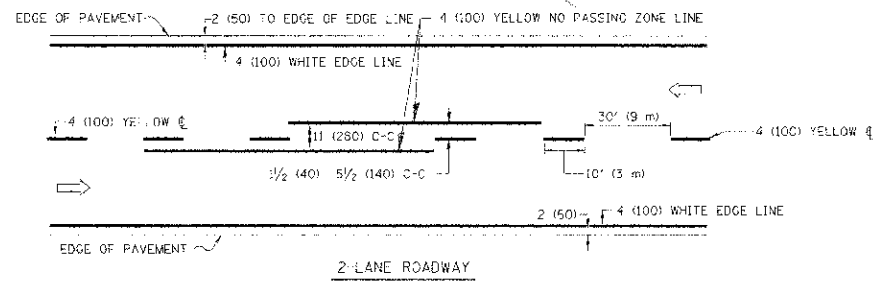

TYPICAL ISLAND MARKING

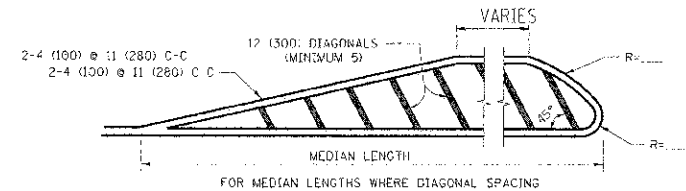
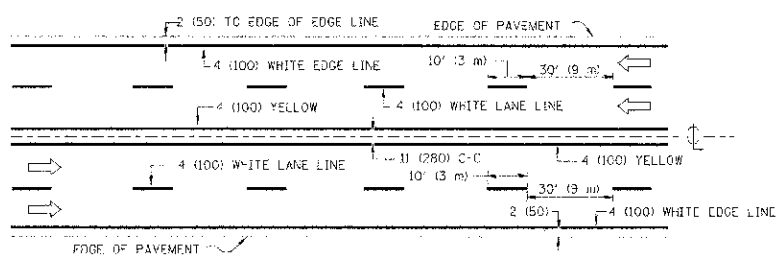

FOR MEDIAN LENGTHS WHERE DIAGONAL SPACING CANNOT BE ATTAINED, USE 5 (FIVE) EQUALLY SPACED DIAGONAL LINES.  
 DIAGONAL LINE SPACING: 50' (15 m) C-C (LESS THAN 30MPH (50 km/h))  
 75' (23 m) C-C (30MPH (50 km/h) TO 45MPH (70 km/h))  
 150' (45 m) C-C (MORE THAN 45MPH (70 km/h))

MEDIANS OVER 4' (1.2 m) WIDE

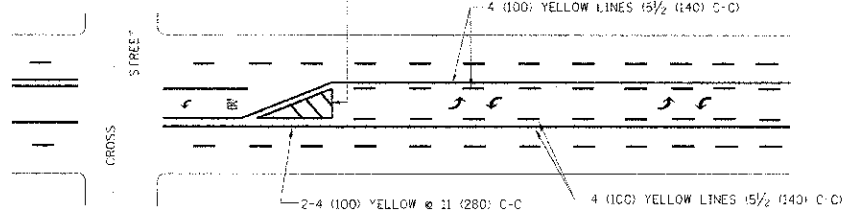

A MINIMUM OF TWO PAIRS OF TURN ARROWS SHALL BE USED, WHITE IN COLOR. ADDITIONAL PAIRS SHALL BE PLACED AT 200' (60 m) TO 300' (90 m) INTERVALS.

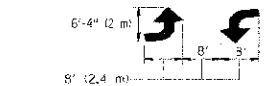

MEDIAN WITH TWO-WAY LEFT TURN LANE

TYPICAL PAINTED MEDIAN MARKING

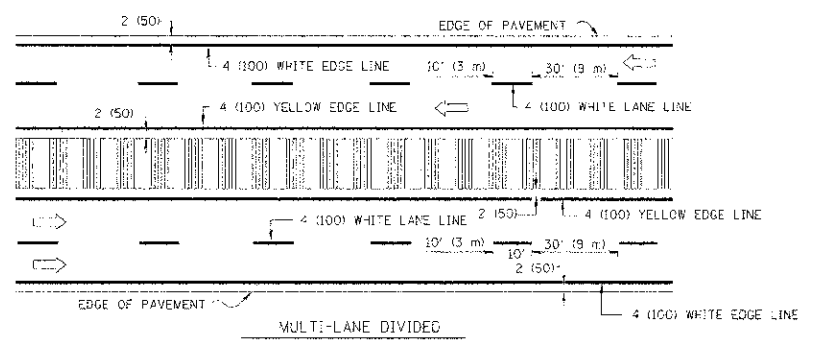

NOTE: MEDIANS WITH BARRIER CURB DO NOT REQUIRE AN EDGE LINE

TYPICAL LANE AND EDGE LINE MARKING

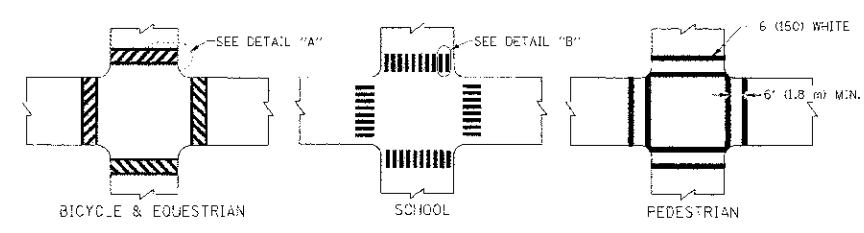

TYPICAL CROSSWALK MARKING

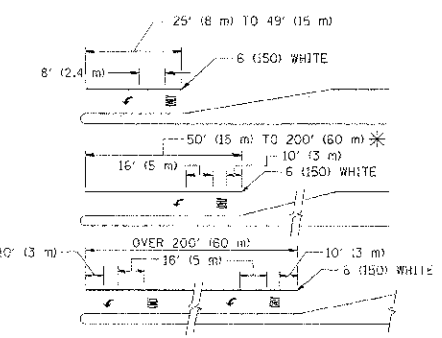

FULL SIZE LETTERS 8' (2.4 m) AND ARROWS SHALL BE USED.  
 AREA = 15.6 SQ. FT. (1.5 m<sup>2</sup>) ONLY AREA = 20.8 SQ. FT. (1.9 m<sup>2</sup>)  
 \* TURN LANES IN EXCESS OF 400' (120 m) IN LENGTH MAY HAVE AN ADDITIONAL SET OF ARROW - "ONLY" INSTALLED MIDWAY BETWEEN THE OTHER TWO SETS OF ARROW - "ONLY".

TYPICAL LEFT (OR RIGHT) TURN LANE

TYPICAL TURN LANE MARKING

TYPE OF MARKING	WIDTH OF LINE	PATTERN	COLOR	SPACING / REMARKS
CENTERLINE ON 2 LANE PAVEMENT	4 (100)	SKIP-DASH	YELLOW	10' (3 m) LINE WITH 30' (9 m) SPACE
CENTERLINE ON MULTI-LANE UNDIVIDED PAVEMENT	2 @ 4 (100)	SOLID	YELLOW	11 (280) C-C
NO PASSING ZONE LINES FOR ONE DIRECTION FOR BOTH DIRECTIONS	4 (100) 2 @ 4 (100)	SOLID SOLID	YELLOW YELLOW	5 1/2 (140) C-C FROM SKIP-DASH CENTERLINE 11 (280) C-C OMIT SKIP-DASH CENTERLINE BETWEEN
LANE LINES	4 (100) 5 (125) ON FREEWAYS	SKIP-DASH SKIP-DASH	WHITE WHITE	10' (3 m) LINE WITH 30' (9 m) SPACE
DOTTED LINES (EXTENSIONS OF CENTER, LANE OR TURN LANE MARKINGS)	SAME AS LINE BEING EXTENDED	SKIP-DASH	SAME AS LINE BEING EXTENDED	2' (600) LINE WITH 6' (1.8 m) SPACE
EDGE LINES	4 (100)	SOLID	YELLOW-LEFT WHITE-RIGHT	OUTLINE MOUNTABLE MEDIANS IN YELLOW; EDGE LINES ARE NOT USED NEXT TO BARRIER CURB
TURN LANE MARKINGS	8 (150) LINE; FULL SIZE LETTERS & SYMBOLS (8' (2.4m))	SOLID	WHITE	SEE TYPICAL TURN LANE MARKING DETAIL
TWO WAY LEFT TURN MARKING	2 @ 4 (100) 8' (2.4m) LEFT ARROW	SKIP-DASH AND SOLID IN PAIRS	YELLOW WHITE	10' (3 m) LINE WITH 30' (9 m) SPACE FOR SKIP-DASH 5/2 (140) C-C BETWEEN SOLID LINE AND SKIP-DASH LINE SEE TYPICAL TWO-WAY LEFT TURN MARKING DETAIL
CROSSWALK LINES (PEDESTRIAN) A. DIAGONALS (BIKE & PEDESTRIAN) B. LONGITUDINAL BARS (SCHOOL)	2 @ 6 (150) 12 (300) @ 45° 12 (300) @ 90°	SOLID SOLID	WHITE WHITE	NOT LESS THAN 6' (1.8 m) APART 2' (600) APART 2' (600) APART SEE TYPICAL CROSSWALK MARKING DETAILS.
STOP LINES	24 (600)	SOLID	WHITE	PLACE 2' (0.6 m) IN ADVANCE OF AND PARALLEL TO CROSSWALK, IF PRESENT. OTHERWISE, PLACE AT DESIRED STOPPING POINT, PARALLEL TO CROSSROAD CENTERLINE, WHERE POSSIBLE.
PAINTED MEDIANS	2 @ 4 (100) WITH 12 (300) DIAGONALS @ 45° NO DIAGONALS USED FOR 4' (1.2 m) WIDE MEDIANS	SOLID	YELLOW: TWO WAY TRAFFIC WHITE: ONE WAY TRAFFIC	11 (280) C-C FOR THE DOUBLE LINE SEE TYPICAL PAINTED MEDIAN MARKING.
GORE MARKING AND CHANNELIZING LINES	8 (200) WITH 12 (300) DIAGONALS @ 45°	SOLID	WHITE	DIAGONALS: 15' (4.5 m) C-C (LESS THAN 30MPH (50 km/h)) 20' (6 m) C-C (30MPH (50 km/h) TO 45MPH (70 km/h)) 30' (9 m) C-C (OVER 45MPH (70 km/h))
RAILROAD CROSSING	24 (600) TRANSVERSE LINES; "RR" IS 6' (1.8 m) LETTERS; 16 (400) LINE FOR "X"	SOLID	WHITE	SEE STATE STANDARD 780001 AREA OF: "R"=3.6 SQ. FT. (0.33 m <sup>2</sup> ) EACH "X"=54.0 SQ. FT. (5.0 m <sup>2</sup> )
SHOULDER DIAGONALS	12 (300) @ 45°	SOLID	WHITE - RIGHT YELLOW - LEFT	50' (15 m) C-C (LESS THAN 30MPH (50 km/h)) 75' (23 m) C-C (30 MPH (50 km/h) TO 45MPH (70 km/h)) 150' (45 m) C-C (OVER 45MPH (70 km/h))

FOR FURTHER DETAILS ON PAVEMENT MARKING REFER TO STANDARD SPECIFICATIONS FOR ROAD AND BRIDGE CONSTRUCTION AND STATE STANDARD 780001.

All dimensions are in inches (millimeters) unless otherwise shown.