

RESTORATION OF WORK AREA. RESTORATION OF THE TRAFFIC SIGNAL WORK AREA SHALL BE INCLUDED IN THE COST OF THE WORK PERFORMED AND NO EXTRA COMPENSATION SHALL BE ALLOWED. ALL ROADWAY SURFACES SUCH AS SHOULDERS, MEDIAN, SIDEWALKS, PAVEMENT, ETC. SHALL BE REPLACED IN KIND. ALL DAMAGE TO MOWED LAWNS SHALL BE REPLACED WITH AN APPROVED SOD, AND ALL DAMAGE TO UNMOWED FIELDS SHALL BE SEEDING IN ACCORDANCE WITH STANDARD SPECIFICATIONS 252 AND 250 RESPECTIVELY.

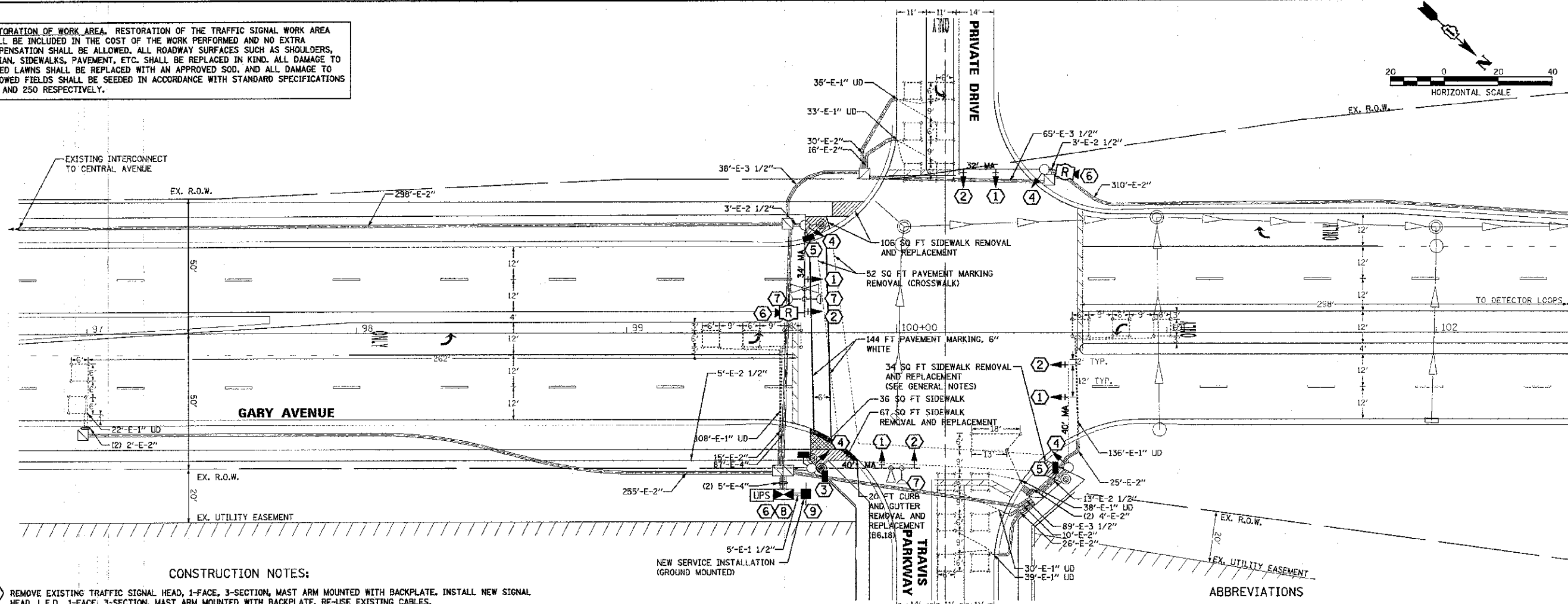
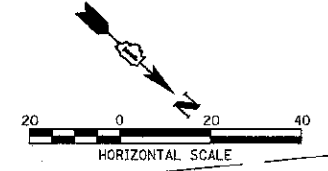

MATCHLINE STA. 102+50
SEE SHEET 5 FOR CONTINUATION

CONSTRUCTION NOTES:

- 1 REMOVE EXISTING TRAFFIC SIGNAL HEAD, 1-FACE, 3-SECTION, MAST ARM MOUNTED WITH BACKPLATE. INSTALL NEW SIGNAL HEAD, L.E.D., 1-FACE, 3-SECTION, MAST ARM MOUNTED WITH BACKPLATE. RE-USE EXISTING CABLES.
 - 2 REMOVE EXISTING TRAFFIC SIGNAL HEAD, 1-FACE, 5-SECTION, MAST ARM MOUNTED WITH BACKPLATE. INSTALL NEW SIGNAL HEAD, L.E.D., 1-FACE, 5-SECTION, MAST ARM MOUNTED WITH BACKPLATE. RE-USE EXISTING CABLES.
 - 3 REMOVE EXISTING PEDESTRIAN SIGNAL HEAD, 2-FACE, BRACKET MOUNTED. INSTALL NEW PEDESTRIAN SIGNAL HEAD WITH COUNTDOWN TIMER, L.E.D., 2-FACE, BRACKET MOUNTED. RE-USE EXISTING CABLES. INSTALL NEW PEDESTRIAN PUSH BUTTON FOR TRAVIS PARKWAY CROSSING ON EXISTING TRAFFIC SIGNAL POLE.
 - 4 REMOVE EXISTING TRAFFIC SIGNAL HEAD, 1-FACE, 5-SECTION, BRACKET MOUNTED. INSTALL NEW TRAFFIC SIGNAL HEAD, L.E.D., 1-FACE, 5-SECTION BRACKET MOUNTED. RE-USE EXISTING CABLES.
 - 5 REMOVE EXISTING PEDESTRIAN SIGNAL HEAD, 1-FACE, BRACKET MOUNTED. INSTALL NEW PEDESTRIAN SIGNAL HEAD WITH COUNTDOWN TIMER, L.E.D., 1-FACE, BRACKET MOUNTED. RE-USE EXISTING CABLES.
 - 6 INSTALL NEW RADAR VEHICLE DETECTION SYSTEM, BRACKET MOUNTED. PULL NEW CABLE TO CONTROL CABINET. CONTRACTOR TO COORDINATE INSTALLATION OF EQUIPMENT WITH RADAR DETECTION SYSTEM'S MANUFACTURER TO ENSURE PROPER CONFIGURATION AND OPERATION OF DEVICE, EXACT MOUNTING LOCATION TO BE DETERMINED BY FIELD TESTING AND APPROVAL OF MANUFACTURER OF DETECTION SYSTEM.
 - 7 REMOVE EXISTING CONFIRMATION BEACON INCANDESCENT BULB. INSTALL NEW CONFIRMATION BEACON L.E.D LAMP IN ACCORDANCE WITH DISTRICT ONE EMERGENCY VEHICLE PRIORITY SYSTEM SPECIFICATION AT NO ADDITIONAL COST TO CONTRACT (INCLUDED IN COST OF UNINTERRUPTIBLE POWER SUPPLY).
 - 8 REMOVE EXISTING TRAFFIC SIGNAL CABINET AND RETURN CABINET TO DUPAGE COUNTY AS DIRECTED BY THE ENGINEER. INSTALL NEW TRAFFIC SIGNAL CABINET, TYPE IV-4, AND RELOCATE EXISTING TRAFFIC SIGNAL CONTROLLER AND EMERGENCY VEHICLE PRIORITY SYSTEM, PHASING UNIT, INTO NEW CABINET ON EXISTING FOUNDATION. INSTALL NEW UNINTERRUPTIBLE POWER SUPPLY (UPS). REMOVE AND REPLACE DETECTOR LOOP AMPLIFIERS. INSTALL NEW LIGHT DETECTOR AMPLIFIER.
 - 9 INSTALL NEW GROUNDING CABLE AS SHOWN IN THE CABLE PLAN AND PROVIDE GROUNDING CONNECTION AS DETAILED IN IDOT DISTRICT ONE STANDARD, TS-05, SEE SHEET 21. REMOVE EXISTING GROUND MOUNTED SERVICE. INSTALL NEW GROUND MOUNTED SERVICE, MODEL TO BE APPROVED BY ENGINEER. EXISTING BASE AND MOUNTING POST FOR GROUND MOUNTED SERVICE SHALL BE RE-USED.
- * TYPE IV CABINET SHALL BE SIZED TO BE 65 INCHES TALL, 26 INCHES DEEP, AND 44 INCHES WIDE. SEE DETAILS ON SHEET 24.
 † RADAR VEHICLE DETECTION SYSTEM BACKPLATE AND ALL OTHER EQUIPMENT REQUIRED FOR PROPER INSTALLATION OF RADAR SENSORS INSIDE THE CONTROL CABINET SHALL BE PAID FOR AS "RADAR VEHICLE DETECTION SYSTEM". ALL OTHER EQUIPMENT REQUIRED FOR INSTALLATION OF RADAR SENSOR OUTSIDE THE CONTROL CABINET, INCLUDING CABLES AND BRACKETS, SHALL ALSO BE PAID FOR AS "RADAR VEHICLE DETECTION SYSTEM".



ALL EXISTING PEDESTRIAN PUSH-BUTTON SIGNAGE TO BE REMOVED. NEW PEDESTRIAN SIGNAGE TO BE INSTALLED ABOVE ALL EXISTING AND PROPOSED PEDESTRIAN PUSH-BUTTONS.

REMOVAL AND DISPOSAL OF EXISTING PUSH-BUTTON SIGNS SHALL BE INCLUDED IN THE PRICE OF "SIGN PANEL - TYPE 1"

GENERAL NOTES:

- ALL SIDEWALK REMOVAL AND REPLACEMENT AREAS SHALL BE FIELD VERIFIED SUCH THAT THE CROSSWALKS, RAMPS, AND SIDEWALK BENDS LEADING UP TO THE INTERSECTION MEET CURRENT ADA STANDARDS. ANY ADDITIONAL REMOVAL AND REPLACEMENT OF SIDEWALK SHALL BE PAID FOR AT THE UNIT PRICE OF "SIDEWALK REMOVAL" AND "PORTLAND CEMENT CONCRETE SIDEWALK 5 INCH" RESPECTIVELY. CONTRACTOR SHALL NOTIFY THE ENGINEER IF FIELD REVIEW WARRANTS ADDITIONAL QUANTITIES.
- THE EXISTING TRAFFIC SIGNAL CABINET SHALL BE RETURNED TO DUPAGE COUNTY. CONTRACTOR SHALL DELIVER EXISTING CABINET TO LOCATION AS DETERMINED BY THE ENGINEER. THIS WORK SHALL BE INCLUDED IN THE COST OF THE TRAFFIC SIGNAL CONTROL CABINET BEING INSTALLED.
- ALL SIDEWALK CROSSING LOCATIONS SHALL HAVE DETECTABLE WARNING PANELS INSTALLED PER HIGHWAY STANDARD 424001 AND SHALL BE PAID FOR AS "DETECTABLE WARNING". SIDEWALK WALK REMOVAL AND REPLACEMENT SHALL BE PAID FOR AS "SIDEWALK REMOVAL" AND "PORTLAND CEMENT CONCRETE SIDEWALK 5 INCH" RESPECTIVELY. ALL REQUIRED EXCAVATION, TOPSOIL, AND SEEDING/SODDING REQUIRED TO INSTALL SIDEWALK SHALL BE INCLUDED IN THE COST OF "PORTLAND CEMENT CONCRETE SIDEWALK 5 INCH".
- THE FOLLOWING ITEMS SHALL BE REMOVED BY THE CONTRACTOR AND SHALL BE DISPOSED OF BY THE CONTRACTOR OUTSIDE THE RIGHT-OF-WAY AT THE CONTRACTOR'S EXPENSE. THE SALVAGE VALUE OF THE REMOVED EQUIPMENT SHALL BE REFLECTED IN THE CONTRACT BID PRICE.

4 EACH	SIGNAL HEAD, 1-FACE, 3-SECTION	2 EACH	PEDESTRIAN SIGNAL, 1-FACE
8 EACH	SIGNAL HEAD, 1-FACE, 5-SECTION	1 EACH	PEDESTRIAN SIGNAL, 2-FACE
2 EACH	FLASHING BEACON, AMBER, 1-FACE	8 EACH	TRAFFIC SIGNAL BACKPLATE

ABBREVIATIONS

- 30'-E-1" UD (LENGTH OF ITEM) - (EXISTING) - (SIZE OF UNIT DUCT)
- 26'-E-2" (LENGTH OF ITEM) - (EXISTING) - (SIZE OF CONDUIT)
- 15'-UC (LENGTH OF ITEM) - (UNDERGROUND CONDUIT)
- 2 1/2" (SIZE OF CONDUIT)

TRAFFIC SIGNAL LEGEND

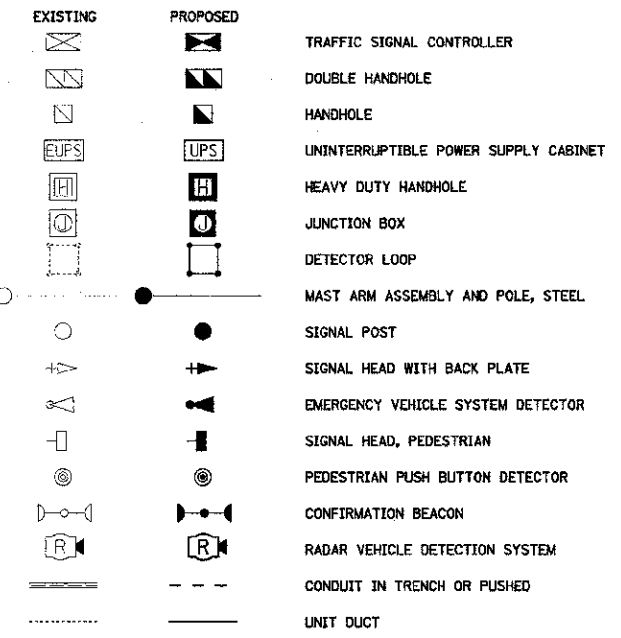

FILE NAME: J:\Projects\485591\485591.dwg Models and Sheets\DC-C-Dwg1\Sheets\013 signal.dwg

USER NAME = zulkowid	DESIGNED - JAC	REVISED -
PLOT SCALE = 48.0000 1/2 in.	DRAWN - SDZ	REVISED -
PLOT DATE = 4/2/2013	CHECKED - JAP	REVISED -
	DATE - 03-22-2013	REVISED -

**STATE OF ILLINOIS
DEPARTMENT OF TRANSPORTATION**

**GARY AVENUE AT TRAVIS PARKWAY
TRAFFIC SIGNAL MODIFICATION PLAN**

SCALE: 1" = 20' SHEET NO. 4 OF 24 SHEETS STA. 96+75.00 TO STA. 102+50.00

F.A.U. RTE.	SECTION	COUNTY	TOTAL SHEETS	SHEET NO.
2561	11-00237-12-5P	DUPAGE/COOK	24	4
CONTRACT NO. 63821				
ILLINOIS FED. AID PROJECT HSIP-0043 (029)				