

ROUTE NO.	SECTION	COUNTY	TOTAL SHEETS	SHEET NO.
FAP 326	11-00001-00-CH	KANE	55	17

**STATE OF ILLINOIS  
DEPARTMENT OF TRANSPORTATION  
DIVISION OF HIGHWAYS**

**PLAT OF HIGHWAY**

**ROUTE: F.A.P. 326 (IL 47) & OLD OAKS ROAD  
SEC. 5 T38N, R7E OF THE 3RD P.M.  
PROJECT: R-91-017-13  
KANE COUNTY**

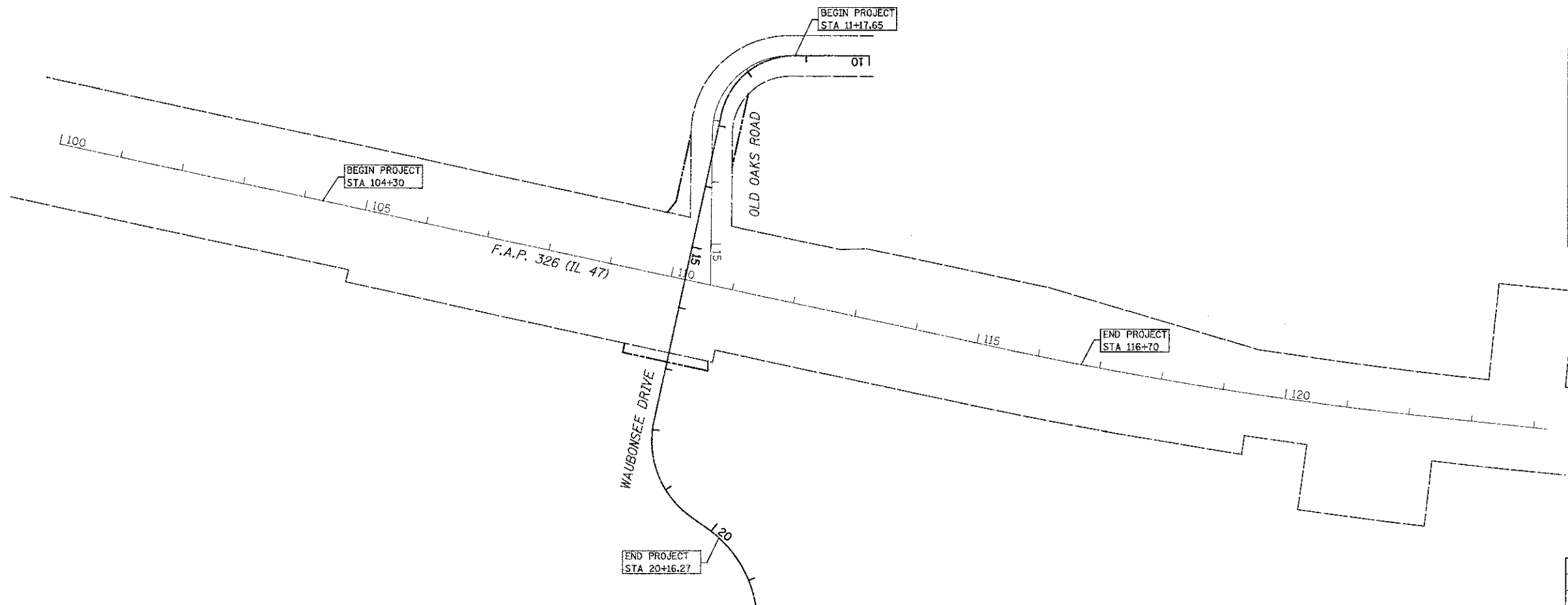
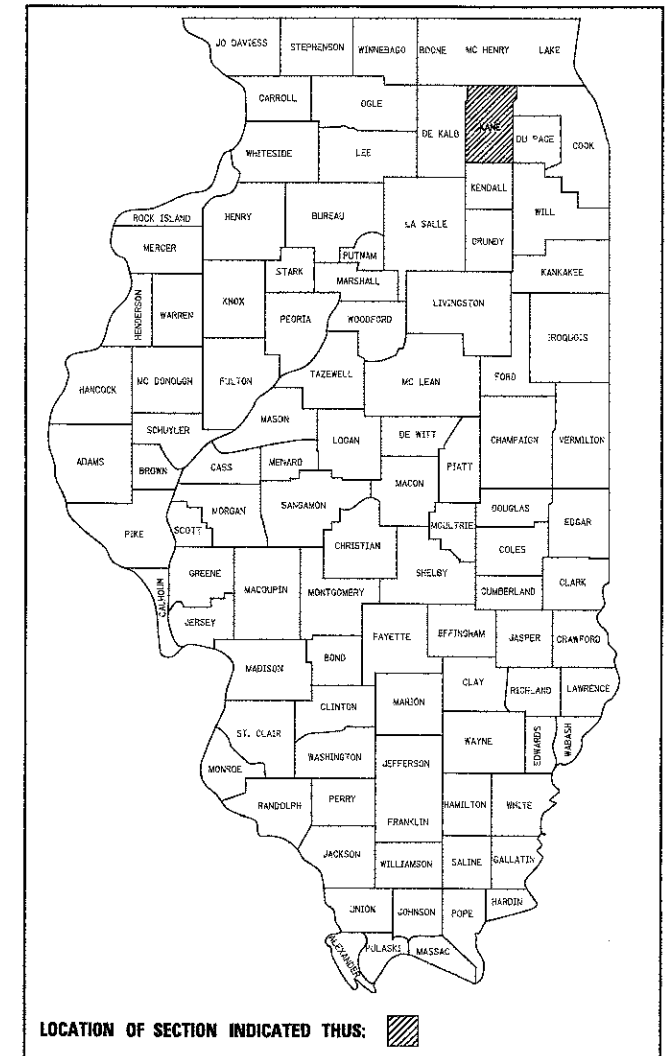

**J.U.L.I.E.  
JOINT UTILITY LOCATION INFORMATION FOR EXCAVATION  
1-800-892-0123**



**PATRICK ENGINEERING INC.**  
4970 VARSITY DRIVE  
LISLE, IL 60532  
patrickengineering.com  
Design Firm License No. 184-000409

REVISION	DATE	DESCRIPTION

STATE OF ILLINOIS DEPARTMENT OF TRANSPORTATION  
**PLAT OF HIGHWAYS**  
ROUTE F.A.P. 326 (IL 47)  
SECTION 11-00001-00-CH  
KANE COUNTY  
JOB# 21250.013 PROJ# R-91-017-13  
SEC 5 T 38N, R 7E OF 3RD P.M.  
DRAWN RJP CHECKED CD/SL  
SCALE: 1" = 100' SHEET NO. 17 of 55