

STATE OF ILLINOIS
DEPARTMENT OF TRANSPORTATION
DIVISION OF HIGHWAYS

PLANS FOR PROPOSED
FEDERAL AID HIGHWAY

FAU 1379 (FULLERTON AVENUE) AND VARIOUS ROUTES
PRESIDENT STREET TO BLOOMINGDALE ROAD AND NEAR VARIOUS SCHOOLS
TRAFFIC CALMING, INSTALLATION OF STREET SIGNS, AND PAVEMENT MARKING

Section No.: 12-00062-00-SP
Project No. SRTS-4009(132)
VILLAGE OF GLENDALE HEIGHTS
DUPAGE COUNTY
JOB NO.: C-91-410-12

F.A.U. RTE.	SECTION	COUNTY	TOTAL SHEETS	SHEET NO.
1379	12-00062-00-SP	DUPAGE	10	1

ILLINOIS FED. AID PROJECT

CONTRACT NO. 63832

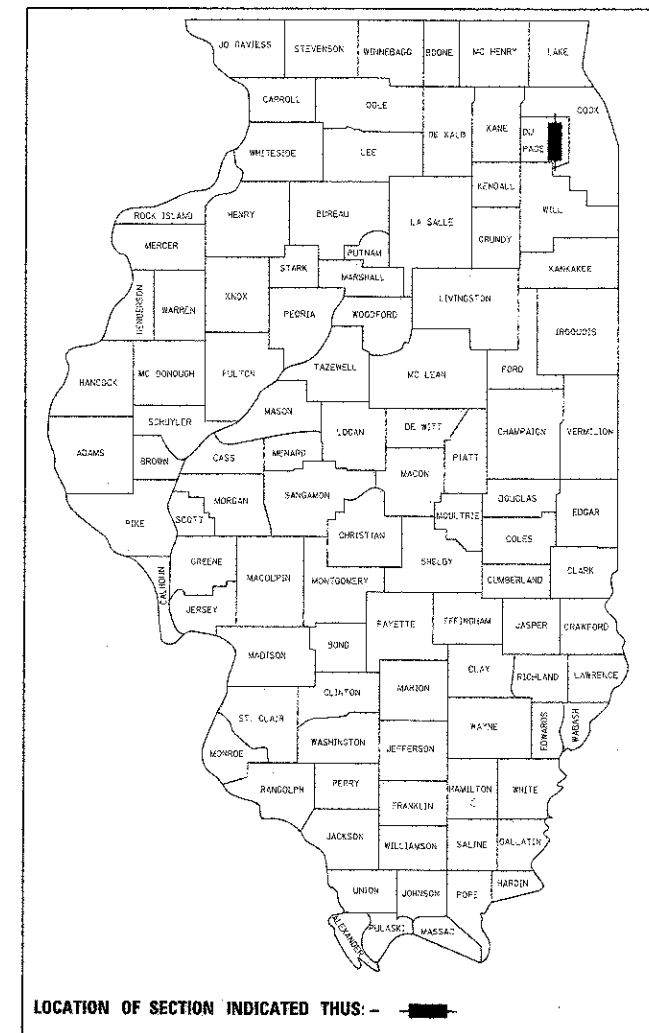

INDEX OF SHEETS

SHEET NO.	DESCRIPTION
1	COVER SHEET
2	GENERAL NOTES AND HIGHWAY STANDARDS
3	SCHEDULES OF QUANTITIES
4	TYPICAL SECTIONS
5	ROADWAY PLANS
6	CONSTRUCTION DETAILS
7	SIGNAGE AND PAVEMENT MARKING LOCATION MAP
8	CURB OR CURB AND GUTTER REMOVAL AND REPLACEMENT
9	DISTRICT ONE TYPICAL PAVEMENT MARKINGS
10	TRAFFIC CONTROL AND PROTECTION FOR SIDE ROADS, INTERSECTIONS, AND DRIVEWAYS

TRAFFIC DATA
CLASSIFICATION - RESIDENTIAL COLLECTOR
ADT (2011) = 6700
SPEED LIMIT = 25 MPH

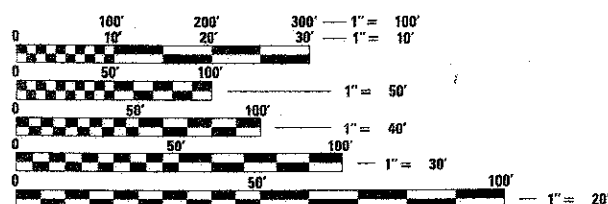

FULL SIZE PLANS HAVE BEEN PREPARED USING STANDARD ENGINEERING SCALES. REDUCED SIZED PLANS WILL NOT CONFORM TO STANDARD SCALES. IN MAKING MEASUREMENTS ON REDUCED PLANS, THE ABOVE SCALES MAY BE USED.

J.U.L.I.E.
JOINT UTILITY LOCATION INFORMATION FOR EXCAVATION
1-800-892-0123

BEGIN PROJECT
STA. 12+42.7

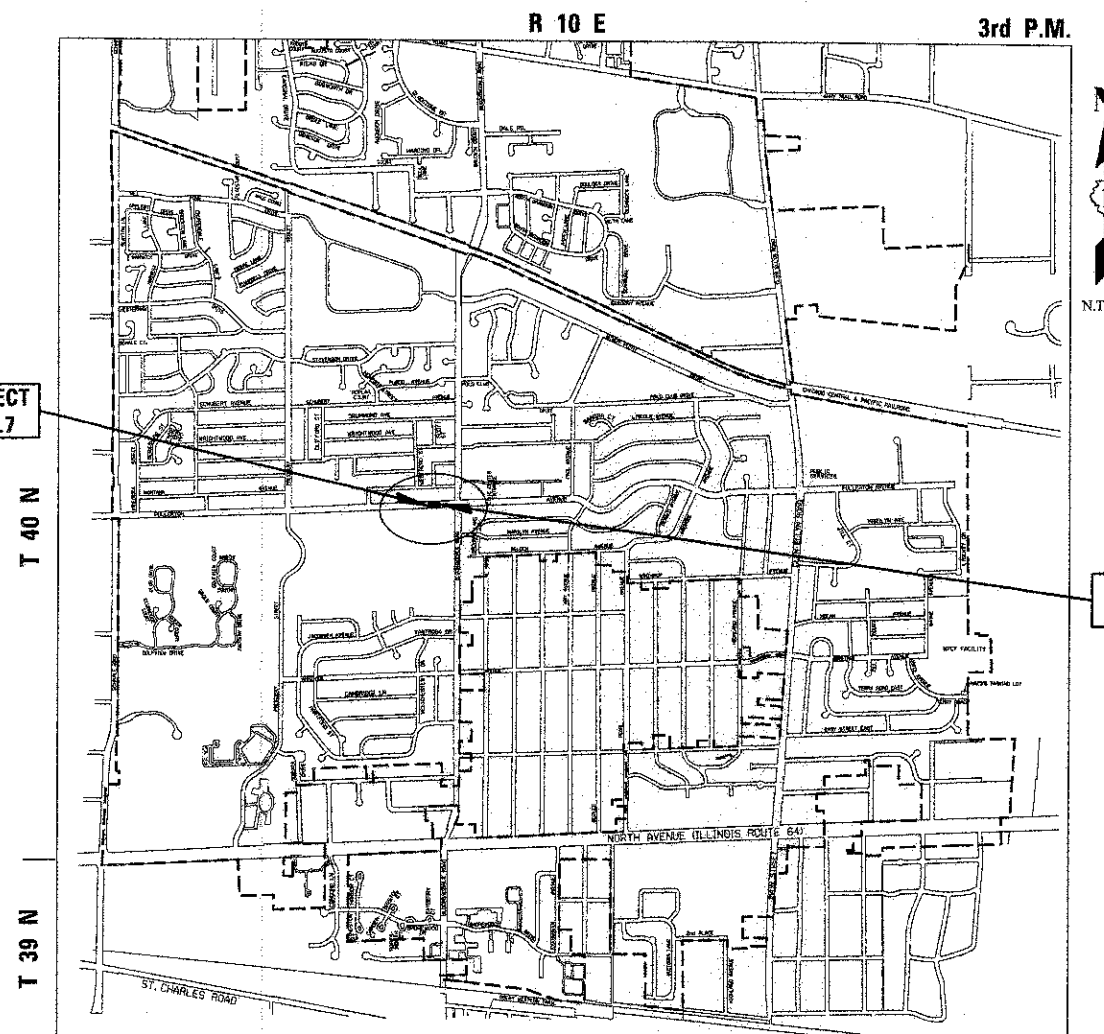

END PROJECT
STA. 12+80.6

LOCATION MAP - BLOOMINGDALE TOWNSHIP
GROSS LENGTH OF PROJECT = 37.9 LINEAL FEET (0.01 MI.)
NET LENGTH OF PROJECT = 37.9 LINEAL FEET (0.01 MI.)

STATE OF ILLINOIS
DEPARTMENT OF TRANSPORTATION
DIVISION OF HIGHWAYS

APPROVED 3/19 20 13
Sandra Jackson MAYOR
VILLAGE OF GLENDALE HEIGHTS

PASSED APRIL 9 20 13
C. H. Hill C.J. HILL
DISTRICT 1 ENGINEER OF LOCAL ROADS AND STREETS

RELEASING FOR
BID BASED ON
LIMITED REVIEW April 10 20 13
John Pufundt
DEPUTY DIRECTOR OF HIGHWAYS
REGION ONE ENGINEER



March 25, 2013
Andrew Pufundt
ANDREW M. PUFUNDT
ILLINOIS REGISTRATION NO. 062-061729 ENGINEER
EXPIRATION DATE: 11/30/13

PRINTED BY THE AUTHORITY OF THE STATE OF ILLINOIS

CHRISTOPHER B. BURKE ENGINEERING LTD.
9575 West Higgins Road, Suite 600
Rosemont, Illinois 60018 (847) 823-0500



PROGRAM AND OFFICE ENGINEER: CHARLES F. RIDGLE, P.E. (847) 705-4486, SCHAMBERG, IL

CONTRACT NO. 63832