



1"=40'



REMOVAL LEGEND

- DENOTES HOT-MIX ASPHALT SURFACE REMOVAL—BUTT JOINT
- DENOTES HOT-MIX ASPHALT SURFACE REMOVAL, 3 INCH, (0' TO 3' WIDTH & VARIES) SURFACE REMOVAL SHALL COMMENCE ONLY AFTER PLACEMENT OF HOT-MIX ASPHALT BASE COURSE, 9 INCH IN PAVEMENT REMOVAL AREA IS COMPLETED.
- DENOTES PAVEMENT REMOVAL
- DENOTES DRIVEWAY PAVEMENT REMOVAL
- DENOTES SIDEWALK REMOVAL
- 8 FT DENOTES COMBINATION CURB AND GUTTER REMOVAL
- "A"** DENOTES EXISTING VALVE VAULTS, VALVE BOXES, INLETS, CATCH BASINS AND MANHOLES TO BE ADJUSTED
- "BO"** DENOTES EXISTING TO BE ADJUSTED (BY OTHERS)
- "S"** DENOTES EXISTING FRAMES AND LIDS TO BE ADJUSTED (SPECIAL)
- "OL"** DENOTES NEW FRAMES AND LIDS, TYPE I, OPEN LID
- "CL"** DENOTES NEW FRAMES AND LIDS, TYPE I, CLOSED LID
- "R"** DENOTES EXISTING VALVE VAULTS TO BE RECONSTRUCTED
- *** DENOTES ALLEY RETURN OR DRIVEWAY TO BE REMOVED WITH PAVEMENT REMOVAL

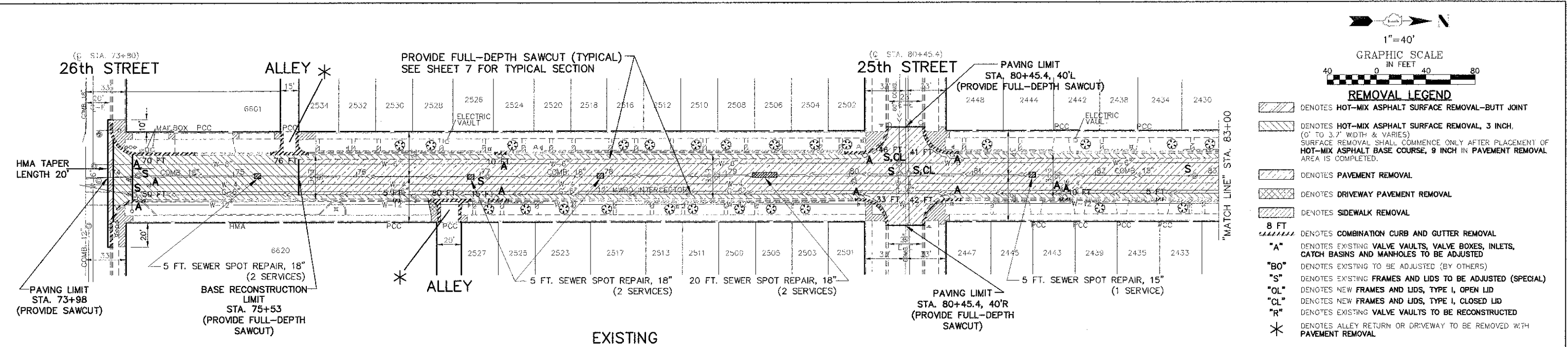

EXISTING

FOR CONTINUATION SEE SHEET 11

FOR CONTINUATION SEE SHEET 13

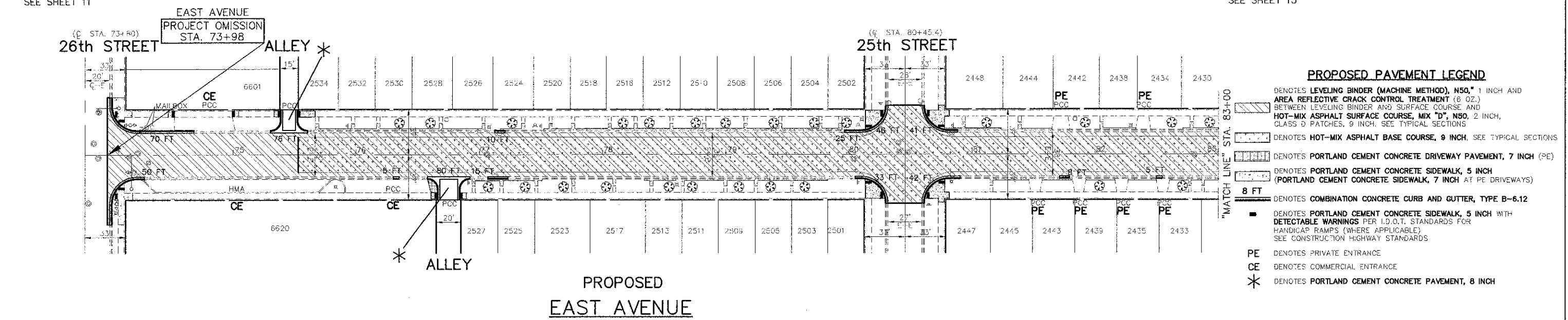

PROPOSED EAST AVENUE

PROPOSED PAVEMENT LEGEND

- DENOTES LEVELING BINDER (MACHINE METHOD), N50, 1 INCH AND AREA REFLECTIVE CRACK CONTROL TREATMENT (8 OZ.) BETWEEN LEVELING BINDER AND SURFACE COURSE AND HOT-MIX ASPHALT SURFACE COURSE, MIX "D", N50, 2 INCH, CLASS 5 PATCHES, 9 INCH. SEE TYPICAL SECTIONS
- DENOTES HOT-MIX ASPHALT BASE COURSE, 9 INCH. SEE TYPICAL SECTIONS
- DENOTES PORTLAND CEMENT CONCRETE DRIVEWAY PAVEMENT, 7 INCH (PE)
- DENOTES PORTLAND CEMENT CONCRETE SIDEWALK, 5 INCH (PORTLAND CEMENT CONCRETE SIDEWALK, 7 INCH AT PE DRIVEWAYS)
- 8 FT DENOTES COMBINATION CONCRETE CURB AND GUTTER, TYPE B-6.12
- DENOTES PORTLAND CEMENT CONCRETE SIDEWALK, 5 INCH WITH DETECTABLE WARNINGS PER I.D.O.T. STANDARDS FOR HANDICAP RAMPS (WHERE APPLICABLE) SEE CONSTRUCTION HIGHWAY STANDARDS
- PE** DENOTES PRIVATE ENTRANCE
- CE** DENOTES COMMERCIAL ENTRANCE
- *** DENOTES PORTLAND CEMENT CONCRETE PAVEMENT, 8 INCH

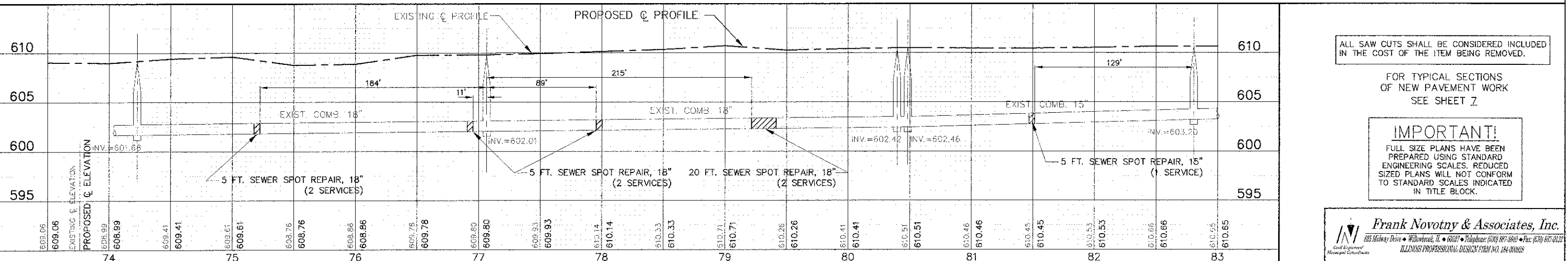

ALL SAW CUTS SHALL BE CONSIDERED INCLUDED IN THE COST OF THE ITEM BEING REMOVED.

FOR TYPICAL SECTIONS OF NEW PAVEMENT WORK SEE SHEET 2

IMPORTANT!
FULL SIZE PLANS HAVE BEEN PREPARED USING STANDARD ENGINEERING SCALES. REDUCED SIZED PLANS WILL NOT CONFORM TO STANDARD SCALES INDICATED IN TITLE BLOCK.

| | | | | | | | | | | | |
|---|-----------------|-------------------|--|---|--|--------------------|---------------------------|---------------------------|--------------------|-----------------|-----------------------|
| FILE NAME CITY OF BERWYN EAST AVENUE 31st STREET TO GERMAK ROAD RESURFACING | USER NAME - | DESIGNED - IHK | REVISIONS - JEF 3-13-13 - JEF 4-5-13 | STATE OF ILLINOIS DEPARTMENT OF TRANSPORTATION | PLAN & PROFILE: EAST AVENUE - STA. 74+13 TO STA. 83+00 (RESURFACING AND RECONSTRUCTION) | F.A.L. NO. 2779 | SECTION 09-00187-00-RS | COUNTY COOK | TOTAL SHEETS 31 | SHEET NO. 12 | CONTRACT NO. 63837 |
| DATE 1-24-13 | PILOT DATE - | CHECKED - JEF | REVISIONS - | SCALE: 1"=40' | SHEET NO. OF SHEETS | STA. TO STA. | FED. ROAD DIST. NO. | ILLINOIS FED. AID PROJECT | M-4003(087) | | |

Frank Novotny & Associates, Inc.
 285 Mainway Drive • Wheelersville, IL • 61897 • Telephone: (618) 987-8860 • Fax: (618) 687-0137
 ILLINOIS PROFESSIONAL DESIGN FIRM NO. 184-00069