

- REMOVAL LEGEND**
- DENOTES HOT-MIX ASPHALT SURFACE REMOVAL-BUTT JOINT
  - DENOTES HOT-MIX ASPHALT SURFACE REMOVAL, 3 INCH. (0' TO 3.7' WIDTH & VARIES) SURFACE REMOVAL SHALL COMMENCE ONLY AFTER PLACEMENT OF HOT-MIX ASPHALT BASE COURSE, 9 INCH IN PAVEMENT REMOVAL AREA IS COMPLETED.
  - DENOTES PAVEMENT REMOVAL
  - DENOTES DRIVEWAY PAVEMENT REMOVAL
  - DENOTES SIDEWALK REMOVAL
  - DENOTES COMBINATION CURB AND GUTTER REMOVAL
  - "A"** DENOTES EXISTING VALVE VAULTS, VALVE BOXES, INLETS, CATCH BASINS AND MANHOLES TO BE ADJUSTED
  - "BO"** DENOTES EXISTING TO BE ADJUSTED (BY OTHERS)
  - "S"** DENOTES EXISTING FRAMES AND LIDS TO BE ADJUSTED (SPECIAL)
  - "OL"** DENOTES NEW FRAMES AND LIDS, TYPE I, OPEN LID
  - "CL"** DENOTES NEW FRAMES AND LIDS, TYPE I, CLOSED LID
  - "R"** DENOTES EXISTING VALVE VAULTS TO BE RECONSTRUCTED
  - DENOTES ALLEY RETURN OR DRIVEWAY TO BE REMOVED WITH PAVEMENT REMOVAL

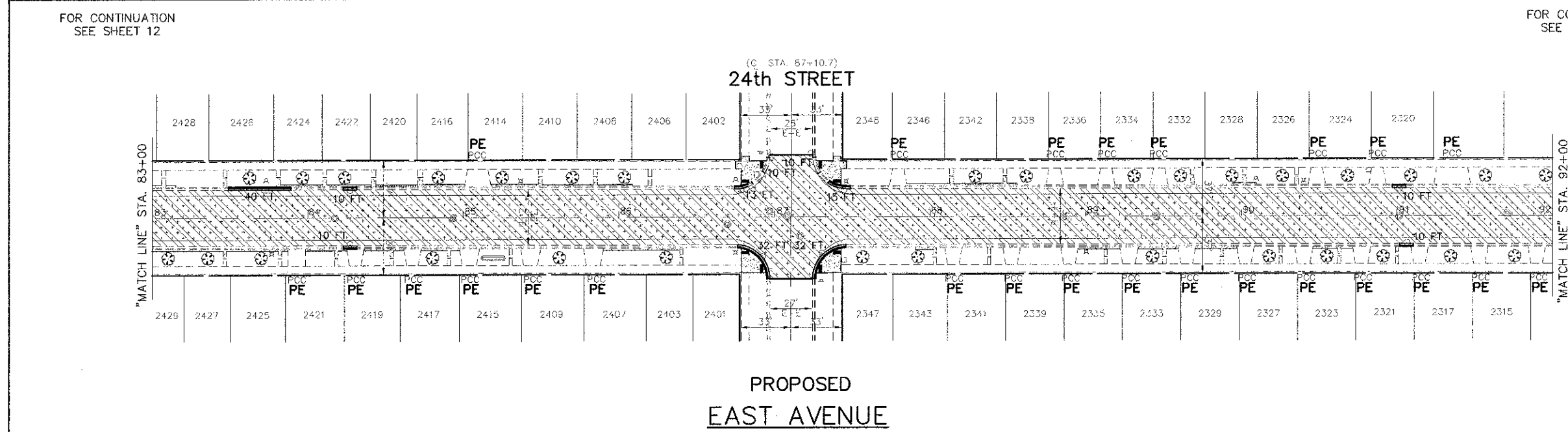

- PROPOSED PAVEMENT LEGEND**
- DENOTES LEVELING BINDER (MACHINE METHOD), N50, 1 INCH AND AREA REFLECTIVE CRACK CONTROL TREATMENT (6 OZ.) BETWEEN LEVELING BINDER AND SURFACE COURSE AND HOT-MIX ASPHALT SURFACE COURSE, MIX "D", N50, 2 INCH, CLASS D PATCHES, 9 INCH. SEE TYPICAL SECTIONS
  - DENOTES HOT-MIX ASPHALT BASE COURSE, 9 INCH, SEE TYPICAL SECTIONS
  - DENOTES PORTLAND CEMENT CONCRETE DRIVEWAY PAVEMENT, 7 INCH (PE)
  - DENOTES PORTLAND CEMENT CONCRETE SIDEWALK, 5 INCH (PORTLAND CEMENT CONCRETE SIDEWALK, 7 INCH AT PE DRIVEWAYS)
  - DENOTES COMBINATION CONCRETE CURB AND GUTTER, TYPE B-6.12
  - DENOTES PORTLAND CEMENT CONCRETE SIDEWALK, 5 INCH WITH DETECTABLE WARNINGS PER I.D.O.T. STANDARDS FOR HANDICAP RAMPS (WHERE APPLICABLE) SEE CONSTRUCTION HIGHWAY STANDARDS
  - PE** DENOTES PRIVATE ENTRANCE
  - CE** DENOTES COMMERCIAL ENTRANCE
  - DENOTES PORTLAND CEMENT CONCRETE PAVEMENT, 8 INCH

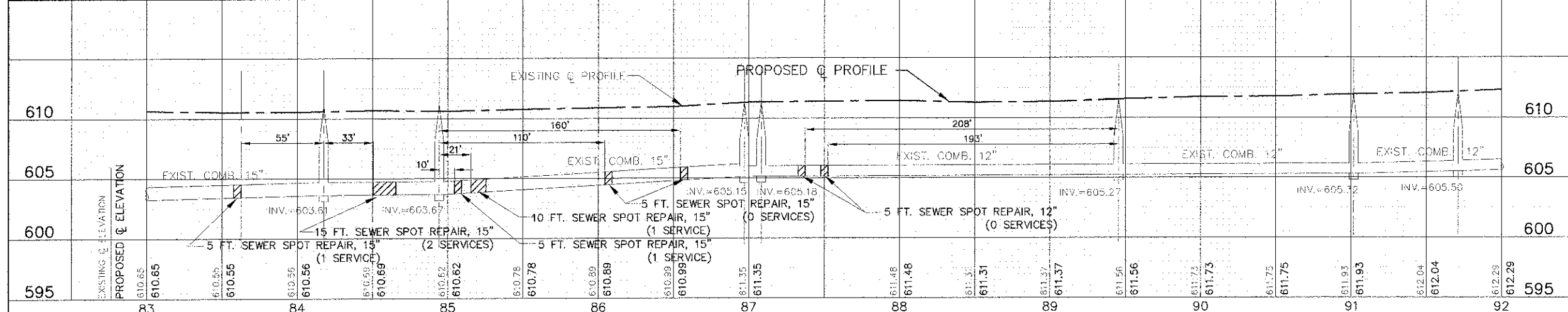

ALL SAW CUTS SHALL BE CONSIDERED INCLUDED IN THE COST OF THE ITEM BEING REMOVED.

FOR TYPICAL SECTIONS OF NEW PAVEMENT WORK SEE SHEET Z

**IMPORTANT!**  
FULL SIZE PLANS HAVE BEEN PREPARED USING STANDARD ENGINEERING SCALES. REDUCED SIZED PLANS WILL NOT CONFORM TO STANDARD SCALES INDICATED IN TITLE BLOCK.

FILE NAME: CITY OF BERWYN  
EAST AVENUE  
31st STREET TO CERMAK ROAD  
RESURFACING

USER NAME: THK  
DESIGNED: THK  
DRAWN: JFP  
CHECKED: JFP  
DATE: 1-24-13

REVISIONS:  
REVISED: JEF 3-13-13  
REVISED: JEF 4-5-13

STATE OF ILLINOIS  
DEPARTMENT OF TRANSPORTATION

PLAN & PROFILE: EAST AVENUE - STA. 83+00 TO STA. 92+00  
(RESURFACING AND RECONSTRUCTION)

SCALE: 1"=40' SHEET NO. OF SHEETS STA. TO STA.

**Frank Novotny & Associates, Inc.**  
605 Midway Drive • Wheeling, IL • 60091 • Telephone: (815) 851-8100 • Fax: (815) 851-0130  
ILLINOIS PROFESSIONAL DESIGN FIRM NO. 181-000208

PLAN NO.	SECTION	COUNTY	TOTAL SHEETS	SHEET NO.
2779	09-00167-00-RS	COOK	31	13
CONTRACT NO. 63837				
FED. ROAD DIST. NO.		ILLINOIS FED. AID PROJECT	M-4003(087)	