

# STANDARD INLET DETAIL FOR CURB & GUTTER TYPE M-4.24

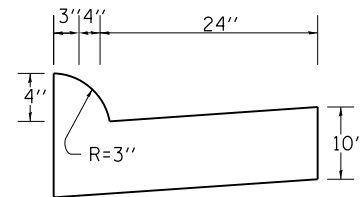

SECTION A-A

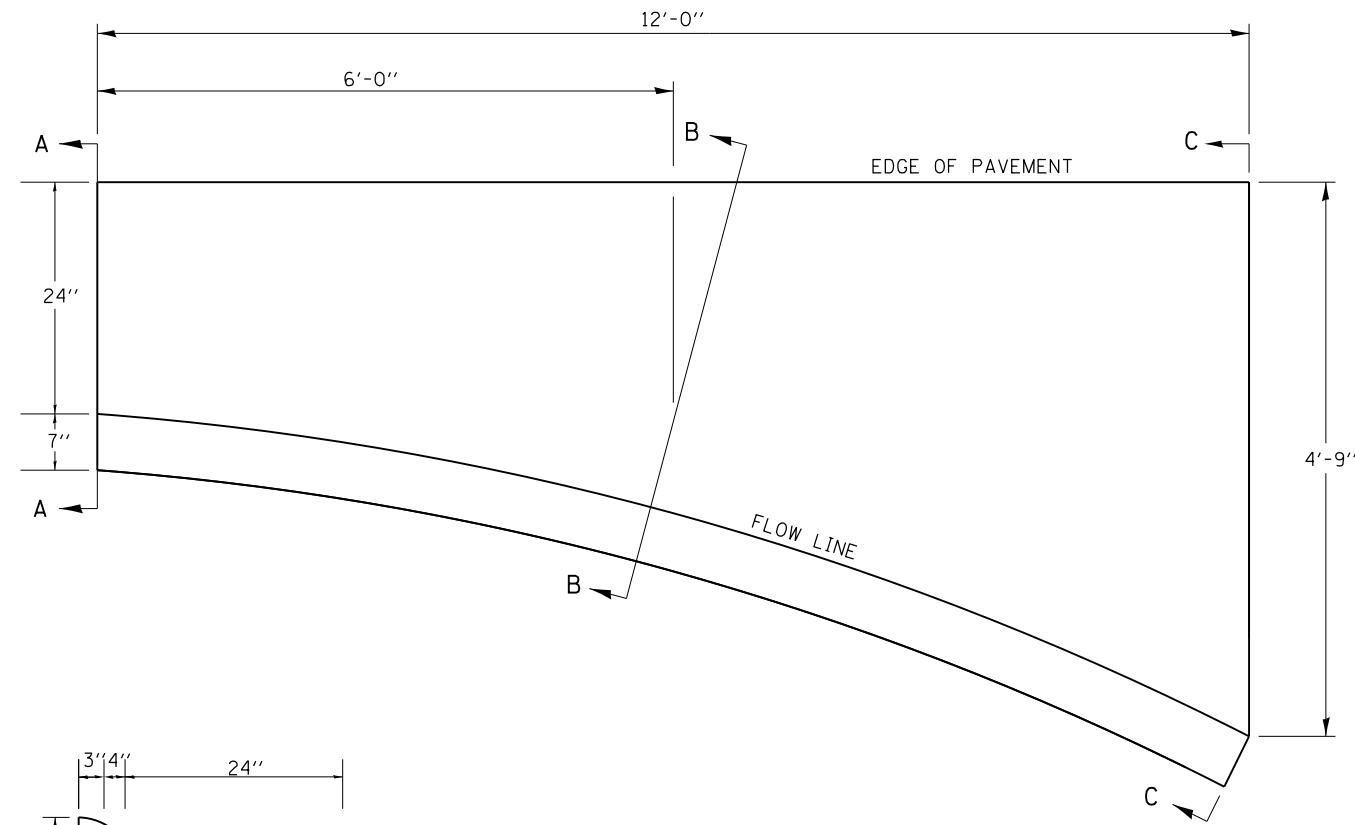
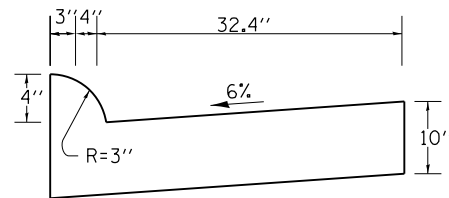

SECTION B-B

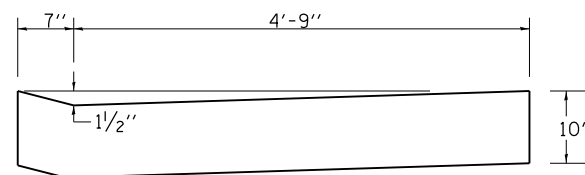

SECTION C-C

### NOTES

Class SI Concrete shall be used throughout.

The Curb and Gutter inlet will be paid for at the contract unit price per cubic yard for Class SI Concrete (OUTLETS).

Joints shall be constructed in accordance with the requirements of Article 606.07 of the Standard Specifications.

When curb and gutter is constructed adjacent to flexible pavement, a 1" expansion joint shall be installed at construction joints.

- QUANTITY -

Section A-A to C-C  
(1.40 Cu. Yds.)  
Class SI Concrete

FILE NAME =	USER NAME = rundbladerr	DESIGNED -	REVISED -
et:\pw\work\p\idot\rundbladerr\d0275077	D206211-shr-cover.dgn	DRAWN -	REVISED -
Default	PLOT SCALE = 100.0000' / in.	CHECKED -	REVISED -
	PLOT DATE = Fri Mar 15 13:39:24 2013	DATE -	REVISED -

STATE OF ILLINOIS  
DEPARTMENT OF TRANSPORTATION

STANDARD INLET DETAIL FOR  
CURB & GUTTER TYPE M-4.24

SCALE: SHEET OF SHEETS STA. TO STA.

F.A.P. RTE.	SECTION	COUNTY	TOTAL SHEETS	SHEET NO.
517	1R	BOONE	126	73
				64697
ILLINOIS FED. AID PROJECT				