

PARTIAL FRAMING PLAN
(Spans 1 thru 6)

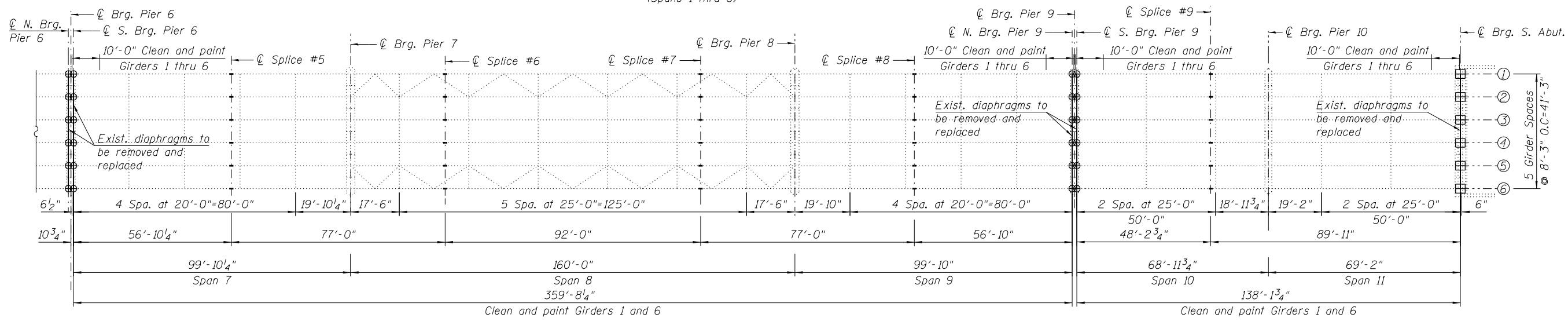

PARTIAL FRAMING PLAN
(Spans 7 thru 11)

BILL OF MATERIAL

ITEM	UNIT	QUANTITY
Cleaning and Painting Structural Steel, Location 1	L Sum	1
Containment and Disposal of Lead Paint Cleaning Residues	L Sum	1

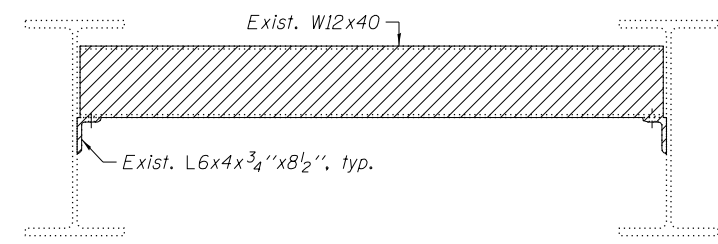

EXISTING DIAPHRAGM REMOVAL
(At Pier 6-Span 6, Pier 9-Span 10 & S. Abut.)

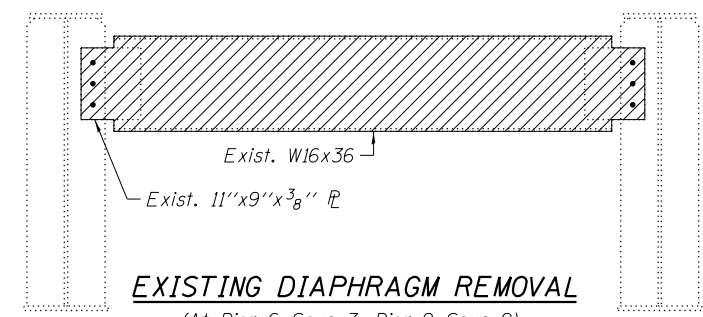

EXISTING DIAPHRAGM REMOVAL
(At Pier 6-Span 7, Pier 9-Span 9)

NOTES:

- Jacking and Removing Existing Bearings shall be done after scarification is completed and before the new deck overlay is poured.
- All work is to be performed under staged construction. See Stage Construction Sheets S03 and S04 for details.
- The new bearings shall be in place and the jacks shall be lowered before the new deck overlay is poured.
- Jacking of existing bearing for Girder 1 at North Abutment, Girders 1 thru 6 at Pier 6 (Spans 6 & 7) and Pier 9 (Spans 9 & 10) will be paid under Temporary Shoring and Cribbing.
- For diaphragm replacement details see Sheet S16 and S17.

SUMMARY OF REACTIONS - PIERS 6, 9 & NORTH AND SOUTH ABUTS.

Loads	North Abut Pier 6-Span 6	Pier 6-Span 7 Pier 9-Span 9	South Abut Pier 9-Span 10
R _∅ (k)	36.7	40.0	35.0
R _L (k)	45.0	47.8	45.0
R _{1M} (k)	11.6	10.6	11.6
R _{Total} (k)	93.3	98.4	91.6

LEGEND

- Bearing Removal
- Jack and Remove Existing Bearings
- Remove Existing Bearing and Perform Temporary Shoring and Cribbing
- Remove and replace existing diaphragms

HBM
ENGINEERING GROUP, LLC
CONSULTING & DESIGN
INSPECTION & TESTING
RESEARCH & TESTING

4415 WEST HARRISON ST.
SUITE 231
HILLSIDE, IL 60162
PHONE: (708) 236-0900
FAX: (708) 236-0901

DESIGNED - LAK, HH	REVISED -
CHECKED - MI	REVISED -
DRAWN - HH	REVISED -
CHECKED - MAI, MI	REVISED -

DATE - 03/13/2013

STATE OF ILLINOIS
DEPARTMENT OF TRANSPORTATION

FRAMING PLAN
EB US ROUTE 20 OVER PECATONICA RIVER STRUCTURE NO. 089-0042

SHEET NO. S15 OF S26 SHEETS

F.A.P. RTE.	SECTION	COUNTY	TOTAL SHEETS	SHEET NO.
0301	(177-4B-11M)	STEPHENSON	43	32

CONTRACT NO. 64J24
ILLINOIS FED. AID PROJECT