

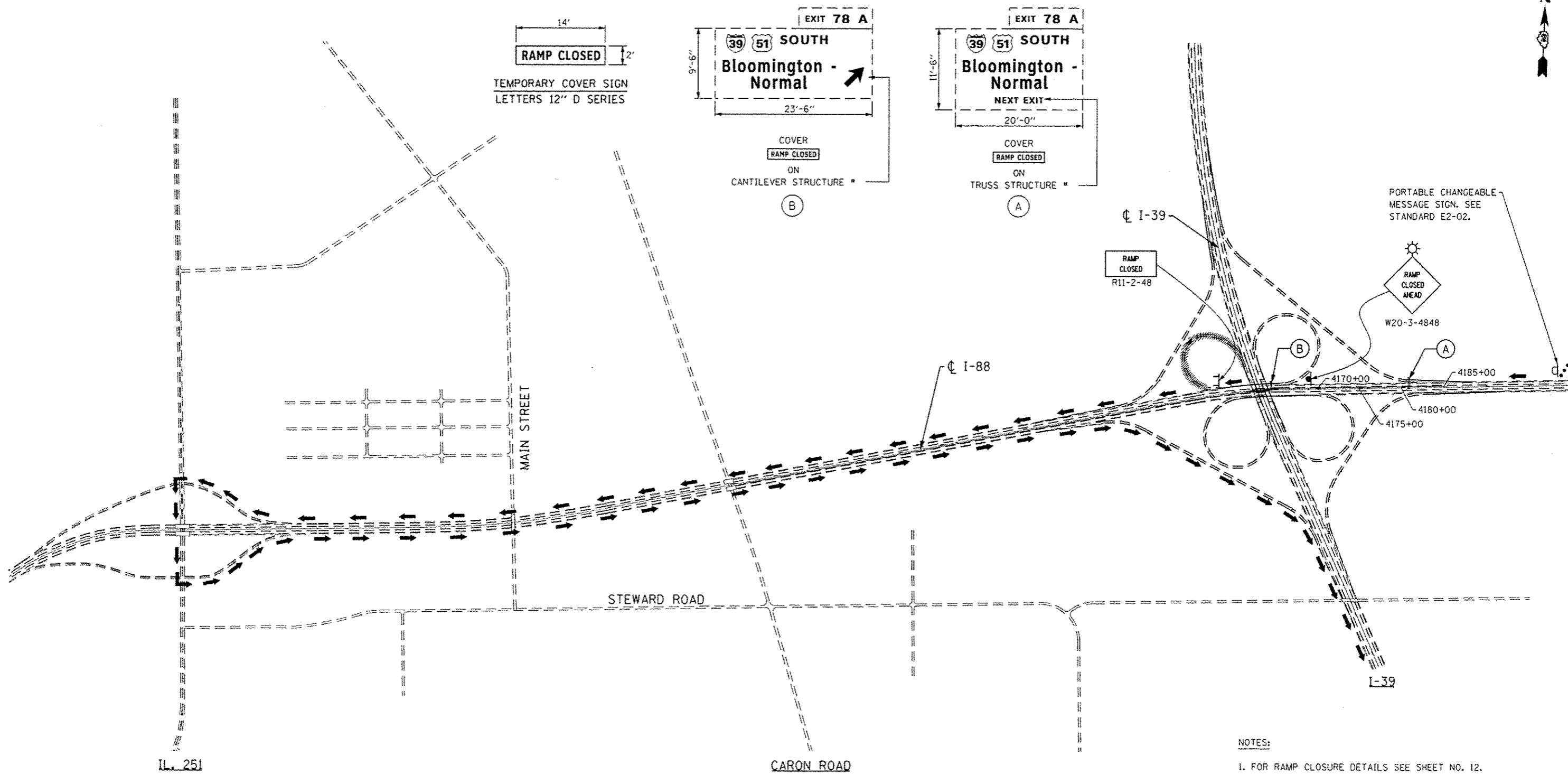

| | |
|-----------|--|
| DATE | |
| BY | |
| SUBMITTED | |
| PLOTTED | |
| TEMPLATE | |
| AREAS | |
| CHECKED | |
| NO. | |

| | |
|-----------|--|
| DATE | |
| BY | |
| SUBMITTED | |
| PLOTTED | |
| TEMPLATE | |
| AREAS | |
| CHECKED | |
| NO. | |



NOTES:
 1. FOR RAMP CLOSURE DETAILS SEE SHEET NO. 12.

LEGEND
 PROPOSED DETOUR TRAFFIC
 RAMP CLOSURE

| | | | | | | | | | | | | |
|---------------------|--|--------------------|-----------|---|---|-----------------------|--------------|---|---------|--------|--------------|-----------|
| FILE NAME: *FILES* | | DESIGNED - G.F.L. | REVISED - | STATE OF ILLINOIS DEPARTMENT OF TRANSPORTATION | DETOUR PLAN I-39 OVER I-88 RAMP CLOSURE - STAGE II | | | F.A.I. RTE. | SECTION | COUNTY | TOTAL SHEETS | SHEET NO. |
| PLOT DATE: *DATES* | | DRAWN - B.K. | REVISED - | | 39 | D2 DECK REPAIR 2013-1 | OGLE | 32 | 7 | | | |
| PLOT SCALE: *SCALE* | | CHECKED - E.J.M. | REVISED - | | CONTRACT NO. 64H73 | | | | | | | |
| | | DATE - AUGUST 2012 | REVISED - | | SCALE: | SHEET NO. OF SHEETS | STA. TO STA. | FED. ROAD DIST. NO. 1 [ILLINOIS] FED. AID PROJECT | | | | |