

ELECTRICAL LOAD FOR INTERSECTION

STREET NAME	COMPONENT	NUMBER	WATTAGE EACH	BURNTIME %
US 6/ THIRD STREET	RED	6	11	50
	YELLOW	6	22	25
	GREEN	6	15	25
	YELLOW ARROW LT.	4	10	10
	GREEN ARROW LT.	4	11	10
CREVE COEUR STREET	RED	4	11	50
	YELLOW	4	22	25
	GREEN	4	15	25
	LEFT TURN GREEN	4	20	100
TRAFFIC SIGNAL CABINET	CONTROLLER	1	6	100
	UPS	1	50	100

AGENCY RESPONSIBLE FOR TRAFFIC SIGNAL ENERGY CHARGES:
CITY OF LASALLE

THERE MAY BE ADDITIONAL ENERGY CHARGES DUE TO LIGHTING OR EMERGENCY VEHICLE DETECTION EQUIPMENT.

TRAFFIC SIGNALS LEGEND

	DENOTES NUMBER OF EXISTING CONDUCTORS
	DENOTES NUMBER OF PROPOSED CONDUCTORS
	EXISTING CONTROLLER AND CABINET
	EXISTING SIGNAL SECTION 12"
	SIGNAL SECTION 12"
	LEFT TURN GREEN
	LEFT TURN YELLOW
	EXISTING PEDESTRIAN PUSH BUTTON
	EXISTING WALK/DON'T WALK WITH COUNT DOWN TIMER
	EXISTING TRAFFIC SIGNAL BACKPLATE
	PROPOSED TRAFFIC SIGNAL BACKPLATE

CONSTRUCTION NOTES:

REMOVAL OF THE FOLLOWING ITEMS SHALL BE PAID FOR AS REMOVE EXISTING TRAFFIC SIGNAL EQUIPMENT:

- 2 EACH - SIGNAL HEAD, 1-FACE, 4-SECTION, BRACKET MOUNTED
- 2 EACH - SIGNAL HEAD, 1-FACE, 4-SECTION, MAST ARM MOUNTED

HOLES IN TRAFFIC SIGNAL POSTS OR MAST ARM POLES RESULTING FROM REMOVAL OF SIGNAL HEADS SHALL BE COVERED WITH STAINLESS STEEL PLATES AND MOUNTING HARDWARE. THIS WORK SHALL BE CONSIDERED INCLUDED IN THE COST OF REMOVE EXISTING TRAFFIC SIGNAL EQUIPMENT.

REMOVE AND REPLACE FOUR (4) 4-SECTION HEADS WITH LED 5-SECTION HEADS.

- RELOCATE FOUR (4) PEDESTRIAN SIGNAL HEADS AT THE TRAFFIC SIGNAL POSTS IN THE NORTHEAST AND SOUTHWEST QUADRANTS OF THE INTERSECTION AS DIRECTED BY THE ENGINEER TO ALLOW PLACEMENT OF NEW 5-SECTION HEADS.

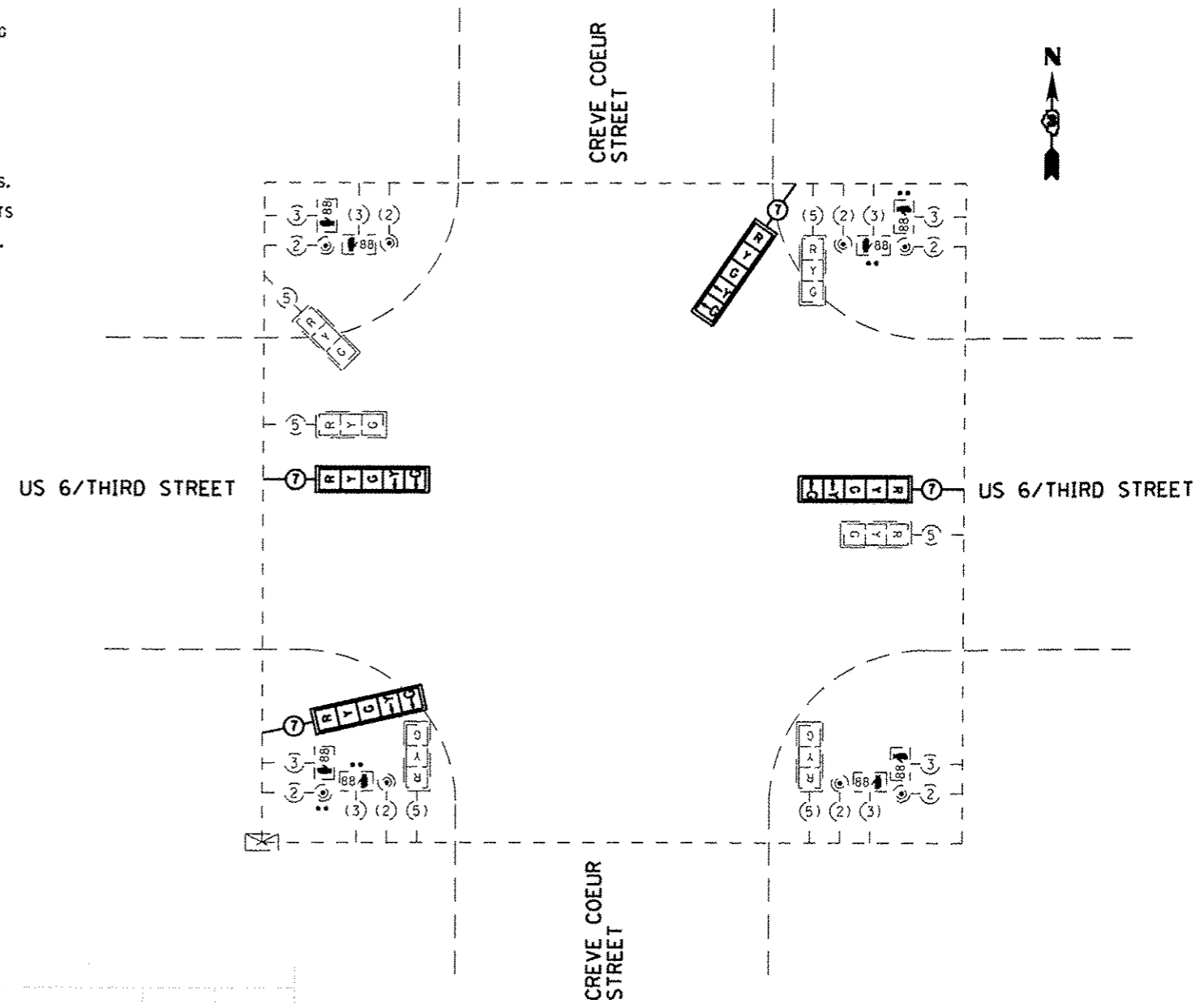

SCHEDULE OF QUANTITIES (95% STATE / 5% CITY)

LASALLE US 6 (THIRD ST) & CREVE COEUR ST

ITEM NO.	DESCRIPTION	UNIT	TOTAL QUANTITY
85000200	MAINTENANCE OF EXISTING TRAFFIC SIGNAL INSTALLATION	EACH	1
88040150	SIGNAL HEAD, POLYCARBONATE, LED, 1-FACE, 5-SECTION, BRACKET MOUNTED	EACH	2
88040160	SIGNAL HEAD, POLYCARBONATE, LED, 1-FACE, 5-SECTION, MAST ARM MOUNTED	EACH	2
88200410	TRAFFIC SIGNAL BACKPLATE, LOUVERED, FORMED PLASTIC	EACH	4
89500200	RELOCATE EXISTING PEDESTRIAN SIGNAL HEAD	EACH	4
89502375	REMOVE EXISTING TRAFFIC SIGNAL EQUIPMENT	EACH	1

SEE GENERAL NOTES, ESPECIALLY NUMBER 19

FILE NAME: D366C67-SMT-TS-C-L-US6-CREVE-COEUR.DGN

USER NAME: --

DESIGNED: --

REVISED: ---

DRAWN: ARR/NV

REVISED: ---

CHECKED: PM

REVISED: ---

DATE: 03/13

REVISED: ---

STATE OF ILLINOIS
DEPARTMENT OF TRANSPORTATION

TRAFFIC SIGNAL CABLE PLAN

LASALLE - US 6 (THIRD STREET) & CREVE COEUR STREET

SCALE: 1" = 20' SHEET NO. ___ OF ___ SHEETS STA. _____ TO STA. _____

F.A. RTE. SECTION COUNTY TOTAL SHEETS SHEET NO.

-- D-3 LED RETROFIT 2013-1 - 38 26

CONTRACT NO. 66C67

ILLINOIS FED. AID PROJECT

• DEKALB, GRUNDY, KANKAKEE & LASALLE