

ELECTRICAL LOAD FOR INTERSECTION				
STREET NAME	COMPONENT	NUMBER	WATTAGE EACH	BURNTIME %
US 6/ NORRIS DRIVE	RED	8	11	50
	YELLOW	8	22	25
	GREEN	8	15	25
	YELLOW ARROW LT.	4	10	10
	GREEN ARROW LT.	4	11	10
IL 23/ COLUMBUS STREET	RED	8	11	50
	YELLOW	8	22	25
	GREEN	8	15	25
	YELLOW ARROW LT.	4	10	10
	GREEN ARROW LT.	4	11	10
TRAFFIC SIGNAL CABINET	CONTROLLER	1	6	100
	UPS	1	50	100

AGENCY RESPONSIBLE FOR TRAFFIC SIGNAL ENERGY CHARGES:
STATE OF ILLINOIS

THERE MAY BE ADDITIONAL ENERGY CHARGES DUE TO
LIGHTING OR EMERGENCY VEHICLE DETECTION EQUIPMENT.

TRAFFIC SIGNALS LEGEND

	DENOTES NUMBER OF EXISTING CONDUCTORS
	DENOTES NUMBER OF PROPOSED CONDUCTORS
	EXISTING CONTROLLER AND CABINET
	EXISTING SIGNAL SECTION 12"
	SIGNAL SECTION 12"
	LEFT TURN GREEN
	LEFT TURN YELLOW
	EXISTING PEDESTRIAN PUSH BUTTON
	EXISTING WALK/DON'T WALK WITH COUNT DOWN TIMER
	EXISTING TRAFFIC SIGNAL BACKPLATE
	PROPOSED TRAFFIC SIGNAL BACKPLATE

CONSTRUCTION NOTES:

REMOVAL OF THE FOLLOWING ITEMS SHALL BE PAID FOR AS REMOVE EXISTING TRAFFIC SIGNAL EQUIPMENT:
4 EACH - SIGNAL HEAD, 1-FACE, 4-SECTION, BRACKET MOUNTED

HOLES IN TRAFFIC SIGNAL POSTS OR MAST ARM POLES RESULTING FROM REMOVAL OF SIGNAL HEADS SHALL BE COVERED WITH STAINLESS STEEL PLATES AND MOUNTING HARDWARE. THIS WORK SHALL BE CONSIDERED INCLUDED IN THE COST OF REMOVE EXISTING TRAFFIC SIGNAL EQUIPMENT.

REMOVE AND REPLACE FOUR (4) 4-SECTION HEADS WITH LED 5-SECTION HEADS.

**RELOCATE FOUR (4) PEDESTRIAN SIGNAL HEADS AT THE TRAFFIC SIGNAL POSTS IN THE NORTHEAST, SOUTHEAST, SOUTHWEST, AND NORTHWEST QUADRANTS OF THE INTERSECTION AS DIRECTED BY THE ENGINEER TO ALLOW PLACEMENT OF NEW 5-SECTION HEADS.

REMOVE AND RE-ERECT TWO (2) EXISTING SIGNS AT THE TRAFFIC SIGNAL POSTS IN THE NORTHEAST AND SOUTHEAST QUADRANTS OF THE INTERSECTION AS DIRECTED BY THE ENGINEER TO ALLOW PLACEMENT OF NEW 5-SECTION HEADS.

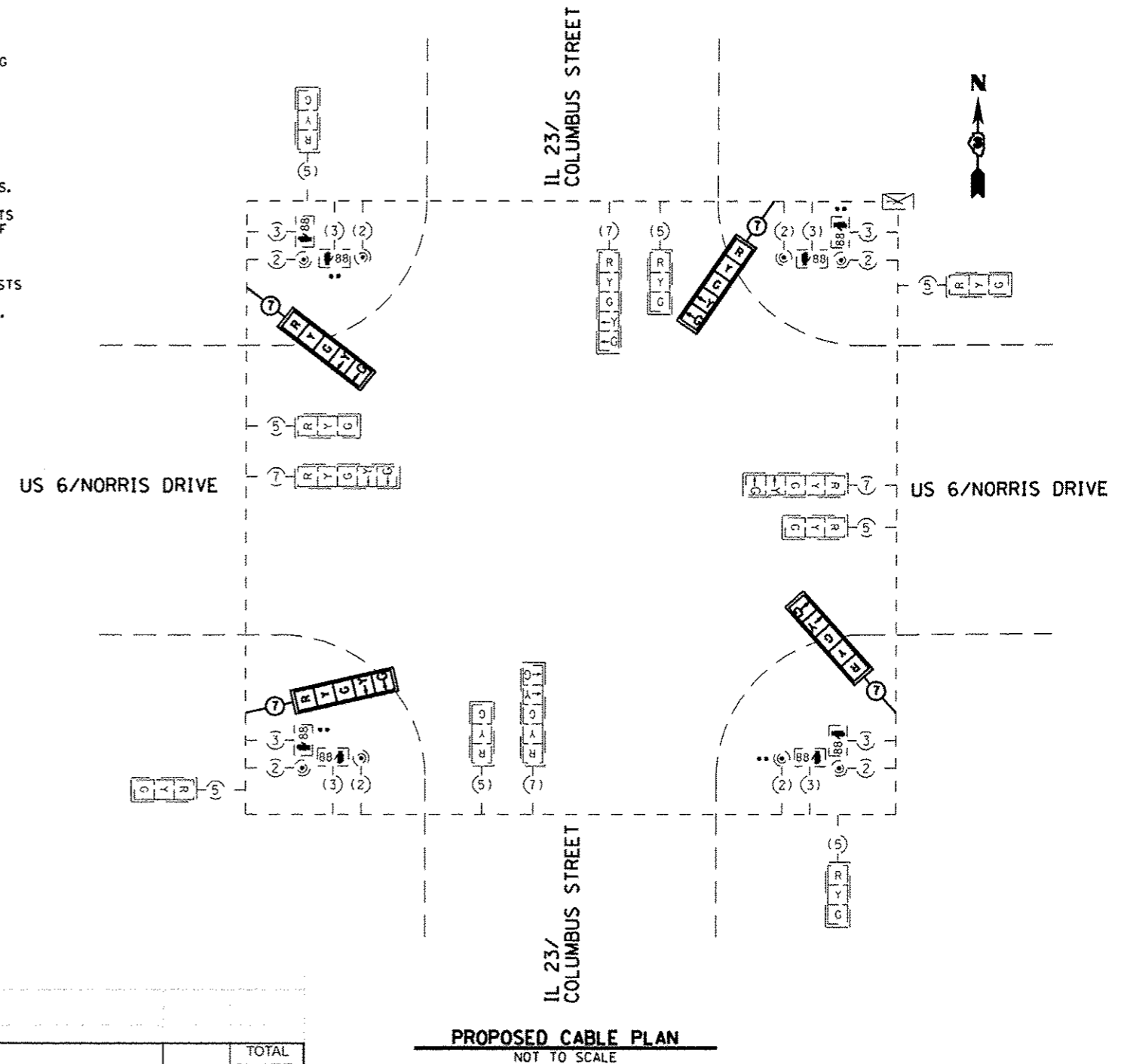

SCHEDULE OF QUANTITIES (100% STATE / 0% CITY)

ITEM NO.	DESCRIPTION	UNIT	TOTAL QUANTITY
85000200	MAINTENANCE OF EXISTING TRAFFIC SIGNAL INSTALLATION	EACH	1
88040150	SIGNAL HEAD, POLYCARBONATE, LED, 1-FACE, 5-SECTION, BRACKET MOUNTED	EACH	4
88200410	TRAFFIC SIGNAL BACKPLATE, LOUVERED, FORMED PLASTIC	EACH	4
89500200	RELOCATE EXISTING PEDESTRIAN SIGNAL HEAD	EACH	4
89502375	REMOVE EXISTING TRAFFIC SIGNAL EQUIPMENT	EACH	1
X7240600	REMOVE AND RE-ERECT EXISTING SIGN	EACH	2

↑ SEE GENERAL NOTES, ESPECIALLY NUMBER 19

FILE NAME :
006667-SHT-TS-C-O-US6-IL23.DGN

USER NAME :
PLOT SCALE = 1" = 20'
PLOT DATE = 03/13

DESIGNED - --
DRAWN - ARR/NV
CHECKED - PM
DATE - 03/13

REVISED - ---
REVISED - ---
REVISED - ---
REVISED - ---

STATE OF ILLINOIS
DEPARTMENT OF TRANSPORTATION

TRAFFIC SIGNAL CABLE PLAN
OTTAWA - US 6 (NORRIS DRIVE) & IL 23 (COLUMBUS STREET)
SCALE: 1" = 20' SHEET NO. ___ OF ___ SHEETS STA. _____ TO STA. _____

* DEKALB, GRUNDY, KANKAKEE & LASALLE
SECTION COUNTY TOTAL SHEETS SHEET NO.
D-3 LED RETROFIT 2013-1 * 38 32
CONTRACT NO. 66C67
ILLINOIS FED. AID PROJECT