

**STATE OF ILLINOIS**  
**DEPARTMENT OF TRANSPORTATION**  
**DIVISION OF HIGHWAYS**

**PROPOSED**  
**HIGHWAY PLANS**

**FAP ROUTE 332 (IL 1)**  
**SECTION D3 PAVEMENT PATCHING 2014-1**

**CLASS B PAVEMENT PATCHING**  
**WILL COUNTY LINE TO GRANT PARK**  
**KANKAKEE COUNTY**

C-93-080-13

INDEX OF SHEETS

1. COVER SHEET
2. GENERAL NOTES
3. SUMMARY QUANTITIES
4. TYPICAL SECTIONS
- 5.-6. SCHEDULES - PATCHING
- 7.-8. SCHEDULES - PAVEMENT MARKING
- 9.-11. CLASS B PATCHING DETAILS
12. TYPICAL PAVEMENT MARKING

STANDARDS

- |           |   |
|-----------|---|
| 00Q001-06 | STANDARD SYMBOLS, ABBREVIATIONS AND PATTERNS                                |
| 420701-02 | PAVEMENT FABRIC   |
| 701106-02 | OFF-ROAD OPERATIONS, MULTILANE, MORE THAN 15' (4.5 m) AWAY                  |
| 701301-04 | LANE CLOSURE, 2L, 2W, SHORT TERM OPERATION                                  |
| 701306-03 | LANE CLOSURE, 2L, 2W, SLOW MOVING OPERATIONS DAY ONLY, FOR SPEEDS >= 45 MPH |
| 780001-03 | TYPICAL PAVEMENT MARKINGS   |
| 701901-02 | TRAFFIC CONTROL DEVICES   |



**BEGIN PROJECT**  
**WILL COUNTY LINE**  
**STA. 49+80**

**END PROJECT**  
**GRANT PARK**  
**STA. 247 ± 50**

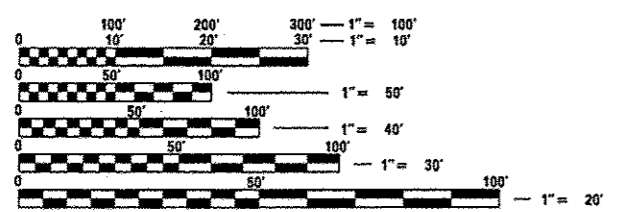

FULL SIZE PLANS HAVE BEEN PREPARED USING STANDARD ENGINEERING SCALES. REDUCED SIZED PLANS WILL NOT CONFORM TO STANDARD SCALES. IN MAKING MEASUREMENTS ON REDUCED PLANS, THE ABOVE SCALES MAY BE USED.

J.U.L.I.E.  
 JOINT UTILITY LOCATION INFORMATION FOR EXCAVATION  
 1-800-892-0123  
 OR 811

DISTRICT NO. (815)-434-6131  
 PROJECT ENGINEER: JOE KANNEL P.E.  
 UNIT CHIEF: RON WOODSHANK  
 TOWNSHIPS: YELLOW HEAD

CONTRACT NO. 66C85

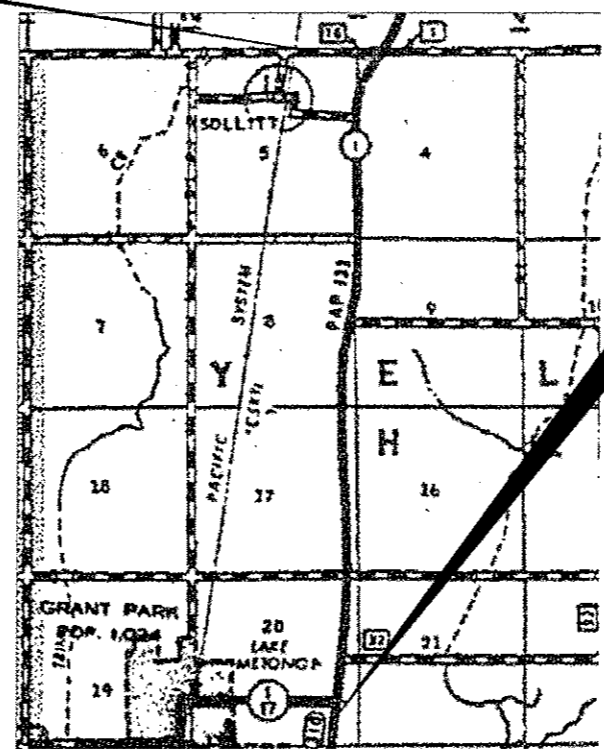

RURAL	
OTHER PRINCIPAL ARTERIAL	
FAP 332 (IL 1)	
2011	
ADT	4,950
P.V.	66.16%
S.U.	7.58%
M.U.	26.26%

STATE OF ILLINOIS  
 DEPARTMENT OF TRANSPORTATION  
 DIVISION OF HIGHWAYS

SUBMITTED 403 2013  
*Paul R. ...*  
 DEPUTY DIRECTOR OF HIGHWAYS, REGION ENGINEER

May 10 2013  
*John D. ...*  
 ENGINEER OF DESIGN AND ENVIRONMENT

May 10 2013  
*Osman ...*  
 DIRECTOR OF HIGHWAYS, CHIEF ENGINEER

**PRINTED BY THE AUTHORITY**  
**OF THE STATE OF ILLINOIS**