

F.A.I. RTE.	SECTION	COUNTY	TOTAL SHEETS	SHEET NO.
57	D3 PATCHING 2014-3	KANKAKEE	17	1
		ILLINOIS	CONTRACT NO. 66C89	

STATE OF ILLINOIS 06-14-13 LETTING ITEM 155

DEPARTMENT OF TRANSPORTATION

DIVISION OF HIGHWAYS

PROPOSED

HIGHWAY PLANS

INDEX OF SHEETS

1. COVER SHEET
2. GENERAL NOTES
3. SUMMARY OF QUANTITIES
4. TYPICAL SECTIONS
- 5-8. SCHEDULES
- 9-10. TRAFFIC CONTROL AND PROTECTION, STANDARD 701400 (SPECIAL)
- 11-13. CLASS A PATCHES
- 14-16. CLASS B PATCHES
17. TYPICAL PAVEMENT MARKINGS

HIGHWAY STANDARDS

- | | |
|-----------|---|
| 000001-06 | STANDARD SYMBOLS, ABBREVIATIONS AND PATTERNS |
| 001001-02 | AREAS OF REINFORCEMENT BARS |
| 001006 | DECIMAL OF AN INCH AND OF A FOOT |
| 420701-02 | PAVEMENT FABRIC |
| 421001-02 | BAR REINFORCEMENT FOR CRC PAVEMENT |
| 442201-03 | CLASS C & D PATCHES |
| 701101-03 | OFF-ROAD OPERATIONS MULTILANE, 15' (4.5 m) TO 24" (600 mm) FROM PAVEMENT EDGE |
| 701401-07 | LANE CLOSURE, FREEWAY/EXPRESSWAY |
| 701411-08 | LANE CLOSURE, MULTILANE, AT ENTRANCE OR EXIT RAMP FOR SPEEDS ≥ 45 MPH |
| 701426-05 | LANE CLOSURE, MULTILANE INTERMITTENT OR MOVING OPERATION, FOR SPEEDS ≥ 45 MPH |
| 701456-02 | PARTIAL EXIT RAMP CLOSURE FREEWAY/EXPRESSWAY |
| 701901-02 | TRAFFIC CONTROL DEVICES |

FAI ROUTE 57 (I-57)

SECTION D3 PATCHING 2014-3

PAVEMENT PATCHING

KANKAKEE

C-93-084-13

END PROJECT
ARMOUR ROAD
(M.P. 314.91)

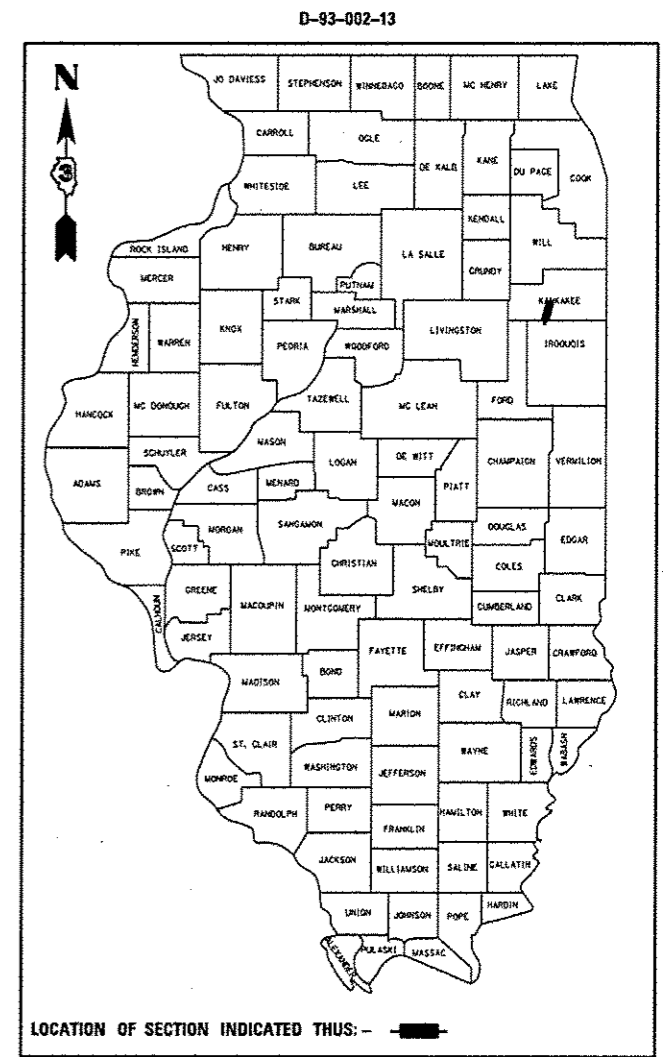

RURAL	
INTERSTATE	
FAI 57 (I-57)	
2011	
ADT	17300
P.V.	65.23%
S.U.	3.99%
M.U.	30.78%

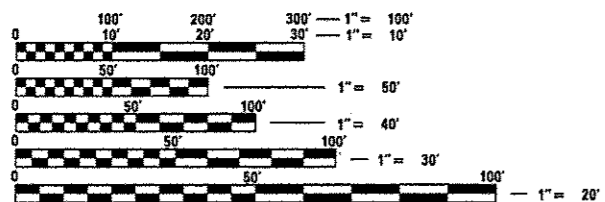

FULL SIZE PLANS HAVE BEEN PREPARED USING STANDARD ENGINEERING SCALES. REDUCED SIZED PLANS WILL NOT CONFORM TO STANDARD SCALES. IN MAKING MEASUREMENTS ON REDUCED PLANS, THE ABOVE SCALES MAY BE USED.

J.U.L.I.E.
JOINT UTILITY LOCATION INFORMATION FOR EXCAVATION
1-800-892-0123
OR 811

PROJECT ENGINEER: JOE KANNEL P.E.
UNIT CHIEF: RON WOODSHANK
TOWNSHIP: VARIOUS
CONTRACT NO. 66C89

BEGIN PROJECT
IROQUOIS COUNTY LINE
(M.P. 301.96)



STATE OF ILLINOIS
DEPARTMENT OF TRANSPORTATION
DIVISION OF HIGHWAYS

SUBMITTED 4-3-2013
Paul A. Tanton
DEPUTY DIRECTOR OF HIGHWAYS, REGION ENGINEER

May 10 2013
John D. Baranzelli P.E.
ENGINEER OF DESIGN AND ENVIRONMENT

May 10 2013
Omer Osman P.E.
DIRECTOR OF HIGHWAYS, CHIEF ENGINEER

PRINTED BY THE AUTHORITY
OF THE STATE OF ILLINOIS

GENERAL NOTES

PLAN DIMENSIONS AND DETAILS RELATIVE TO EXISTING PLANS ARE SUBJECT TO NOMINAL CONSTRUCTION VARIATIONS. THE CONTRACTOR SHALL FIELD VERIFY EXISTING DIMENSIONS AND DETAILS AFFECTING NEW CONSTRUCTION AND MAKE NECESSARY APPROVED ADJUSTMENTS PRIOR TO CONSTRUCTION OR ORDERING OF MATERIALS. SUCH VARIATIONS SHALL NOT BE CAUSE FOR ADDITIONAL COMPENSATION FOR A CHANGE IN SCOPE OF WORK; HOWEVER, THE CONTRACTOR WILL BE PAID FOR THE QUANTITY ACTUALLY FURNISHED AT THE UNIT PRICE BID FOR THE WORK.

FOR STABILIZATION, ALL TYPE III BARRICADES SHALL REQUIRE A MINIMUM OF FOUR SAND BAGS PER BARRICADE.

ANY REFERENCE TO A STANDARD IN THESE PLANS SHALL BE INTERPRETED TO MEAN THE EDITION AS INDICATED BY THE SUBNUMBER SHOWN IN THE LIST OF STANDARDS OR THE COPY INCLUDED IN THESE PLANS.

THE CONTRACTOR SHALL CONTACT JULIE AT LEAST 48 HOURS PRIOR TO EXCAVATION TO DETERMINE WHICH UTILITIES ARE IN THE AREA.

MIX TABLE FOR CLASS D PATCHES

	CL D PATCHES (TOP 2")	CL D PATCHES (BOTTOM LIFTS)
PG GRADE	SBS PG70-22	SBS PG70-23
DESIGN AIR VOIDS	4.0% @ N90	4.0% @ N90
MIXTURE COMPOSITION	IL 9.5	IL 19.0
FRICTION AGGREGATE	MIXTURE D	
DENSITY CONTROL LIMITS	CORES	CORES

COMMITMENTS

DISPOSAL OF EXCAVATED MATERIALS. ALL UNSUITABLE OR UNSTABLE MATERIALS, DEFINED AS SOILS, EMBANKMENTS, SUB-BASE GRANULAR MATERIALS, AND/OR AGGREGATE MATERIALS THAT ARE EXCAVATED DUE TO CONSTRUCTION OPERATIONS SHALL BE DISPOSED OF WITHIN THE LIMITS OF THE EXISTING RIGHT OF WAY. DISPOSAL OF EXCAVATED MATERIALS, AS DEFINED ABOVE, OFF THE EXISTING RIGHT OF WAY SHALL NOT BE PERMITTED.

EXCAVATED MATERIALS SHALL BE DISPOSED OF AT LOCATIONS DIRECTED BY THE ENGINEER. ANY SUCH DISPOSAL SHALL NOT CREATE AND UNSIGHTLY OR OBJECTIONABLE APPEARANCE OR DETRACT FROM THE NATURAL TOPOGRAPHIC FEATURES WITHOUT WRITTEN PERMISSION FROM THE ENGINEER.

DATE: 4-3-2013

PREPARED BY: Dave Rosenblum
DISTRICT STUDIES & PLANS ENGINEER

EXAMINED BY: Herbert
DISTRICT CONSTRUCTION ENGINEER

Wayne L. Phillips
DISTRICT MATERIALS ENGINEER

Bruce A. Hooker
DISTRICT OPERATIONS ENGINEER

FILE NAME *	USER NAME * potelij	DESIGNED -	REVISED -
c:\pwork\pndot\potelij\0335477\036609-sht-details.dgn		DRAWN -	REVISED -
PLOT SCALE * 100.0000 1/ in.		CHECKED -	REVISED -
PLOT DATE * 4/3/2013		DATE -	REVISED -

STATE OF ILLINOIS
DEPARTMENT OF TRANSPORTATION

GENERAL NOTES

SCALE: SHEET NO. 1 OF 1 SHEETS STA. TO STA.

F.A.I. RTE.	SECTION	COUNTY	TOTAL SHEETS	SHEET NO.
57	D3 PATCHING 2014-3	KANKAKEE	17	2
ILLINOIS FED. AID PROJECT			CONTRACT NO. 66C89	

CODE NO.	ITEM	UNIT	CONSTR. CODE	
			STATE	
			100%	
			ROADWAY	
			0005	
			RURAL	
44200630	CLASS A PATCHES, TYPE II, 15 INCH	SQ YD		128
44201007	CLASS B PATCHES, TYPE II, 13 INCH	SQ YD		297
44201055	CLASS B PATCHES, TYPE II, 17 INCH	SQ YD		312
44201299	DOWEL BARS 1 1/2"	EACH		1536
44201851	CLASS D PATCHES, TYPE II, 17 INCH	SQ YD		120
44213000	PATCH REINFORCEMENT	SQ YD		144
44213100	PAVEMENT FABRIC	SQ YD		1362
44213200	SAW CUTS	FOOT		6780
67100100	MOBILIZATION	L SUM		1
70100420	TRAFFIC CONTROL AND PROTECTION, STANDARD 701411	EACH		2
70100825	TRAFFIC CONTROL AND PROTECTION, STANDARD 701456	L SUM		1
70103815	TRAFFIC CONTROL SURVEILLANCE	CAL DAY		20
* 78009004	MODIFIED URETHANE PAVEMENT MARKING LINE 4"	FOOT		888
* 78009006	MODIFIED URETHANE PAVEMENT MARKING LINE 6"	FOOT		590
X0326880	MESSAGE BOARD VEHICLE DRIVER	HOURL		160
X0326907	PORTABLE, VEHICLE MOUNTED, CHANGEABLE MESSAGE SIGN	CAL MO		0.67
X7010805	TRAFFIC CONTROL AND PROTECTION, STANDARD 701401(SPECIAL)	L SUM		1

* SPECIALITY ITEMS

FILE NAME *	USER NAME *	DESIGNED -	REVISED -	STATE OF ILLINOIS DEPARTMENT OF TRANSPORTATION	SUMMARY OF QUANTITIES			F.A.I. RTE.	SECTION	COUNTY	TOTAL SHEETS	SHEET NO.
ct:\pwork\pvidos\patel\0305477\036689-shr-details.dgn	patel	DRAWN -	REVISED -					57	03 PATCHING 2014-3	KANKAKEE	17	3
PLOT SCALE * 1/8" = 1' / in.		CHECKED -	REVISED -		SCALE:	SHEET NO. 1 OF 1 SHEETS	STA.	TO STA.	CONTRACT NO. 66C89			
PLOT DATE * 4/3/2013		DATE -	REVISED -		ILLINOIS FED. AID PROJECT							

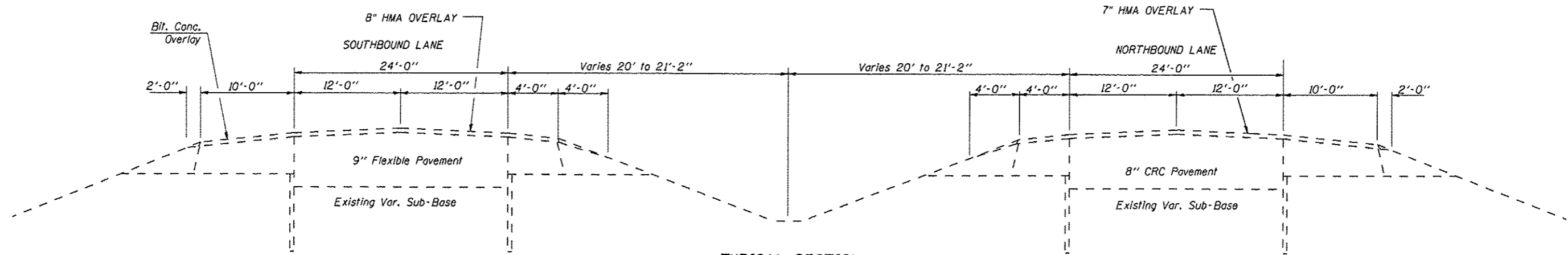

TYPICAL SECTION
MM 301.94 TO MM 307.60

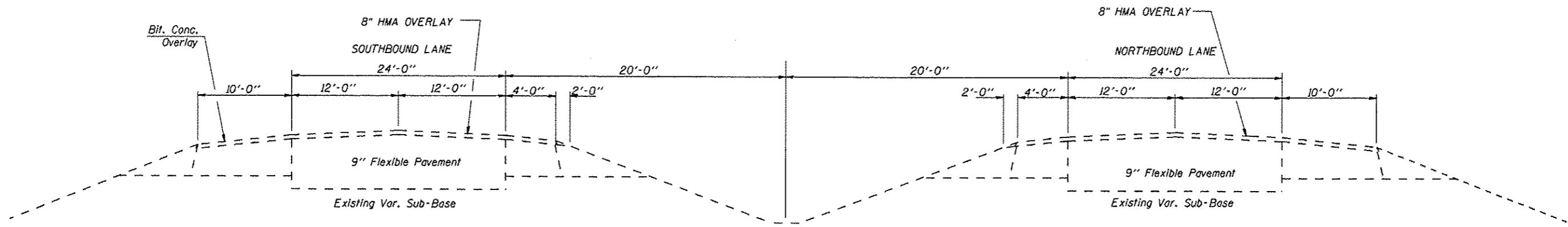

TYPICAL SECTION
MM 307.60 TO MM 309.96

FILE NAME = c:\pwwork\pwwork\patel\j\100335477\036689.dwg	USER NAME = patel,j	DESIGNED -	REVISED -	STATE OF ILLINOIS DEPARTMENT OF TRANSPORTATION	TYPICAL SECTIONS		F.A.I. RTE.	SECTION	COUNTY	TOTAL SHEETS	SHEET NO.	
	PLT SCALE = 1/8" = 1' / in.	CHECKED -	REVISED -				57	D3 PATCHING 2014-3	KANKAKEE	17	4	
PLT DATE = 4/3/2013	DATE -	REVISED -	REVISED -		SCALE:	SHEET NO. 1 OF 1 SHEETS	STA.	TO STA.	CONTRACT NO. 66C89			
ILLINOIS FED. AID PROJECT												

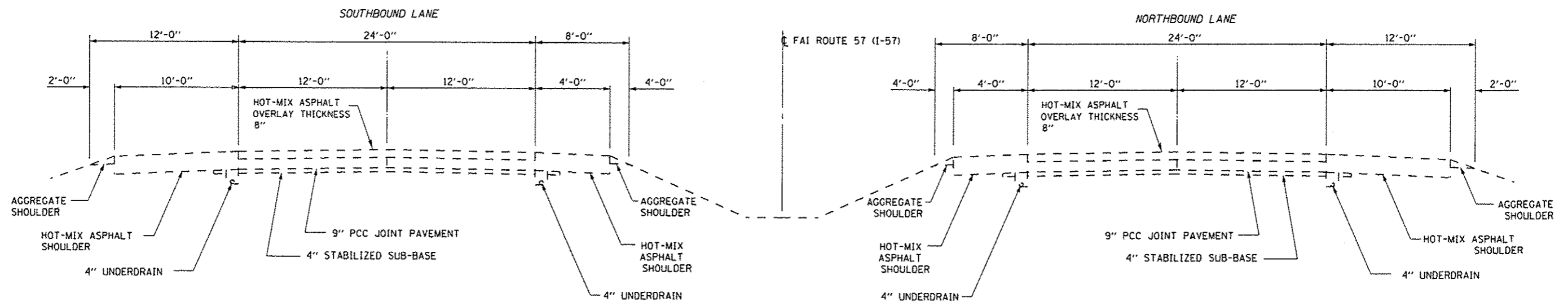

TYPICAL SECTION
MM 309.96 TO MM 314.04

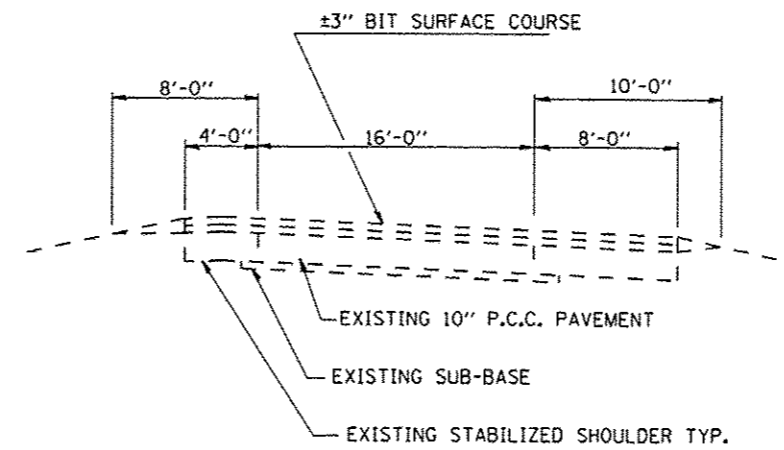

RAMP TYPICAL

FILE NAME =	USER NAME = potelyj	DESIGNED -	REVISED -
c:\pwork\p\idoc\potelyj\d0335477\036609-ahc-details.dgn		DRAWN -	REVISED -
		CHECKED -	REVISED -
		DATE -	REVISED -

STATE OF ILLINOIS
DEPARTMENT OF TRANSPORTATION

TYPICAL SECTIONS	
SCALE:	SHEET NO. 1 OF 1 SHEETS
STA.	TO STA.

F.A.I. RTE.	SECTION	COUNTY	TOTAL SHEETS	SHEET NO.
57	D3 PATCHING 2014-3	KANKAKEE	17	5
CONTRACT NO. 66C89				
ILLINOIS FED. AID PROJECT				

SCHEDULES								
CLASS A PATCHING								
NORTHBOUND LANES								
LOCATION	DRIVING LANE				PASSING LANE			
	TYPE II 15"	PATCH REINF.	PAV'T FABRIC	SAW CUTS	TYPE II 15"	PATCH REINF.	PAV'T FABRIC	SAW CUTS
	SQ YD	SQ YD	SQ YD	FOOT	SQ YD	SQ YD	SQ YD	FOOT
301.89	8	8	8	60				
302.58	8	8	8	60				
302.61	8	8	8	60				
303.49	8	8	8	60				
304.18	8	8	8	60				
304.48	8	8	8	60				
305.08	8	8	8	60				
305.28	8	8	8	60				
305.38	8	8	8	60				
305.56	8	8	8	60				
305.92	8	8	8	60	8	8	8	60
306.18	8	8	8	60				
306.48	8	8	8	60				
306.94					8	8	8	60
306.94	8	8	8	60				
307.48	8	8	8	60				
307.60	8	8	8	60				
TOTALS	128	128	128	960	16	16	16	120

SCHEDULES								
CLASS B PATCHING								
NORTHBOUND LANES								
LOCATION	DRIVING LANE				PASSING LANE			
	TYPE II 17"	DOWEL BARS	PAV'T FABRIC	SAW CUTS	TYPE II 17"	DOWEL BARS	PAV'T FABRIC	SAW CUTS
	SQ YD		SQ YD	FOOT	SQ YD		SQ YD	FOOT
309.88	8	20	16	60	8	20	16	60
310.72	8	20	16	60				
310.88	8	20	16	60				
311.38	8	20	16	60	8	20	16	60
311.53	8	20	16	60	8	20	16	60
311.60	8	20	16	60	8	20	16	60
311.62	8	20	16	60	8	20	16	60
311.63	8	20	16	60	8	20	16	60
312.90	8	20	16	60				
313.03	8	20	16	60				
313.12	8	20	16	60				
313.36	8	20	16	60				
313.42	8	20	16	60				
313.86	8	20	16	60	8	20	16	60
TOTALS	112	280	224	840	56	140	112	420

SCHEDULES				
CLASS D PATCHING				
SOUTHBOUND LANES				
LOCATION MILE POST	DRIVING LANE		PASSING LANE	
	TYPE II 17"	SAW CUTS	TYPE II 17"	SAW CUTS
	SQ YD	FOOT	SQ YD	FOOT
307.54	8	60	8	60
307.52	8	60	8	60
305.90	8	60	8	60
305.89	8	60		
304.08	8	60		
303.04	8	60	8	60
302.84	8	60	8	60
302.79	8	60	8	60
302.72			8	60
302.62	8	60	8	60
302.61	8	60	8	60
302.60	8	60	8	60
302.59	8	60	8	60
302.58	8	60	8	60
301.95	8	60	8	60
301.94	8	60	8	60
TOTALS	120	900	112	840

SCHEDULES								
CLASS B PATCHING								
SOUTHBOUND LANES								
LOCATION MILE POST	DRIVING LANE				PASSING LANE			
	TYPE II 17"	DOWEL BARS	PAV'T FABRIC	SAW CUTS	TYPE II 17"	DOWEL BARS	PAV'T FABRIC	SAW CUTS
	SQ YD		SQ YD	FOOT	SQ YD		SQ YD	FOOT
314.04	8	20	16	60				
313.70					8	20	16	60
313.70	8	20	16	60				
313.14					8	20	16	60
313.14	8	20	16	60				
312.92					8	20	16	60
312.92	8	20	16	60				
312.74	8	20	16	60	8	20	16	60
312.24					8	20	16	60
310.24	8	20	16	60	8	20	16	60
310.04	8	20	16	60	8	20	16	60
309.99	8	20	16	60	8	20	16	60
309.98	8	20	16	60				
309.96	8	20	16	60				
TOTALS	80	200	160	600	64	160	128	480

SCHEDULES						
CLASS B PATCHES						
SOUTHBOUND RAMPS						
LOCATION			RAMPS			
EXIT NO.	TYPE	L.M.	TYPE II	DOWEL	SAW	PAVE'T
			13"	BARS	CUTS	FABRIC
			SO YD	EACH	FOOT	SO YD
308	EXIT	0.03	11	28	60	22
		0.05	11	28	60	22
		0.06	11	28	60	22
		0.08	11	28	60	22
		0.10	11	28	60	22
		0.12	11	28	60	22
		0.13	11	28	60	22
		0.15	11	28	60	22
		0.18	11	28	60	22
		0.20	11	28	60	22
		0.21	11	28	60	22
		0.23	11	28	60	22
	ENTRANCE	0.01	11	28	60	22
		0.03	11	28	60	22
		0.04	11	28	60	22
		0.06	11	28	60	22
		0.08	11	28	60	22
		0.09	11	28	60	22
		0.10	11	28	60	22
		0.12	11	28	60	22
		0.15	11	28	60	22
		0.17	11	28	60	22
		0.19	11	28	60	22
		0.21	11	28	60	22
0.24	11	28	60	22		
0.28	11	28	60	22		
0.30	11	28	60	22		
TOTALS			297	756	1620	594

- ALL EXIT RAMPS: L.M. = 0.00 = BEGINNING OF CORE AREA
- ALL ENTRANCE RAMPS: L.M. = 0.00 = TOP OF RAMP CONST. JT.

SCHEDULE				
PAVEMENT MARKING				
NORTHBOUND LANES				
LOCATION	MODIFIED URETHANE PAVEMENT MARKING LINE 4"		MODIFIED URETHANE PAVEMENT MARKING LINE 6"	
	FEET		FEET	
	YELLOW	WHITE	WHITE	
MILE POST				
301.89		6	10	
302.58		6	10	
302.61		6	10	
303.49		6	10	
304.18		6	10	
304.48		6	10	
305.08		6	10	
305.28		6	10	
305.38		6	10	
305.56		6	10	
305.92		6	10	
306.18	6		10	
306.48	6	6	10	
306.94	6		10	
306.94	6	6	10	
307.48		6	10	
307.60	6		10	
309.88	6	6	10	
310.72	6	6	10	
310.88	6	6	10	
311.38	6	6	10	
311.53	6	6	10	
311.60	6	6	10	
311.62	6	6	10	
311.63	6	6	10	
312.90	6	6	10	
313.03	6	6	10	
313.12	6	6	10	
313.36	6	6	10	
313.42	6	6	10	
313.86	6	6	10	
TOTALS		282	310	

SCHEDULE				
PAVEMENT MARKING				
SOUTHBOUND LANES				
LOCATION	MODIFIED URETHANE PAVEMENT MARKING LINE 4"		MODIFIED URETHANE PAVEMENT MARKING LINE 6"	
	FEET		FEET	
	YELLOW	WHITE	WHITE	
MILE POST				
301.94	6	6	10	
301.95	6	6	10	
302.58	6	6	10	
302.59	6	6	10	
302.60	6	6	10	
302.61	6	6	10	
302.62	6	6	10	
302.72	6		10	
302.79	6	6	10	
302.84	6	6	10	
303.04	6	6	10	
304.08		6	10	
305.89		6	10	
305.90	6	6	10	
307.52	6	6	10	
307.54	6	6	10	
309.96		6	10	
309.98		6	10	
309.99	6	6	10	
310.04	6	6	10	
310.24	6	6	10	
312.24	6		10	
312.74	6	6	10	
312.92	6	6	10	
313.14	6	6	10	
313.70		6	10	
313.70	6		10	
314.04		6	10	
TOTALS		282	280	

SCHEDULE					
PAVEMENT MARKING					
SOUTHBOUND RAMP					
LOCATION	MODIFIED URETHANE PAVEMENT MARKING LINE 4"				
	FEET				
	YELLOW	WHITE			
EXIT NO.	TYPE	L.M.	YELLOW	WHITE	
308	EXIT	0.03	6	6	
		0.05	6	6	
		0.06	6	6	
		0.08	6	6	
		0.10	6	6	
		0.12	6	6	
		0.13	6	6	
		0.15	6	6	
		0.18	6	6	
		0.20	6	6	
		0.21	6	6	
		0.23	6	6	
		0.01	6	6	
		0.03	6	6	
		0.04	6	6	
	0.06	6	6		
	0.08	6	6		
	0.09	6	6		
	0.10	6	6		
	0.12	6	6		
	0.15	6	6		
	0.17	6	6		
	0.19	6	6		
	0.21	6	6		
	0.24	6	6		
	0.28	6	6		
	0.30	6	6		
	TOTALS			324	

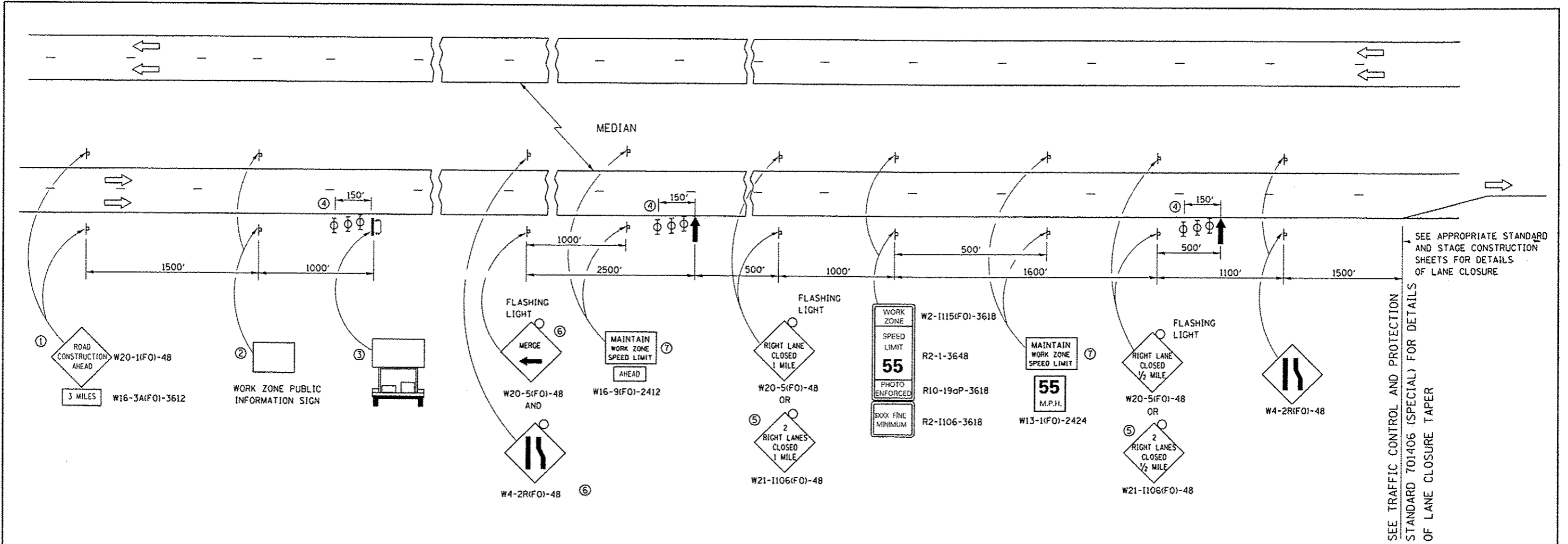

- ① THE ROAD CONSTRUCTION AHEAD SIGN SHALL BE LOCATED 3 MILES IN ADVANCE OF THE PROJECT LIMITS.
- ② THE MESSAGE AND SIZE OF THE WORK ZONE PUBLIC INFORMATION SIGN SHALL BE AS SPECIFIED BY THE DEPARTMENT.
- ③ TO BE PLACED IN THE MEDIAN WHEN FEASIBLE. THE MESSAGE BOARD SHALL BE USED TO DISPLAY STATUS OF LANES WITHIN THE PROJECT. THE PRIMARY MESSAGES SHALL BE:
"RIGHT LANE CLOSED" / " x MILES AHEAD"
"LEFT LANE CLOSED" / " x MILES AHEAD"
"ALL LANES OPEN"
- ④ THREE, TYPE II BARRICADES, DRUMS, OR VERTICAL BARRICADES AT 50' CENTERS.
- ⑤ THIS SIGN SHALL BE USED WHEN 2 LANES ARE CLOSED.
- ⑥ WHEN THE LEFT LANE IS CLOSED, SWITCH THESE TWO SIGNS AND THE DIRECTION OF THE MERGE ARROW.

⑦ 48"x36" FLUORESCENT ORANGE SIGN WITH BLACK LETTERS.

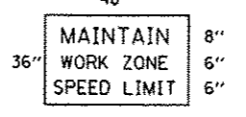

- ↑ ARROW BOARD
- PORTABLE CHANGEABLE MESSAGE SIGN
- ▭ SIGN
- ⊕ TYPE II BARRICADE, DRUM, OR VERTICAL BARRICADE WITH MONODIRECTIONAL FLASHING LIGHT

GENERAL NOTE:

THIS STANDARD IS USED WHERE AT ANY TIME A LANE IS CLOSED ON A FREEWAY/EXPRESSWAY.

WHEN THE LEFT LANE IS CLOSED, LEFT LANE CLOSED SIGNS SHALL BE SUBSTITUTED FOR THE RIGHT LANE CLOSED SIGNS.

THE FIRST TWO SIGNS AND THE MESSAGE BOARD ARE STATIONARY. THE OTHER SIGNS AND ARROWBOARDS SHALL BE MOVED AS NECESSARY TO MAINTAIN THE REQUIRED DISTANCE FROM THE START OF THE LANE CLOSURE TAPER(S).

WHEN WORK OPERATIONS ARE NEAR MAJOR INTERCHANGES THE CONTRACTOR SHALL FURNISH ADDITIONAL MESSAGE BOARDS AND UTILIZED AT THE DIRECTION OF THE ENGINEER.

FILE NAME :	USER NAME : pateluj	DESIGNED -	REVISED -	STATE OF ILLINOIS DEPARTMENT OF TRANSPORTATION	TRAFFIC CONTROL AND PROTECTION STANDARD 701400 (SPECIAL)	F.A.I. RTE.:	SECTION	COUNTY	TOTAL SHEETS	SHEET NO.	
c:\pwwork\puidot\pateluj\d0335477\03066	B9-shr-details.dgn	DRAWN -	REVISED -			57	D3 PATCHING 2014-3	KANKAKEE	17	10	
	PLOT SCALE * 100,0000 ' / in.	CHECKED -	REVISED -			CONTRACT NO. 66CB9					
	PLOT DATE * 4/3/2013	DATE -	REVISED -			ILLINOIS FED. AID PROJECT					

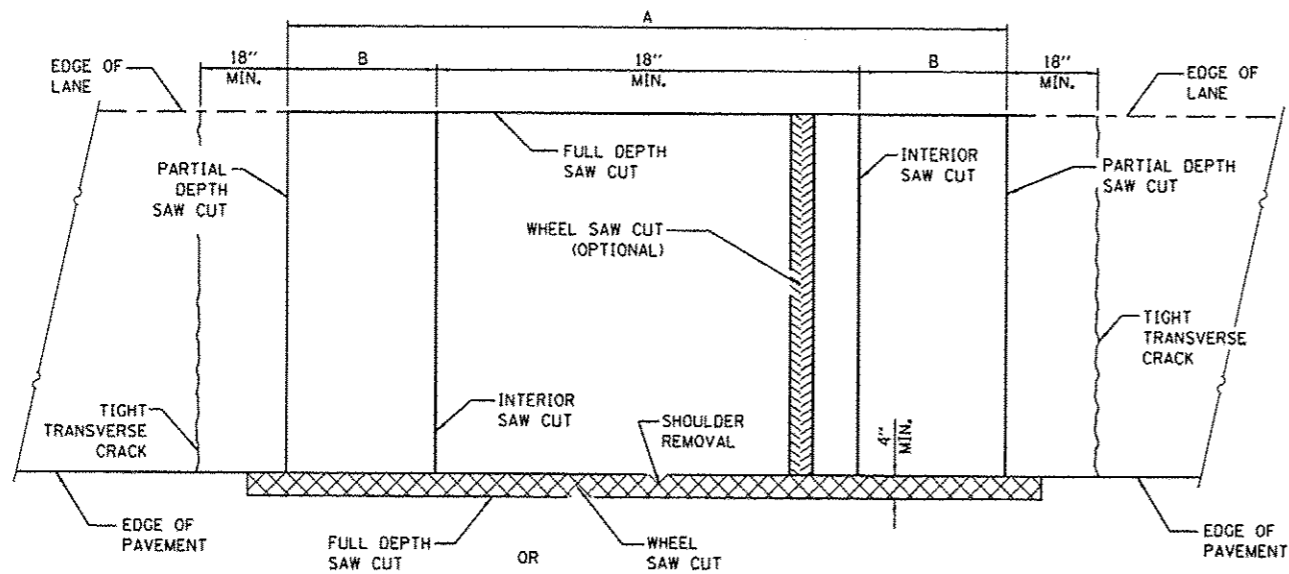

PAVEMENT SAWING DETAIL
(HMA SHOULDER)

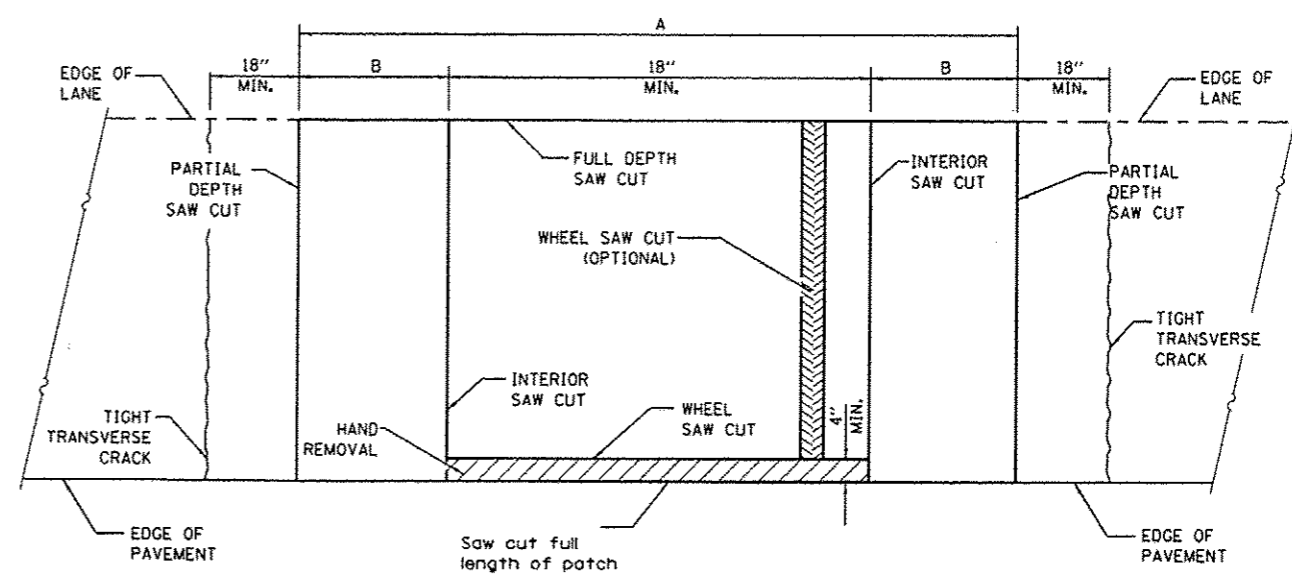

PAVEMENT SAWING DETAIL
(PCC SHOULDER)

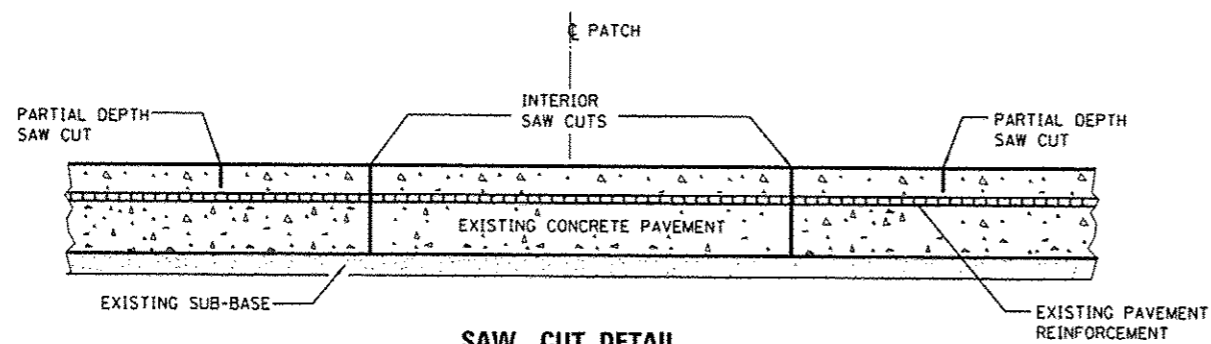

SAW CUT DETAIL
WITHOUT HMA SURFACE

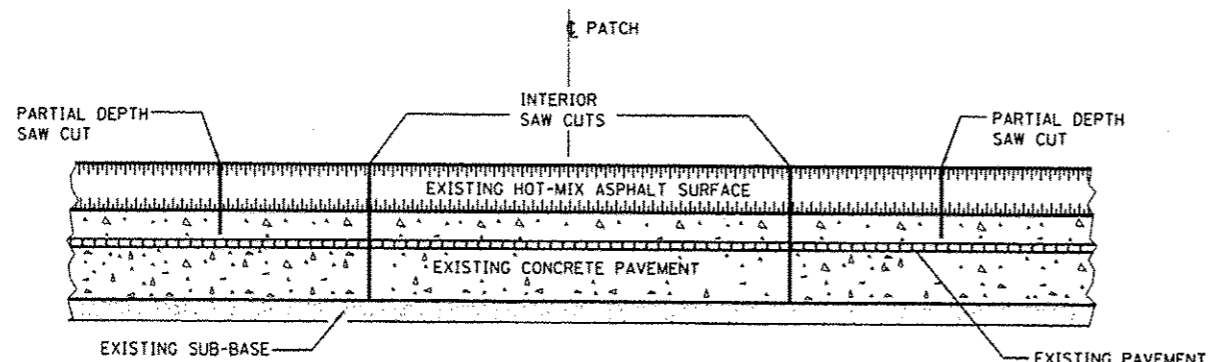

SAW CUT DETAIL
WITH HMA SURFACE

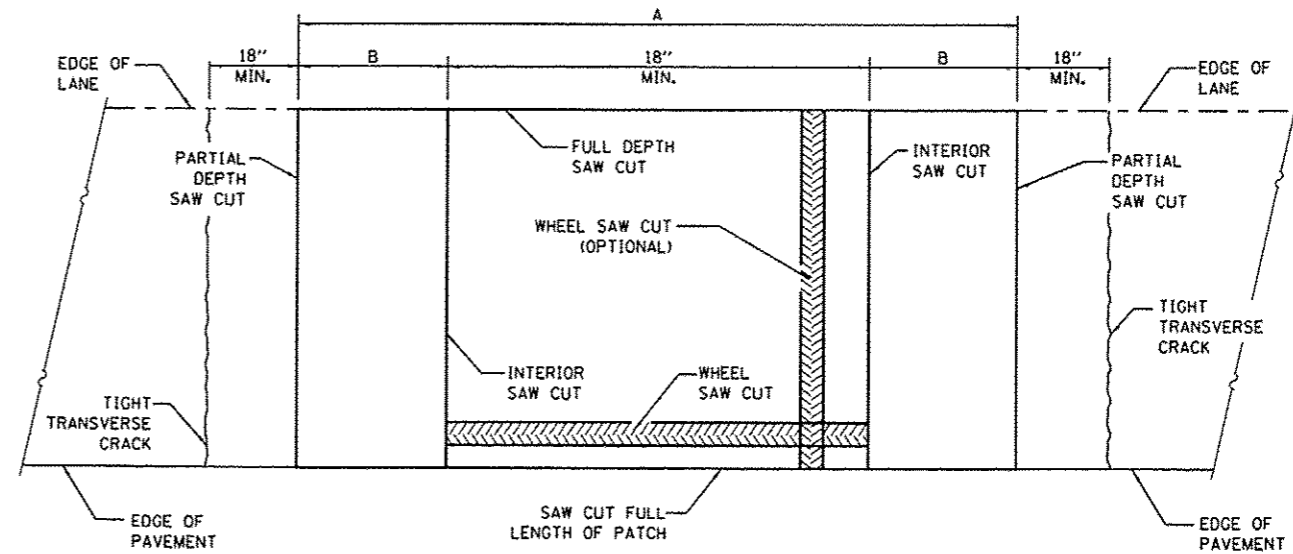

ALTERNATE SAWING DETAIL
(PCC SHOULDER)

EXISTING REINFORCEMENT BARS	A (MIN.)	B (MIN.)	C (MIN.)
#5	4'-6"	18"	16"
#6	5'-0"	21"	19"
#7	5'-6"	24"	22"
FABRIC	5'-0"	21"	18"

GENERAL NOTES

WHEN PATCHING TWO ADJACENT LANES IN ONE OPERATION THE LONGITUDINAL JOINT SHALL BE LONGITUDINAL SAWED JOINT AS DETAILED ON STANDARD 420001, HOWEVER, THE GROOVE MAYBE EITHER PREFORMED OR SAWED.

SEE STANDARD 421001 FOR DETAILS OF PAVEMENT REINFORCEMENT.

FILE NAME =	USER NAME = potelyj	DESIGNED -	REVISED -
c:\pv_work\pavdot\potelyj\08335477\0366089-shr-details.dgn		DRAWN -	REVISED -
		CHECKED -	REVISED -
		DATE -	REVISED -

STATE OF ILLINOIS
DEPARTMENT OF TRANSPORTATION

CLASS A PATCHES

SCALE:	SHEET NO. 1 OF 1 SHEETS	STA.	TO STA.	F.A.I. RTE.	SECTION	COUNTY	TOTAL SHEETS	SHEET NO.
				57	D3 PATCHING 2014-3	KANKAKEE	17	11
							CONTRACT NO. 66C89	
ILLINOIS FED. AID PROJECT								

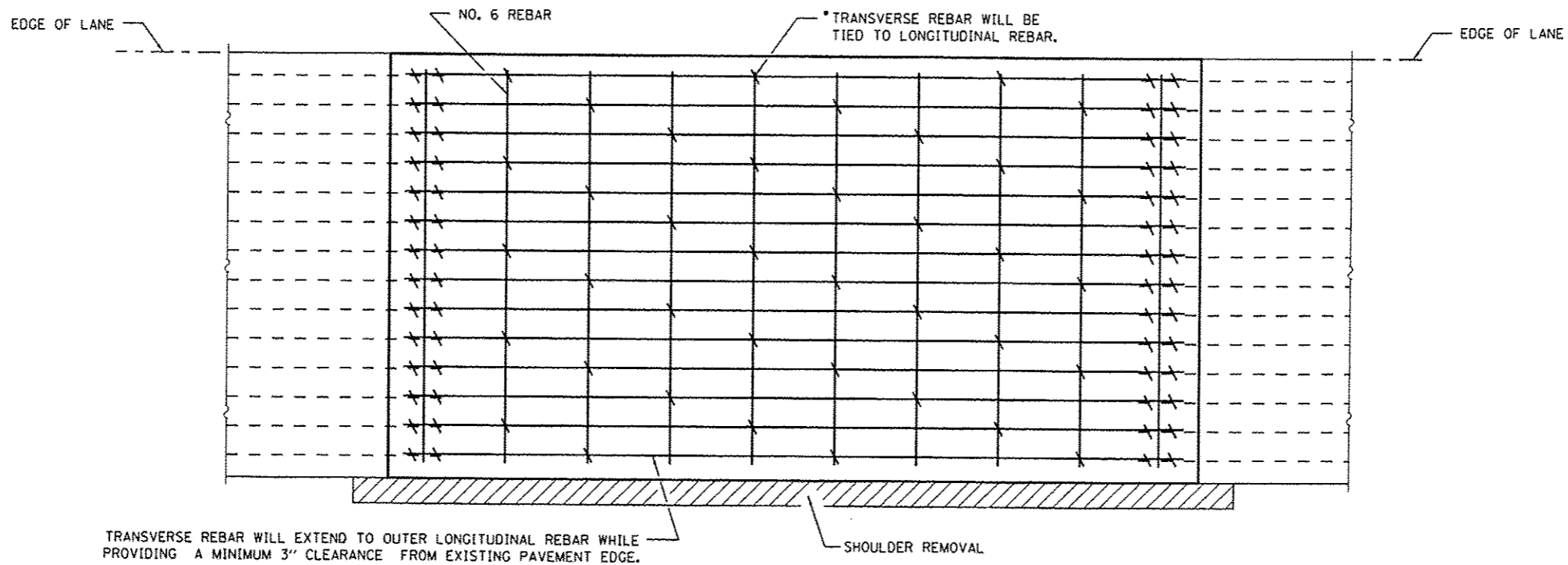

PAVEMENT REINFORCEMENT DETAIL

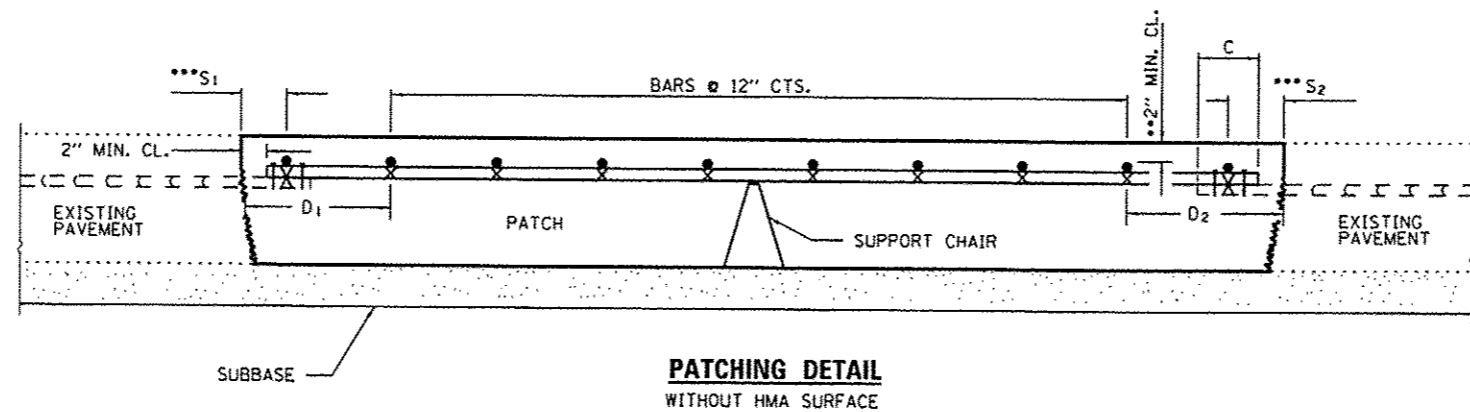

PATCHING DETAIL WITHOUT HMA SURFACE

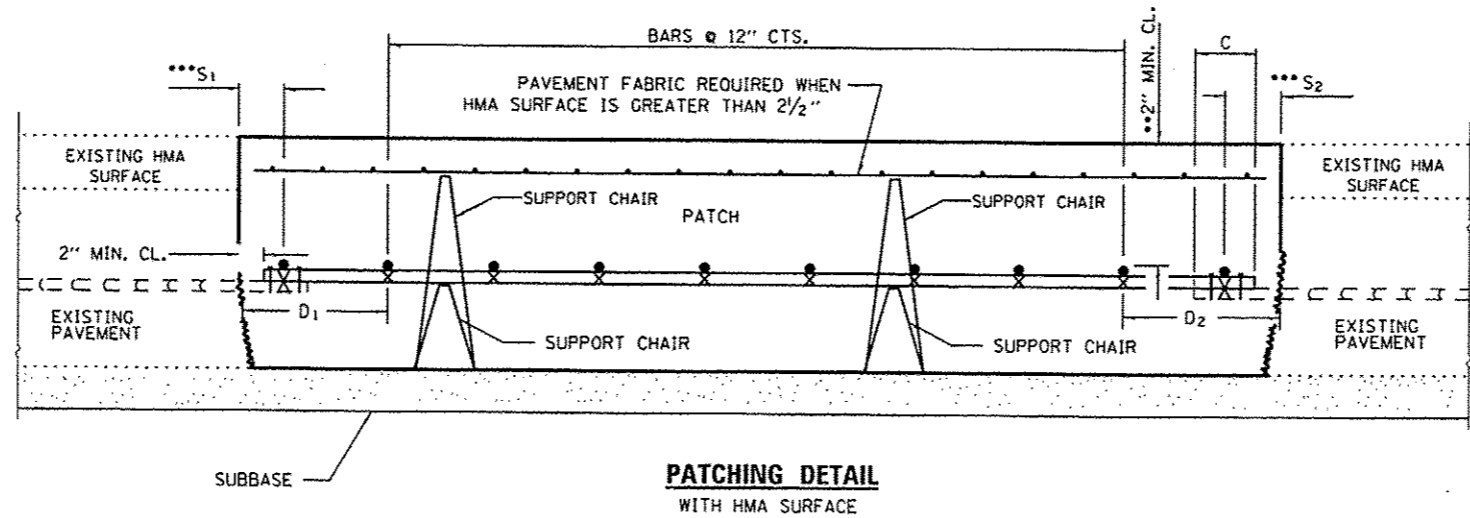

PATCHING DETAIL WITH HMA SURFACE

- EVERY 3rd INTERSECTION MUST BE TIED.
- ** WHEN THE MINIMUM CLEARANCE CANNOT BE OBTAINED WITH THE TRANSVERSE REBAR ON TOP, THEN THE TRANSVERSE REBAR SHALL BE TIED TO THE BOTTOM OF THE LONGITUDINAL REBAR.
- *** VARIABLES: WHERE S_1 AND S_2 ARE $2\frac{1}{2}$ " MIN. AND 12" MAX. $D_1 = 2(S_1)$ AND $D_2 = 2(S_2)$.

FILE NAME :	USER NAME :	DESIGNED :	REVISED :	STATE OF ILLINOIS DEPARTMENT OF TRANSPORTATION	CLASS A PATCHES		F.A.I. RTE.	SECTION	COUNTY	TOTAL SHEETS	SHEET NO.
c:\pwwork\pwwork\patel\03035477\03036689\shd-details.dgn	patel	DRAWN :	REVISED :				57	03 PATCHING 2014-3	KANKAKEE	17	12
		CHECKED :	REVISED :		SCALE: SHEET NO. 1 OF 1 SHEETS		STA.	TO STA.		CONTRACT NO. 66C89	
		DATE :	REVISED :		ILLINOIS FED. AID PROJECT						

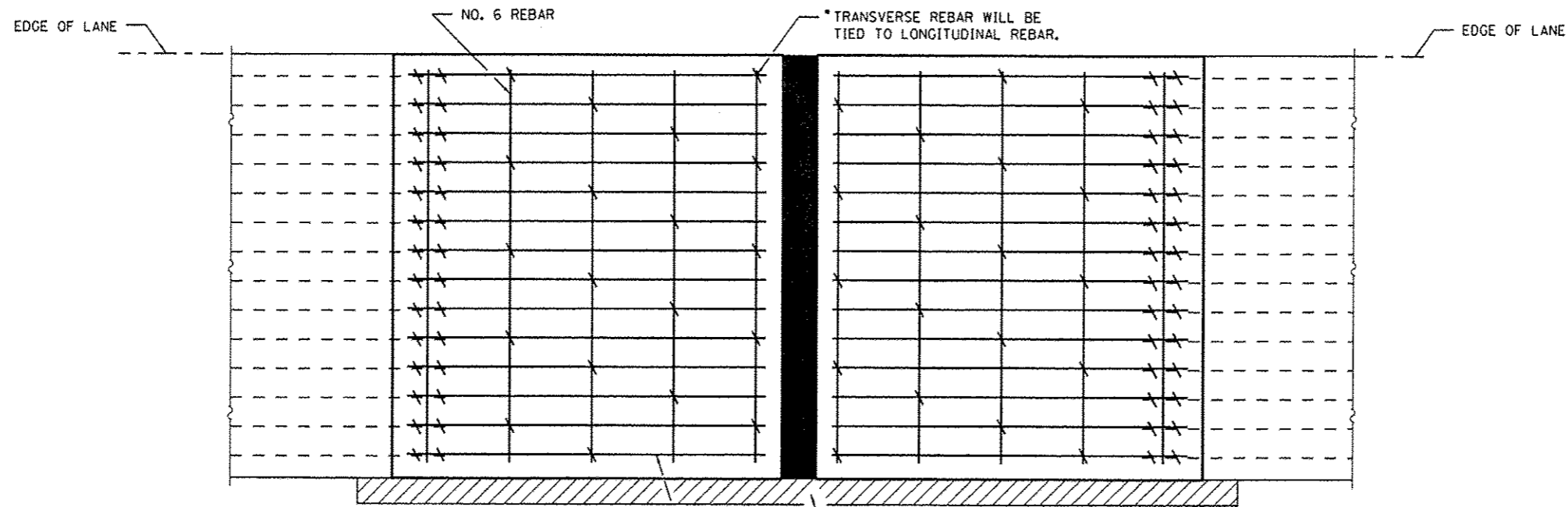

TRANSVERSE REBAR WILL EXTEND TO OUTER LONGITUDINAL REBAR WHILE PROVIDING A MINIMUM 3" CLEARANCE FROM EXISTING PAVEMENT EDGE.

PAVEMENT REINFORCEMENT DETAIL

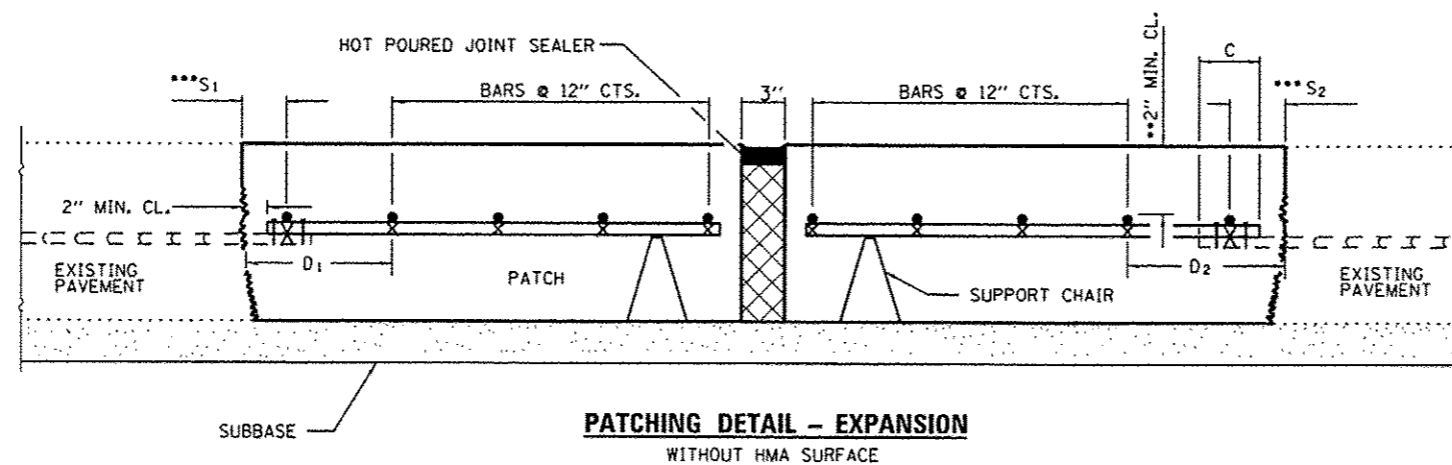

PATCHING DETAIL - EXPANSION WITHOUT HMA SURFACE

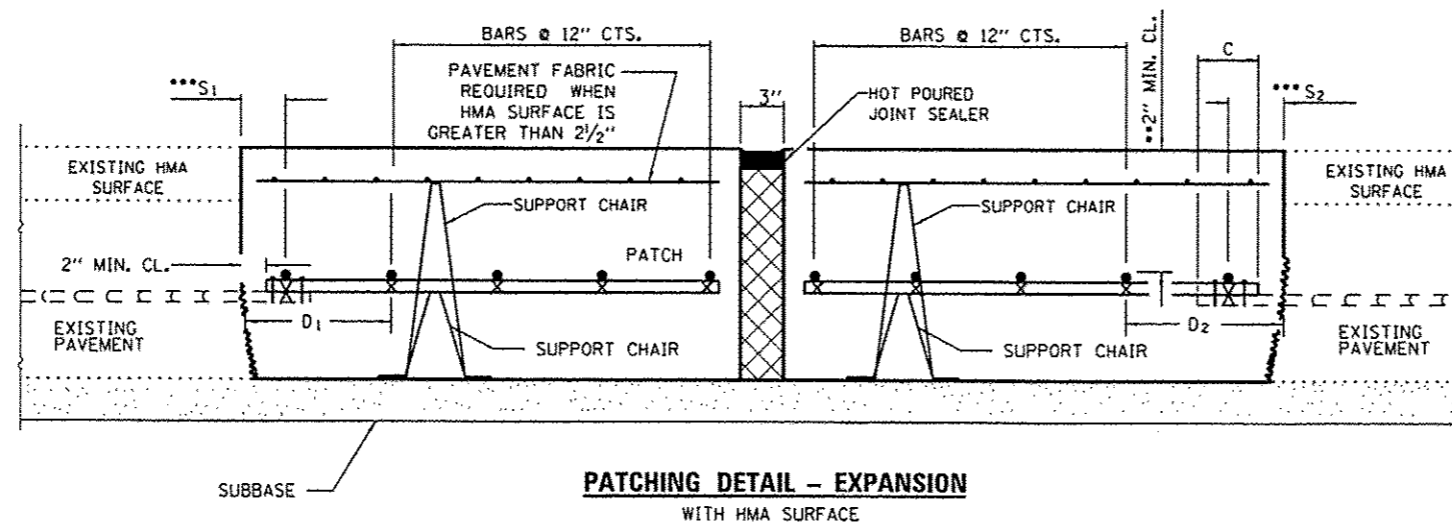

PATCHING DETAIL - EXPANSION WITH HMA SURFACE

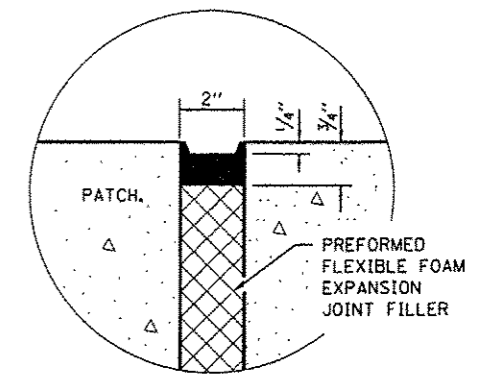

SEALING DETAIL

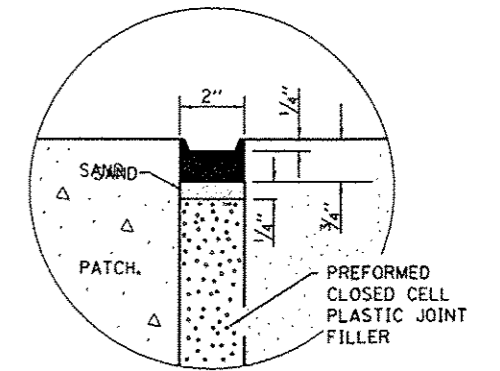

SEALING DETAIL

- EVERY 3rd INTERSECTION MUST BE TIED.
 - ** WHEN THE MINIMUM CLEARANCE CANNOT BE OBTAINED WITH THE TRANSVERSE REBAR ON TOP, THEN THE TRANSVERSE REBAR SHALL BE TIED TO THE BOTTOM OF THE LONGITUDINAL REBAR.
 - ***
- VARIABLES: WHERE S_1 AND S_2 ARE $2\frac{1}{2}$ " MIN. AND 12" MAX. $D_1 = 2(S_1)$ AND $D_2 = 2(S_2)$.

FILE NAME: c:\pwork\p1dot\patel\ad0335477\036689-shr-details.dgn	USER NAME: pateluj	DESIGNED: -	REVISED: -	STATE OF ILLINOIS DEPARTMENT OF TRANSPORTATION	CLASS A PATCHES WITH EXPANSION	F.A.I. RTE.:	SECTION:	COUNTY:	TOTAL SHEETS:	SHEET NO.:
PLOT SCALE: 100.0000 1/ in.	CHECKED: -	REVISED: -	57			D3 PATCHING 2014-3	KANKAKEE	17	13	
PLOT DATE: 4/3/2013	DATE: -	REVISED: -	CONTRACT NO. 66C89							
						ILLINOIS FED. AID PROJECT				
				SCALE:	SHEET NO. 1 OF 1 SHEETS	STA.	TO STA.			

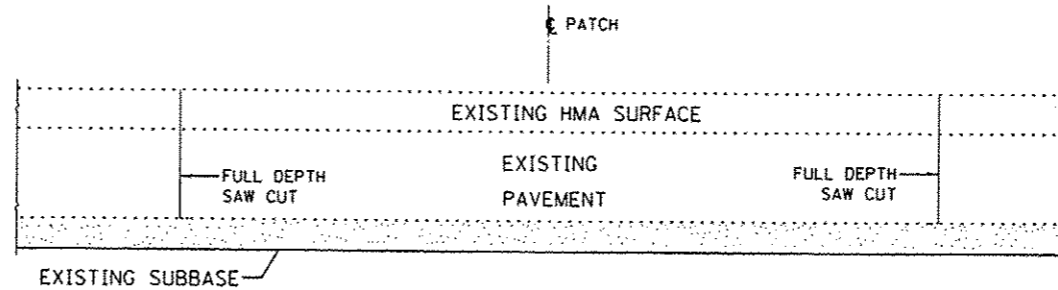
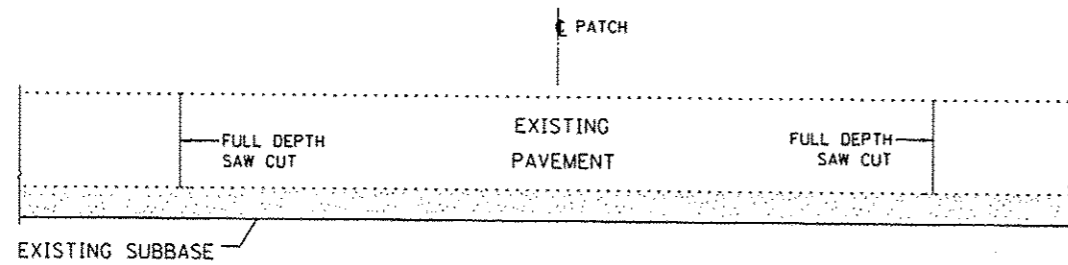
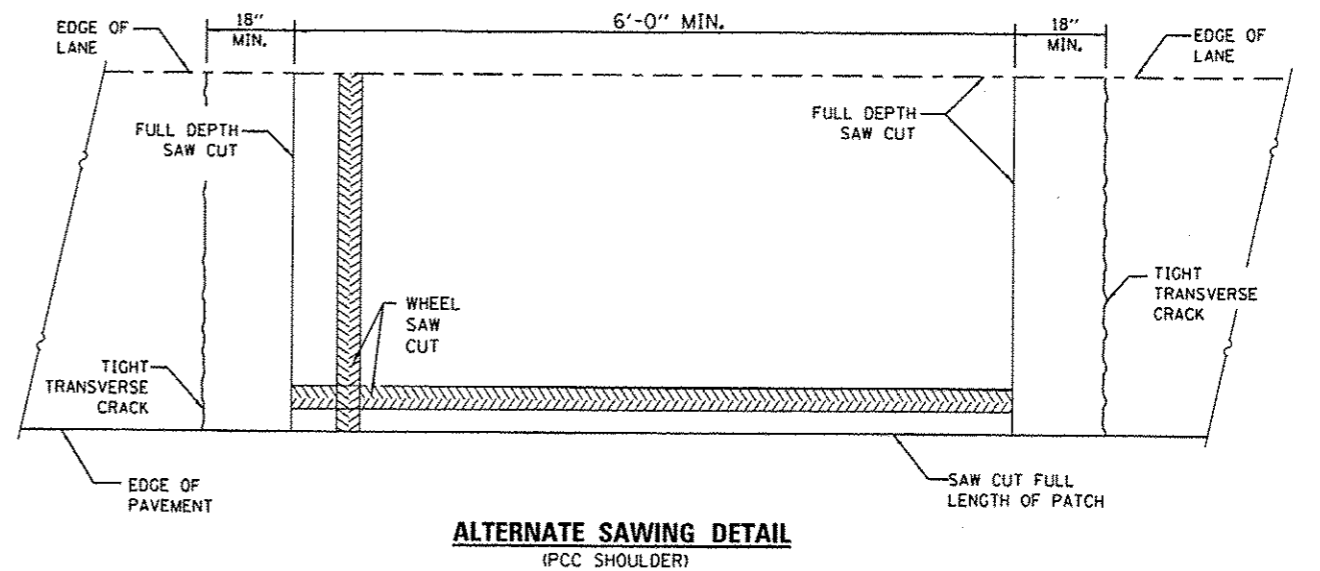
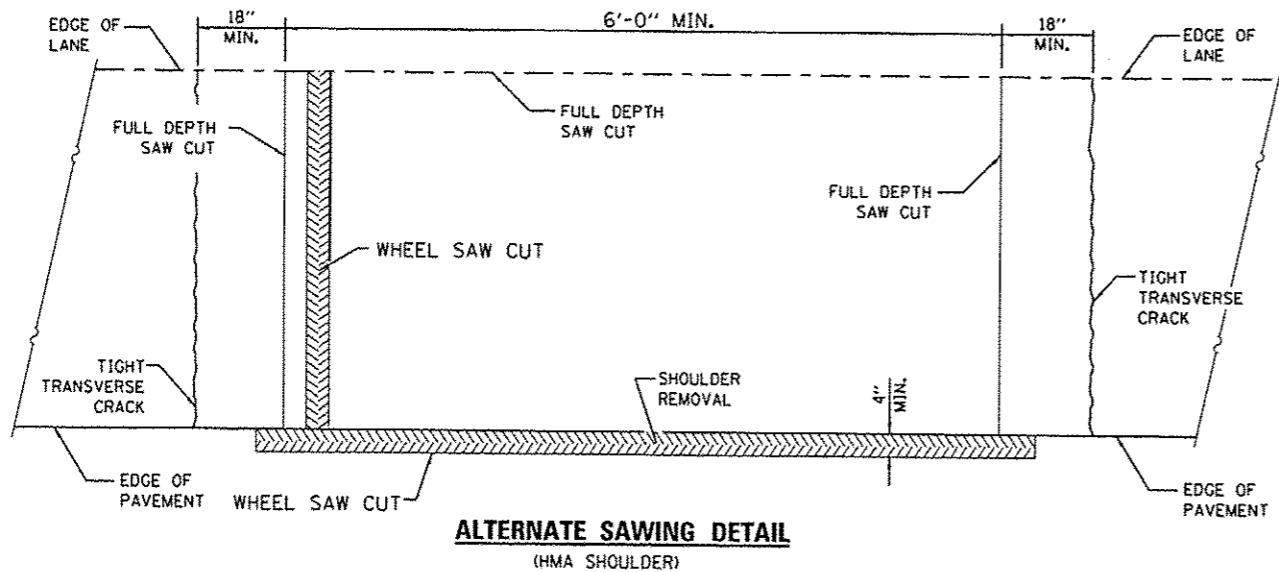
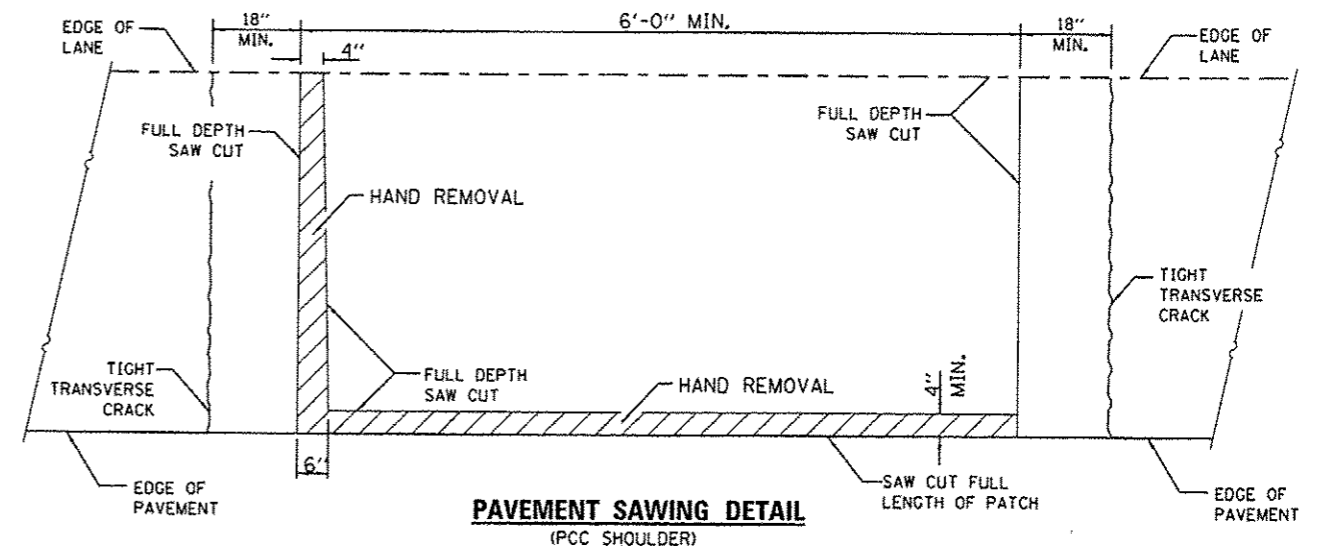
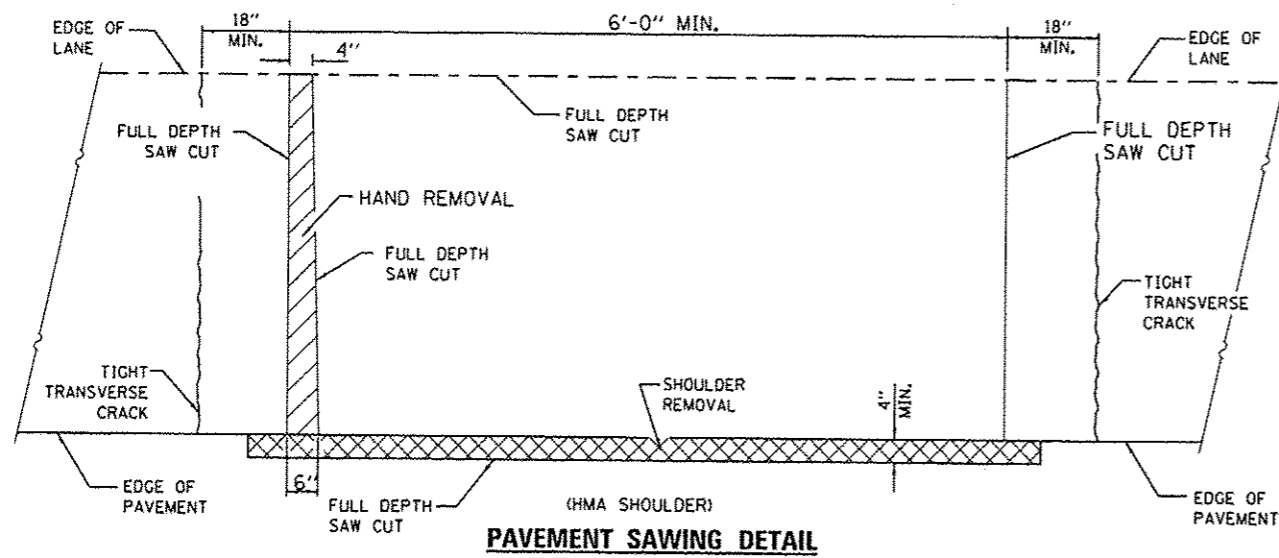

GENERAL NOTES

THE TRANSVERSE JOINTS FOR CLASS B PATCHES SHALL ALIGN WITH JOINTS OR CRACKS IN THE ADJACENT LANE WHENEVER POSSIBLE.

SEE STANDARD 420701 FOR DETAIL OF PAVEMENT FABRIC.

FILE NAME =	USER NAME = petelyj	DESIGNED -	REVISED -
c:\p\work\pav\dot\petelyj\0335477\036689-shr-detail.dgn		DRAWN -	REVISED -
		CHECKED -	REVISED -
		DATE -	REVISED -

STATE OF ILLINOIS
DEPARTMENT OF TRANSPORTATION

CLASS B PATCHES

SCALE: SHEET NO. 1 OF 1 SHEETS STA. TO STA.

F.A.I. RTE.	SECTION	COUNTY	TOTAL SHEETS	SHEET NO.
57	D3 PATCHING 2014-3	KANKAKEE	17	14
CONTRACT NO. 66C89			ILLINOIS FED. AID PROJECT	

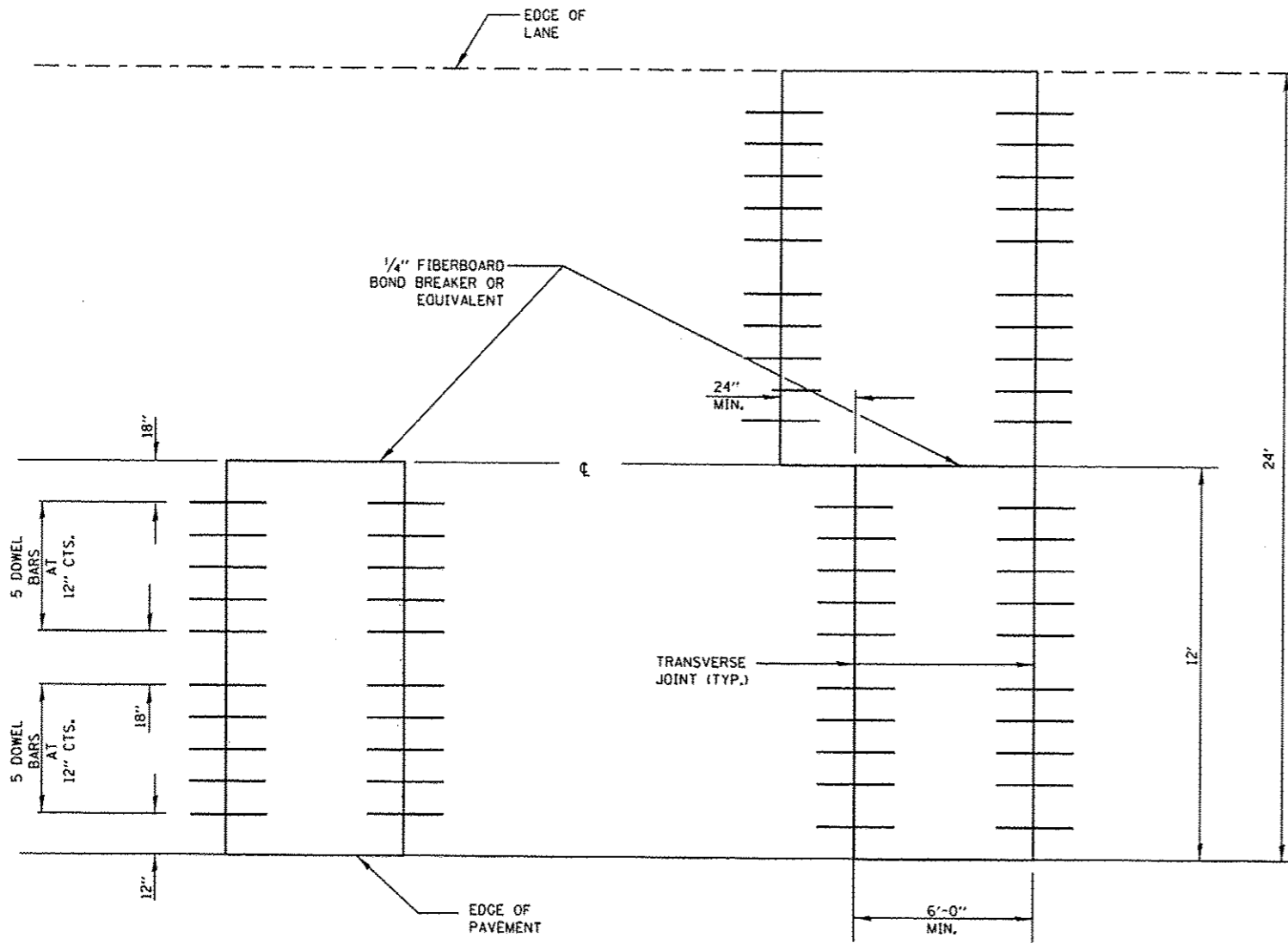

12' (3.6 m) WIDE LANES

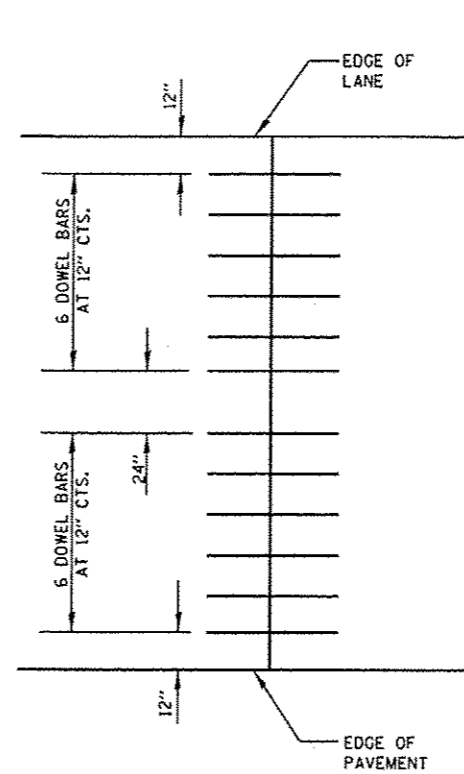

14' WIDE RAMP

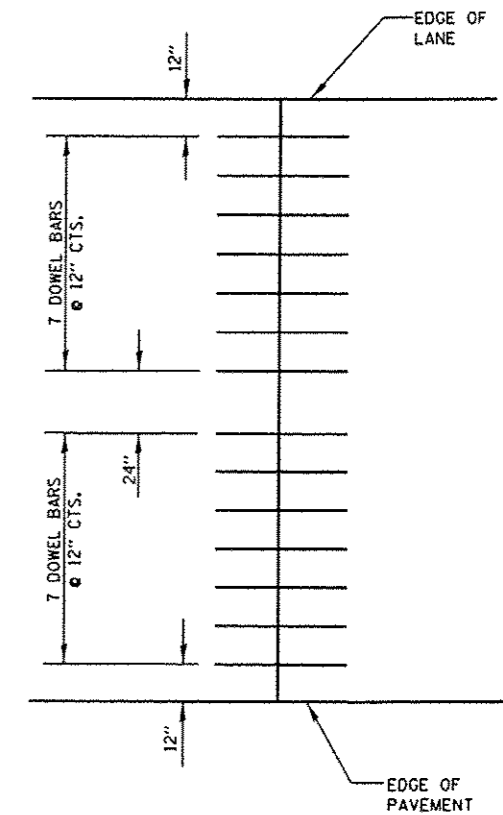

16' WIDE RAMP

FILE NAME *	USER NAME = patelyj	DESIGNED -	REVISED -
c:\pwwork\pavdot\patelyj\0335477\0366	03-shr-details.dgn	DRAWN -	REVISED -
	PLOT SCALE = 1/8" = 1' / in.	CHECKED -	REVISED -
	PLOT DATE = 4/3/2013	DATE -	REVISED -

STATE OF ILLINOIS
DEPARTMENT OF TRANSPORTATION

CLASS B PATCHES

SCALE: SHEET NO. 1 OF 1 SHEETS STA. TO STA.

F.A.J. RTE.	SECTION	COUNTY	TOTAL SHEETS	SHEET NO.
57	D3 PATCHING 2014-3	KANKAKEE	17	15
CONTRACT NO. 66C89			ILLINOIS FED. AID PROJECT	

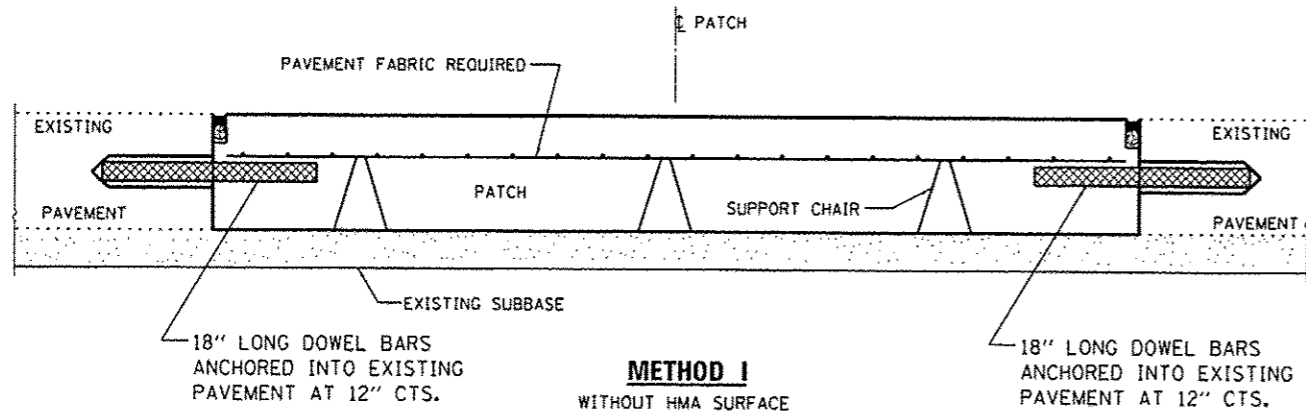

METHOD I
WITHOUT HMA SURFACE

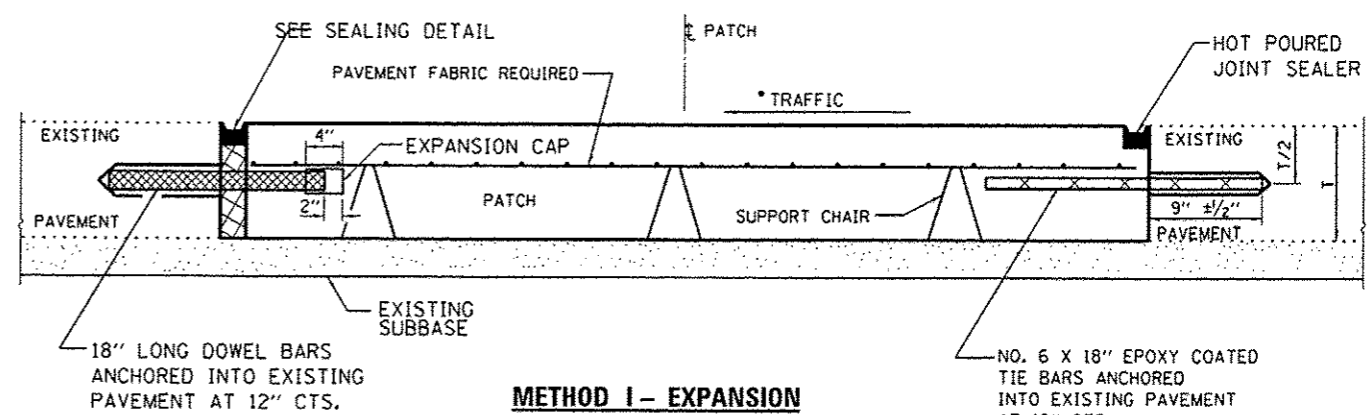

METHOD I - EXPANSION
WITHOUT HMA SURFACE

DOWEL BAR TABLE		
PAVEMENT THICKNESS	DOWEL BAR DIAMETER	HOLE DIAMETER
8" OR GREATER	1 1/2"	1 5/8"
7" THRU 7 5/8"	1 1/4"	1 3/8"
LESS THAN 7"	1"	1 1/8"

NOTE
WHEN RE-ESTABLISHING A TRANSVERSE EXPANSION JOINT ON A TWO-LANE, TWO-WAY ROAD, REVERSE THE ORIENTATION OF THE DOWEL BARS WITH RESPECT TO TRAFFIC FOR ONE OF THE PATCHES SUCH THAT THE JOINT WILL BE CONTINUOUS ACROSS BOTH LANES.

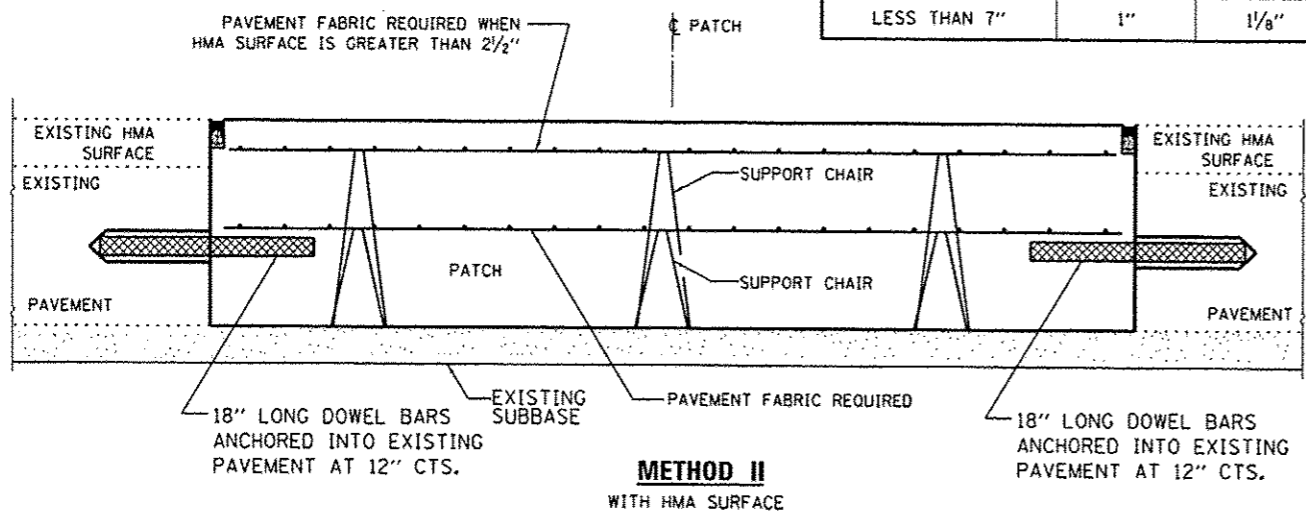

METHOD II
WITH HMA SURFACE

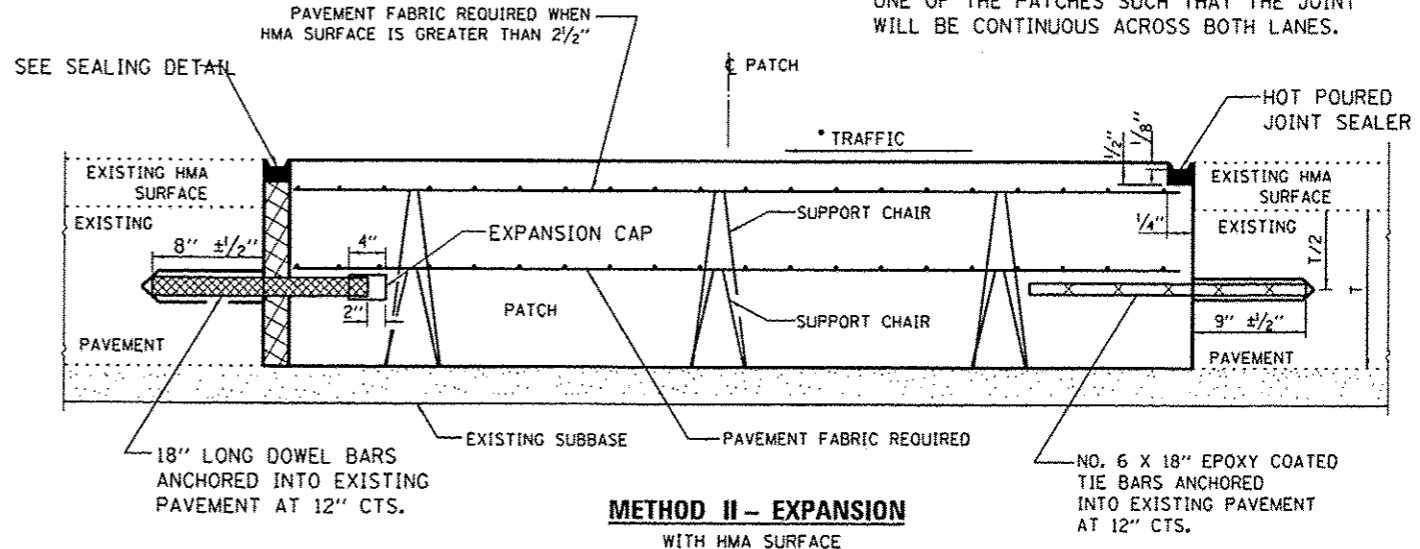

METHOD II - EXPANSION
WITH HMA SURFACE

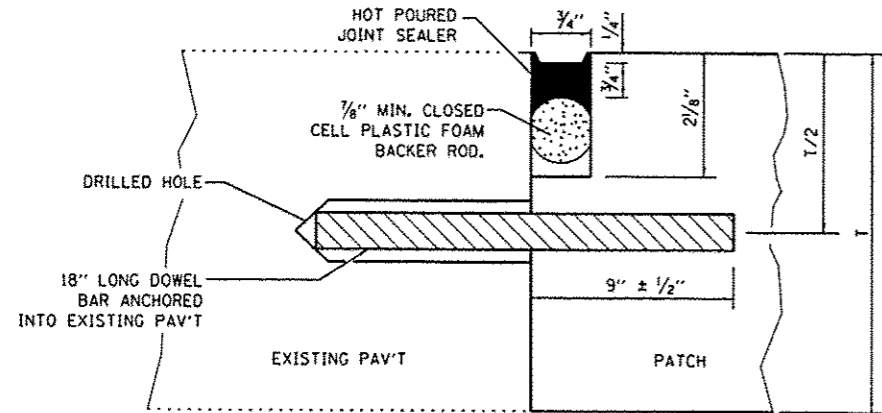

TRANSVERSE JOINT

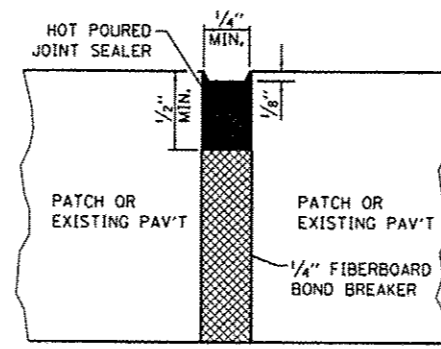

CENTERLINE JOINT

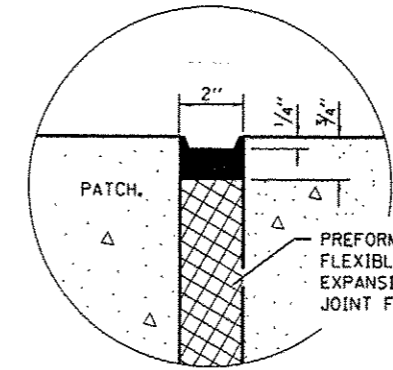

SEALING DETAIL

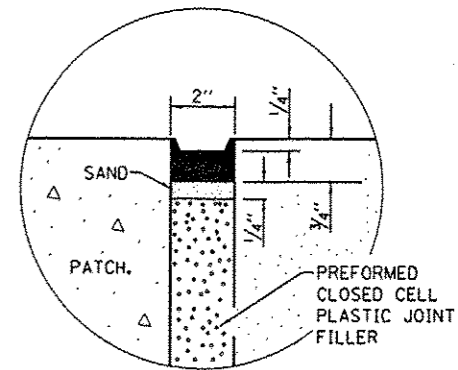

SEALING DETAIL

FILE NAME =	USER NAME = potelyj	DESIGNED =	REVISED =
c:\pwork\pavdat\potelyj\0335477\0366	09-shr-deta11a.dgn	DRAWN =	REVISED =
	PLOT SCALE = 100.0000 / in.	CHECKED =	REVISED =
	PLOT DATE = 4/3/2013	DATE =	REVISED =

STATE OF ILLINOIS
DEPARTMENT OF TRANSPORTATION

CLASS B PATCHES WITH EXPANSION

SCALE: SHEET NO. 1 OF 1 SHEETS STA. TO STA.

F.A.J. RTE.	SECTION	COUNTY	TOTAL SHEETS	SHEET NO.
57	03 PATCHING 2014-3	KANKAKEE	17	16
CONTRACT NO. 66C89			ILLINOIS FED. AID PROJECT	

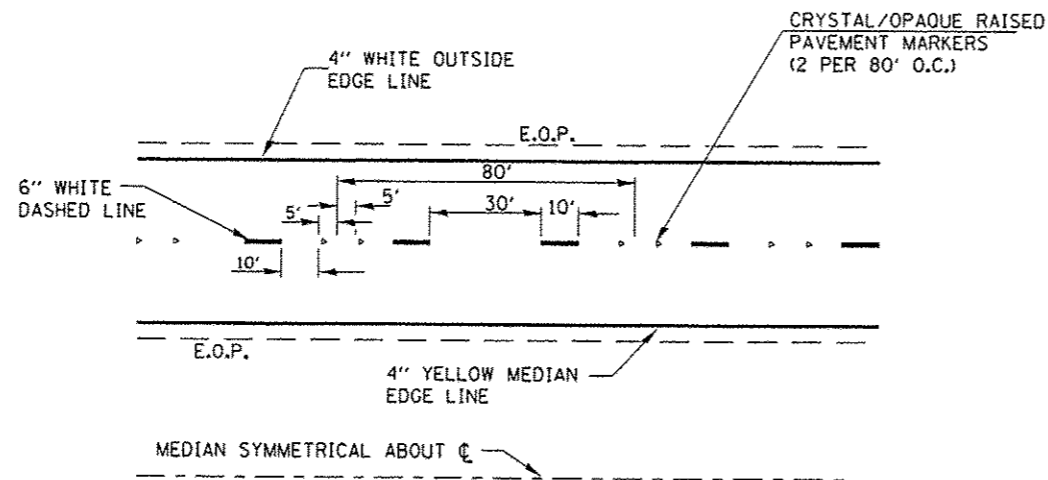

TYPICAL PAVEMENT MARKINGS

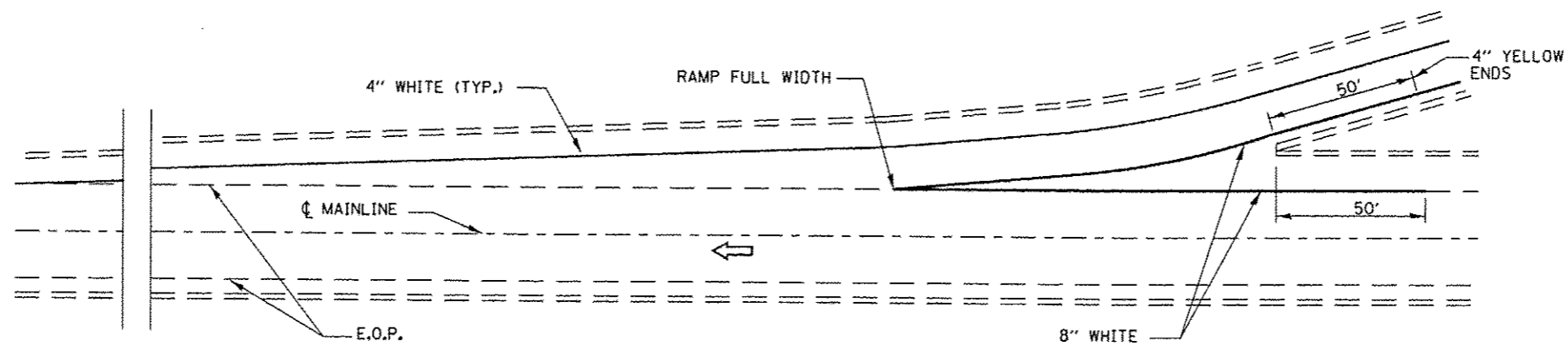

TYPICAL PAVEMENT MARKING FOR ENTRANCE RAMP TERMINALS

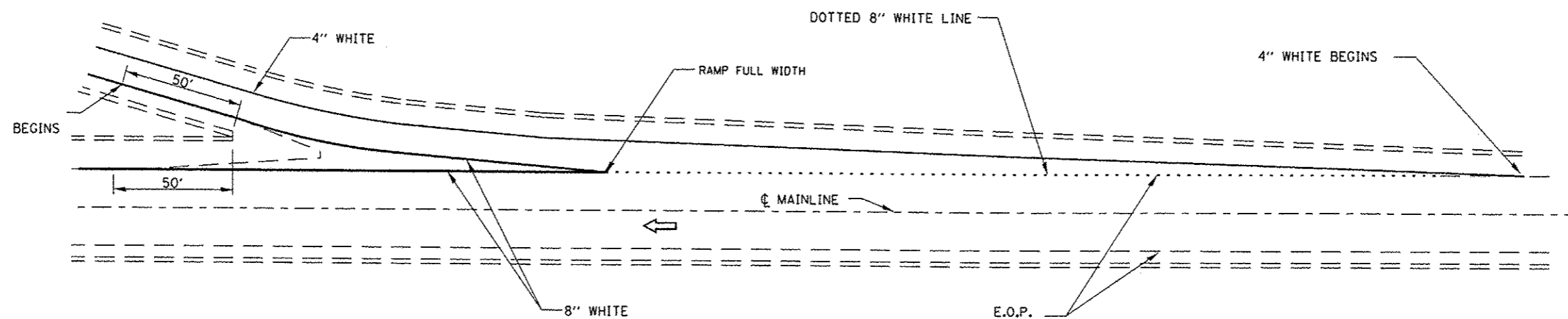

TYPICAL PAVEMENT MARKINGS FOR EXIT RAMP TERMINALS

FILE NAME =	USER NAME = petelyj	DESIGNED -	REVISED -	STATE OF ILLINOIS DEPARTMENT OF TRANSPORTATION	TYPICAL PAVEMENT MARKING		F.A.I. RTE.	SECTION	COUNTY	TOTAL SHEETS	SHEET NO.
c:\pwwork\petidoc\petelyj\080305477\0366	99-shd-detailed.dgn	DRAWN -	REVISED -				57	03 PATCHING 2014-3	KANKAKEE	17	17
	PLOT SCALE = 100.0000' / in.	CHECKED -	REVISED -		SCALE: SHEET NO. 1 OF 1 SHEETS		STA. TO STA.		CONTRACT NO. 66C89		
	PLOT DATE = 4/3/2013	DATE -	REVISED -		ILLINOIS FED. AID PROJECT						