

STATE OF ILLINOIS
DEPARTMENT OF TRANSPORTATION
DIVISION OF HIGHWAYS

**PROPOSED
HIGHWAY PLANS**

F.A.P. ROUTE 673 (IL 116)
SECTION (102B-1)BR

**BRIDGE REPLACEMENT
TAZEWELL COUNTY**

F.A.P. RTE. 673	SECTION 102B-1BR	COUNTY TAZEWELL	TOTAL SHEETS 89	SHEET NO. 1
ILLINOIS CONTRACT NO. 68671			* 89 + 1 = 90	

D-94-140-06

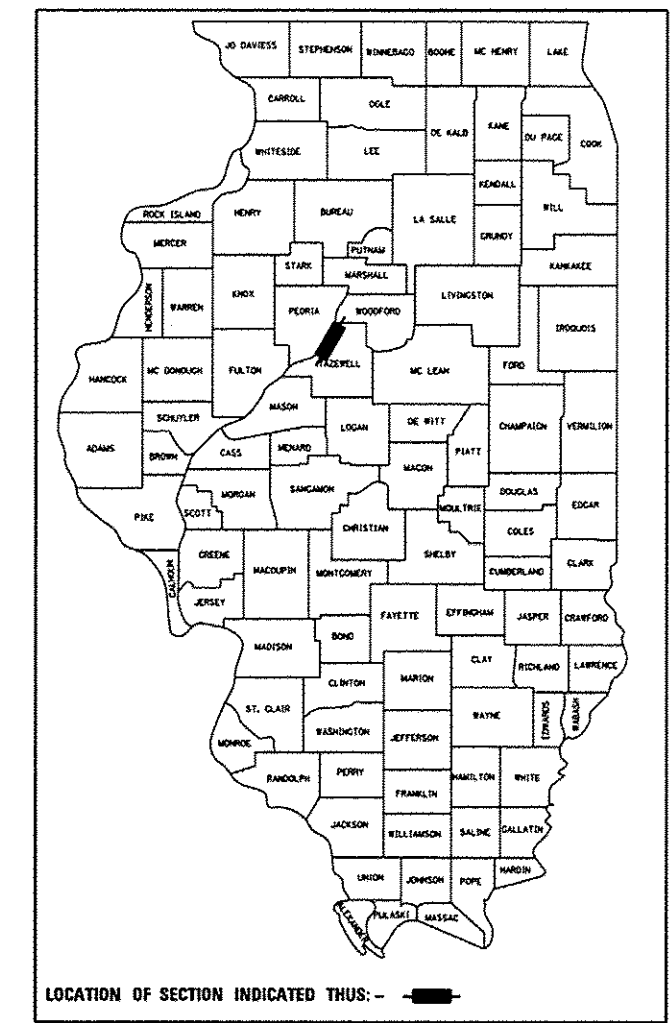

FUNCTIONAL CLASSIFICATION
MINOR ARTERIAL (NON-URBAN)
2009 ADT = 18,500
P.V. = 95.9% S.U. = 1.9% M.U. = 2.2%

STATE OF ILLINOIS
DEPARTMENT OF TRANSPORTATION
DIVISION OF HIGHWAYS

SUBMITTED Dec 14, 2012

[Signature]
DEPUTY DIRECTOR OF HIGHWAYS, REGION ENGINEER

20 _____
ENGINEER OF DESIGN AND ENVIRONMENT

20 _____
DIRECTOR OF HIGHWAYS, CHIEF ENGINEER

FOR INDEX OF SHEETS, SEE SHEET NO. 2

- HIGHWAY STANDARDS 701901-02
- 000001-06 704001-07
 - 280001-07 780001-03
 - 420401-09 781001-03
 - 515001-03 601101-01
 - 602301-03
 - 602306-03
 - 602601-02
 - 604036-02
 - 630001-10
 - 630301-06
 - 631026-05
 - 631031-11
 - 635006-03
 - 635011-02
 - 666001-01
 - 701101-03
 - 701106-02
 - 701416-07
 - 701422-05

- END CONSTRUCTION
STA 325 + 70
- END IMPROVEMENT
STA 320 + 00
- STATION EQUATION
STA 318 + 80.74 BK =
STA 319 + 00.64 AH
- BRIDGE REPLACEMENT
STA 316 + 93.71 TO
STA 318 + 76.59
- EXIST SN 090-0065
- PROP SN 090-0179
- BEGIN IMPROVEMENT
STA 313 + 00
- BEGIN CONSTRUCTION
STA 301 + 45

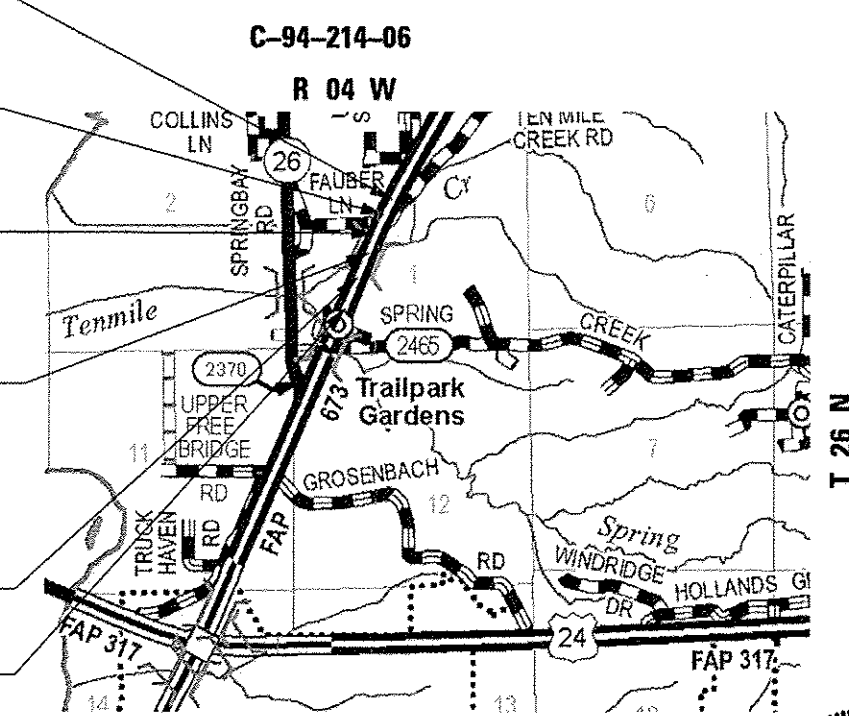

N
LOCATION MAP
NOT TO SCALE

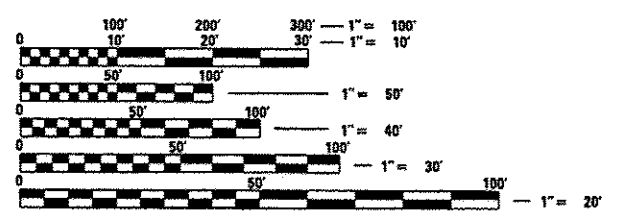

FULL SIZE PLANS HAVE BEEN PREPARED USING STANDARD ENGINEERING SCALES. REDUCED SIZED PLANS WILL NOT CONFORM TO STANDARD SCALES. IN MAKING MEASUREMENTS ON REDUCED PLANS, THE ABOVE SCALES MAY BE USED.

J.U.L.I.E.
JOINT UTILITY LOCATION INFORMATION FOR EXCAVATION
1-800-892-0123
OR 811

PROJECT ENGINEER: RICHARD DOTSON, P.E.
PROJECT MANAGER: KEVIN HORST, P.E.
CATALOG NO. 033422-00D
CONTRACT NO. 68671

GROSS LENGTH = 2,405.1 FT. = 0.46 MILE
NET LENGTH = 680.1 FT. = 0.13 MILE

REVISI 6-4-13

GEORGE A. GHAREEB
062-047473
REGISTERED
PROFESSIONAL
ENGINEER
OF ILLINOIS

GEORGE GHAREEB, P.E.
LICENSED PROFESSIONAL ENGINEER
ILLINOIS NO. 062-047473 EXPIRES 11-30-13

TERRA
ENGINEERING LTD.
401 Main Street, Suite 1130
Peoria, IL 61602
(309)999-0123

**PRINTED BY THE AUTHORITY
OF THE STATE OF ILLINOIS**

12/14/2012 8:37:12 AM T:\Projects\10-221-1001-Tab-edges-Ten Mile Creek-Phase II\Drawings\CADD Sheets\068671-wt-cover.dgn