

I:\Projects\116-221\1101\1-Final\116-221-Ten Mile Creek-Phase 1\Drawings\116-221-1101-1-Final\116-221-1101-1-Final-116-221-1101-1-Final.dwg

I:\Projects\116-221\1101\1-Final\116-221-Ten Mile Creek-Phase 1\Drawings\116-221-1101-1-Final\116-221-1101-1-Final-116-221-1101-1-Final.dwg

I:\Projects\116-221\1101\1-Final\116-221-Ten Mile Creek-Phase 1\Drawings\116-221-1101-1-Final\116-221-1101-1-Final-116-221-1101-1-Final.dwg

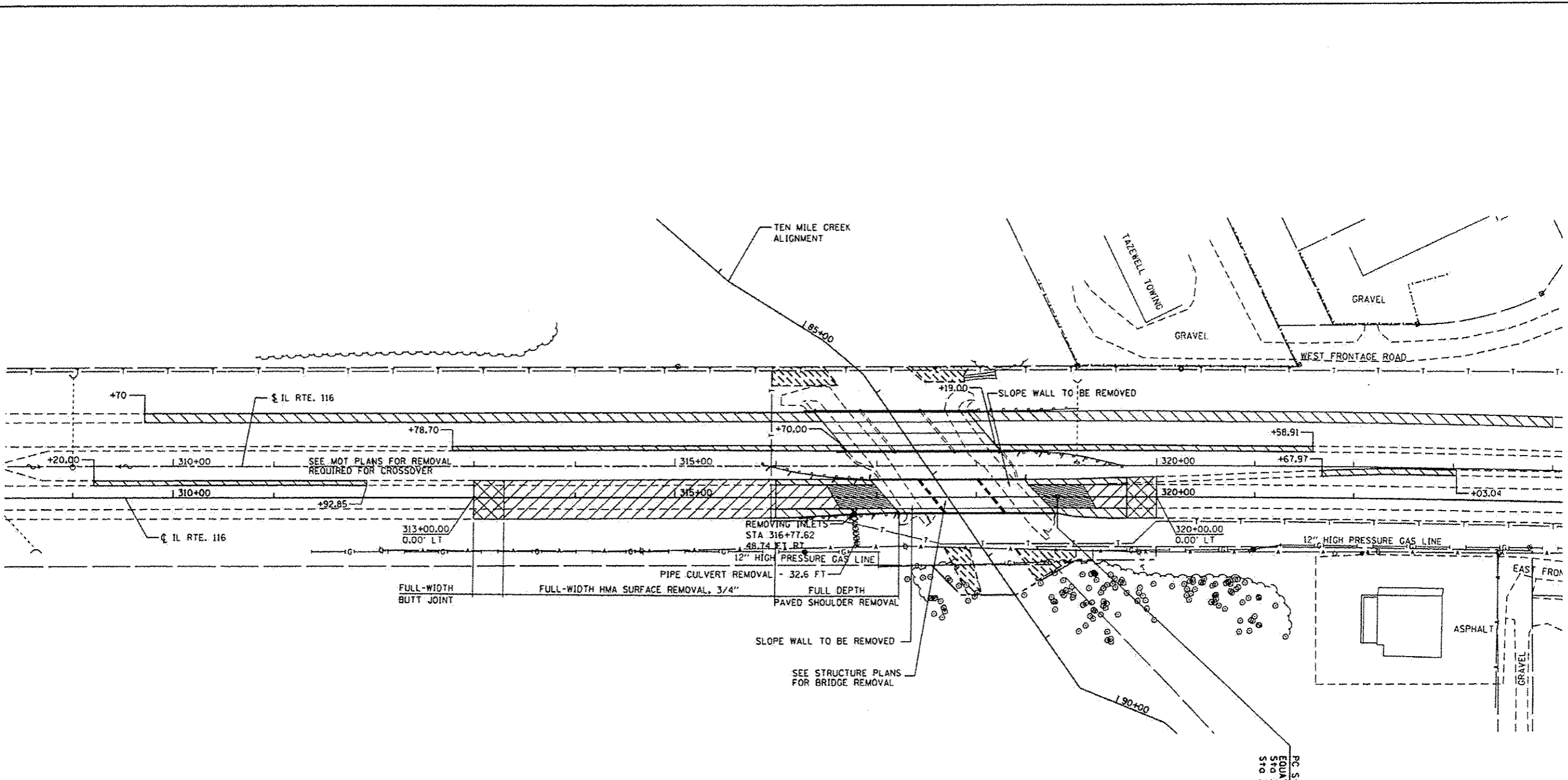

LEGEND

	HMA SURFACE REMOVAL, 3/4"
	HMA SURFACE REMOVAL - BUTT JOINT
	PAVED SHOULDER REMOVAL
	PAVEMENT REMOVAL
	GUARDRAIL REMOVAL
	TREE REMOVAL, ACRES
	PIPE CULVERT REMOVAL
	REMOVING INLETS

NOTE:
ALL STATIONS AND OFFSETS ARE BASED ON MEDIAN SURVEYLINE UNLESS OTHERWISE NOTED.

REVISSED SHEET 6-4-13

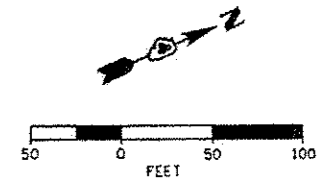

	USER NAME - WAH	DESIGNED - CL	REVISED - KJH (10-7) 04/10/13	STATE OF ILLINOIS DEPARTMENT OF TRANSPORTATION	REMOVAL PLANS IL 116 OVER TEN MILE CREEK		F.A.P. RTE. 673	SECTION (1028-1)BR	COUNTY TAZEWELL	TOTAL SHEETS 89	SHEET NO. 20		
	PLOT SCALE - 1/8"=1'-0"	DRAWN - WAH	REVISED -		SCALE: NTS	SHEET NO. 1 OF 1 SHEETS	STA. TO STA.	[ILLINOIS] FED. AID PROJECT					
	PLOT DATE - 12/13/2012	CHECKED - KJC/HTL	REVISED -										
		DATE - 10/04/12	REVISED -										