

- LEGEND**
- ← DIRECTION OF TRAFFIC
  - [Hatched Box] PAVED SHOULDER REMOVAL AND REPLACEMENT (COMPLETED IN STAGE I)
  - [Dashed Line] TEMPORARY CONCRETE BARRIER
  - [TBR Symbol] TO BE REMOVED
  - ① TEMPORARY TRAFFIC BARRIER TERMINAL, TYPE 1 (SPECIAL) TANGENT
  - ② TEMPORARY STEEL PLATE BEAM GUARDRAIL, TYPE A
  - ③ TEMPORARY TRAFFIC BARRIER TERMINAL, TYPE 6
  - ④ TEMPORARY TRAFFIC BARRIER, TYPE 5
  - ⑤ TRAFFIC BARRIER TERMINAL, TYPE 6
  - ⑥ STEEL PLATE BEAM GUARDRAIL, TYPE A, 6 FOOT POSTS
  - ⑦ COMBINATION CONCRETE CURB AND GUTTER, TYPE B-6.12
- SEE SCHEDULE OF QUANTITIES FOR STATION LIMITS.

- NOTES:**
1. ALL STATIONS AND OFFSETS ARE REFERENCED FROM  $\phi$  IL 116.

DATE	
BY	
CHECKED	
DESIGNED	
FILE NAME	
NOTE BOOK	
NO. OF SHEETS	
DATE	

DATE	
BY	
CHECKED	
DESIGNED	
FILE NAME	
NOTE BOOK	
NO. OF SHEETS	
DATE	

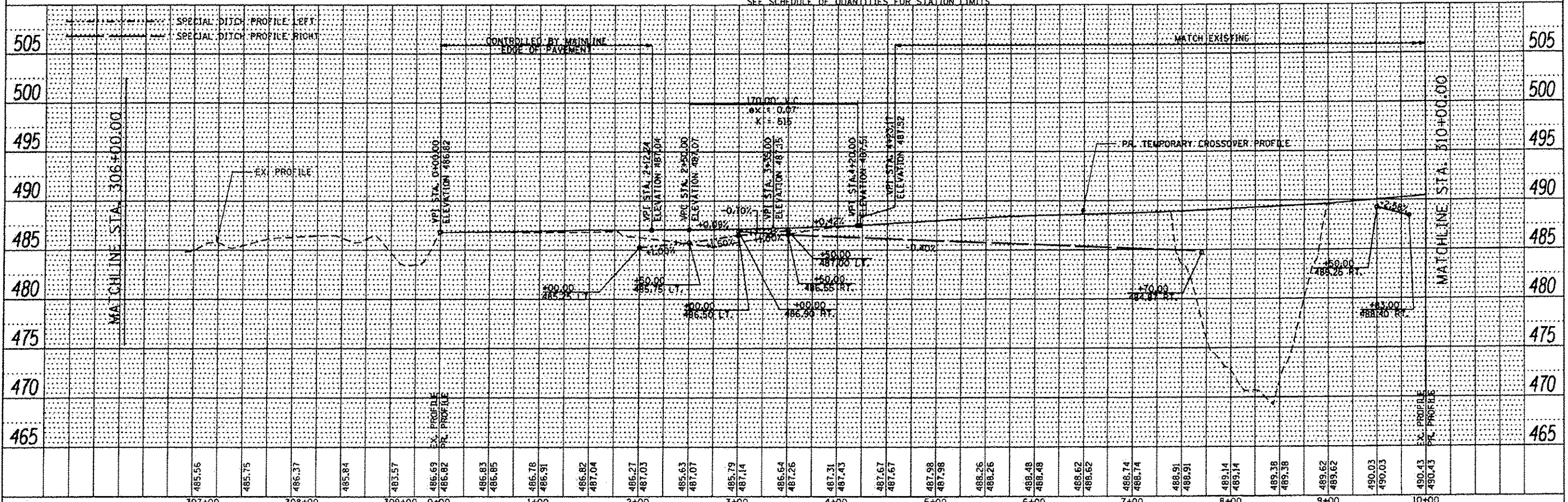

DESIGN FIRM <b>whks</b> engineers • planners • land surveyors	USER NAME • bsmiths FILE NAME • 0486671-ahx-MOT.dgn PLOT SCALE • 1/8" = 1'-0" PLOT DATE • 12/13/2012	DESIGNED - CHECKED - DRAWN - CHECKED -	REVISED REVISED REVISED REVISED	<b>STATE OF ILLINOIS</b> <b>DEPARTMENT OF TRANSPORTATION</b>	<b>IL ROUTE 116 OVER TEN MILE CREEK</b> <b>TEMPORARY CROSSOVER PLAN AND PROFILE</b>	F.A.P. RTE. 673 SECTION 102B-10BR COUNTY TAZEWELL TOTAL SHEETS 89 SHEET NO. 24 CONTRACT NO. 68671
---	---	---	--	---	--	--

SCALE: 1" = 50' SHEET NO. 2 OF 3 SHEETS STA. 306+00.00 TO STA. 10+00.00 ILLINOIS FED. AID PROJECT