

DATE	
BY	
FINAL SURVEY	
SURVEY PLOTTED	
NOTE BOOK	
AREA'S	
OK'D	
NO. _____	

DATE	
BY	
ORIGINAL SURVEY	
SURVEY PLOTTED	
NOTE BOOK	
AREA'S	
OK'D	
NO. _____	

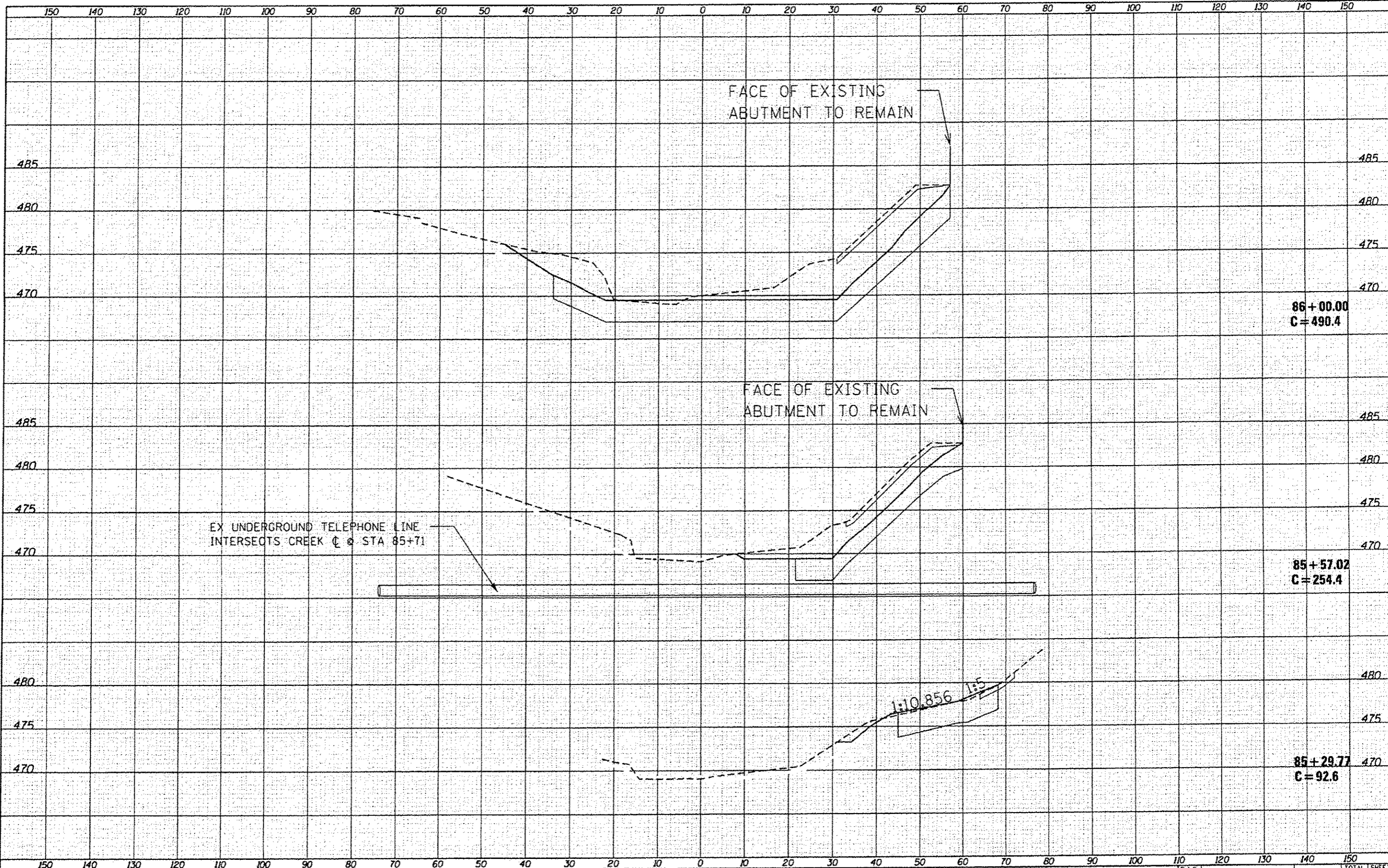

86+00.00  
C=490.4

85+57.02  
C=254.4

85+29.77  
C=92.6



USER NAME: WAH  
DESIGNED: CL  
DRAWN: WAH  
CHECKED: -KJC/HTL  
DATE: -10/04/12

REVISIONS:  
REVISED - KJM (REV) 4/10/13  
REVISED - [Signature] SHEET  
REVISED - 6-4-13

STATE OF ILLINOIS  
DEPARTMENT OF TRANSPORTATION

CREEK CROSS SECTIONS  
IL 116 OVER TEN MILE CREEK  
SCALE: SHEET NO. 1 OF 4 SHEETS STA. 85+29.77 TO STA. 86+00.00

F.A.P. NO. 673	SECTION 1102B-11BR	COUNTY TAZEWELL	TOTAL SHEETS 89	SHEET NO. 86
FED. ROAD DIST. NO. ILLINOIS FED. AID PROJECT			CONTRACT NO. 68671	

K-Phase 1180-awings&c-add Sheets 85-4685-77