

NOTES:

TRAFFIC CONTROL IN ACCORDANCE WITH HIGHWAY STANDARD 701321.

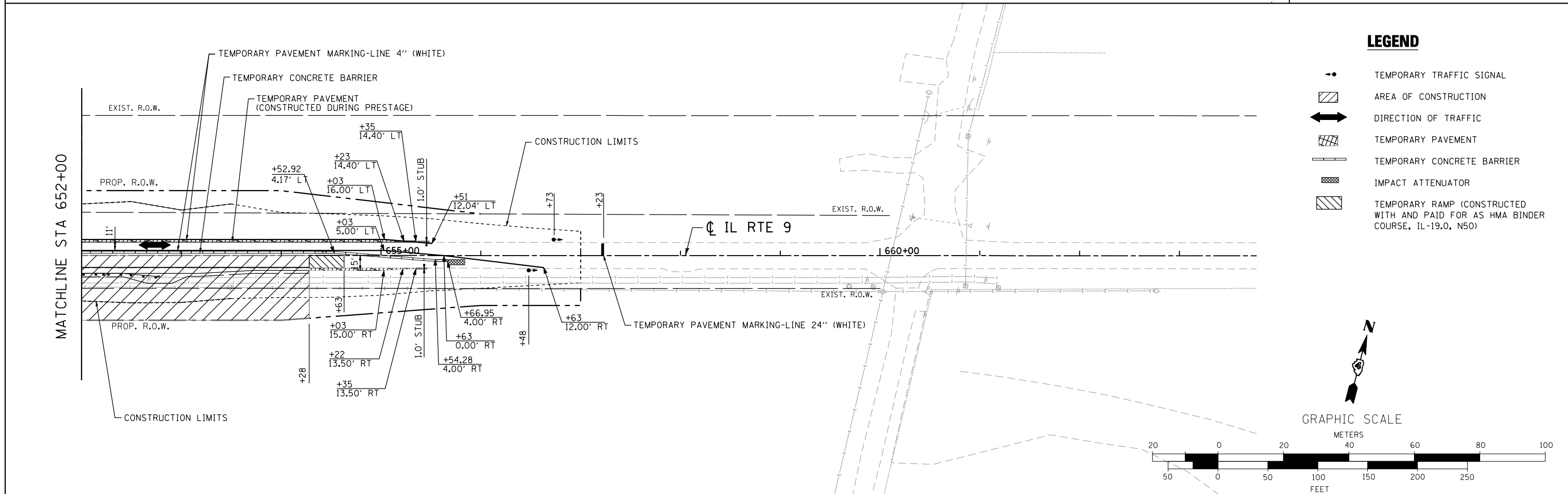

LEGEND

- TEMPORARY TRAFFIC SIGNAL
- AREA OF CONSTRUCTION
- DIRECTION OF TRAFFIC
- TEMPORARY PAVEMENT
- TEMPORARY CONCRETE BARRIER
- IMPACT ATTENUATOR
- TEMPORARY RAMP (CONSTRUCTED WITH AND PAID FOR AS HMA BINDER COURSE, IL-19.0, N50)

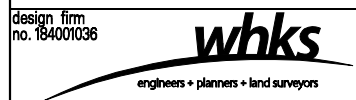
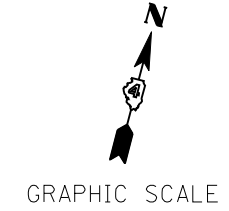

USER NAME = gjameson	DESIGNED -	REVISED
FILE NAME = D468757-shr-mot1.dgn	CHECKED -	REVISED
PLOT SCALE = 100.0000 "/>		

**STATE OF ILLINOIS
DEPARTMENT OF TRANSPORTATION**

**IL ROUTE 9 OVER MUD CREEK
MAINTENANCE OF TRAFFIC STAGE I**

SCALE: 1" = 50' SHEET NO. 1 OF 1 SHEETS STA. 643+00.00 TO STA. 657+00.00

F.A.P. RTE. 693	SECTION (119B)BR	COUNTY TAZEWELL	TOTAL SHEETS 80	SHEET NO. 25
CONTRACT NO. 68757				
ILLINOIS FED. AID PROJECT				