

**NOTES:**

TRAFFIC CONTROL IN ACCORDANCE WITH HIGHWAY STANDARD 701321.

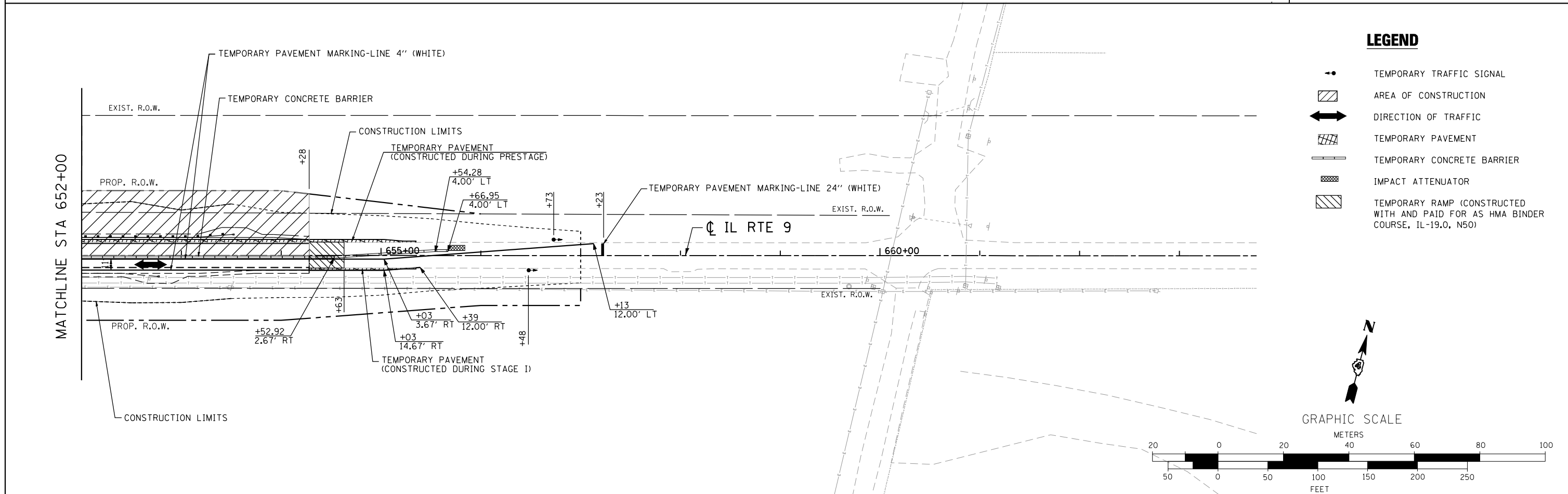

**LEGEND**

- TEMPORARY TRAFFIC SIGNAL
- AREA OF CONSTRUCTION
- DIRECTION OF TRAFFIC
- TEMPORARY PAVEMENT
- TEMPORARY CONCRETE BARRIER
- IMPACT ATTENUATOR
- TEMPORARY RAMP (CONSTRUCTED WITH AND PAID FOR AS HMA BINDER COURSE, IL-19.0, N50)

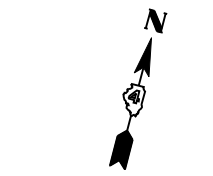

GRAPHIC SCALE

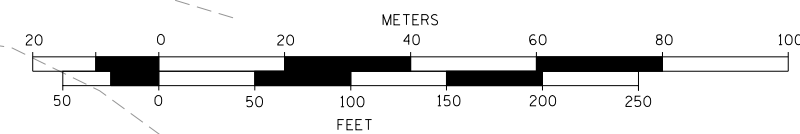

design firm  
no. 184001036  
**whks**  
engineers • planners • land surveyors

USER NAME = gjameson	DESIGNED -	REVISED
FILE NAME = D468757-sh1-mot2.dgn	CHECKED -	REVISED
PLOT SCALE = 100.0000' / IN.	DRAWN -	REVISED
PLOT DATE = 1/22/2013	CHECKED -	REVISED

**STATE OF ILLINOIS  
DEPARTMENT OF TRANSPORTATION**

**IL ROUTE 9 OVER MUD CREEK  
MAINTENANCE OF TRAFFIC STAGE II**

SCALE: 1" = 50' SHEET NO. 1 OF 1 SHEETS STA. 643+00.00 TO STA. 657+00.00

F.A.P. RTE. 693	SECTION (119BR)BR	COUNTY TAZEWELL	TOTAL SHEETS 80	SHEET NO. 26
CONTRACT NO. 68757				
ILLINOIS FED. AID PROJECT				