

|               |  |
|---------------|--|
| DATE          |  |
| BY            |  |
| SURVEYED      |  |
| PLOTTED       |  |
| TEMPLATE      |  |
| AREAS CHECKED |  |
| NO.           |  |

|               |  |
|---------------|--|
| DATE          |  |
| BY            |  |
| SURVEYED      |  |
| PLOTTED       |  |
| TEMPLATE      |  |
| AREAS CHECKED |  |
| NO.           |  |

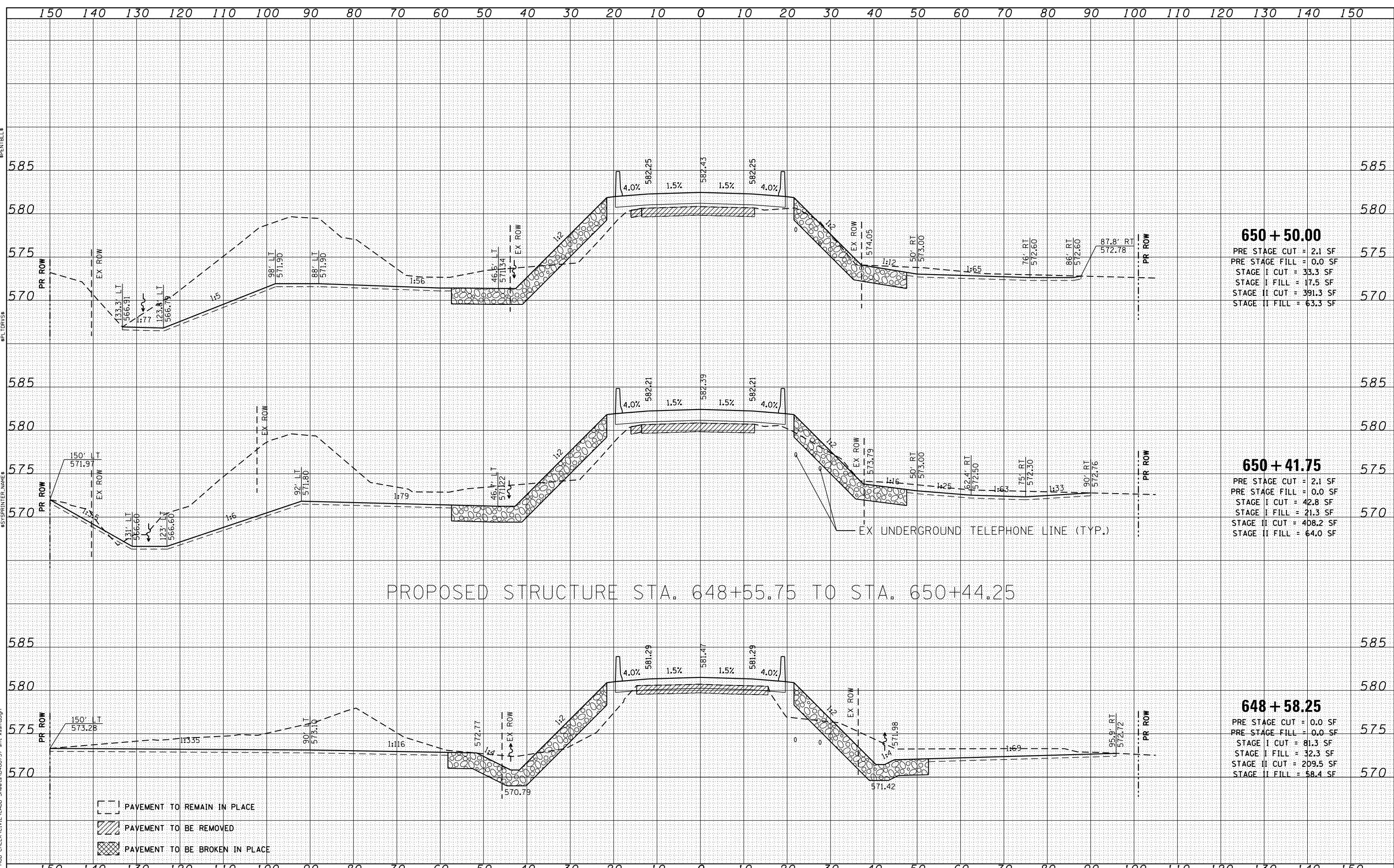

**650 + 50.00**  
 PRE STAGE CUT = 2.1 SF  
 PRE STAGE FILL = 0.0 SF  
 STAGE I CUT = 33.3 SF  
 STAGE I FILL = 17.5 SF  
 STAGE II CUT = 391.3 SF  
 STAGE II FILL = 63.3 SF

**650 + 41.75**  
 PRE STAGE CUT = 2.1 SF  
 PRE STAGE FILL = 0.0 SF  
 STAGE I CUT = 42.8 SF  
 STAGE I FILL = 21.3 SF  
 STAGE II CUT = 408.2 SF  
 STAGE II FILL = 64.0 SF

**648 + 58.25**  
 PRE STAGE CUT = 0.0 SF  
 PRE STAGE FILL = 0.0 SF  
 STAGE I CUT = 81.3 SF  
 STAGE I FILL = 32.3 SF  
 STAGE II CUT = 209.5 SF  
 STAGE II FILL = 58.4 SF

PROPOSED STRUCTURE STA. 648+55.75 TO STA. 650+44.25

- PAVEMENT TO REMAIN IN PLACE
- PAVEMENT TO BE REMOVED
- PAVEMENT TO BE BROKEN IN PLACE



|                                   |                 |           |
|-----------------------------------|-----------------|-----------|
| USER NAME = TERRA                 | DESIGNED - CL   | REVISED - |
|                                   | DRAWN - KJC     | REVISED - |
| PLOT SCALE = 1"=10'               | CHECKED - LVA   | REVISED - |
| PLOT DATE = 1/23/2013 11:18:17 AM | DATE - 01/25/13 | REVISED - |

STATE OF ILLINOIS  
 DEPARTMENT OF TRANSPORTATION

ROADWAY CROSS SECTIONS  
 IL 9 OVER MUD CREEK

SCALE: 1"=10' SHEET NO. 5 OF 10 SHEETS STA. 648+58.25 TO STA. 650+50.00

|             |            |          |              |                    |
|-------------|------------|----------|--------------|--------------------|
| F.A.P. RTE. | SECTION    | COUNTY   | TOTAL SHEETS | SHEET NO.          |
| 693         | (119BR) BR | TAZEWELL | 80           | 71                 |
|             |            |          |              | CONTRACT NO. 68757 |

ILLINOIS FED. AID PROJECT