

DATE	
BY	
SURVEYED	
PLOTTED	
TEMPLATE	
AREAS CHECKED	
AREAS CHECKED	

DATE	
BY	
SURVEYED	
PLOTTED	
TEMPLATE	
AREAS CHECKED	
AREAS CHECKED	

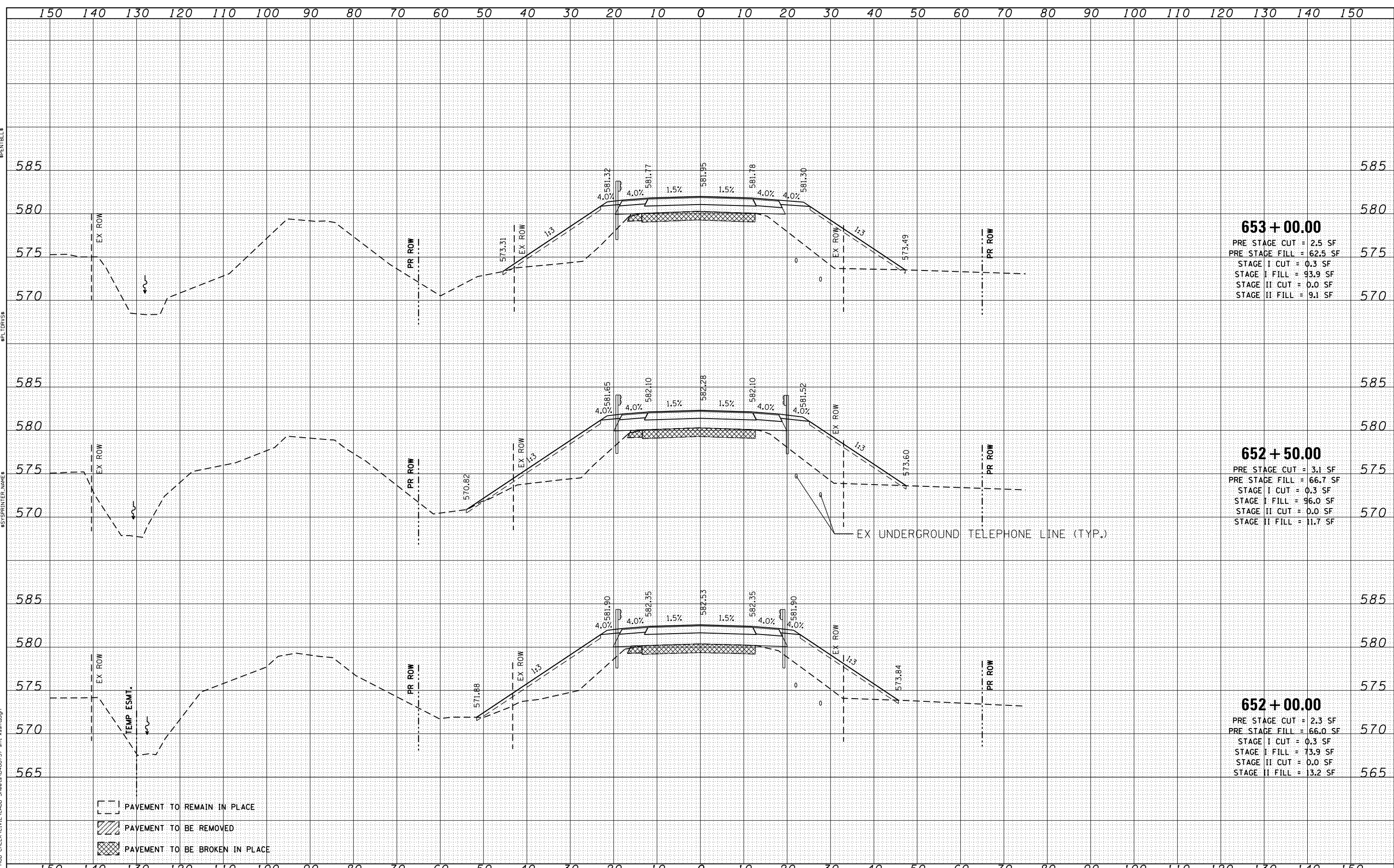

**653 + 00.00**

PRE STAGE CUT = 2.5 SF  
 PRE STAGE FILL = 62.5 SF  
 STAGE I CUT = 0.3 SF  
 STAGE I FILL = 93.9 SF  
 STAGE II CUT = 0.0 SF  
 STAGE II FILL = 9.1 SF

**652 + 50.00**

PRE STAGE CUT = 3.1 SF  
 PRE STAGE FILL = 66.7 SF  
 STAGE I CUT = 0.3 SF  
 STAGE I FILL = 96.0 SF  
 STAGE II CUT = 0.0 SF  
 STAGE II FILL = 11.7 SF

**652 + 00.00**

PRE STAGE CUT = 2.3 SF  
 PRE STAGE FILL = 66.0 SF  
 STAGE I CUT = 0.3 SF  
 STAGE I FILL = 73.9 SF  
 STAGE II CUT = 0.0 SF  
 STAGE II FILL = 13.2 SF

- PAVEMENT TO REMAIN IN PLACE
- PAVEMENT TO BE REMOVED
- PAVEMENT TO BE BROKEN IN PLACE



USER NAME = TERRA	DESIGNED - CL	REVISED -
	DRAWN - KJC	REVISED -
	CHECKED - LVA	REVISED -
	DATE - 01/25/13	REVISED -

STATE OF ILLINOIS  
 DEPARTMENT OF TRANSPORTATION

ROADWAY CROSS SECTIONS  
 IL 9 OVER MUD CREEK

SCALE: 1"=10' SHEET NO. 7 OF 10 SHEETS STA. 652+00.00 TO STA. 653+00.00

F.A.P. RTE.	SECTION	COUNTY	TOTAL SHEETS	SHEET NO.
693	(119BR) BR	TAZEWELL	80	73
				CONTRACT NO. 68757

ILLINOIS FED. AID PROJECT