

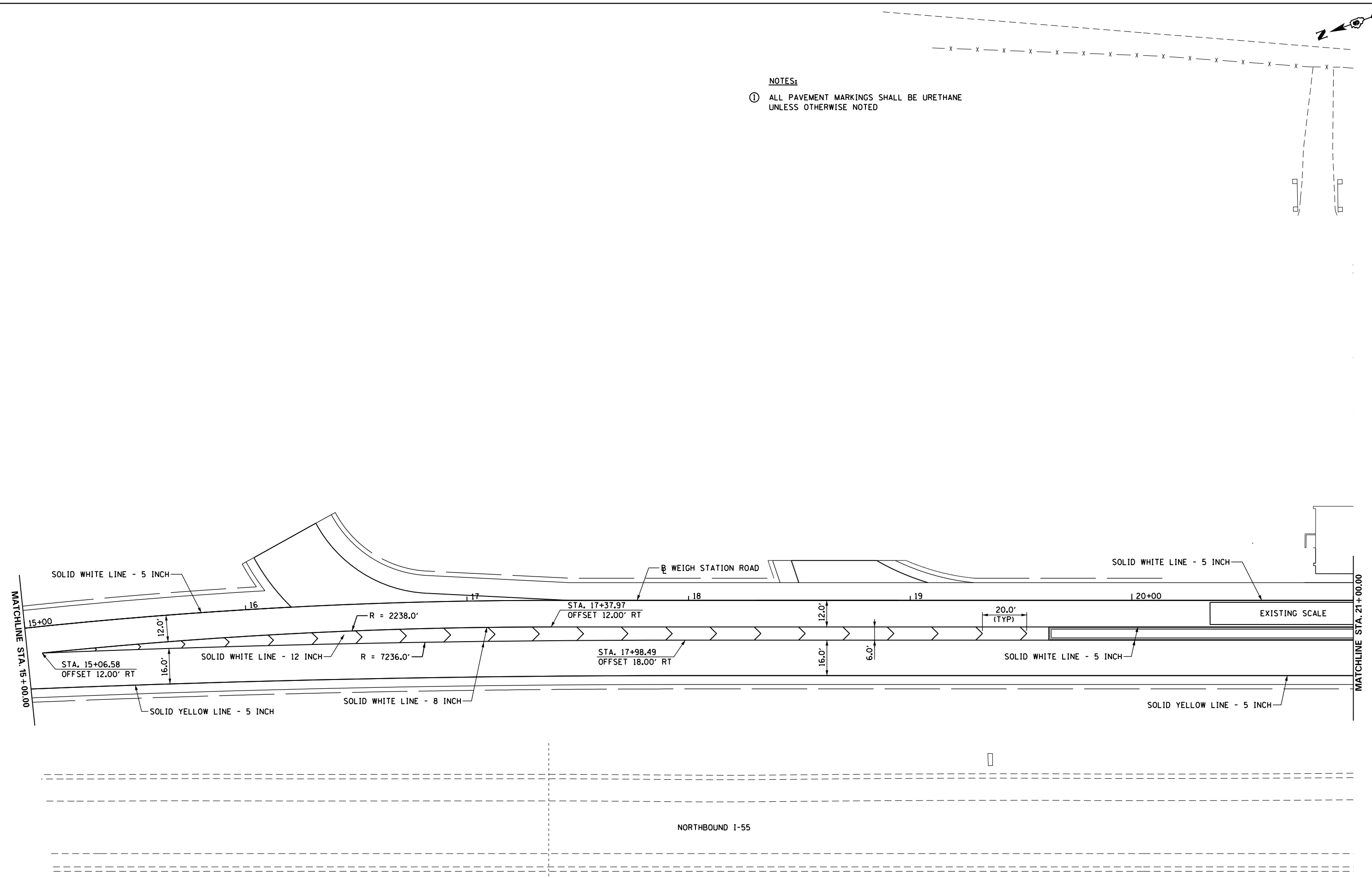

NOTES:
 ① ALL PAVEMENT MARKINGS SHALL BE URETHANE UNLESS OTHERWISE NOTED



NORTHBOUND I-55

FILE NAME = c:\pwork\pwork\sparks\0216368\0672505-sht-markings.dgn	USER NAME = sparksq	DESIGNED -	REVISED -	STATE OF ILLINOIS DEPARTMENT OF TRANSPORTATION	SIGNING & PAVEMENT MARKING DETAILS			F.A.I. RTE. = 55	SECTION = 68-2WS-2	COUNTY = MONTGOMERY	TOTAL SHEETS = 124	SHEET NO. = 55	
	PLOT SCALE = 40.0000' / in.	CHECKED -	REVISED -					CONTRACT NO. 72505					
PLOT DATE = Apr-11-2013 03:50:38PM	DATE -	REVISED -	SCALE: 1" = 20'			SHEET NO. 2 OF 5 SHEETS		STA. 15+00.00 TO STA. 21+00.00			ILLINOIS FED. AID PROJECT		