

NOTES:
 ① ALL PAVEMENT MARKINGS SHALL BE URETHANE UNLESS OTHERWISE NOTED

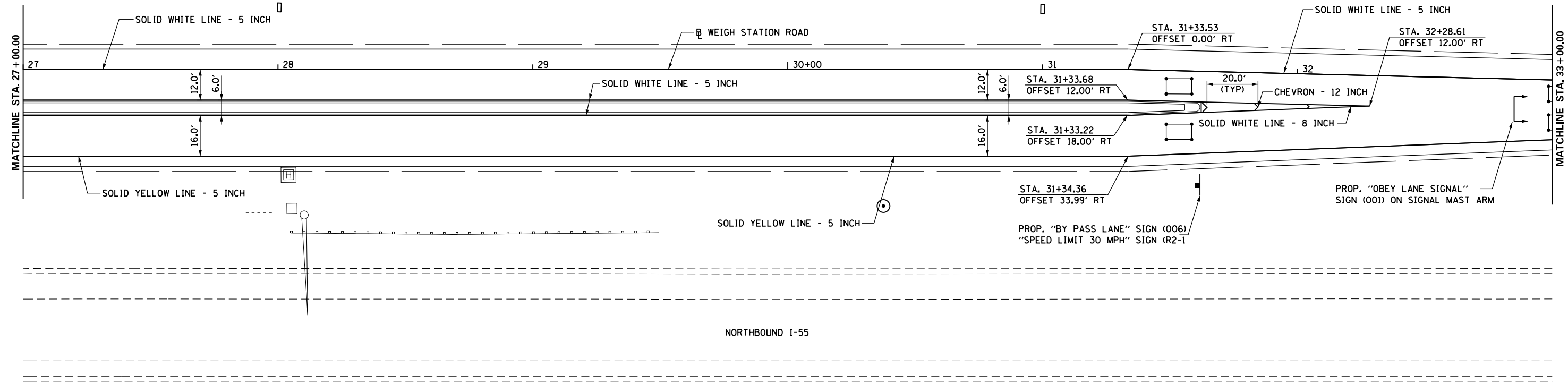

NOTES:
 ① ALL PAVEMENT MARKINGS SHALL BE URETHANE UNLESS OTHERWISE NOTED

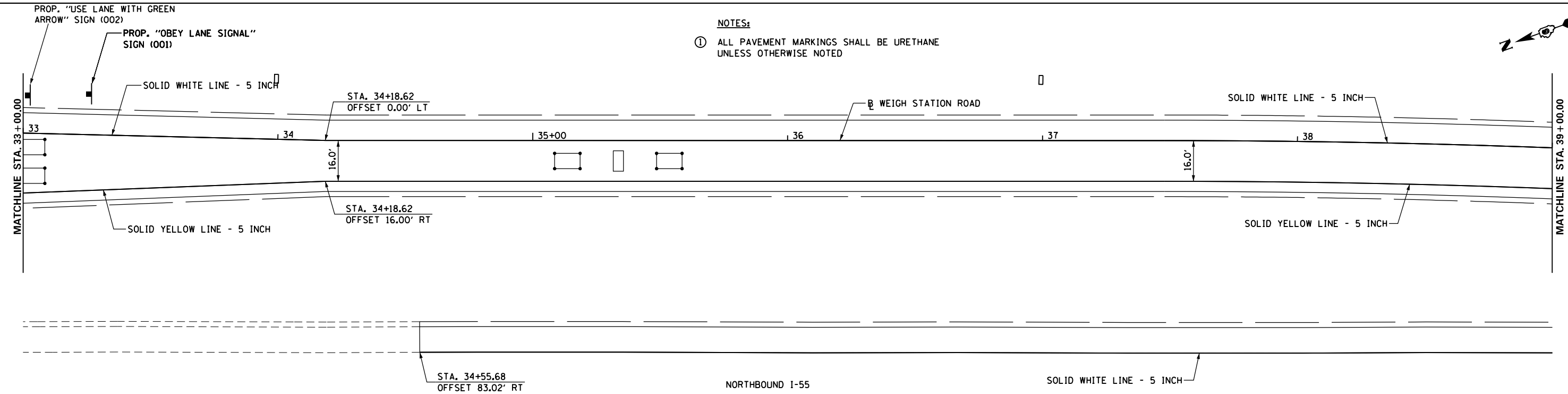

| | | | |
|--|------------------------------------|------------|-----------|
| FILE NAME = | USER NAME = sparksgw | DESIGNED - | REVISED - |
| c:\pwwork\pwwork\sparksgw\0216368\0672505-sht-markings.dgn | | DRAWN - | REVISED - |
| | PLOT SCALE = 40.0000' / in. | CHECKED - | REVISED - |
| | PLOT DATE = Apr-11-2013 03:50:39PM | DATE - | REVISED - |

**STATE OF ILLINOIS
 DEPARTMENT OF TRANSPORTATION**

**SIGNING & PAVEMENT
 MARKING DETAILS**

SCALE: 1" = 20' SHEET NO. 4 OF 5 SHEETS STA. 27+00.00 TO STA. 39+00.00

| F.A.I. RTE. | SECTION | COUNTY | TOTAL SHEETS | SHEET NO. |
|---------------------------|----------|------------|--------------|-----------|
| 55 | 68-2WS-2 | MONTGOMERY | 124 | 57 |
| CONTRACT NO. 72505 | | | | |
| ILLINOIS FED. AID PROJECT | | | | |