

DETAIL B - SENSOR LAYOUT

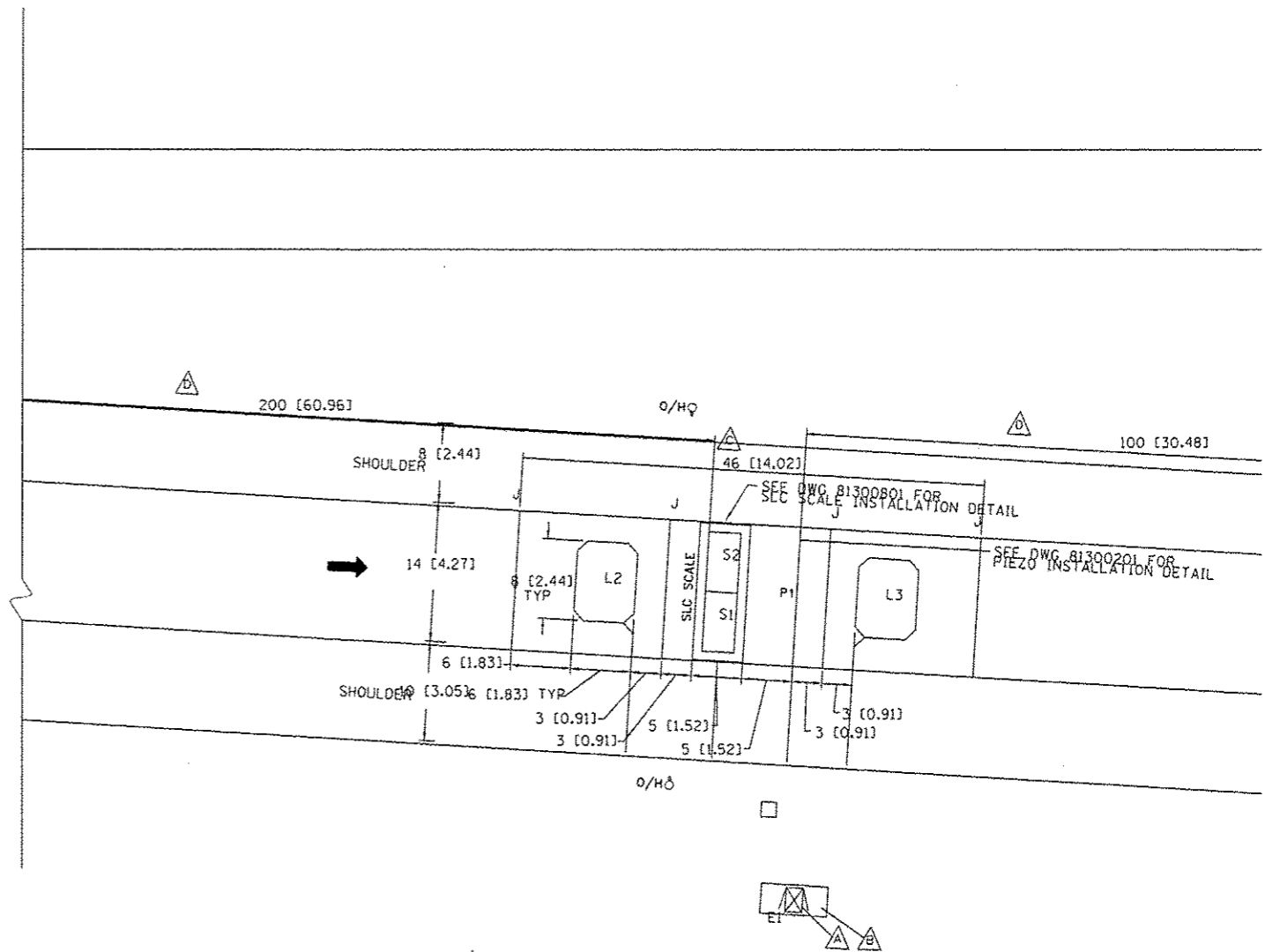
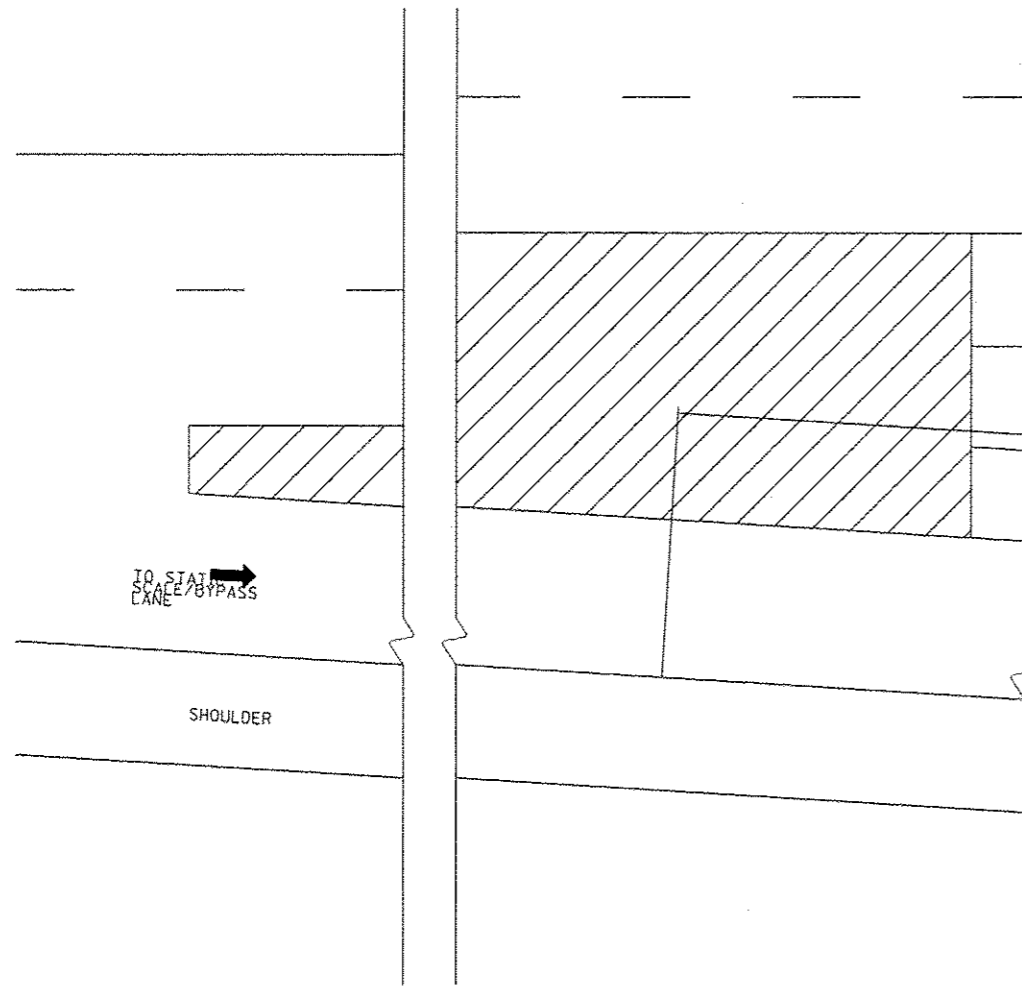

NOTES: (THIS SHEET ONLY)

- ▲ CABINET WITH WIM ELECTRONICS (SEE SHEET 94, 95, AND 96 FOR DETAIL)
- ▲ CABINET BASE (SEE SHEET 97 FOR DETAIL)
- ▲ NEW SENSORS AS SHOWN
- ▲ SITE CONDITIONS AS PER ASTM E1318-02

FILE NAME =	USER NAME = sparkgs	DESIGNED -	REVISED -	<b>STATE OF ILLINOIS DEPARTMENT OF TRANSPORTATION</b>	<b>WEIGH IN MOTION DETAILS</b>	P.A.I. RTE.	SECTION	COUNTY	TOTAL SHEETS	SHEET NO.
n:\pwork\puidot\sparkgs\0216368\067	505-SHT-WIM.dgn	DRAWN -	REVISED -			55	68-2WS-2	MONTGOMERY	12M	90
Default	PLOT SCALE = 1/8"=1'-0"	CHECKED -	REVISED -			SCALE: SHEET 2 OF 12 SHEETS STA. TO STA.		CONTRACT NO. 72505		
	PLOT DATE = May-14-2013 01:56:00PM	DATE -	REVISED -			ILLINOIS FED. AID PROJECT				