

STORM SEWERS, CLASS A, TYPE 1 12"
 LT. STA. 798+04 (WB)
 RT. STA. 798+04 (EB)

PIPE DRAINS 12"
 LT. STA. 798+04 (OUTSIDE WB)
 RT. STA. 798+04 (OUTSIDE EB)

METAL END SECTIONS 12"
 LT. STA. 798+04 (OUTSIDE WB)
 RT. STA. 798+04 (OUTSIDE EB)

STONE DUMPED RIPRAP, CLASS A4
 LT. STA. 798+04
 RT. STA. 798+04

FILTER FABRIC
 LT. STA. 798+04
 RT. STA. 798+04

BRIDGE APPROACH PAVEMENT CONNECTOR (PCC)
 (WIDTH 24' PAVEMENT + 10' OUTSIDE + 6' INSIDE SHOULDER = 40')

LT. STA. 797+09 TO LT. STA. 798+09
 RT. STA. 797+09 TO RT. STA. 798+09
 LT. STA. 800+27 TO LT. STA. 801+27
 RT. STA. 800+27 TO RT. STA. 801+27

TYPE E INLET BOX, STANDARD 610001 (SPECIAL)
 (SEE DETAILS)

LT. STA. 798+04 INSIDE SHLD.
 RT. STA. 798+04 INSIDE SHLD.

TYPE F INLET BOX, STANDARD 610001 (SPECIAL)
 (SEE DETAILS)

LT. STA. 798+04 OUTSIDE SHLD.
 RT. STA. 798+04 OUTSIDE SHLD.

PAVEMENT REMOVAL (24' WIDTH)
 (SAWCUT, & APPROACH SLAB INCLUDED IN THE COST)

LT. STA. 797+09 TO LT. STA. 798+39
 RT. STA. 797+09 TO RT. STA. 798+39
 LT. STA. 799+97 TO LT. STA. 801+27
 RT. STA. 799+97 TO RT. STA. 801+27

REMOVING INLETS

LT. STA. 798+28 INSIDE SHLD.
 LT. STA. 798+28 OUTSIDE SHLD.
 RT. STA. 798+28 INSIDE SHLD.
 RT. STA. 798+28 OUTSIDE SHLD.

PIPE CULVERT REMOVAL

LT. STA. 798+28 12" S.S.
 LT. STA. 798+28 12" CMP
 RT. STA. 798+28 12" S.S.
 RT. STA. 798+28 12" CMP

PAVED SHOULDER REMOVAL
 (10' OUTSIDE - 6' INSIDE)
 (SAWCUT, & APPROACH SLAB INCLUDED IN THE COST)

LT. STA. 797+09 TO LT. STA. 798+39
 RT. STA. 797+09 TO RT. STA. 798+39
 LT. STA. 799+97 TO LT. STA. 801+27
 RT. STA. 799+97 TO RT. STA. 801+27

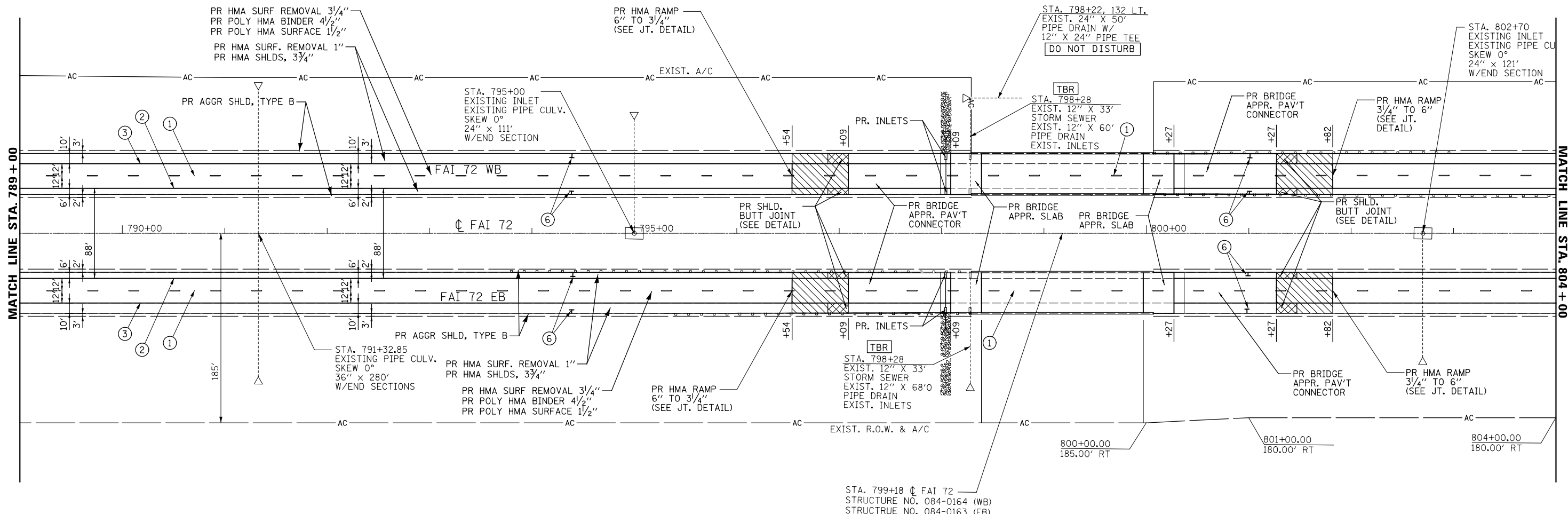

BRIDGE RESURFACING OMISSION
 STA. 797+09 TO STA. 801+27 WB & EB

PAVEMENT MARKING LEGEND

- ① PR PREFORMED PLASTIC PAVEMENT MARKING, TYPE B - INLAID - LINE 5" (30' SKIP, 10' DASH WHITE)
- ② PR MODIFIED URETHANE PAVEMENT MARKING - LINE 5" (SOLID YELLOW)
- ③ PR MODIFIED URETHANE PAVEMENT MARKING - LINE 5" (SOLID WHITE)
- ④ PR MODIFIED URETHANE PAVEMENT MARKING - LINE 8" (SOLID WHITE)
- ⑤ PR MODIFIED URETHANE PAVEMENT MARKING - LINE 12" (SOLID WHITE)
- ⑥ PR OUTLET MARKER (EACH) SEE DETAIL

NOTE: USE MODIFIED URETHANE PAVEMENT MARKING - LINE 5" (30' SKIP, 10' DASH WHITE) STA. 797+09 TO STA. 801+27 LT/RT



FILE NAME = ... \CADD\0672C88-sh1-plan18.dgn	USER NAME =	DESIGNED -	REVISED -	STATE OF ILLINOIS DEPARTMENT OF TRANSPORTATION	PLAN SHEETS			F.A.I. RTE.	SECTION	COUNTY	TOTAL SHEETS	SHEET NO.
		DRAWN -	REVISED -		SCALE:	SHEET NO.	OF SHEETS	STA.	TO STA.	ILLINOIS FED. AID PROJECT	95	64
		CHECKED -	REVISED -								CONTRACT NO. 72C88	
		DATE -	REVISED -								PART B - SHEET 36 of 67	