

EXISTING STRUCTURE: S.N. 084-0163(EB) & -0164(WB), originally constructed in 1975 as F.A.I. Route 72 Section 84-10-3B-2 at Station 99+18.00, using 36" steel beams with 8" concrete deck and 1 1/2" HMA Wearing Surface, 3 spans, 158'-0" back-back abutments, 42'-0" out-out width, stub abutments on concrete piles, wall piers with footing on concrete piles. In 1991, HMA Wearing Surface was removed and replaced, and expansion joints reconstructed. In 1999, HMA Wearing Surface was again replaced.

Staged construction shall be used to maintain one lane of traffic.

No Salvage.

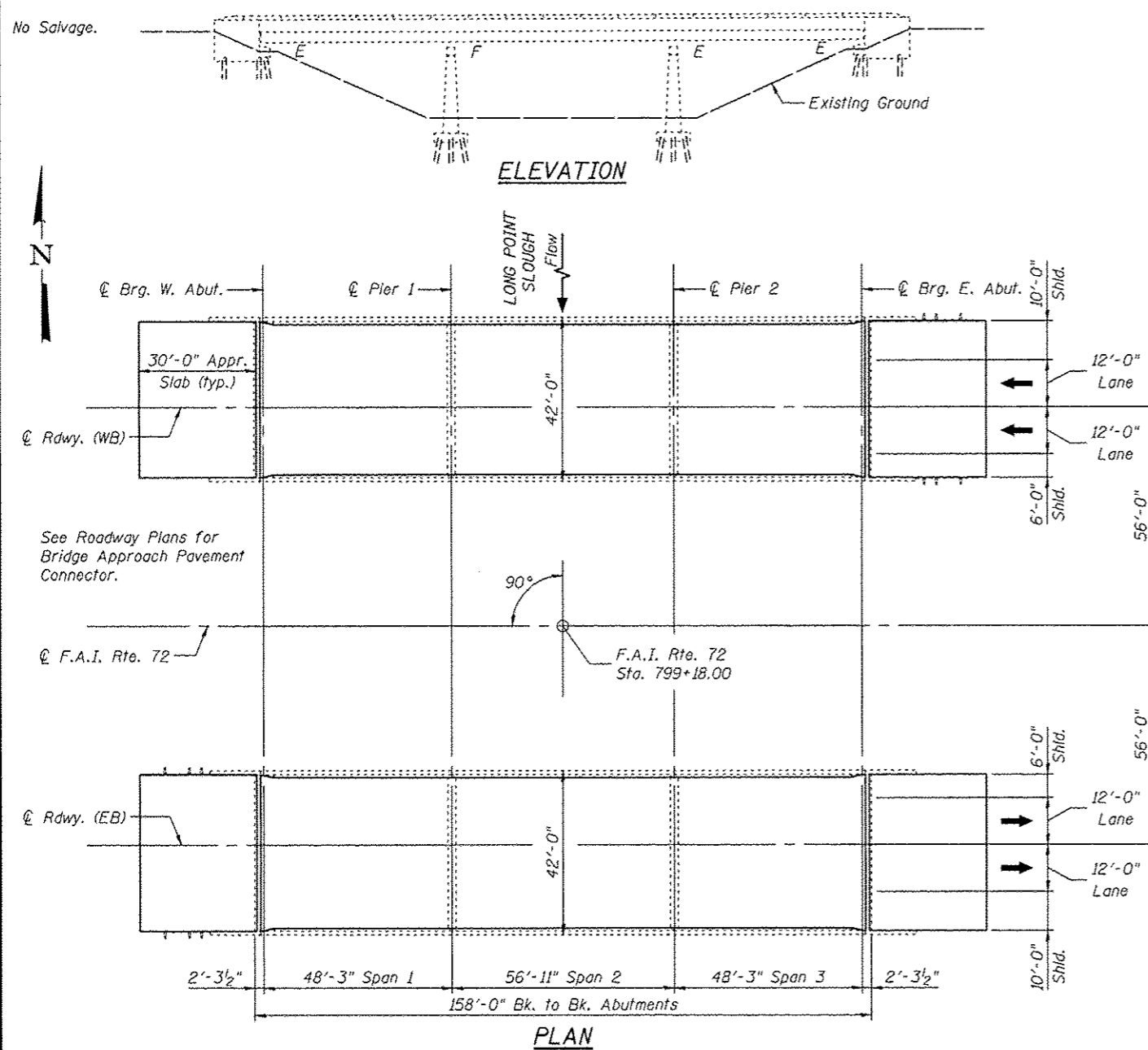

See Roadway Plans for Bridge Approach Pavement Connector.

See Roadway Plans for Bridge Approach Pavement Connector.

Signed: *David Dapp*
Date: 4-2-2013
Lic. Expires: 11-30-2014

SCOPE OF WORK:

- Remove existing HMA overlay and waterproofing membrane.
- Bridge deck repairs.
- Scarify deck and add microsilica concrete overlay.
- Remove and replace approach slabs.
- Diamond Grind deck overlay and approach slabs.
- Remove and replace existing expansion joint seals at both abutments.
- Remove and replace existing expansion bearings at abutments.
- Plug half of the deck drains and replace existing drain extensions.

INDEX OF SHEETS

- 1 Gen Plan, Gen Notes, Bill of Mat'l
- 2 Temporary Concrete Barrier
- 3-5 Deck Repairs
- 6-7 Bridge Approach Slab Details
- 8-9 Bearing Details
- 10 Bar Splicers

GENERAL NOTES

Reinforcement bars designated (E) shall be epoxy coated.
Plan dimensions and details relative to existing plans are subject to routine variations. The Contractor shall field verify existing dimensions and details affecting new construction and make necessary approved adjustments prior to construction or ordering of materials. Such variations shall not be cause for additional compensation for a change in scope of the work, however, the Contractor will be paid for the quantity actually furnished based upon the unit price bid for the work.
The existing structural steel coating contains lead. The Contractor shall take appropriate precautions to deal with the presence of lead on this project.
Existing structural steel that will be in contact with new structural steel shall be cleaned and painted prior to erection as required by the Special Provision "Cleaning and Painting Contact Surface Areas of Existing Steel Structures".
All new structural steel shall be shop painted with the inorganic zinc rich primer per AASHTO M300, Type 1. Cost included with Furnishing and Erecting Structural Steel.
Field painting of structural steel shall be done under a separate painting contract.
Concrete Sealer shall be applied to the surfaces of the parapets (deck and wings), and the approach slabs. No sealer shall be applied to the new deck overlay. See Special Provisions for BRIDGE DECK CONCRETE SEALER.
Diamond Grinding shall be applied to the new concrete deck overlay and approach slabs, prior to Bridge Deck Grooving. See Special Provisions for "Diamond Grinding and Surface Testing Bridge Sections".

TOTAL BILL OF MATERIAL

ITEM	UNIT	EB	WB	TOTAL
Concrete Structures	Cu Yd	25.3	25.3	50.6
Concrete Superstructure	Cu Yd	118.8	118.8	237.6
Bridge Deck Grooving	Sq Yd	889	889	1778
Furnishing and Erecting Structural Steel	Pound	1713	1713	3426
Reinforcement Bars, Epoxy Coated	Pound	30480	30480	60960
Bar Splicers	Each	222	222	444
Elastomeric Bearing Assembly, Type I	Each	6	6	12
Elastomeric Bearing Assembly, Type II	Each	6	6	12
Anchor Bolts, 1"	Each	24	24	48
Bridge Deck Concrete Sealer	Sq Ft	3708	3708	7416
Floor Drain Extension	Each	20	20	40
Jack and Remove Existing Bearings	Each	12	12	24
Hot-Mix Asphalt Surface Removal (Deck)	Sq Yd	645	645	1290
Bridge Deck Scarification 3/4"	Sq Yd	645	645	1290
Bridge Deck Microsilica Concrete Overlay 2 3/4"	Sq Yd	645	645	1290
Plug Existing Deck Drains	Each	20	20	40
Deck Slab Repair (Full Depth, Type I)	Sq Yd	10	10	20
Deck Slab Repair (Full Depth, Type II)	Sq Yd	10	10	20
Silicone Joint Sealer, 1 3/4"	Foot	41	41	82
Silicone Joint Sealer, 2 3/4"	Foot	41	41	82
Diamond Grinding (Bridge Section)	Sq Yd	831	831	1662

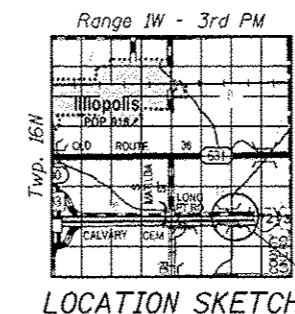

GENERAL PLAN & ELEVATION
F.A.I. RTE. 72 OVER LONG POINT SLOUGH
F.A.I. RTE. 72 SEC. (84-10-3)RS-5
SANGAMON COUNTY
STATION 799+18.00
STRUCTURE NO. 084-0163(EB) & -0164(WB)

FILE NAME = ...0840163-72C88-001-gplan.dgn	USER NAME = DCD	DESIGNED - CMV	REVISIONS -	STATE OF ILLINOIS DEPARTMENT OF TRANSPORTATION	GENERAL PLAN & ELEVATION STRUCTURE NO. 084-0163(EB) & 084-0164(WB)	SHEET NO. 1 OF 10 SHEETS	F.A.I. RTE. 72	SECTION (84-10-3)RS-5	COUNTY SANGAMON	TOTAL SHEETS 95	SHEET NO. 78
PLOT SCALE =	DRAWN - P. Roy	REVISIONS -	STA. 799+18.00				CONTRACT NO. 72C88				
PLOT DATE = 04/02/2013 15:18:32	CHECKED - CMV/DCD	REVISIONS -	ILLINOIS FED. AID PROJECT								
Johnson, Dapp & Gilsenberry CONSULTING ENGINEERS Springfield, Illinois											